

2 PLAN 1:25/50/100 @ A0/A2/A4
Ground Floor - Proposed

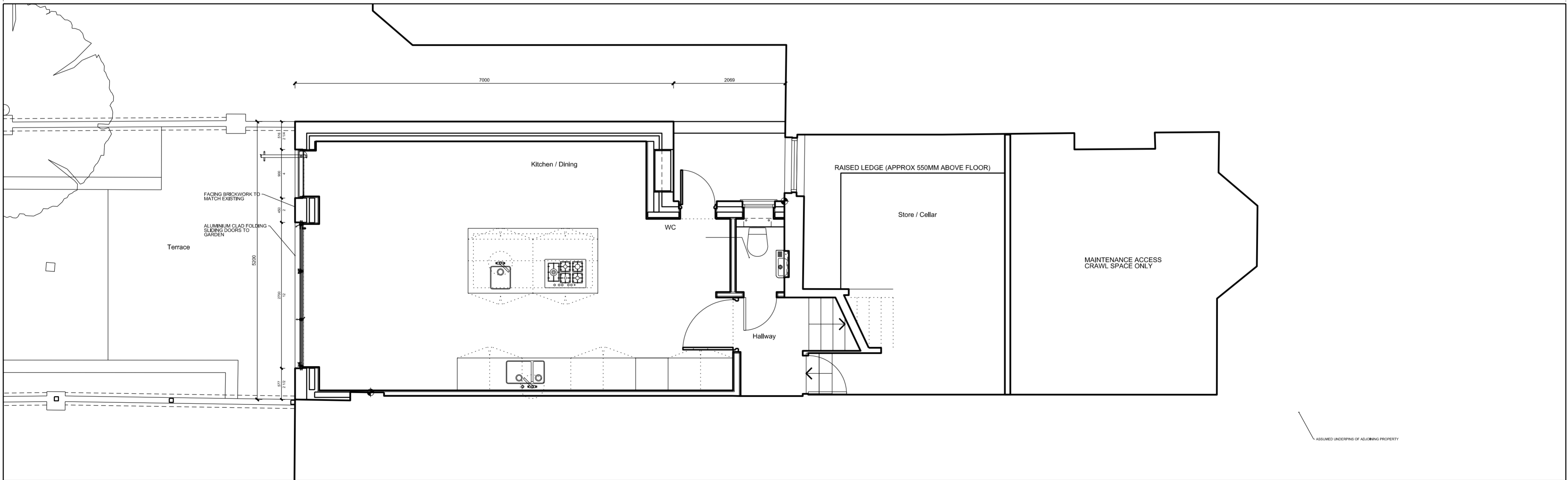

1 PLAN 1:25/50/100 @ A0/A2/A4
Basement - Proposed

NOTES
DO NOT SCALE
ALL DIMENSIONS TO BE CHECKED ON SITE

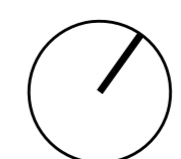

<p>pawlik+wiedmer</p> <p>Unit 1.33 75 Whitechapel Road London E1 1DU London@pawlikwiedmer.com Telephone: +44 (0)20 7341 1884 Registered Office: 27 Avenue Road, W1F 8UE, UK</p>		<p>3 ALDRED ROAD LONDON, NW6</p>	
Scale	1:25/50/100 @ A0/A2/A4	Date	04.03.2015
Drawn	NP	Status	PLANNING
Authorised	NP	Proj No	14501_PA_100
<p>C. BATHROOM WINDOW MOVED 12.04.2017 D. BASEMENT OMITTED 10.02.2017 B. PLANNING AMENDMENTS 15.10.2015 A. PLAN UPDATE 10.04.2015</p>		<p>The PROPOSED GA PLANS GROUND AND BASEMENT LEVELS</p>	
Rev		Rev	