

Ground Floor

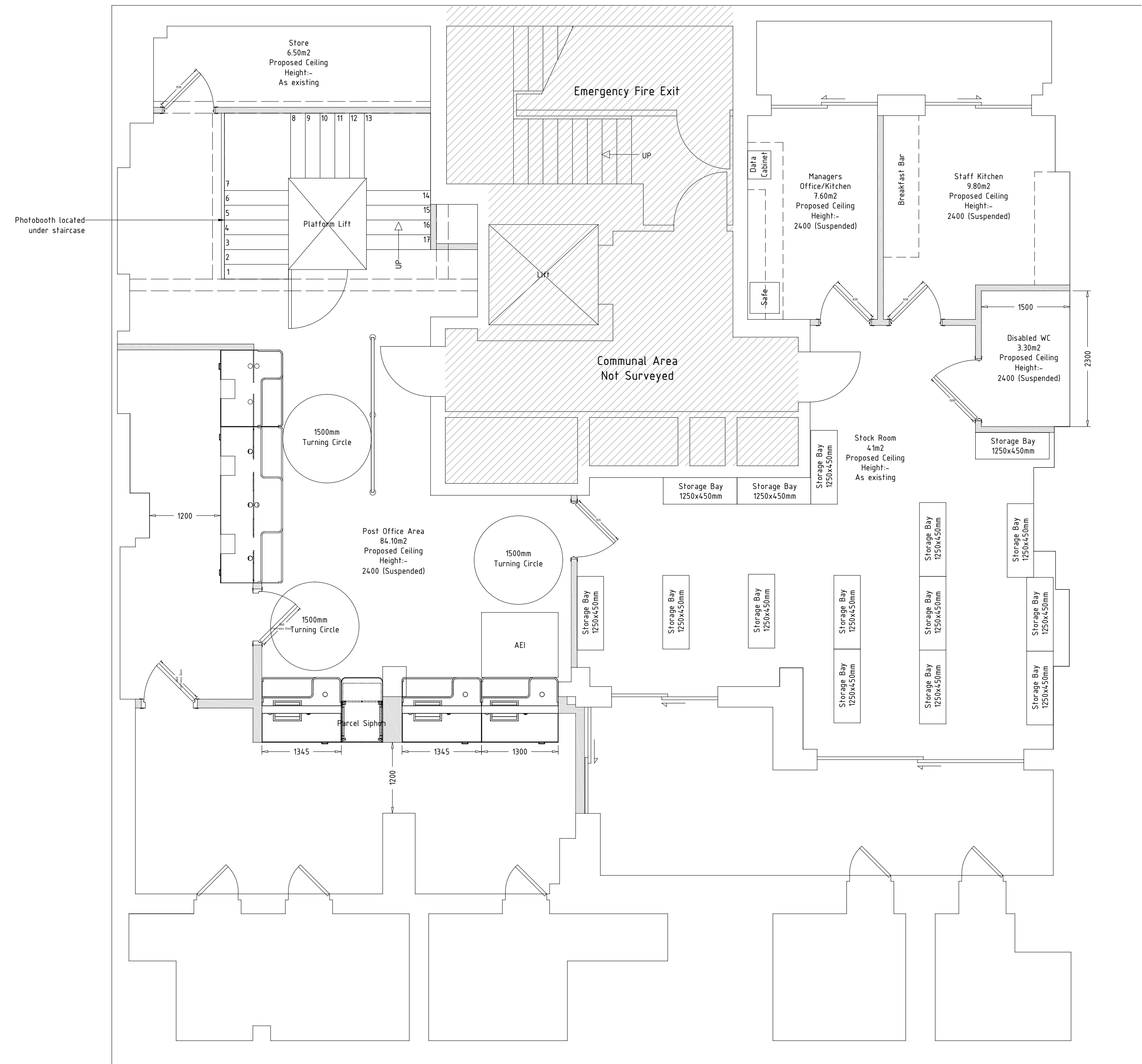

Basement

<p>Unit 4, Kingsthorpe Business Park, Studland Road Northampton. NN2 6NE. T: (01604) 791050 F: (01604) 791281 E: office@ppshopfit.com</p>	CLIENT Ryman	DATE 14.11.2016	SCALE 1:50 @ A1	
	CONTRACT 24-28 Grays Inn Road London	DRAWN BY DE	DRAWING NO. 300-1111	
	DRAWING TITLE Proposed Staircase Details Basement, Ground & Section	No. Revisions A	Date 06.12.2016	
		Layout updated		