

10.0 APPENDIX

10.1 Drawings

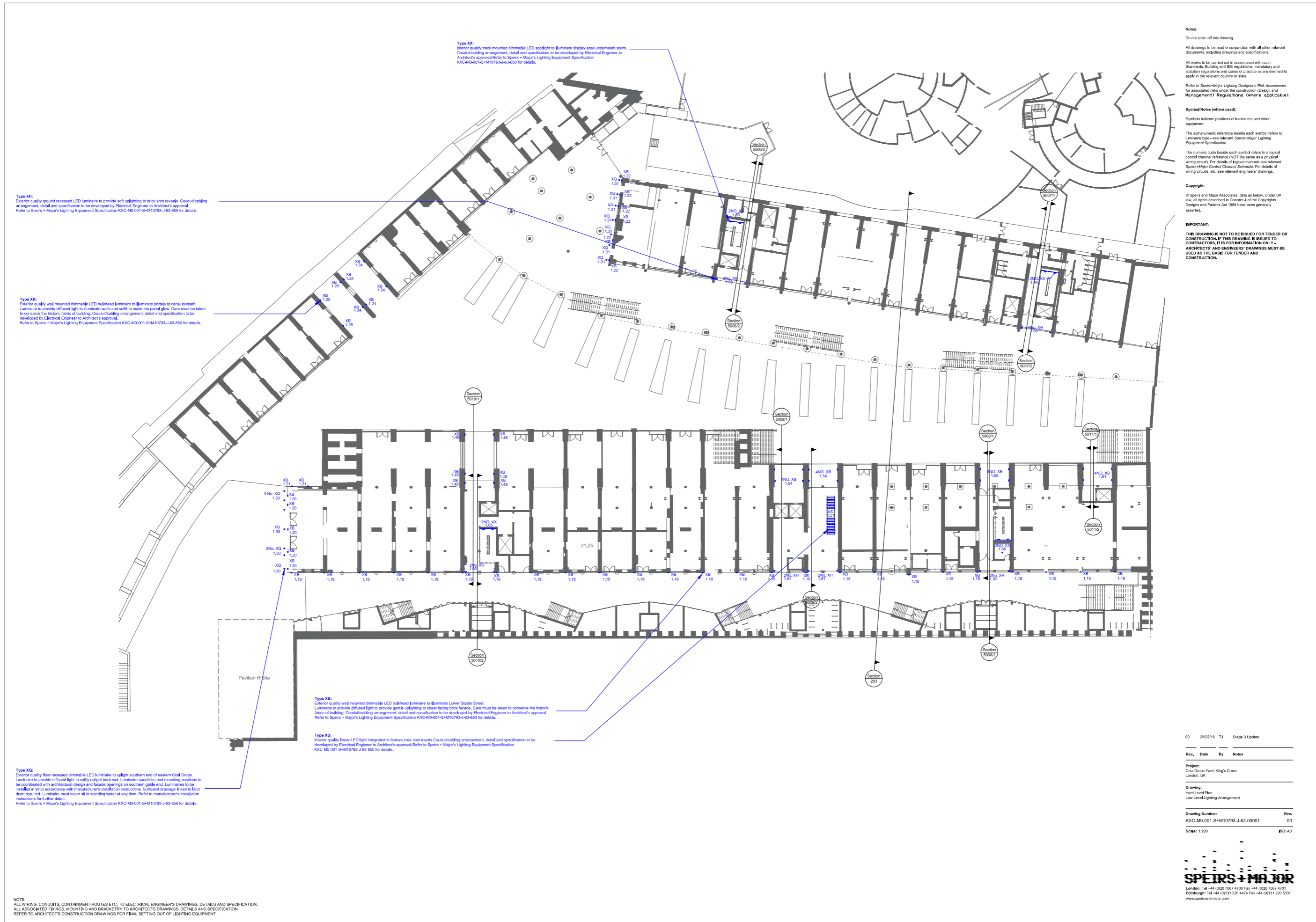

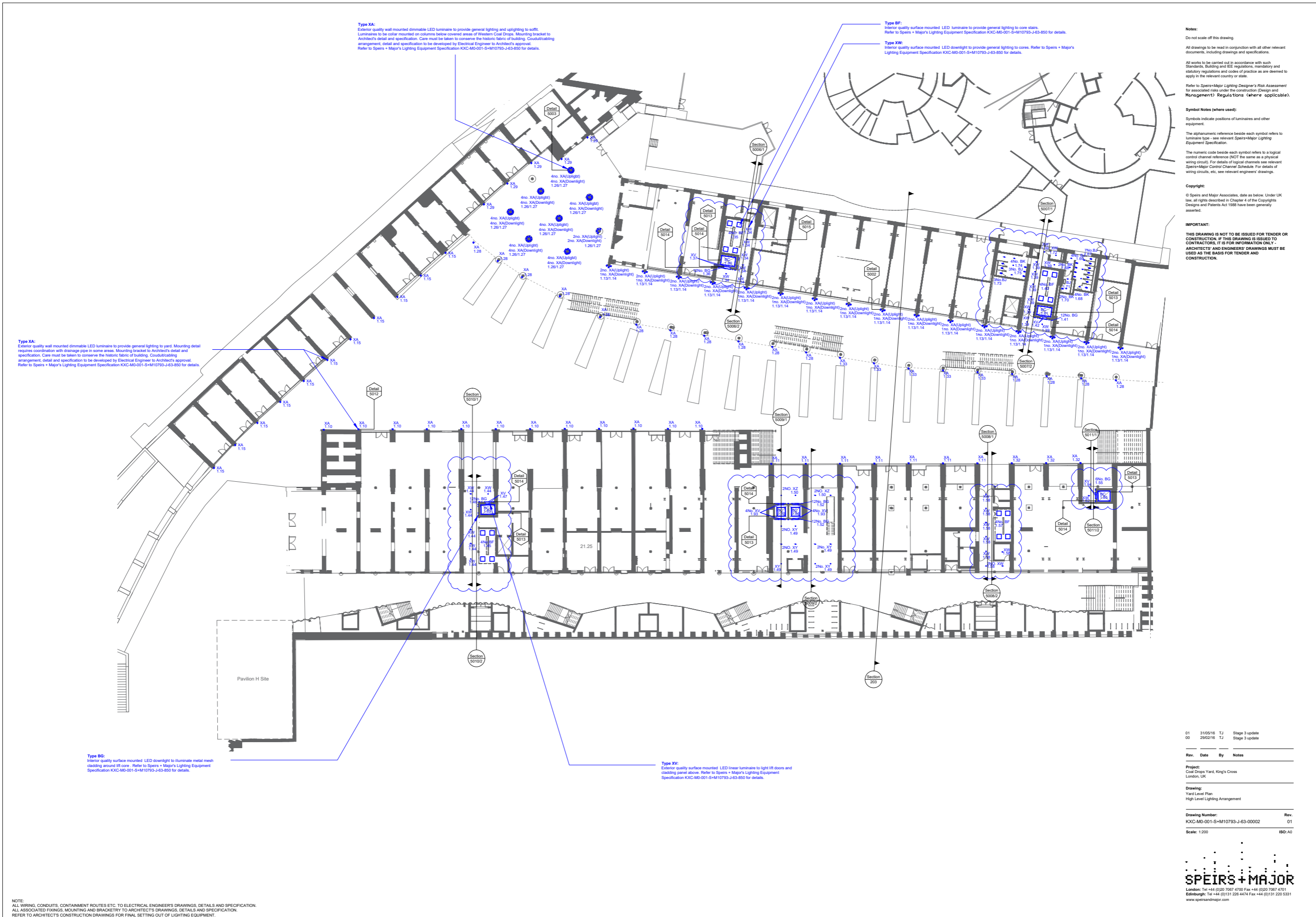

Type XA:
 Exterior quality wall mounted dimmable LED luminaire to provide general lighting and uplighting to soffit.
 Luminaires to be collar mounted on columns below covered areas of Western Coal Drops. Mounting bracket to
 Architect's detail and specification. Care must be taken to conserve the historic fabric of building. Cabling
 arrangement, detail and specification to be developed by Electrical Engineer to Architect's approval.
 Refer to Speirs + Major's Lighting Equipment Specification KXC-MD-001-S-M10793-J-63-850 for details.

Type BF:
 Interior quality surface mounted LED luminaire to provide general lighting to core stairs.
 Refer to Speirs + Major's Lighting Equipment Specification KXC-MD-001-S-M10793-J-63-850 for details.

Type XV:
 Interior quality surface mounted LED downlight to provide general lighting to cores. Refer to Speirs + Major's
 Lighting Equipment Specification KXC-MD-001-S-M10793-J-63-850 for details.

Type XA:
 Exterior quality wall mounted dimmable LED luminaire to provide general lighting to yard. Mounting detail
 requires coordination with drainage pipe in some areas. Mounting bracket to Architect's detail and
 specification. Care must be taken to conserve the historic fabric of building. Cabling
 arrangement, detail and specification to be developed by Electrical Engineer to Architect's approval.
 Refer to Speirs + Major's Lighting Equipment Specification KXC-MD-001-S-M10793-J-63-850 for details.

Type XZ:
 Interior quality surface mounted LED downlight to illuminate metal mesh
 cladding around lift core. Refer to Speirs + Major's Lighting Equipment
 Specification KXC-MD-001-S-M10793-J-63-850 for details.

Type XV:
 Exterior quality surface mounted LED linear luminaire to light lift doors and
 cladding panel above. Refer to Speirs + Major's Lighting Equipment
 Specification KXC-MD-001-S-M10793-J-63-850 for details.

Notes:
 Do not scale off this drawing.
 All drawings to be read in conjunction with all other relevant
 documents, including drawings and specifications.

All works to be carried out in accordance with such
 Standards, Building and IEE regulations, mandatory and
 statutory regulations and codes of practice as are deemed to
 apply in the relevant country or state.

Refer to Speirs+Major Lighting Designer's Risk Assessment
 for associated risks under the construction (Design and
 Management) Regulations (where applicable).

Symbol Notes (where used):
 Symbols indicate positions of luminaires and other
 equipment.

The alphanumeric reference beside each symbol refers to
 luminaire type - see relevant Speirs+Major Lighting
 Equipment Specification.

The numeric code beside each symbol refers to a logical
 control channel reference (NOT the same as a physical
 control channel reference). For details of logical channels see relevant
 Speirs+Major Control Channel Schedule. For details of
 wiring circuits, etc. see relevant engineers' drawings.

Copyright:
 © Speirs and Major Associates, date as below. Under UK
 law, all rights described in Chapter 4 of the Copyrights
 Designs and Patents Act 1988 have been generally
 asserted.

IMPORTANT:
 THIS DRAWING IS NOT TO BE ISSUED FOR TENDER OR
 CONSTRUCTION IF THIS DRAWING IS ISSUED TO
 CONTRACTORS. IT IS FOR INFORMATION ONLY.
 ARCHITECTS' AND ENGINEERS' DRAWINGS MUST BE
 USED AS THE BASIS FOR TENDER AND
 CONSTRUCTION.

01	31/05/16	TJ	Stage 3 update
00	29/02/16	TJ	Stage 3 update

Rev. Date By Notes

Project:
 Coal Drops Yard, King's Cross
 London, UK

Drawing:
 Yard Level Plan
 High Level Lighting Arrangement

Drawing Number: KXC-MD-001-S-M10793-J-63-00002
Rev: 01

Scale: 1:200 **ISO: A0**



NOTE:
 ALL WIRING, CONDUITS, CONTAMINANT ROUTES ETC. TO ELECTRICAL ENGINEERS DRAWINGS, DETAILS AND SPECIFICATION.
 ALL ASSOCIATED FIXINGS, MOUNTING AND BRACKETRY TO ARCHITECT'S DRAWINGS, DETAILS AND SPECIFICATION.
 REFER TO ARCHITECT'S CONSTRUCTION DRAWINGS FOR FINAL SETTING OUT OF LIGHTING EQUIPMENT.