

Sheffield Loop Racks

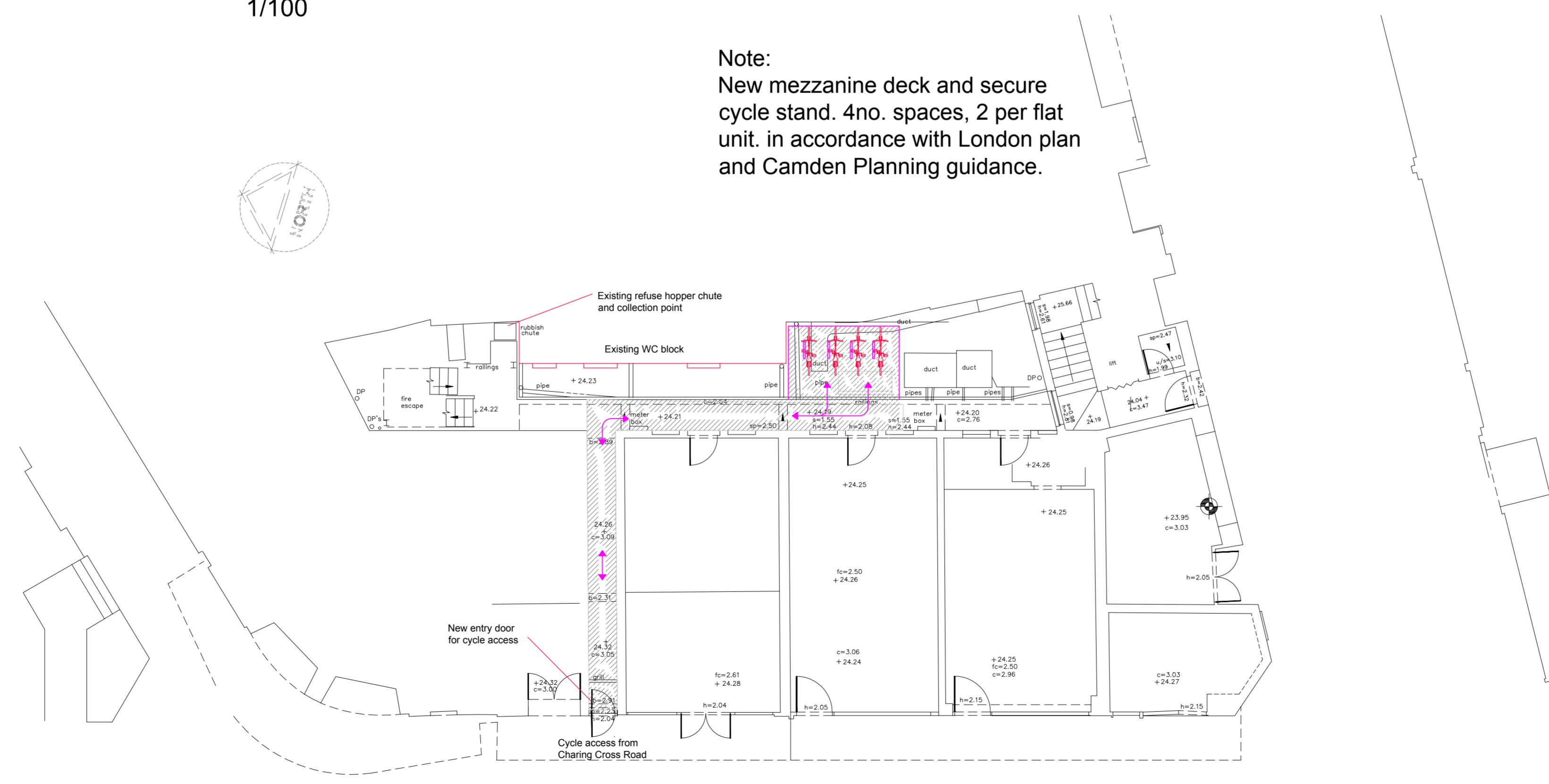

Note:
New mezzanine deck and secure cycle stand. 4no. spaces, 2 per flat unit. in accordance with London plan and Camden Planning guidance.



- Revision C. Section amended 12-04-2017
- Revision B Escape door omitted 13-12-2016
- Revision B Escape door omitted 13-12-2016

This drawing is the property of Life Designs and is issued on the condition that it not reproduced, disclosed or copied to any unauthorised person in whole or part without prior written consent.
No dimensions are to be scaled from this drawing all dimensions stated must be verified on site. The architect must be advised of any discrepancies prior to any item of work being put in hand. This drawing must be read together with the specification, bill of quantities and related drawings

Julia Vincens 16
Bendinat - 07181 Calvià
Mallorca - Spain
T +34 871 115 433
m. +34 608 392 748
aa_lifedesigns@ymail.com

Project: Phoenix House 104-110 Charing Cross Road, London WC2 OJP				
Client: Mr & Mrs H S Markham & The Hallam partnership LLP				
Title: Proposed grand floor plan & Proposed section				
Situation: Planning				
Project N°:	Date:	Scale:	Drawing N°:	Rev:
259	04 / 2017	1/50 1/100 (A1)	(P) 003	