

EXISTING SECOND FLOOR PLAN
1:50 @ A1 / 1:100 @ A3

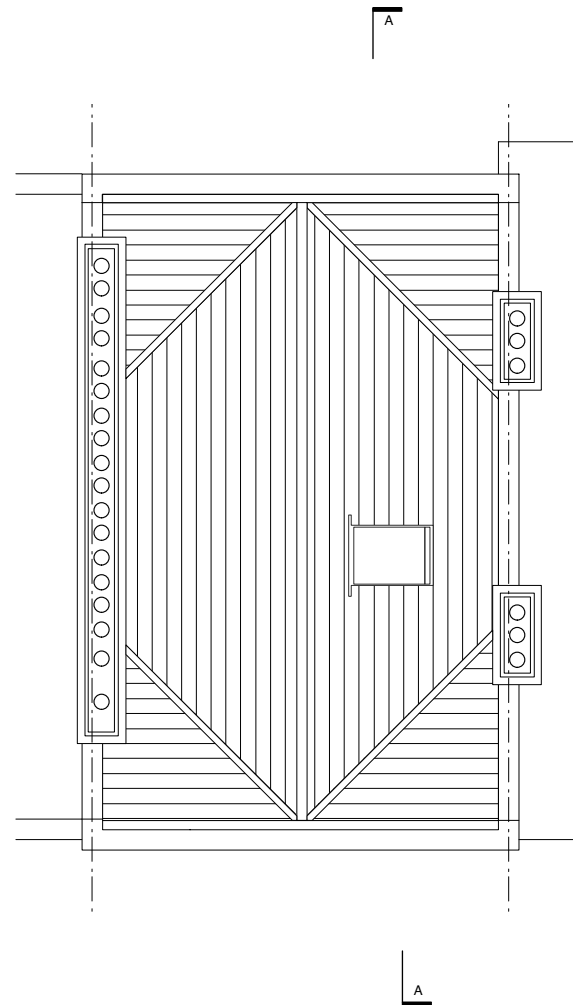

EXISTING ROOF PLAN
1:50 @ A1 / 1:100 @ A3



designstudio

a: 31 Priam House, Old Bethnal green Rd., London E2 9RH
e: tg@gorawski.com m: 077 2467 8579

client
JANE & SIMON

project status
Planning

project name
118 Leighton Road

drawing title
Existing 2nd Floor & Roof Plan

scale: 1:50 @ A1 & 1:100 @ A3
date: 03.04.2017
drawn: TG

project no	drawing no	revision
1607	(EX) 02	.

Do not scale from this drawing. All information to be checked on site for accuracy. Any discrepancy between this drawing and other information is to be referred to the architects. This drawing is copyright