

1 Worktop Locations

1 : 25

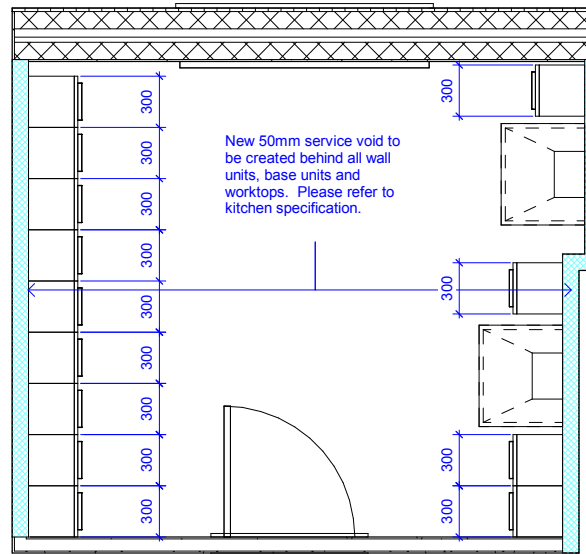
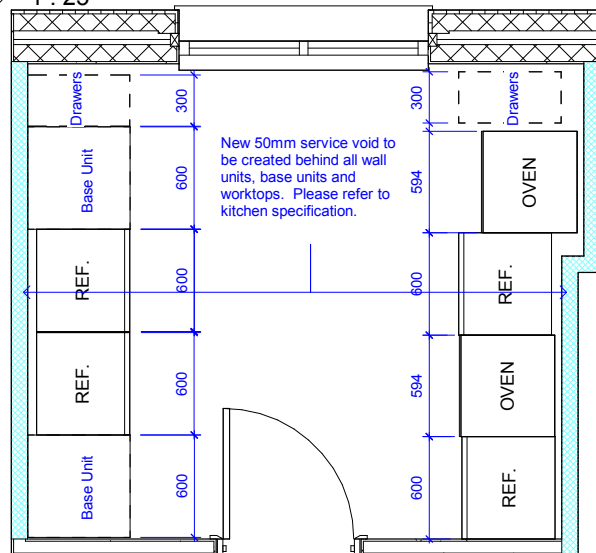

2 Wall Unit Locations

1 : 25

3 Base Unit Locations

1 : 25

- Contents:
- 2nr. Sinks
 - 2nr. Ovens with hob and extractor
 - 2nr. Fridges
 - 2nr. Freezers
 - 13nr. Extra tall (900mm) wall units
 - 2nr. Below sink base units
 - 2nr. Sets of Drawers

Do Not Scale

Like only written dimensions. All dimensions must be verified prior to the works being put into hand and any discrepancies reported to the originator.

Health and Safety Information		
Details	Date	Initials
Asbestos Survey		
Structural Check - Lifting & Handling		
Site Survey		
Access and Egress - Site Compound		
Materials Identified		

General Notes

Drawings are indicative, to be used as a computer representation of the layout only.

The contractor is responsible for ensuring that the room dimensions are correct, the final measure, templating and installation of the kitchen, inclusive of any infill panels and plinths where required.

Please consult the drawing for the list of items currently included.

Any changes to the indicative layout and worktop templating are to be agreed with the project manager prior to production.

Client:

UCL



Euston Tower, 286 Euston Road,
London, NW1 3AT
Tel. +44(0)20 7121 2121
Fax. +44(0)20 7121 2020

Project:
UCL Summer Works 2017

Gower Street

Ref:

Drawing No:
UCL/ATH/57

Site:
125 Gower Street - Student Kitchen -
Component Locations 1 of 1

Scale	Code	Created	Revised
1 : 25	CB	LY	LY
Original Size	A	Date: 14/2/2017	Date: 14/2/2017

Status: