

ALAN GREEN BSc, C Eng, MICE  
CONSULTING ENGINEER

119 DUKE ROAD, LONDON W4 2BX  
Tel no. 020 8995 1845  
alan.greenw4@btinternet.com

Date 3/17

Sheet No.

Eng. *MG*

7139/SKZ

Job. FLAT 4  
17 PRINCE ALBERT ROAD  
LONDON NW1

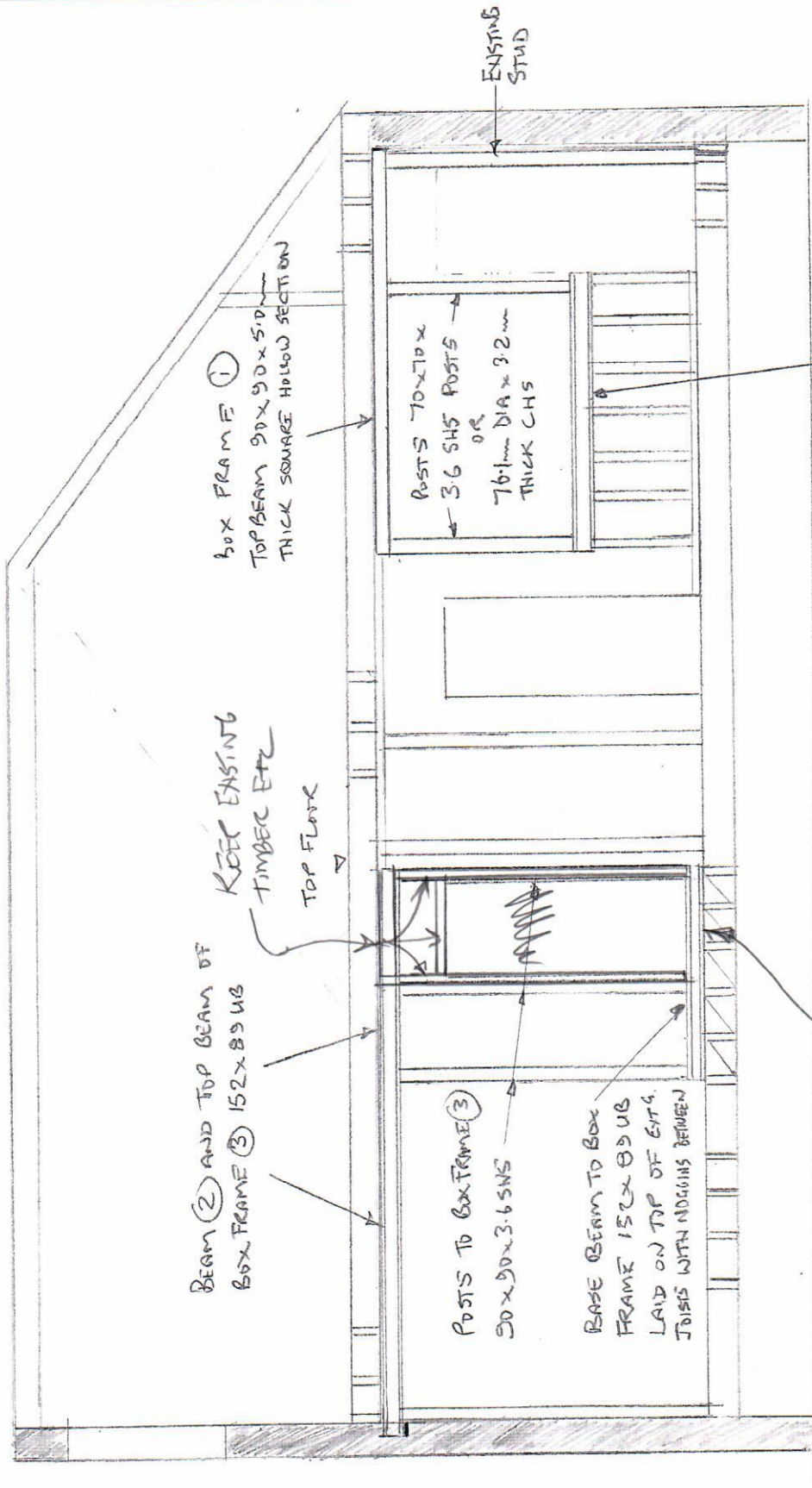

BOX FRAME 1  
TOP BEAM 90x90x5.0  
THICK SQUARE HOLLOW SECTION

POSTS 70x70x  
3.6 SHS POSTS  
OR  
76.1mm DIA x 3.2mm  
THICK CHS

EXISTING  
STUD

KEEP EXISTING  
TIMBER ETC  
TOP FLOOR

BEAM 2 AND TOP BEAM OF  
BOX FRAME 3 152x89 UB

POSTS TO BOX FRAME 3  
50x90x3.6 SHS

BASE BEAM TO BOX  
FRAME 152x89 UB  
LAID ON TOP OF ETC.  
JOISTS WITH NOTCHES BETWEEN

152x89 UB LAID ON TOP  
OF EXISTING CUT DOWN STUDS

A-A

CAN WE CUT BOTTOM OF  
EXISTING STUDS AT SIDES  
OF DOOR, AND PUT IN BOTTOM  
BEAMS TO SPREAD LOADS?