

1. Set up site welfare within 19, 23, 24 & 25 Denmark Street L1-L4 Area
2. Smithy relocated to temporary position by demolition contractor
3. Commence Secant and Bearing Piles
4. Establish Bentonite Plant on St Giles High Street
5. NLEB works commence in Week 21

- Key
- Skanska Road Traffic
 - Brookfield Road Traffic (Assumed)
 - Skanska Site Traffic
 - Pedestrian Site Traffic
 - Gate Reference

All high level fixtures, including awnings, signage, CCTV etc, must be removed in this area to ensure they do not impede piling rig access.

19 Denmark Street All Levels, except GF, to be used for Site Welfare.

Ground Floor Retail Units in Operation. Access to be maintained at all times. 23 - 25 Denmark Street Level 1 - Level 4 to be used for Site Offices.

Piling Works In Progress

Final Smithy Position - Week 17

Temporary Smithy Position

Bentonite Storage Zone

Bentonite Storage Zone

FACADE RETENTION

Traffic Arm Barrier - to restrict area to construction vehicles only

NOTES

1. Expected Vehicle Movements = 55/day
2. Week numbers based on revised 140 week tender programme
3. Once the benonite plant is removed in Week 30 (Dec 17), vehicles drive into St Giles High Street unloading bay and reverse back out before turning left onto Denmark Street

REVISED START DATE TO 22nd MAY NK 08/12/16
HOARDING LINE ADJUSTED FOR UKPN NK 01/11/16
SLABS AND AT SOUTH PORTAL NK 31/08/16
TIL ROUNDUP ADDED NK 31/08/16
REVISED DUE TO NEW START ON NK 01/07/16
SITE DATE AND UPDATED HOARDING LAYOUT AS REQUESTED BY LBC&TL NK 01/07/16
REVISED FOLLOWING CONFIRMATION NK 01/06/16
OF FURTHER CONSTRAINTS NK 11/04/16
REVISED DUE NEW START ON SITE NK 07/01/16
DATE & REVISED PILE LAYOUT NK 07/01/16
REVISED FOLLOWING COMMENTS NK 07/01/16
REVISED FOLLOWING ST GILES CIRCUS NK 12/11/15
COORDINATION MEETINGS NK 18/09/15
WORKING GROUP MEETING 03/08/15 NK 10/08/15
REVISED FOLLOWING INTERNAL REVIEW NK 27/07/15
REVISED FOLLOWING CAMDEN MEETING NK 27/07/15
REVISED FOLLOWING SLW COMMENTS NK 06/07/15

Consolidated Developments Limited

SKANSKA

ST GILES CIRCUS, LONDON WC1

ZONE 1 & 2 LOGISTICS STAGE 1
Wks 1 - 24 (May 17 - Oct 17) 19.06.15
SKA-LOG-001 12

MAY 2017 - OCT 2017
PILING WORKS ONGOING.

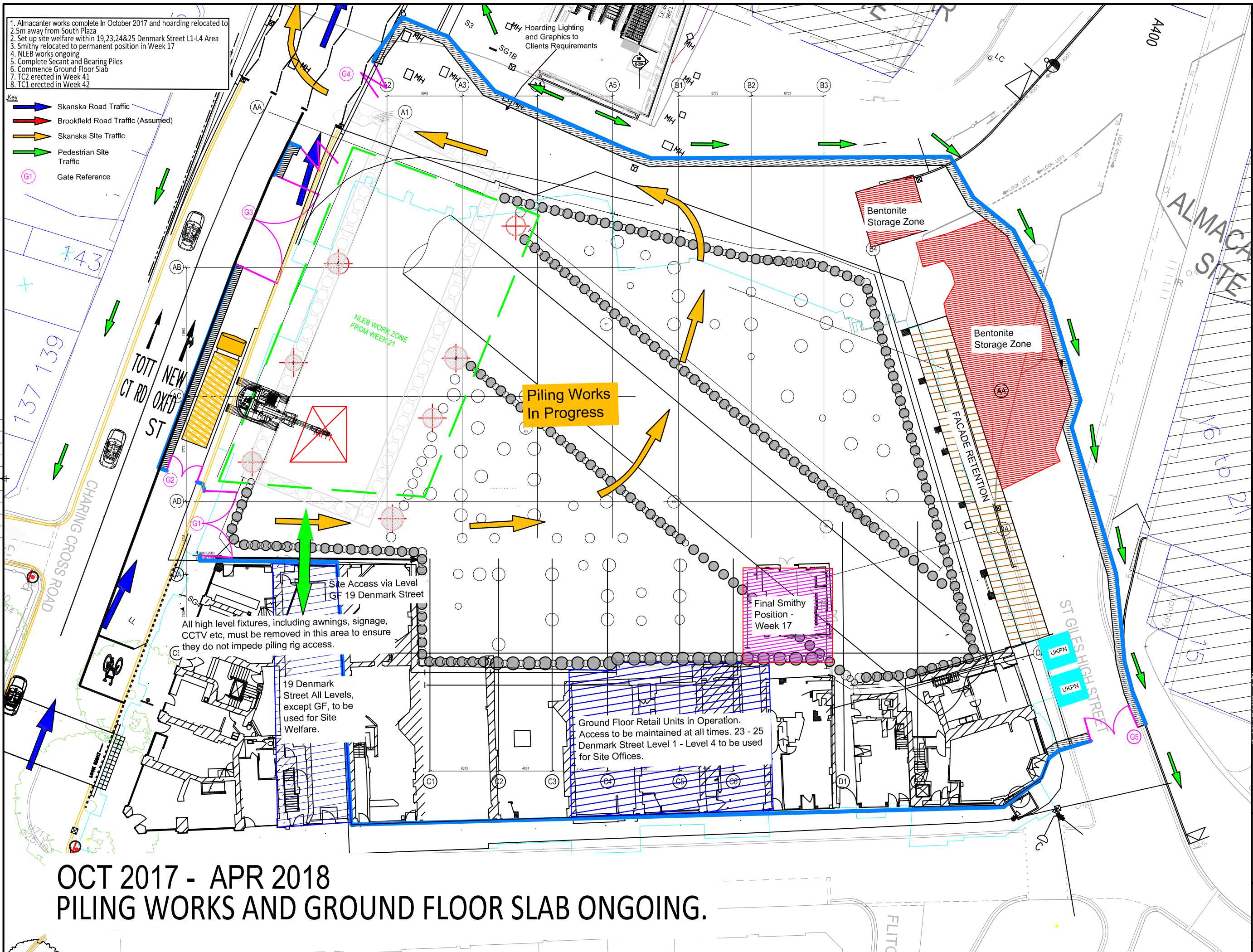

1. Almacanter works complete in October 2017 and hoarding relocated to 2.5m away from South Plaza
2. Set up site welfare within 19, 23, 24 & 25 Denmark Street L1-L4 Area
3. Smithy relocated to permanent position in Week 17
4. NLEB works ongoing
5. Complete Secant and Bearing Piles
6. Commence Ground Floor Slab
7. TC2 erected in Week 41
8. TC1 erected in Week 42

- Key
- Skanska Road Traffic
 - Brookfield Road Traffic (Assumed)
 - Skanska Site Traffic
 - Pedestrian Site Traffic
 - Gate Reference

- NOTES
1. Expected Vehicle Movements = 55/day
 2. Week numbers based on revised 140 week tender programme
 3. Once the bentonite plant is removed in Week 30 (Dec 17), vehicles drive into St Giles High Street unloading bay and reverse back out before turning left onto Denmark Street

11	REVISED DUE TO NEW START ON	NK 08/12/16
10	REVISED DUE TO NEW START ON	NK 17/10/16
9	REVISED DUE TO NEW START ON	NK 31/08/16
8	REVISED DUE TO NEW START ON	NK 01/07/16
7	REVISED DUE TO NEW START ON	NK 11/04/16
6	REVISED DUE TO NEW START ON	NK 07/01/16
5	REVISED DUE TO NEW START ON	NK 12/11/15
4	REVISED DUE TO NEW START ON	NK 18/09/15
3	REVISED DUE TO NEW START ON	NK 03/08/15
2	REVISED DUE TO NEW START ON	NK 10/08/15
1	REVISED DUE TO NEW START ON	NK 06/07/15

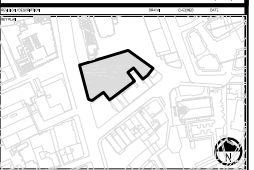

Consolidated Developments Limited



ST GILES CIRCUS, LONDON WC1

ZONE 1 & 2	LOGISTICS STAGE 2	24/06/15
Wks 25 - 49 (Oct 17 - Apr 18)		
SKA-LOG-002		11

OCT 2017 - APR 2018
PILING WORKS AND GROUND FLOOR SLAB ONGOING.

1. Complete excavation works to B1M level MH3 & MH4
2. Install temporary props and construct B1M slab
3. Commence Buildings A & B core construction
4. Complete B1M slab
5. Commence excavation to B1 level
6. Complete Building B core in week 52
7. Commence Building B superstructure in week 53

- Key**
- Skanska Road Traffic
 - Brookfield Road Traffic (Assumed)
 - Skanska Site Traffic
 - Pedestrian Site Traffic
 - Gate Reference
 - Unloading Zone

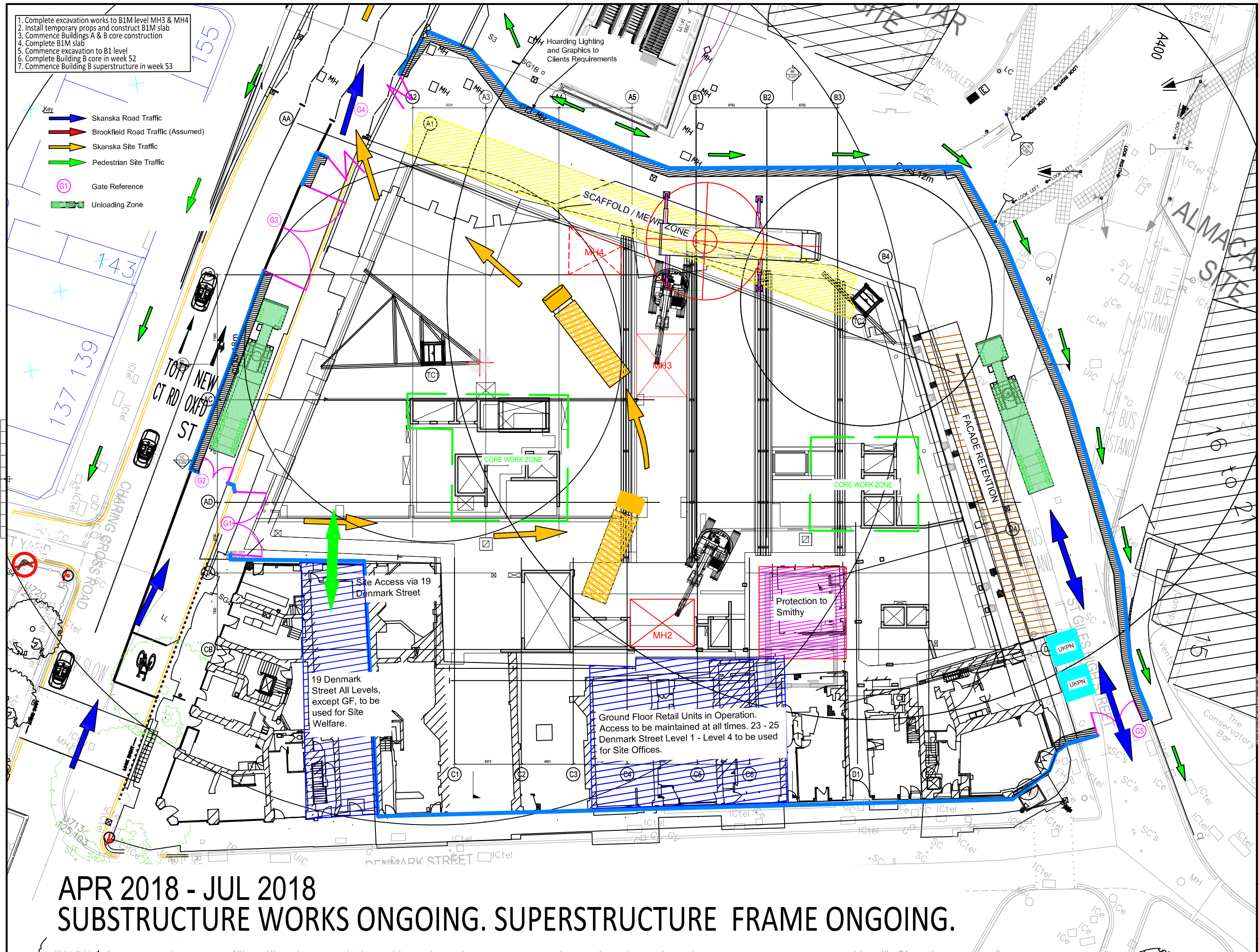

- NOTES**
1. Expected Vehicle Movements = 40/day
 2. Week numbers based on revised 140 week tender programme
 3. Vehicles drive into St Giles High Street and reverse back out before turning left onto Denmark Street

12	REVISED DUE TO NEW START ON	NK 08/12/16
11	REVISED DUE TO NEW START ON	NK 17/10/16
10	REVISED DUE TO NEW START ON	NK 31/08/16
9	REVISED DUE TO NEW START ON	NK 29/07/16
8	REVISED DUE TO NEW START ON	NK 01/07/16
7	REVISED DUE TO NEW START ON	NK 11/04/16
6	REVISED DUE TO NEW START ON	NK 07/01/16
5	REVISED DUE TO NEW START ON	NK 12/11/15
4	REVISED DUE TO NEW START ON	NK 18/09/15
3	REVISED DUE TO NEW START ON	NK 03/09/15
2	REVISED DUE TO NEW START ON	NK 10/08/15
1	REVISED DUE TO NEW START ON	NK 27/07/15
0	REVISED DUE TO NEW START ON	NK 06/07/15

Consolidated Developments Limited

SKANSKA

ST GILES CIRCUS, LONDON WC1

ZONE 1 & 2
LOGISTICS STAGE 3
Wks 49 - 60 (Apr 18 - Jul 18)

SKA-LOG-003 12

1. Excavation to B1 using MH4 completed
2. Construction of B1 raft slab ongoing
3. Commence Building A superstructure
4. Complete Building B superstructure

- Key**
- Skanska Road Traffic
 - Brookfield Road Traffic (Assumed)
 - Material Distribution
 - Pedestrian Site Traffic
 - Gate Reference
 - Unloading Zone
 - Hoist
 - Hoist Common Tower

NOTES

1. Expected Vehicle Movements = 40/day
2. Week numbers based on revised 140 week tender programme
3. Vehicles drive into St Giles High Street and reverse back out before turning left onto Denmark Street

- | | | |
|----|---|---|
| 12 | REVISED DUE TO NEW START ON | NK 08/12/16 |
| 11 | SITE DATE | REVISED DUE TO NEW START ON NK 17/10/16 |
| 10 | SITE DATE | REVISED DUE TO NEW START ON NK 17/10/16 |
| 9 | TIL ROUNDEL ADDED | NK 31/08/16 |
| 8 | REVISED FOLLOWING COMMENTS | NK 29/07/16 |
| 7 | FROM LUL ON HOARDING CDS | NK 01/07/16 |
| 6 | REVISED DUE TO NEW START ON | NK 01/07/16 |
| 5 | SITE DATE AND UPDATED HOARDING LAYOUT AS REQUESTED BY LUL | NK 11/04/16 |
| 4 | REVISED DUE TO NEW START ON SITE DATE & REVISED PILE LAYOUT | NK 07/01/16 |
| 3 | REVISED FOLLOWING ST GILES CIRCUS NK 12/11/15 | |
| 2 | COORDINATION MEETINGS | |
| 1 | REVISED FOLLOWING ST GILES CIRCUS NK 18/09/15 | |
| | WORKING GROUP MEETING 03.09.15 | |
| | REVISED FOLLOWING INTERNAL REVIEW NK 10/08/15 | |
| | REVISED FOLLOWING CAMDEN MEETING NK 27/07/15 | |
| | REVISED FOLLOWING SLW COMMENTS NK 06/07/15 | |

Consolidated
Developments
Limited

SKANSKA

ST GILES CIRCUS,
LONDON WC1

ZONE 1 & 2 LOGISTICS STAGE 4 Wks 60 - 70 (Jul18 - Sep18)	24/06/15
SKA-LOG-004	12

**JUL 2018 - SEP 2018
SUBSTRUCTURE WORKS ONGOING. SUPERSTRUCTURE FRAME ONGOING.**

1. Complete B1 slab
2. Commence excavation to B2
3. Complete stone cladding to Building B
4. Commence Building D structure
5. Commence Building B cladding
6. Install H3 between Building B and C
7. Commence Building C structure
8. Commence Zone 2 works
9. Dismantle facade retention
10. Commence Building B Fit Out & Lift works

- Key**
- Skanska Road Traffic
 - Brookfield Road Traffic (Assumed)
 - Material Distribution
 - Pedestrian Site Traffic
 - Gate Reference
 - Unloading Zone
 - Hoist
 - Hoist Common Tower

- Hoist Schedule**
- H1 - Services Buildings A, B, C & D from GF to level 06
 - H2 - Services GF to B1
 - H3 - Services Buildings A, B, C & D from GF to level 07

- NOTES**
1. Expected Vehicle Movements = 40/day
 2. Week numbers based on revised 140 week tender programme

- 10 REVISED DUE TO NEW START ON NK 08/12/16
- 11 SITE DATE NK 31/08/16
- 12 REVISED DUE TO NEW START ON NK 01/07/16
- 13 SITE DATE AND UPDATED HOARDING NK 01/07/16
- 14 LAYOUT AS REQUESTED BY LICHTS NK 11/04/16
- 15 REVISED DUE TO NEW START ON NK 11/04/16
- 16 DATE & REVISED PILE LAYOUT NK 07/01/16
- 17 REVISED FOLLOWING COMMENTS NK 07/01/16
- 18 COORDINATION MEETINGS NK 12/11/15
- 19 REVISED FOLLOWING ST GILES CIRCUS NK 18/09/15
- 20 WORKING GROUP MEETING 03.09.15
- 21 REVISED FOLLOWING INTERNAL REVIEW NK 10/08/15
- 22 REVISED FOLLOWING CAMDEN MEETING NK 27/07/15
- 23 REVISED FOLLOWING SLW COMMENTS NK 06/07/15

Consolidated Developments Limited

SKANSKA

ST GILES CIRCUS, LONDON WC1

ZONE 1 & 2 LOGISTICS STAGE 5
Wks 71 - 85 (Sep18 - Dec18) 24/16/15

SKA-LOG-005 10

SEP 2018 - DEC 2018

SUBSTRUCTURE WORKS ONGOING. BUILDING A SUPERSTRUCTURE FRAME ONGOING. BUILDING B ENVELOPE ONGOING. BUILDINGS C & D SUPERSTRUCTURE ONGOING.

1. Complete superstructure and continue external cladding
2. Install plant
3. Complete basement concrete works
4. Remove basement propping
5. Complete remaining substructure works
6. Commence box in box construction using MH3 to load out
7. Continue internal fit out and MEP
8. Zone 2 works ongoing
9. Dismantle TC2 in week 105

- Key**
- Skanska Road Traffic
 - Material Distribution
 - Pedestrian Site Traffic
 - Gate Reference
 - Unloading Zone
 - Hoist
 - Hoist Common Tower

- Hoist Schedule**
- H1 - Services Buildings A, B, C & D from GF to level 06
 - H2 - Services GF to B1
 - H3 - Services Buildings A, B, C & D from GF to level 07

- NOTES**
1. Expected Vehicle Movements = 25/day
 2. Week numbers based on revised 140 week tender programme

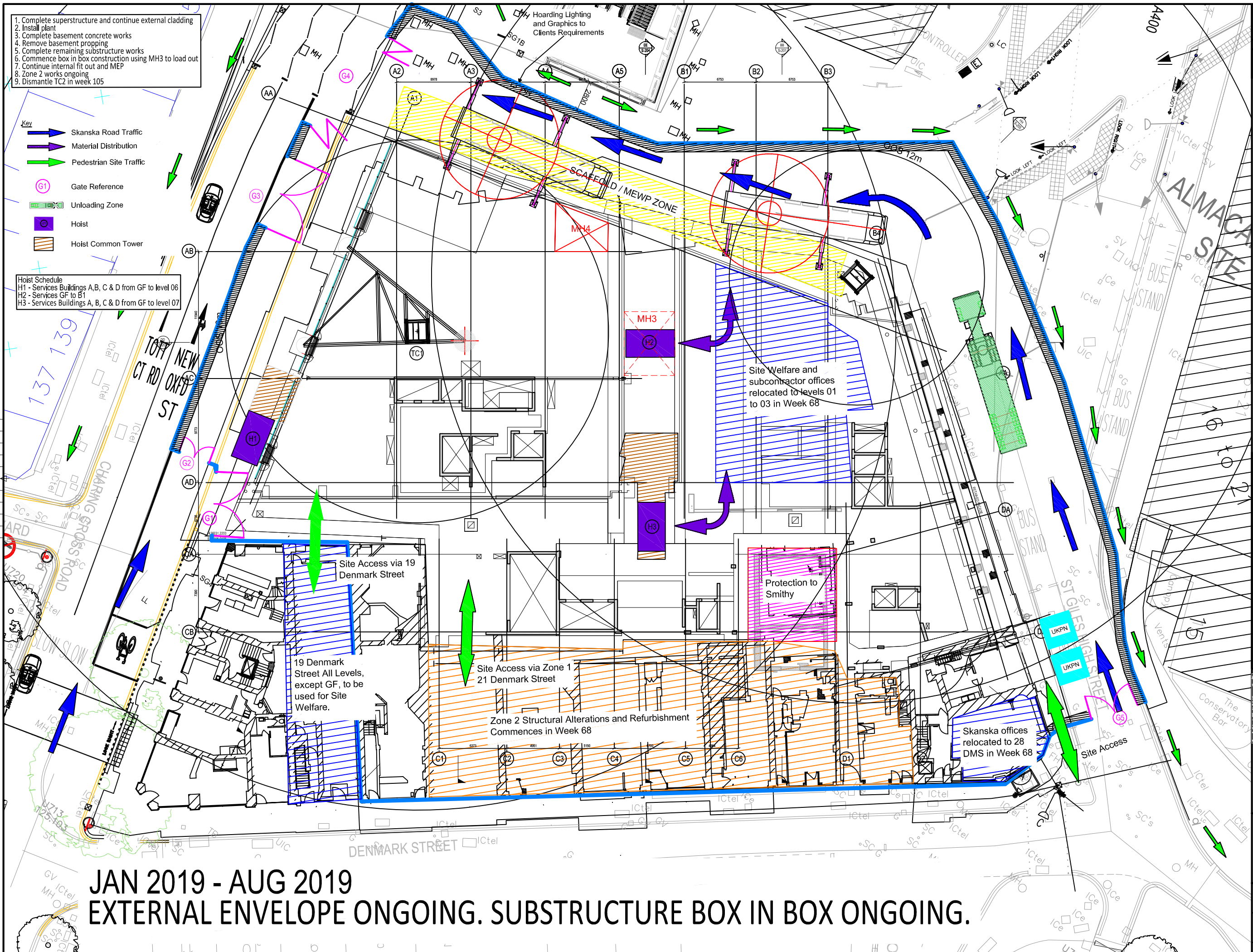

JAN 2019 - AUG 2019
EXTERNAL ENVELOPE ONGOING. SUBSTRUCTURE BOX IN BOX ONGOING.

Consolidated Developments Limited

SKANSKA

ST GILES CIRCUS, LONDON WC1

ZONE 1 & 2 LOGISTICS STAGE 6	
Wks 86 - 118 (Jan19 - Aug 19)	08/12/16
SKA-LOG-006	00

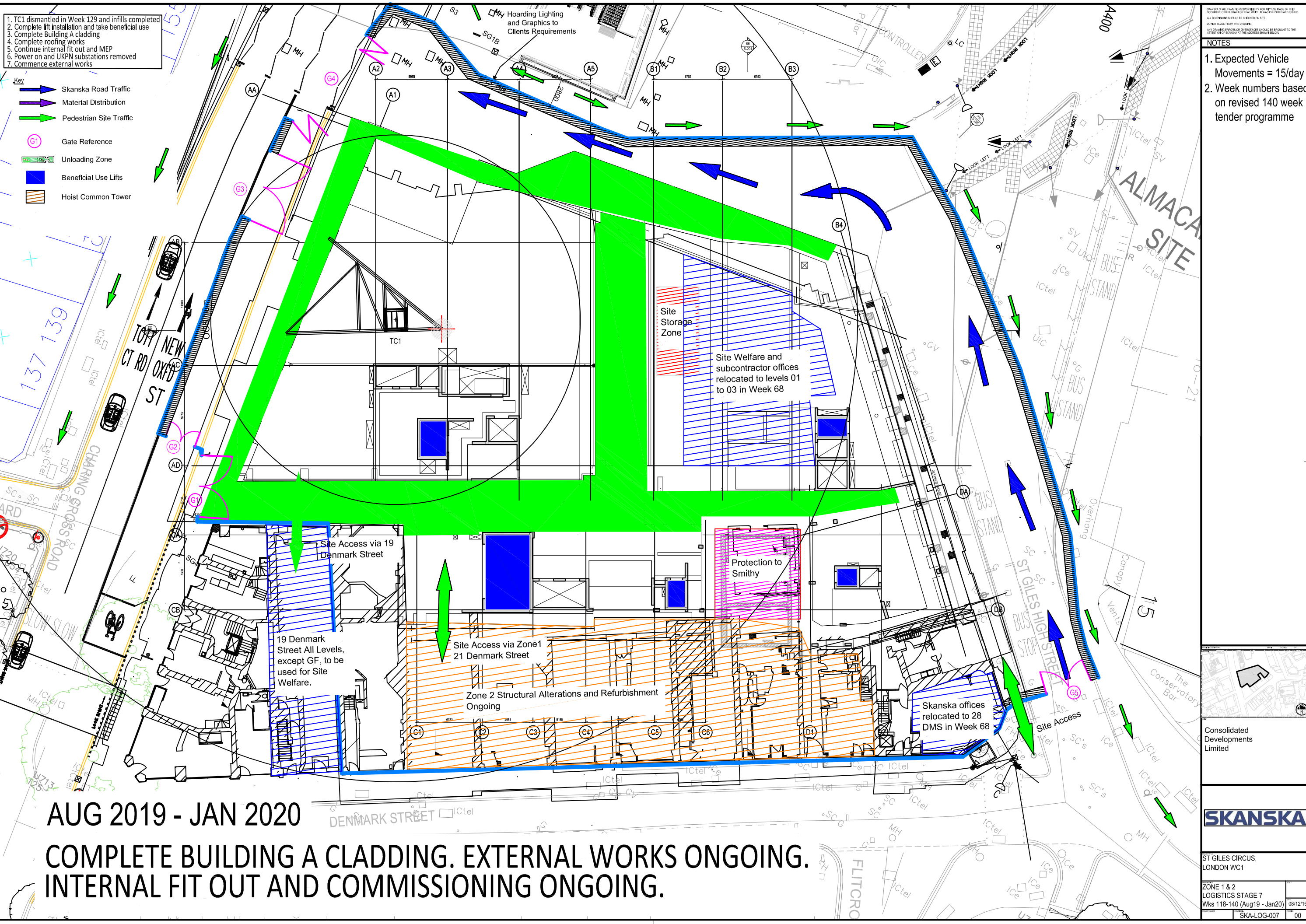

- 1. TC1 dismantled in Week 129 and infills completed
- 2. Complete lift installation and take beneficial use
- 3. Complete Building A cladding
- 4. Complete roofing works
- 5. Continue internal fit out and MEP
- 6. Power on and UKPN substations removed
- 7. Commence external works

- Key
- Skanska Road Traffic
 - Material Distribution
 - Pedestrian Site Traffic
 - Gate Reference
 - Unloading Zone
 - Beneficial Use Lifts
 - Hoist Common Tower

- NOTES
1. Expected Vehicle Movements = 15/day
 2. Week numbers based on revised 140 week tender programme

AUG 2019 - JAN 2020

COMPLETE BUILDING A CLADDING. EXTERNAL WORKS ONGOING.
INTERNAL FIT OUT AND COMMISSIONING ONGOING.

Consolidated Developments Limited

SKANSKA

ST GILES CIRCUS, LONDON WC1

ZONE 1 & 2 LOGISTICS STAGE 7
Wks 118-140 (Aug19 - Jan20) 08/12/16

SKA-LOG-007 00