

Door Reference	MW-01E-A	MW-01E-B	MW-02C-B	MW-02D-A	MW-02D-B	MW-03C-A	MW-03C-B	MW-03D-A	MW-03D-B	MW-04H-A	MW-04H-B	MW-05B-B	MW-06K-A		
Location	APARTMENT ENTRANCE	APARTMENT ENTRANCE	ROOM DOOR	ROOM DOOR	ROOM DOOR	ROOM DOOR	BATHROOM/ ENSUITE	BATHROOM/ ENSUITE	BATHROOM/ ENSUITE	BATHROOM/ ENSUITE	BATHROOM/ ENSUITE	UTILITY	UTILITY	CUPBOARD/ STORE	ROOM DOOR
Quantity	10	4	1	1	30	26	1	1	1	13	4	1	1		
Fire Rating*	FD30s	FD30s	FD20	FD20	FD20	FD20	Zero	Zero	Zero	Zero	FD20	FD20	FD20		
Nominal Leaf Size W x H (Excluding undercut)	914x2,300	914x2,100	762x2,100	762x2,300	838x2,300	838x2,100	762x2,300	762x2,100	762x2,300	838x2,300	838x2,100	1,372x2,300	1,372x2,100	610x2,100	1,524x2,300
View from Opening Side															
Status	New Door	New Door	New Door	New Door	New Door	New Door	New Door	New Door	New Door	New Door	New Door	New Door	New Door	New Door	New Door
Glazing	N/A	N/A	N/A	N/A	N/A	N/A	N/A	N/A	N/A	N/A	N/A	N/A	N/A	N/A	N/A
Colour	Refer to finishes schedule.	Refer to finishes schedule.	Refer to finishes schedule.	Refer to finishes schedule.	Refer to finishes schedule.	Refer to finishes schedule.	Refer to finishes schedule.	Refer to finishes schedule.	Refer to finishes schedule.	Refer to finishes schedule.	Refer to finishes schedule.	Refer to finishes schedule.	Refer to finishes schedule.	Refer to finishes schedule.	Refer to finishes schedule.
Description	3 no paneled timber door - Windsor 3A by Ahmarra	3 no paneled timber door - Windsor 3A by Ahmarra	3 no paneled timber door - Windsor 3A by Ahmarra	3 no paneled timber door - Windsor 3A by Ahmarra	3 no paneled timber door - Windsor 3A by Ahmarra	3 no paneled timber door - Windsor 3A by Ahmarra	3 no paneled timber door - Windsor 3A by Ahmarra	3 no paneled timber door - Windsor 3A by Ahmarra	3 no paneled timber door - Windsor 3A by Ahmarra	3 no paneled timber door - Windsor 3A by Ahmarra	3 no paneled timber door - Windsor 3A by Ahmarra	3 no paneled timber door - Windsor 3A by Ahmarra	3 no paneled timber door - Windsor 3A by Ahmarra	3 no paneled timber door - Windsor 3A by Ahmarra	3 no paneled timber door - Windsor 3A by Ahmarra
Ironmongery	New ironmongery to be matched in style through out the building.	New ironmongery to be matched in style through out the building.	New ironmongery to be matched in style through out the building.	New ironmongery to be matched in style through out the building.	New ironmongery to be matched in style through out the building.	New ironmongery to be matched in style through out the building.	New ironmongery to be matched in style through out the building.	New ironmongery to be matched in style through out the building.	New ironmongery to be matched in style through out the building.	New ironmongery to be matched in style through out the building.	New ironmongery to be matched in style through out the building.	New ironmongery to be matched in style through out the building.	New ironmongery to be matched in style through out the building.	New ironmongery to be matched in style through out the building.	New ironmongery to be matched in style through out the building.

INTERNAL DOOR NOTES:

All Doors CONTRACTORS, SUB-CONTRACTORS AND MANUFACTURERS TO ENSURE THAT ALL MATERIALS AND COMPONENTS ARE SUITABLE FOR THEIR INTENDED PURPOSE AND LOCATION. DESIGNED, MANUFACTURED AND INSTALLED IN ACCORDANCE WITH ALL RELEVANT CURRENT BRITISH STANDARDS, CODES OF PRACTICE, AND MANUFACTURER'S SPECIFICATIONS.

Any reference to an Approved Document in this Specification relates to the relevant Approved Document of the Building Regulations.

All door leaf sizes shown exclude undercuts and packing zones.

All existing and proposed structural openings, frames, door leaves and associated structures (ceilings, stairs, etc) to be confirmed on site prior to manufacture.

For door handing, refer to GA Plans.

Sliding Doors
Scheduled sliding door widths and height are shown as the visible width only. Manufacturer to advise on actual width and height required. Sliding door gear, pockets and jambs to be confirmed and sized prior to manufacture to ensure structural openings are adequate

Fire Doors
All FD30 doors to receive smoke seals and intumescent strips.

All fire door sets to meet all requirements of BS 5588. Fire door sets to be tested to meet BS 476-22 or BS EN4967 and supplied with product conformity certificates.

Door linings, stops, vision panels, cold smoke seals (denoted by the 's' suffix) etc., all to meet doors manufacturers standard fire tested details to achieve fire ratings as noted.

Door schedules to be read in conjunction with relevant joinery details.

* For ALL apartment doors, refer to Fire Drawings

Ironmongery
All ironmongery TBC.

Plant room doors to meet BS 3621 and engineers requirements.

Cycle store doors to have PAS 24 doors (or LPS 175 Security 2) and fob access.

Door Finishes:
Refer to finishes schedule.

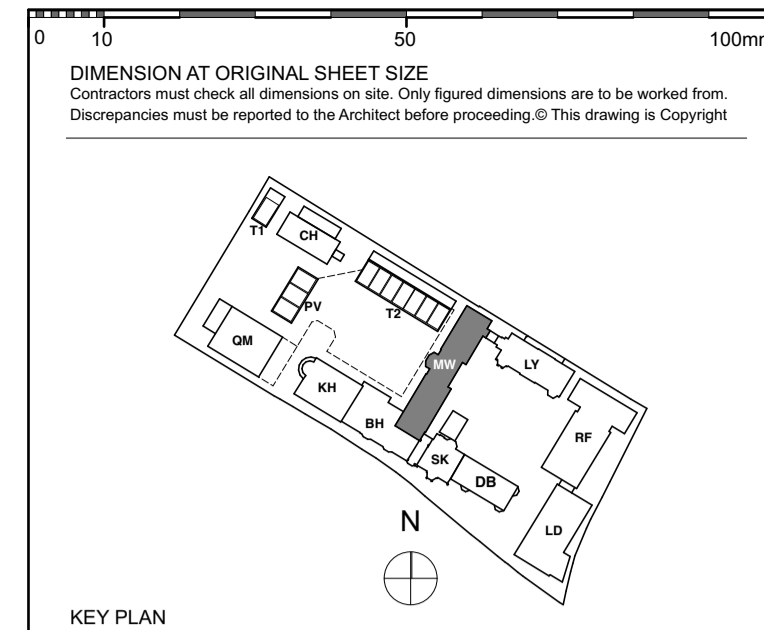

KEY PLAN

NOTE: ALL INFORMATION SHOWN ON THIS DRAWINGS IS SUBJECT TO DESIGN DEVELOPMENT

ALL DIMENSIONS ARE FOR GUIDELINES ONLY - ALL DIMENSIONS TO BE CHECKED ON SITE PRIOR MANUFACTURING

Door Reference	MW-06K-B	MW-07C-A	MW-07D-A	MW-07D-B	MW-09H	MW-10D	MW-11B	MW-11C-A	MW-11C-B	MW-11D-B	MW-12K-A			
Location	ROOM DOOR	BATHROOM/ ENSUITE	BATHROOM/ ENSUITE	BATHROOM/ ENSUITE	BATHROOM/ ENSUITE	RISER CUPBOARD	STAIR CORE	STAIR CORE	STAIR CORE	RISER CUPBOARD	RISER CUPBOARD	RISER CUPBOARD	ROOM DOOR	
Quantity	1	3	1	1	2	4	1	2	1	4	1	2		
Fire Rating*	FD20	Zero	Zero	Zero	Zero	FD30s	FD30s	FD30s	FD30s	FD30s	FD30s	FD20		
Nominal Leaf Size W x H (Excluding undercut)	1,524x2,100	762x2,300	838x2,300	762x2,100	838x2,100	1,372x2,300	838x2,100	838x2,300	838x2,300	610x2,300	762x2,300	762x2,100	838x2,100	1,524x2,300
View from Opening Side														
Status	New Double Door	New Door	New Door	New Door	New Door	New Double Door	New Door	New Door	New Door	New Door	New Door	New Door	New Door	New Double Door
Glazing	N/A	N/A	N/A	N/A	N/A	N/A	7mm Pyrobelite	7mm Pyrobelite	7mm Pyrobelite	N/A	N/A	N/A	N/A	N/A
Colour	Refer to finishes schedule.	Refer to finishes schedule.	Refer to finishes schedule.	Refer to finishes schedule.	Refer to finishes schedule.	Refer to finishes schedule.	Refer to finishes schedule.	Refer to finishes schedule.	Refer to finishes schedule.	Refer to finishes schedule.	Refer to finishes schedule.	Refer to finishes schedule.	Refer to finishes schedule.	Refer to finishes schedule.
Description	3 no paneled timber double doors - Windsor 3AD by Ahmarra	Flush Paneled Timber Bathroom Sliding Door - Enigma by Selo	Flush Paneled Timber Bathroom Sliding Door - Enigma by Selo	Flush panel timber sliding door by Selo. Leaf to be chamfered as required by skilling line.	Flush Paneled Timber Bathroom Sliding Door - Enigma by Selo	3 no paneled timber double doors - Windsor 3AD by Ahmarra	3 no Glazed paneled timber door - Windsor 3AG by Ahmarra	3 no Glazed paneled timber door - Windsor 3AG by Ahmarra	3 no Glazed paneled timber door - Windsor 3AG by Ahmarra	3 no paneled timber door - Windsor 3A by Ahmarra	3 no paneled timber door - Windsor 3A by Ahmarra	3 no paneled timber door - Windsor 3A by Ahmarra	3 no paneled timber door - Windsor 3A by Ahmarra	3 no paneled timber door - Windsor 3A by Ahmarra
Ironmongery	New ironmongery to be matched in style through out the building.	New ironmongery to be matched in style through out the building.	New ironmongery to be matched in style through out the building.	New ironmongery to be matched in style through out the building.	New ironmongery to be matched in style through out the building.	New ironmongery to be matched in style through out the building.	New ironmongery to be matched in style through out the building.	New ironmongery to be matched in style through out the building.	New ironmongery to be matched in style through out the building.	New ironmongery to be matched in style through out the building.	New ironmongery to be matched in style through out the building.	New ironmongery to be matched in style through out the building.	New ironmongery to be matched in style through out the building.	New ironmongery to be matched in style through out the building.

Door Reference	MW-14K-A	MW-15D-A	MW-15D-B	MW-16C-B	MW-17H-B
Location	ROOM DOOR	ROOM DOOR	ROOM DOOR	RISER CUPBOARD	RISER CUPBOARD
Quantity	2	2	1	1	1
Fire Rating*	FD20	FD20	FD20	FD30s	FD30s
Nominal Leaf Size W x H (Excluding undercut)	1,524x2,300	838x2,300	838x2,100	762x2,100	1,372x2,100
View from Opening Side					
Status	New Double Door	New Door with side lights	New Door with side lights	New Door	New Double Door
Glazing	Pyrobel 16 multi-laminated glass	Laminated safety glass to contractors specification	Laminated safety glass to contractors specification	N/A	N/A
Colour	Refer to finishes schedule.	Refer to finishes schedule.	Refer to finishes schedule.	Refer to finishes schedule.	Refer to finishes schedule.
Description	Feature glazed double doors with parliament hinges	Single Timber 3 paneled door-Windsor 3AG by Ahmarra - with glazing 5 panel glazed panel to each side.	Single Timber 3 paneled door-Windsor 3AG by Ahmarra - with glazing 5 panel glazed panel to each side.	Flush panel door	Flush panel double doors
Ironmongery	New ironmongery to be matched in style through out the building.	New ironmongery to be matched in style through out the building.	New ironmongery to be matched in style through out the building.	New ironmongery to be matched in style through out the building.	New ironmongery to be matched in style through out the building.

FOR TENDER

REVISION	DRN	CHKD	DATE
1 First Issue	KVC	KC	29/07/2016
T1 Proposed Approach rates amended to Internal Doors. Issue for tender.	MRR	TW	08/09/2016
T2 Door sizes amended and information added to match finishes schedule.	MRR	TW	04/11/2016
T3 Door/Window References updated New door types added Door quantities revised Door size/configuration revised	MRR	TW	23/11/2016



PROJECT
KIDDEPORE AVENUE

DRAWING
Maynard Wing
Internal Door Types

SCALE NTS @ A1 DATE November 2016

DRAWING No. 15 230 DRAWN BY MRR
9000-SCH-MW-006 REV T3

A & Q PARTNERSHIP (LONDON) LTD
THE LUX BUILDING, 2-4 HOXTON SQUARE, LONDON N1 6 NU
Tel: 020 7613 2244 Fax: 020 7613 2642 Email: london@aqp.co.uk
ARCHITECTURE DESIGN MASTERPLANNING INTERIORS