

GA Plan Key		
Gully / Sump	SVP	Manhole
Indicative Slab hole	SVP/RWP below	
Wall type tag	Indicative SVP/RWP route	
Air Brick vent	Coordinate point	
RWP - Existing	Radiator	
RWP - New	Heated Towel Rail	

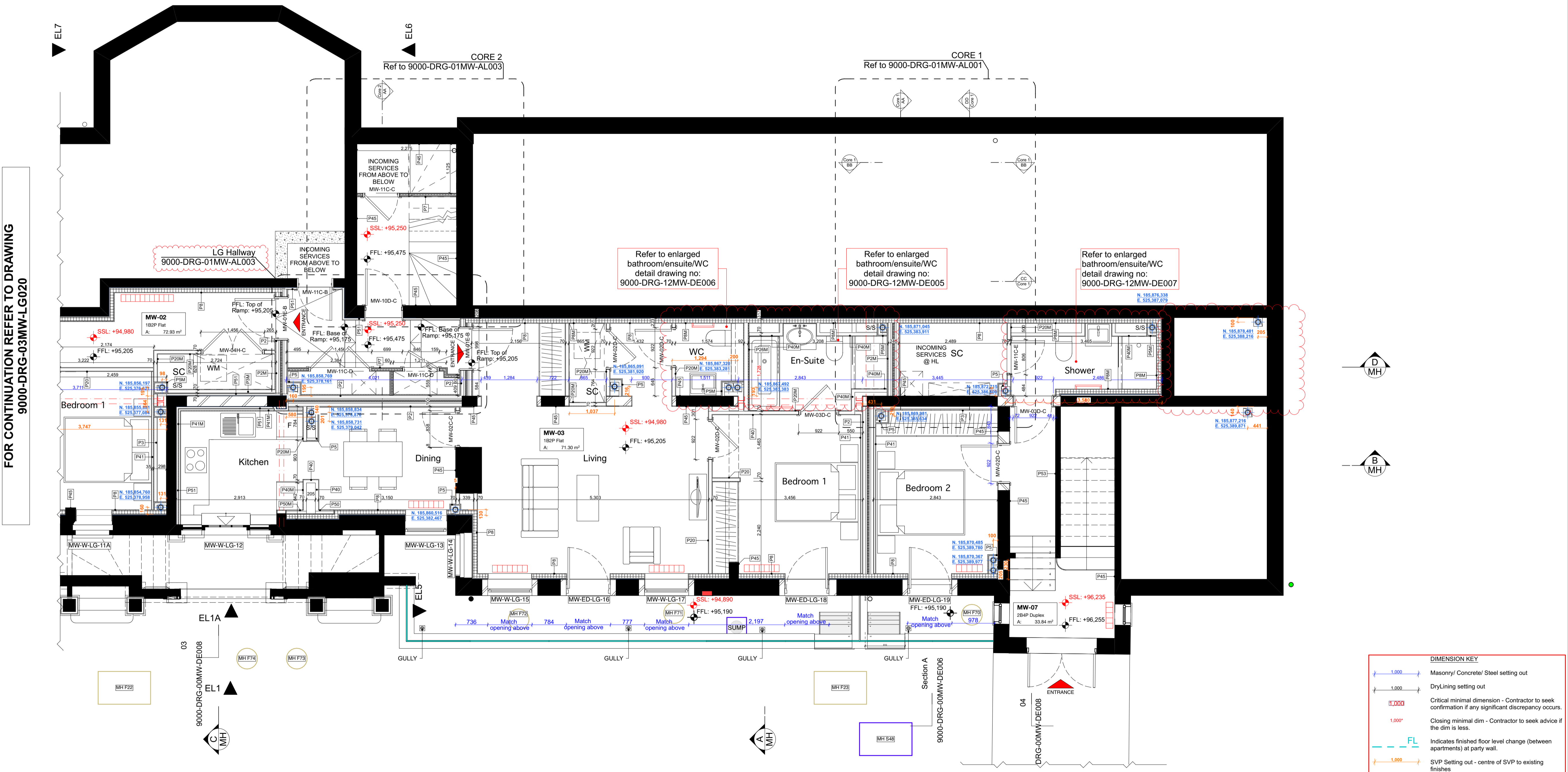

FOR CONTINUATION REFER TO DRAWING 9000-DRG-03MW-LG020

<p>Finishes Legend: External and Separating Wall Lining Types: Type P1: External Mosaic Wall - 2 layers of 15mm British Gypsum SoundBloc on Vapour Control layer. All joints to be taped and jointed, giving a smooth and seamless finish ready for decoration. Type P1M: As type P1, but with outer layer replaced with 15mm Gyproc SoundBloc Moisture Resistant plasterboard. Type P2: Typical Gyproc Quiet IWL Separating Wall - 2 layers of 15mm British Gypsum SoundBloc or similar to each side. All joints to be taped and jointed, giving a smooth and seamless finish ready for decoration. Type P2M: As type P2, but with outer layer replaced with 15mm Gyproc SoundBloc Moisture Resistant plasterboard ('wet' side). Type P2M2: As type P2, but with outer layers replaced with 15mm Gyproc SoundBloc Moisture Resistant plasterboard (both sides). Type P3 / P3A: Independent Wall Lining. Generally to cores - Width varies, depending on wall height - 70 / 90mm Gypliner 'IWL' at 600mm centres with 1 layer of 15mm British Gypsum Gyproc SoundBloc. Fully filled with unfaced mineral wool with min. density 10kg/m³ between studs. All joints to be taped and jointed, giving a smooth and seamless finish, ready for decoration. Type P3M / P3AM: As type P3, but with outer layer replaced with 15mm Gyproc SoundBloc Moisture Resistant plasterboard ('wet' side). Type P4: Thermal Lining to existing buildings (upper floors) - Gypliner Universal GL1 channels at 600mm centres (packed with 50mm Kooltherm K12 board - insulation notched where required) with 32.5mm Kooltherm K118 (20mm rigid insulation with 12.5mm Plasterboard with integrated VCL). All joints to be taped and jointed, giving a smooth and seamless finish, ready for decoration. Type P4M: Thermal Lining to existing buildings to Wet areas (upper floors) - Gypliner Universal GL1 channels at 600mm centres with 32.5mm timber studs, 82.5mm Kooltherm K12 board - insulation notched where required with 12.5mm Gyproc Wallboard Moisture Resistant. All joints to be taped and jointed, giving a smooth and seamless finish, ready for decoration. Type P5 & P5M: SVP Boxing, 2 no. layers 15mm SoundBloc plasterboard, on 60mm Gypliner studwork generally to top casings. All joints to be taped and jointed, giving a smooth and seamless finish, ready for decoration. Pipework to be wrapped in 50mm unfaced mineral wool. NB, 15mm SoundBloc MR to replace outer layer of boxing in 'Wet' areas (Bathrooms, WCs, Utility Cupboards, Kitchens etc). Boxings to be fully filled with insulation when adjoining solid party walls. Type P6: Separating Wall Gyproc Quiet IWL (Community Facility) - 2 no. layer of 15mm British Gypsum Duraline (both sides). All joints to be taped and jointed, giving a smooth and seamless finish ready for decoration. Type P7: Service Riser Wall (Shaftwall) FR60 minutes - 2 layers Fireline, 25mm Isovol APR200, 20mm Gyproc coreboard on Gypliner 80 studs at 600mm centres. All joints to be taped and jointed, giving a smooth and seamless finish ready for decoration. Type P8: Thermal Independent Wall Lining with Drained cavity (generally to existing buildings - Basements) - Gypliner IWL at 600mm centres with 1 layer of 12.5mm British Gypsum Gyproc Wallboard on 92 studs. Fully filled with unfaced mineral wool, density 10kg/m³ between studs. All joints to be taped and jointed, giving a smooth and seamless finish, ready for decoration. Type P9: Load-bearing studwork to external Wall (Roofline Franklin) 2 no. layers of 15mm British Gypsum SoundBloc on Vapour Control layer. All joints to be taped and jointed, giving a smooth and seamless finish ready for decoration. Type P9M: As type P9, but with SoundBloc replaced with 15mm Gyproc SoundBloc Moisture Resistant plasterboard ('wet' side). Type P10: Separating Wall Gyproc Quiet IWL (Partitions) - 2 no. layer of 15mm British Gypsum SoundBloc or similar to both sides. All joints to be taped and jointed, giving a smooth and seamless finish ready for decoration. Type P10M: As type P10, but with one side of SoundBloc replaced with 12.5mm Gyproc SoundBloc Moisture Resistant plasterboard ('wet' side). Internal Partitions: Type P20: Internal Partition width 97mm, 70mm Gypliner 'C' studs at max. 600mm centres with 1 layer of 12.5mm British Gypsum Gyproc SoundBloc to both sides. All joints to be taped and jointed, giving a smooth and seamless finish, ready for decoration. Type P20M: As type P20, but with one side of SoundBloc replaced with 12.5mm Gyproc SoundBloc Moisture Resistant plasterboard ('wet' side). Type P20M2: As type P20, but with both layers replaced with 12.5mm Gyproc SoundBloc Moisture Resistant plasterboard (both sides). Type P21: Internal Partition width 155mm, 92mm Gypliner 'C' studs at max. 600mm centres with 2 layers of 12.5mm British Gypsum Gyproc SoundBloc to each side. All joints to be taped and jointed, giving a smooth and seamless finish, ready for decoration. Type P21M: As type P21, but with one side of SoundBloc replaced with 12.5mm Gyproc SoundBloc Moisture Resistant plasterboard ('wet' side). Type P21M2: As type P21, but with both layers replaced with 12.5mm Gyproc SoundBloc Moisture Resistant plasterboard (both sides). Type P22: Timber stud braced wall, 100mm timber studs at 600mm centres with 1 layer of 18mm Plywood to each side and 1 layer of 12.5mm Gyproc SoundBloc plasterboard to both sides. All joints to be taped and jointed, giving a smooth and seamless finish, ready for decoration. Type P22M: As type P22, but with one side of SoundBloc replaced with 12.5mm Gyproc SoundBloc Moisture Resistant plasterboard ('wet' side). Type P23: Timber stud braced wall, 140mm timber studs at 600mm centres with 1 layer of 18mm Plywood to both sides and 1 layer of 12.5mm Gyproc SoundBloc plasterboard to both sides. All joints to be taped and jointed, giving a smooth and seamless finish, ready for decoration. Type P23M: As type P23, but with one side SoundBloc replaced with 12.5mm Gyproc SoundBloc Moisture Resistant plasterboard ('wet' side). Type P23M2: As type P23, but with both side of SoundBloc replaced with 12.5mm Gyproc SoundBloc Moisture Resistant plasterboard ('wet' side). Type P24: Internal Partition width 122mm, 70mm Gypliner 'C' studs at max. 600mm centres with 2 layers of 12.5mm British Gypsum Gyproc SoundBloc on 18mm Plywood to both sides. All joints to be taped and jointed, giving a smooth and seamless finish, ready for decoration. Type P24M: As type P24, but with one side of SoundBloc replaced with 12.5mm Gyproc SoundBloc Moisture Resistant plasterboard ('wet' side). Type P25: Timber Stud Wall (Queen Mothers Hall) 100mm Stud with 1 layer of 12.5mm British Gypsum Gyproc Wallboard. All joints to be taped and jointed, giving a smooth and seamless finish ready for decoration. Type P25M: As type P25, but with 'wet' side plasterboard replaced with 12.5mm Gyproc Wallboard Moisture Resistant board. Type P26M: Internal Partition width 129mm, 50mm Gypliner 'C' studs at max. 600mm centres with 1 layer of 12.5mm Gyproc SoundBloc Moisture Resistant plasterboard on 12mm Plywood to one side with 1 layer of 12.5mm Gyproc SoundBloc Moisture Resistant plasterboard on opposite side. All joints to be taped and jointed, giving a smooth and seamless finish, ready for decoration. Type P41M: As type P41 but with the layer of Plasterboard replaced with Gyproc Moisture Resistant plasterboard to 'wet' area. Type P42: Typical Sacrificial Wall (Generally for 40mm Drainage runs) - Gypliner Universal GL1 channel with offset of 75mm at 600mm centres (GL2 fixing brackets) with 1 layer of 12.5mm British Gypsum wallboard. All joints to be taped and jointed, giving a smooth and seamless finish, ready for decoration. Type P42M: As type P42 but with the layer of Plasterboard replaced with Gyproc Moisture Resistant plasterboard to 'wet' area. Type P43: Typical Sacrificial Wall (Generally for WC Drainage runs) - Gypliner Universal GL1 channel with offset of 122mm at 600mm centres (GL2 fixing brackets) with 1 layer of 12.5mm British Gypsum wallboard. All joints to be taped and jointed, giving a smooth and seamless finish, ready for decoration. Type P43M: As type P43 but with the layer of Plasterboard replaced with Gyproc Moisture Resistant plasterboard to 'wet' area. Internal Linings & Boxing Types: Type P46: Typical Boxing and False Wall - 70mm Gypliner 'C' studs at max. 600mm centres with 1 layer of 12.5mm British Gypsum Wallboard to one side. All joints to be taped and jointed, giving a smooth and seamless finish, ready for decoration. Type P47: Lining to cavity brick, separating walls - 1 layer of 12.5mm British Gypsum wallboard on 10mm adhesive dabs on 8mm parge coat (Gyproc SoundBloc Plus). All joints to be taped and jointed, giving a smooth and seamless finish, ready for decoration. Type P48M: As type P48 but with the layer of Plasterboard replaced with Gyproc Moisture Resistant plasterboard to 'wet' area. Type P49M: As type P49 but with outer layer replaced by 12.5mm SoundBloc MR Board on dabs. All joints to be taped and jointed, giving a smooth and seamless finish ready for decoration. Type P45M: As type P45 but with outer layer replaced by 12.5mm SoundBloc MR Board on dabs. All joints to be taped and jointed, giving a smooth and seamless finish ready for decoration. Type P46M: As type P46 but with the layer of Plasterboard replaced with Gyproc Moisture Resistant plasterboard to 'wet' area. Type P47M: As type P47 but with the layer of Plasterboard replaced with Gyproc Moisture Resistant plasterboard to 'wet' area. Type P48M: As type P48 but with outer layer replaced by 12.5mm SoundBloc MR Board on dabs. All joints to be taped and jointed, giving a smooth and seamless finish ready for decoration. Type P49M: As type P49 but with outer layer replaced by 12.5mm SoundBloc MR Board on dabs. All joints to be taped and jointed, giving a smooth and seamless finish ready for decoration. Type P46M: As type P46 but with the layer of Plasterboard replaced with Gyproc Moisture Resistant plasterboard to 'wet' area. Type P47M: As type P47 but with the layer of Plasterboard replaced with Gyproc Moisture Resistant plasterboard to 'wet' area. Type P48M: As type P48 but with outer layer replaced by 12.5mm SoundBloc MR Board on dabs. All joints to be taped and jointed, giving a smooth and seamless finish ready for decoration. Type P49M: As type P49 but with outer layer replaced by 12.5mm SoundBloc MR Board on dabs. All joints to be taped and jointed, giving a smooth and seamless finish ready for decoration. Type P46M: As type P46 but with the layer of Plasterboard replaced with Gyproc Moisture Resistant plasterboard to 'wet' area. Type P47M: As type P47 but with the layer of Plasterboard replaced with Gyproc Moisture Resistant plasterboard to 'wet' area. Type P48M: As type P48 but with outer layer replaced by 12.5mm SoundBloc MR Board on dabs. All joints to be taped and jointed, giving a smooth and seamless finish ready for decoration. Type P49M: As type P49 but with outer layer replaced by 12.5mm SoundBloc MR Board on dabs. All joints to be taped and jointed, giving a smooth and seamless finish ready for decoration. </p>	<p>General Lintel heights are as follows or as noted otherwise: LG lintels to be approx 2180mm from proposed FFL UG lintels to be 2380mm from proposed FFL Level 01 lintels to be 2380mm from proposed FFL Level 02 lintels to be 2180mm from proposed FFL Level 03 lintels to be 2180mm from proposed FFL All Lintel heights to be confirmed prior to installation. Note: SSL spot levels shown are assumed levels. Any variation in existing SSL to be confirmed and reported back to architect prior to commencement of work. FFL levels may vary depending on construction of existing floors. Note: Radiators shown are indicative only. Final positions and sizes TBC.</p> <p>REVISION</p> <table border="1"> <thead> <tr> <th>REVISION</th> <th>DRN</th> <th>CHKD</th> <th>DATE</th> </tr> </thead> <tbody> <tr> <td>C1</td> <td>MRR</td> <td>TW</td> <td>31/01/2017</td> </tr> <tr> <td>C2</td> <td>MRR</td> <td>TW</td> <td>10/02/2017</td> </tr> <tr> <td>C3</td> <td>MRR</td> <td>TW</td> <td>17/02/2017</td> </tr> </tbody> </table> <p>DIMENSION KEY</p> <ul style="list-style-type: none"> → 1.000 ← Masonry/ Concrete/ Steel setting out → 1.000 ← DryLining setting out → 1.000 ← Critical minimal dimension - Contractor to seek confirmation if any significant discrepancy occurs. → 1.000 ← Closing minimal dim - Contractor to seek advice if the dim is less. --- FL --- Indicates finished floor level change (between apartments) at party wall. → 1.000 ← SVP Settling out - centre of SVP to existing finishes 	REVISION	DRN	CHKD	DATE	C1	MRR	TW	31/01/2017	C2	MRR	TW	10/02/2017	C3	MRR	TW	17/02/2017
REVISION	DRN	CHKD	DATE														
C1	MRR	TW	31/01/2017														
C2	MRR	TW	10/02/2017														
C3	MRR	TW	17/02/2017														

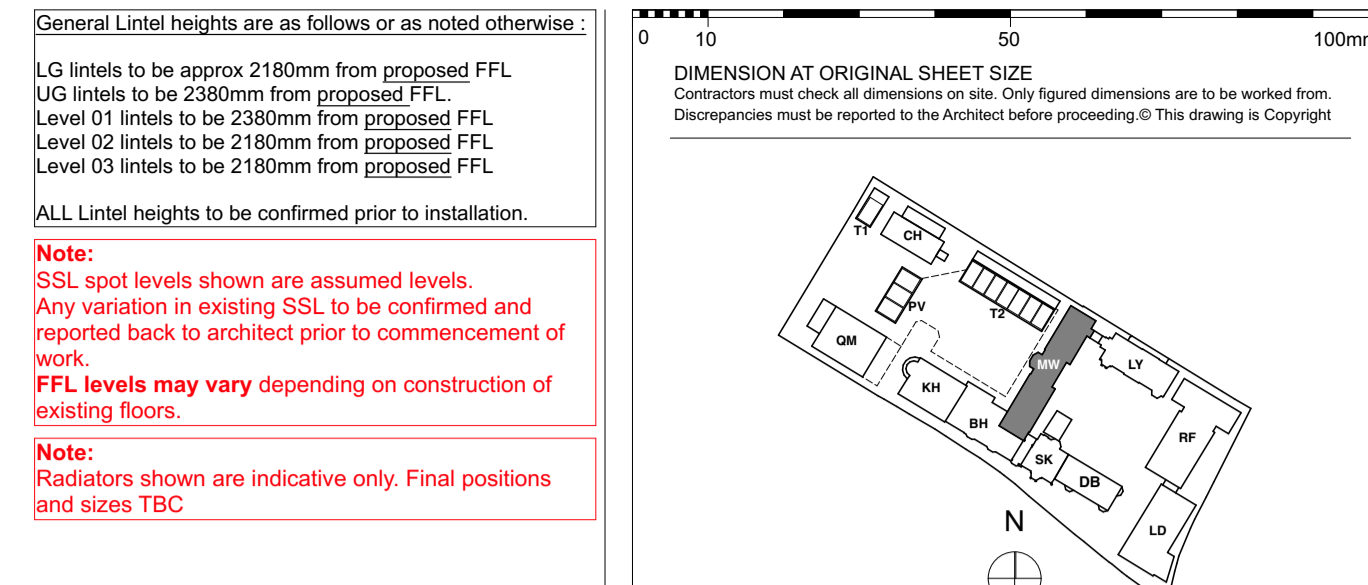

KEY PLAN

NOTE:
 ALL INFORMATION SHOWN ON THIS DRAWING IS SUBJECT TO DESIGN DEVELOPMENT

General Notes:

- All types noted below are based on the British Gypsum range. 'Similar and approved' products will be considered by the client. Any alterations to the specifications below are to be approved by the client PRIOR to order.
- Drying drawings are to be read in conjunction with all relevant AQP GA and M&E consultant drawings.
- Moisture resistant plasterboard is to be used in all wet areas (Kitchens, Bathrooms, En-suites and Utility Cupboards). Areas requiring moisture resistant board are identified with the 'M' prefix in the partition type. Tiled surfaces: MR Plasterboard to be replaced with 12.5mm Glasroc H Tilebacker boards.
- 18mm WBP plywood support presses on proprietary service plates are to be provided in the following areas:
 - Kitchens (Full height)
 - Bathrooms (A band between 300-1800mm)
 - Living Rooms (1500mm wide) x 1035mm high behind wall mounted TV positions, exact locations to be agreed on site with client).
- Additional noggings/supports etc are to be provided as necessary for radiators, kitchen units, wall mounted TVs, shower mixers & diverters, etc.
- Deflection head details are indicated at partition heads giving min. vertical deflection allowance of 25mm. Extra deep flange channels and packing to be provided in accordance with manufacturers standard details.
- All necessary beads etc. to be provided.

General Internal Suspended Ceiling [Newbuild]:
 British Gypsum Casoline MF ceiling system finished with 1 no. 12.5mm Wallboard in 'dry areas' and 12.5mm moisture resistant wallboard in 'wet areas'. Gypliner MFR strap hangers to be fixed to slabs of concrete soffit with Gypliner M12 soffit cleats. Proprietary primary and secondary support grids to be provided at centres in accordance with manufacturers standard details. All perimeter channels etc. to be provided in accordance with manufacturers standard details. All joints to be taped and jointed, giving a smooth and seamless finish, ready for decoration.

FOR CONSTRUCTION

REVISION

REVISION	DRN	CHKD	DATE
C1	MRR	TW	31/01/2017
C2	MRR	TW	10/02/2017
C3	MRR	TW	17/02/2017



CLIENT
 MOUNT ANVIL LTD



PROJECT
 KIDDEPORE AVENUE

DRAWING
 Maynard Wing
 Level LG 1:50 Plan Sheet 2 of 2

SCALE 1:50 @ A1

DATE
Friday, 17 February 2017

DRAWING No.	DATE	DRAWN BY	REV
15 230		MRR	
9000-DRG-03MW-LG021			C3

A & Q PARTNERSHIP (LONDON) LTD
 THE LUX BUILDING, 2-4 HOXTON SQUARE, LONDON N1 6JU
 Tel: 020 7613 2244 Fax: 020 7613 2642 Email: london@aqp.co.uk
 ARCHITECTURE DESIGN MASTERPLANNING INTERIORS