

- GA Plan Key**
- Gully / Sump
 - Indicative Slab hole
 - Wall type tag
 - Air Brick vent
 - RWP - Existing
 - RWP - New
 - SVP
 - SVP/RWP below
 - Indicative SVP/RWP route
 - Coordinate point
 - Radiator
 - Heated Towel Rail

General Lintel heights are as follows or as noted otherwise:
 LG lintels to be approx 2180mm from proposed FFL
 UG lintels to be 2380mm from proposed FFL
 Level 01 lintels to be 2380mm from proposed FFL
 Level 02 lintels to be 2180mm from proposed FFL
 Level 03 lintels to be 2180mm from proposed FFL

Note:
 SSI spot levels shown are assumed levels.
 Any variation in existing SSL to be confirmed and reported back to architect prior to commencement of work.
FFL levels may vary depending on construction of existing floors.

Note:
 Radiators shown are indicative only. Final positions and sizes TBC

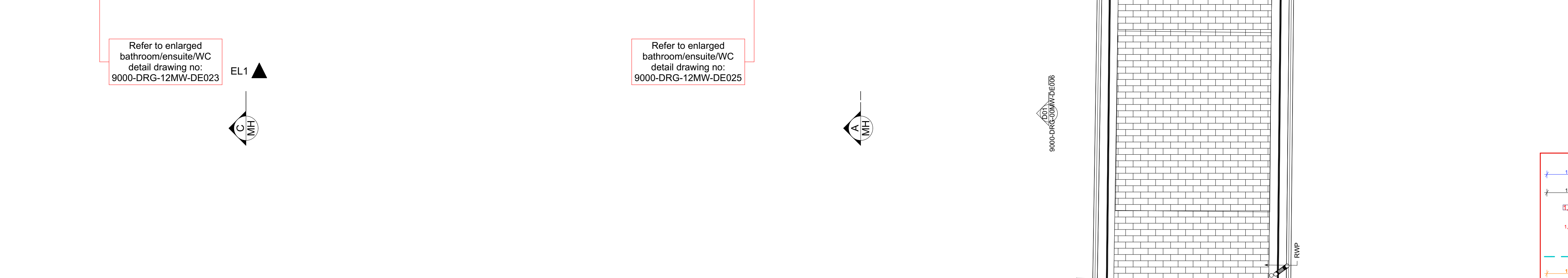
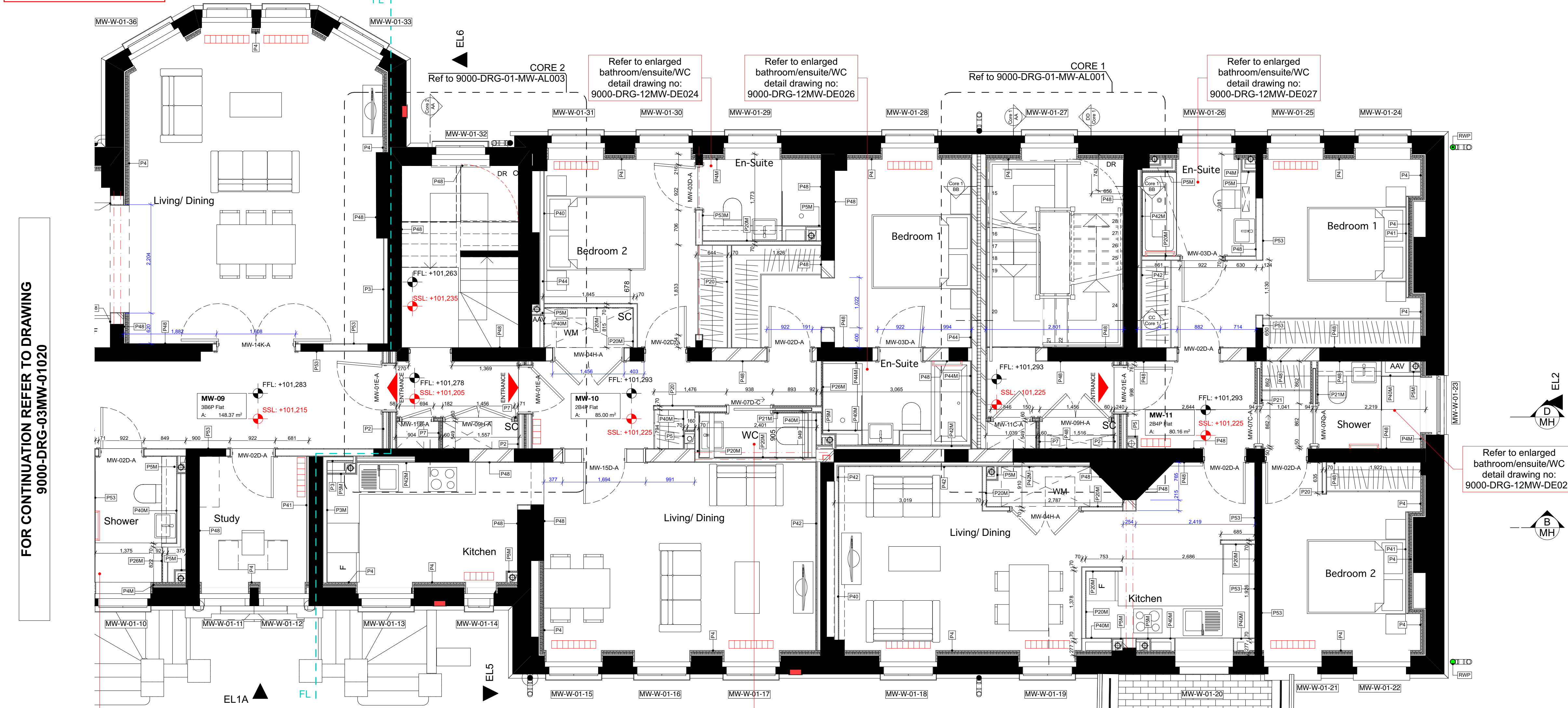
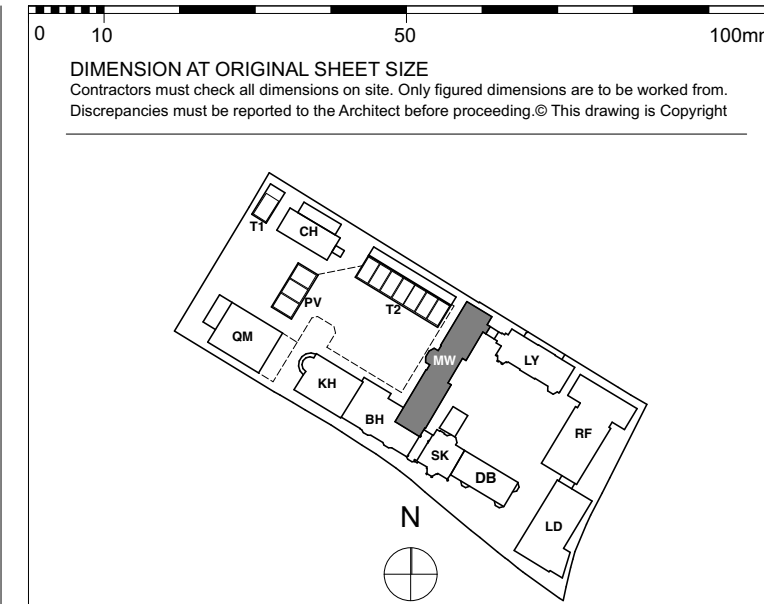

- Finishes Legend:**
External and Separating Wall Lining Types:
Type P1: External Masonry Wall - 2 layers of 15mm British Gyproc SoundBloc on Vapour Control layer. All joints to be taped and jointed, giving a smooth and seamless finish ready for decoration.
Type P1M: As type P1, but with outer layer replaced with 15mm Gyproc SoundBloc Moisture Resistant plasterboard.
Type P2: Typical Gyproc Quiet IWL Separating Wall - 2 layers of 15mm British Gyproc SoundBloc or similar to each side. All joints to be taped and jointed, giving a smooth and seamless finish ready for decoration.
Type P2M: As type P2, but with outer layer replaced with 15mm Gyproc SoundBloc Moisture Resistant plasterboard ('wet' side).
Type P2M2: As type P2, but with outer layers replaced with 15mm Gyproc SoundBloc Moisture Resistant plasterboard (both sides).
Type P3 / P3A: Independent Wall Lining. Generally to cores - Width varies, depending on wall height - 70 / 92mm Gyprolyne IWL at 600mm centres with 1 layer of 15mm British Gyproc Gyproc SoundBloc. Fully filled with unfaced mineralwool with min. density 10kg/m3 between studs. All joints to be taped and jointed, giving a smooth and seamless finish, ready for decoration.
Type P3M / P3A-M: As type P3, but with outer layer replaced with 15mm Gyproc SoundBloc Moisture Resistant plasterboard ('wet' side).
Type P4: Thermal Lining to existing buildings (upper floors) - Gyprolyne Universal GL1 channels at 600mm centres (packed with 50mm Kooltherm K12 board - insulation notched where required) with 32.5mm Kooltherm K118 (20mm rigid insulation with 12.5mm Plasterboard with integrated VCL). All joints to be taped and jointed, giving a smooth and seamless finish, ready for decoration. 32.5mm Kooltherm K118 to window reveals.
Type P4M: Thermal Lining to existing buildings to Wet areas (upper floors) - Gyprolyne Universal GL1 channels at 600mm centres with 32.5mm timber studs, 82.5mm Kooltherm K12 board - insulation notched where required with 12.5mm Gyproc Wallboard Moisture Resistant. All joints to be taped and jointed, giving a smooth and seamless finish, ready for decoration.
Type P5 & P5M: SVP Boxing, 2 no. layers 15mm SoundBloc plasterboard, on 60mm Gyproframe studwork generally to sup casings. All joints to be taped and jointed, giving a smooth and seamless finish, ready for decoration. Pipework to be wrapped in 50mm unfaced mineral wool. NB, 15mm SoundBloc MR to replace outer layer of boxing in 'Wet' areas (Bathrooms, WCs, Utility Cupboards, Kitchens, etc). Boings to be fully filled with insulation when adjoining solid party walls.
Type P6: Separating Wall Gyproc Quiet IWL (Community Facility) - 2 no. layer of 15mm British Gyproc Duralene (both sides). All joints to be taped and jointed, giving a smooth and seamless finish ready for decoration.
Type P7: Service Riser Wall (Shaftwall) FR60 minutes - 2 layers Fireline, 25mm Isovol APR1200, 20mm Gyproc coreboard on Gyproframe 80 studs at 600mm centres. All joints to be taped and jointed, giving a smooth and seamless finish ready for decoration.
Type P8: Thermal Independent Wall Lining with Drained cavity (generally to existing buildings - Basements) - Gyprolyne IWL at 600mm centres with 1 layer of 12.5mm British Gyproc Gyproc Wallboard on 92 studs. Fully filled with unfaced mineralwool, density 10kg/m3 between studs. All joints to be taped and jointed, giving a smooth and seamless finish, ready for decoration.
Type P8M: As type P8, but with Wallboard replaced with 12.5mm Gyproc Wallboard Moisture Resistant plasterboard.
Type P9: Load-bearing studwork to external Wall (Roofline Franklin) 2 no. layers of 15mm British Gyproc SoundBloc on Vapour Control layer. All joints to be taped and jointed, giving a smooth and seamless finish ready for decoration.
Type P9M: As type P9, but with SoundBloc replaced with 15mm Gyproc SoundBloc Moisture Resistant plasterboard.
Type P10: Separating Wall Gyproc Quiet IWL (Partitions) - 2 no. layer of 15mm British Gyproc SoundBloc or similar to each side. All joints to be taped and jointed, giving a smooth and seamless finish ready for decoration.
Type P10M: As type P10, but with one side of SoundBloc replaced with 15mm Gyproc SoundBloc Moisture Resistant plasterboard ('wet' side).
Type P10M2: As type P10, but with outer layers replaced with 15mm Gyproc SoundBloc Moisture Resistant plasterboard (both sides).
Type P11: As type P4, but with additional membrane Newton Lath or similar fixed directly to masonry wall to the height of approx 1200mm from the FFL. Slots to be incorporated to top and bottom of the lining for ventilation.
Internal Partitions:
Type P20: Internal Partition width 97mm, 70mm Gyproframe 'C' studs at max. 600mm centres with 1 layer of 12.5mm British Gyproc Gyproc SoundBloc to both sides. All joints to be taped and jointed, giving a smooth and seamless finish, ready for decoration.
Type P20M: As type P20, but with one side of SoundBloc replaced with 12.5mm Gyproc SoundBloc Moisture Resistant plasterboard ('wet' side).
Type P20M2: As type P20, but with both layers replaced with 12.5mm Gyproc SoundBloc Moisture Resistant plasterboard (both sides).
Type P21: Internal Partition width 155mm, 92mm Gyproframe 'C' studs at max. 600mm centres with 1 layer of 12.5mm British Gyproc Gyproc SoundBloc to each side. All joints to be taped and jointed, giving a smooth and seamless finish, ready for decoration.
Type P21M: As type P21, but with one side of SoundBloc replaced with 12.5mm Gyproc SoundBloc Moisture Resistant plasterboard ('wet' side).
Type P21M2: As type P21, but with both layers replaced with 12.5mm Gyproc SoundBloc Moisture Resistant plasterboard (both sides).
Type P22: Timber stud braced wall. 100mm timber studs at 600mm centres with 1 layer of 18mm Plywood to each side and 1 layer of 12.5mm Gyproc SoundBloc plasterboard to both sides. All joints to be taped and jointed, giving a smooth and seamless finish, ready for decoration.
Type P22M: As type P22, but with one side of SoundBloc replaced with 12.5mm Gyproc SoundBloc Moisture Resistant plasterboard ('wet' side).
Type P23: Timber stud braced wall. 140mm timber studs at 600mm centres with 1 layer of 18mm Plywood to both sides and 1 layer of 12.5mm Gyproc SoundBloc plasterboard to both sides. All joints to be taped and jointed, giving a smooth and seamless finish, ready for decoration.
Type P23M: As type P23, but with one side of SoundBloc replaced with 12.5mm Gyproc SoundBloc Moisture Resistant plasterboard ('wet' side).
Type P23M2: As type P23, but with one side of SoundBloc replaced with 12.5mm Gyproc SoundBloc Moisture Resistant plasterboard ('wet' side).
Type P24: Internal Partition width 122mm, 70mm Gyproframe 'C' studs at max. 600mm centres with 2 layers of 12.5mm British Gyproc Gyproc SoundBloc to each side. All joints to be taped and jointed, giving a smooth and seamless finish, ready for decoration.
Type P24M: As type P24, but with one side of SoundBloc replaced with 12.5mm Gyproc SoundBloc Moisture Resistant plasterboard ('wet' side).
Type P25: Timber Stud Wall (Queen Mothers Hall) 100mm Stud Wall with 1 layer of 12.5mm British Gyproc Gyproc Wallboard. All joints to be taped and jointed, giving a smooth and seamless finish ready for decoration.
Type P25M: As type P25, but with 'wet' side plasterboard replaced with 12.5mm Gyproc Wallboard Moisture Resistant board.
Type P25M: Internal Partition width 122mm, 92mm Gyproframe 'C' studs at max. 600mm centres with 1 layer of 12.5mm Gyproc SoundBloc Moisture Resistant plasterboard on 12mm Plywood to one side with 1 layer of 12.5mm Gyproc SoundBloc Moisture Resistant plasterboard on opposite side. All joints to be taped and jointed, giving a smooth and seamless finish, ready for decoration.
Type P26M: Internal Partition width 141mm, As P26M but with 12mm Plywood to both sides.
Internal Linings & Boxing Types:
Type P46: Typical Boxing and False Wall - 70mm Gyproframe 'C' studs at max. 600mm centres with 1 layer of 12.5mm British Gyproc Wallboard to one side. All joints to be taped and jointed, giving a smooth and seamless finish, ready for decoration.
Type P46M: As type P46 but with the layer of Plasterboard replaced with Gyproc Moisture Resistant plasterboard to 'wet' area.
Type P41: Typical Sacrificial Wall - Gyprolyne Universal GL1 channel with offset of 35mm at 600mm centres (GL2 fixing brackets) with 1 layer of 12.5mm British Gyproc wallboard. All joints to be taped and jointed, giving a smooth and seamless finish, ready for decoration.
Type P41M: As type P41 but with the layer of Plasterboard replaced with Gyproc Moisture Resistant plasterboard to 'wet' area.
Type P42: Typical Sacrificial Wall (Generally for 40mm Drainage runs) - Gyprolyne Universal GL1 channel with offset of 75mm at 600mm centres (GL2 fixing brackets) with 1 layer of 12.5mm British Gyproc wallboard. All joints to be taped and jointed, giving a smooth and seamless finish, ready for decoration.
Type P42M: As type P42 but with the layer of Plasterboard replaced with Gyproc Moisture Resistant plasterboard to 'wet' area.
Type P43: Typical Sacrificial Wall (Generally for WC Drainage runs) - Gyprolyne Universal GL1 channel with offset of 122mm at 600mm centres (GL3 fixing brackets) with 1 layer of 12.5mm British Gyproc wallboard. All joints to be taped and jointed, giving a smooth and seamless finish, ready for decoration.
Type P43M: As type P43 but with the layer of Plasterboard replaced with Gyproc Moisture Resistant plasterboard to 'wet' area.
Type P43M2: As type P43 but with the layer of Plasterboard replaced with Gyproc Moisture Resistant plasterboard to 'wet' area.
Type P44: Lining to cavity brick, separating walls - 1 layer of 12.5mm British Gyproc wallboard on 10mm adhesive dabs on 8mm parge coat (Gyproc SoundBloc Plus). All joints to be taped and jointed, giving a smooth and seamless finish, ready for decoration.
Type P44M: As type P44 but with the layer of Plasterboard replaced with Gyproc Moisture Resistant plasterboard to 'wet' area.
Type P45: Typical Lining to RC blockwork columns, walls - 12.5mm Gyproc SoundBloc on dabs. All joints to be taped and jointed, giving a smooth and seamless finish ready for decoration.
Type P45M: As type P45 but with outer layer replaced by 12.5mm SoundBloc MR Board on dabs. All joints to be taped and jointed, giving a smooth and seamless finish ready for decoration.
Type P46: Plaster to Leisure Area (not to pool). Thistle HardWall by British Gyproc, nom. 11-12mm.
Type P47: Tiling to pool Area. Microtec Fibre reinforced floor adhesive (Ardex X 77) or similar. Thickness varies depending on tile types (to pool specialist's specification)
Type P48/P49: Assumed plaster repair or Lime Plaster applied respectively to existing Walls. Extent of existing damage to be assessed on site - removal to be agreed. New plaster to match existing. Plaster to be feathered with existing and made good. If type of plaster does not correspond as noted, please contact the architect prior to commencement of work.

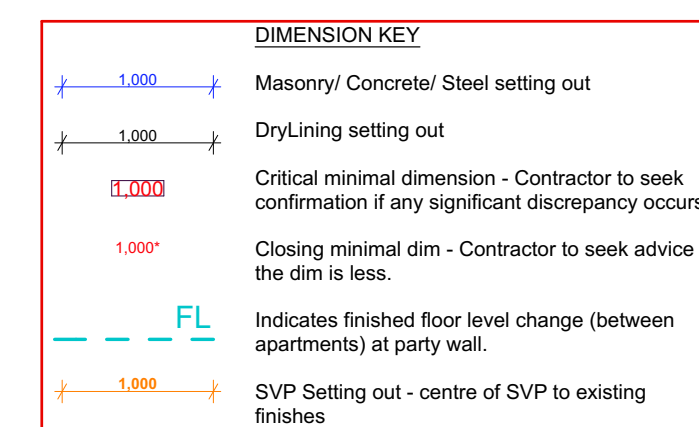

FOR CONSTRUCTION

REVISION	DRN	CHKD	DATE	
C1	Issued for Construction Plans Revised Following Workshop Dimensions Added / Revised Floor levels revised	MRR	TW	31/01/2017



CLIENT
 MOUNT ANVIL LTD



PROJECT
 KIDDEPORE AVENUE

DRAWING
 Maynard Wing
 Level 01 1:50 Plan Sheet 2 of 2

SCALE	DATE
1:50 @ A1	Tuesday, 14 February 2017
DRAWING No.	DRAWN BY
15 230	MRR
9000-DRG-03MW-01021	REV
	C1

A & Q PARTNERSHIP (LONDON) LTD
 THE LUX BUILDING, 2-4 HOXTON SQUARE, LONDON N1 6 NU
 Tel: 020 7613 2244 Fax: 020 7613 2642 Email: london@aqp.co.uk
 ARCHITECTURE DESIGN MASTERPLANNING INTERIORS