

- GA Plan Key**
- Gully / Sump
 - Indicative Slab hole
 - Wall type tag
 - Air Brick vent
 - RWP - Existing
 - RWP - New
 - SVP
 - SVP/RWP below
 - Indicative SVP/RWP route
 - Coordinate point
 - Radiator
 - Heated Towel Rail

General Lintel heights are as follows or as noted otherwise:
 LG lintels to be approx 2180mm from proposed FFL
 UG lintels to be 2380mm from proposed FFL
 Level 01 lintels to be 2380mm from proposed FFL
 Level 02 lintels to be 2180mm from proposed FFL
 Level 03 lintels to be 2180mm from proposed FFL
 All Lintel heights to be confirmed prior to installation.

Note:
 SSL spot levels shown are assumed levels. Any variation in existing SSL to be confirmed and reported back to architect prior to commencement of work.
FFL levels may vary depending on construction of existing floors.

Note:
 Radiators shown are indicative only. Final positions and sizes TBC

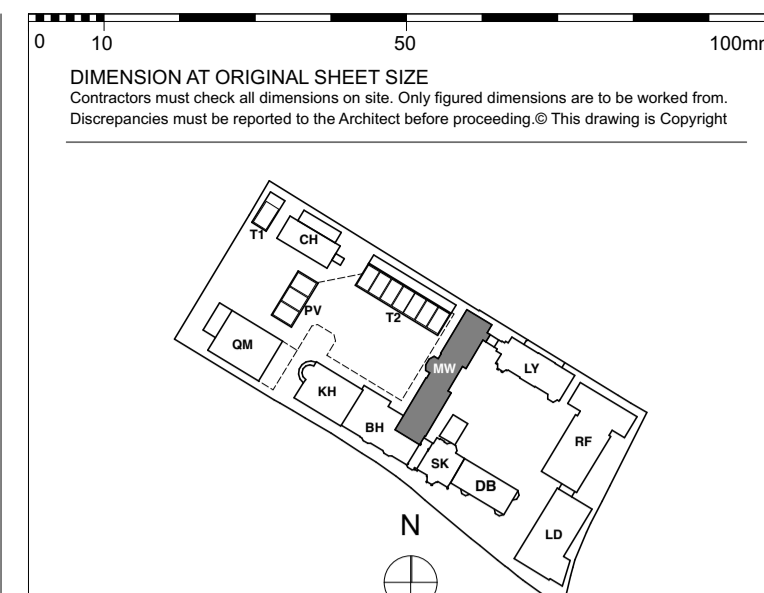

FOR CONSTRUCTION

REVISION	DRN	CHKD	DATE
C1 Issued for Construction Plans Revised Following Workshop Dimensions Added / Revised Floor levels revised	MRR	TW	31/01/2017



PROJECT
 KIDDEPORE AVENUE

DRAWING
 Maynard Wing
 Level 01 1:50 Plan Sheet 1 of 2

SCALE 1:50 @ A1

DATE Tuesday, 14 February 2017

DRAWING No. 15 230
 9000-DRG-03MW-01020

DRAWN BY MRR
REV C1

DATE Tuesday, 14 February 2017

DRAWN BY MRR
REV C1

A & Q PARTNERSHIP (LONDON) LTD
 THE LUX BUILDING, 2-4 HOXTON SQUARE, LONDON N1 6NU
 Tel: 020 7613 2244 Fax: 020 7613 2642 Email: london@aqp.co.uk
 ARCHITECTURE DESIGN MASTERPLANNING INTERIORS

Finishes Legend:
External and Separating Wall Lining Types:
Type P1. External Masonry Wall - 2 layers of 15mm British Gyproc SoundBloc on Vapour Control layer. All joints to be taped and jointed, giving a smooth and seamless finish ready for decoration.
Type P1M. As type P1, but with outer layer replaced with 15mm Gyproc SoundBloc Moisture Resistant plasterboard.
Type P2. Typical Gyproc Quiet IWL Separating Wall - 2 layers of 15mm British Gyproc SoundBloc or similar to each side. All joints to be taped and jointed, giving a smooth and seamless finish ready for decoration.
Type P2M. As type P2, but with outer layer replaced with 15mm Gyproc SoundBloc Moisture Resistant plasterboard ('wet' side).
Type P2M2. As type P2, but with outer layers replaced with 15mm Gyproc SoundBloc Moisture Resistant plasterboard (both sides).
Type P3 / P3A. Independent Wall Lining. Generally to cores - Width varies, depending on wall height - 70 / 90mm Gyproframe 'IWL' at 600mm centres with 1 layer of 15mm British Gyproc Gyproc SoundBloc. Fully filled with unfaced mineralwool with min. density 10kg/m3 between studs. All joints to be taped and jointed, giving a smooth and seamless finish, ready for decoration.
Type P3M / P3A-M. As type P3, but with outer layer replaced with 15mm Gyproc SoundBloc Moisture Resistant plasterboard ('wet' side).

Type P4. Thermal Lining to existing buildings (upper floors) - Gyprolyer Universal GL1 channels at 600mm centres (packed with 50mm Kooltherm K12 board - insulation notched where required).
Type P4. External Masonry Wall - 2 layers of 15mm British Gyproc SoundBloc on Vapour Control layer. All joints to be taped and jointed, giving a smooth and seamless finish ready for decoration.
Type P4M. As type P4, but with outer layer replaced with 15mm Gyproc SoundBloc Moisture Resistant plasterboard.
Type P4M2. As type P4, but with outer layers replaced with 15mm Gyproc SoundBloc Moisture Resistant plasterboard (both sides).
Type P4M2M. As type P4, but with outer layers replaced with 15mm Gyproc SoundBloc Moisture Resistant plasterboard (both sides).
Type P4M2M2. As type P4, but with outer layers replaced with 15mm Gyproc SoundBloc Moisture Resistant plasterboard (both sides).
Type P4M2M2M. As type P4, but with outer layers replaced with 15mm Gyproc SoundBloc Moisture Resistant plasterboard (both sides).
Type P4M2M2M2. As type P4, but with outer layers replaced with 15mm Gyproc SoundBloc Moisture Resistant plasterboard (both sides).
Type P4M2M2M2M. As type P4, but with outer layers replaced with 15mm Gyproc SoundBloc Moisture Resistant plasterboard (both sides).
Type P4M2M2M2M2. As type P4, but with outer layers replaced with 15mm Gyproc SoundBloc Moisture Resistant plasterboard (both sides).
Type P4M2M2M2M2M. As type P4, but with outer layers replaced with 15mm Gyproc SoundBloc Moisture Resistant plasterboard (both sides).
Type P4M2M2M2M2M2. As type P4, but with outer layers replaced with 15mm Gyproc SoundBloc Moisture Resistant plasterboard (both sides).
Type P4M2M2M2M2M2M. As type P4, but with outer layers replaced with 15mm Gyproc SoundBloc Moisture Resistant plasterboard (both sides).
Type P4M2M2M2M2M2M2. As type P4, but with outer layers replaced with 15mm Gyproc SoundBloc Moisture Resistant plasterboard (both sides).
Type P4M2M2M2M2M2M2M. As type P4, but with outer layers replaced with 15mm Gyproc SoundBloc Moisture Resistant plasterboard (both sides).
Type P4M2M2M2M2M2M2M2. As type P4, but with outer layers replaced with 15mm Gyproc SoundBloc Moisture Resistant plasterboard (both sides).
Type P4M2M2M2M2M2M2M2M. As type P4, but with outer layers replaced with 15mm Gyproc SoundBloc Moisture Resistant plasterboard (both sides).
Type P4M2M2M2M2M2M2M2M2. As type P4, but with outer layers replaced with 15mm Gyproc SoundBloc Moisture Resistant plasterboard (both sides).
Type P4M2M2M2M2M2M2M2M2M. As type P4, but with outer layers replaced with 15mm Gyproc SoundBloc Moisture Resistant plasterboard (both sides).
Type P4M2M2M2M2M2M2M2M2M2. As type P4, but with outer layers replaced with 15mm Gyproc SoundBloc Moisture Resistant plasterboard (both sides).
Type P4M2M2M2M2M2M2M2M2M2M. As type P4, but with outer layers replaced with 15mm Gyproc SoundBloc Moisture Resistant plasterboard (both sides).
Type P4M2M2M2M2M2M2M2M2M2M2. As type P4, but with outer layers replaced with 15mm Gyproc SoundBloc Moisture Resistant plasterboard (both sides).
Type P4M2M2M2M2M2M2M2M2M2M2M. As type P4, but with outer layers replaced with 15mm Gyproc SoundBloc Moisture Resistant plasterboard (both sides).
Type P4M2M2M2M2M2M2M2M2M2M2M2. As type P4, but with outer layers replaced with 15mm Gyproc SoundBloc Moisture Resistant plasterboard (both sides).
Type P4M2M2M2M2M2M2M2M2M2M2M2M. As type P4, but with outer layers replaced with 15mm Gyproc SoundBloc Moisture Resistant plasterboard (both sides).
Type P4M2M2M2M2M2M2M2M2M2M2M2M2. As type P4, but with outer layers replaced with 15mm Gyproc SoundBloc Moisture Resistant plasterboard (both sides).
Type P4M2M2M2M2M2M2M2M2M2M2M2M2M. As type P4, but with outer layers replaced with 15mm Gyproc SoundBloc Moisture Resistant plasterboard (both sides).
Type P4M2M2M2M2M2M2M2M2M2M2M2M2M2. As type P4, but with outer layers replaced with 15mm Gyproc SoundBloc Moisture Resistant plasterboard (both sides).
Type P4M2M2M2M2M2M2M2M2M2M2M2M2M2M. As type P4, but with outer layers replaced with 15mm Gyproc SoundBloc Moisture Resistant plasterboard (both sides).
Type P4M2M2M2M2M2M2M2M2M2M2M2M2M2M2. As type P4, but with outer layers replaced with 15mm Gyproc SoundBloc Moisture Resistant plasterboard (both sides).
Type P4M2M2M2M2M2M2M2M2M2M2M2M2M2M2M. As type P4, but with outer layers replaced with 15mm Gyproc SoundBloc Moisture Resistant plasterboard (both sides).
Type P4M2M2M2M2M2M2M2M2M2M2M2M2M2M2M2. As type P4, but with outer layers replaced with 15mm Gyproc SoundBloc Moisture Resistant plasterboard (both sides).
Type P4M2M2M2M2M2M2M2M2M2M2M2M2M2M2M2M. As type P4, but with outer layers replaced with 15mm Gyproc SoundBloc Moisture Resistant plasterboard (both sides).
Type P4M2M2M2M2M2M2M2M2M2M2M2M2M2M2M2M2. As type P4, but with outer layers replaced with 15mm Gyproc SoundBloc Moisture Resistant plasterboard (both sides).
Type P4M2M2M2M2M2M2M2M2M2M2M2M2M2M2M2M2M. As type P4, but with outer layers replaced with 15mm Gyproc SoundBloc Moisture Resistant plasterboard (both sides).
Type P4M2M2M2M2M2M2M2M2M2M2M2M2M2M2M2M2M2. As type P4, but with outer layers replaced with 15mm Gyproc SoundBloc Moisture Resistant plasterboard (both sides).
Type P4M2M2M2M2M2M2M2M2M2M2M2M2M2M2M2M2M2M. As type P4, but with outer layers replaced with 15mm Gyproc SoundBloc Moisture Resistant plasterboard (both sides).
Type P4M2M2M2M2M2M2M2M2M2M2M2M2M2M2M2M2M2M2. As type P4, but with outer layers replaced with 15mm Gyproc SoundBloc Moisture Resistant plasterboard (both sides).
Type P4M2M2M2M2M2M2M2M2M2M2M2M2M2M2M2M2M2M2M. As type P4, but with outer layers replaced with 15mm Gyproc SoundBloc Moisture Resistant plasterboard (both sides).
Type P4M2M2M2M2M2M2M2M2M2M2M2M2M2M2M2M2M2M2M2. As type P4, but with outer layers replaced with 15mm Gyproc SoundBloc Moisture Resistant plasterboard (both sides).
Type P4M2M2M2M2M2M2M2M2M2M2M2M2M2M2M2M2M2M2M2M. As type P4, but with outer layers replaced with 15mm Gyproc SoundBloc Moisture Resistant plasterboard (both sides).
Type P4M2. As type P4, but with outer layers replaced with 15mm Gyproc SoundBloc Moisture Resistant plasterboard (both sides).
Type P4M2M. As type P4, but with outer layers replaced with 15mm Gyproc SoundBloc Moisture Resistant plasterboard (both sides).
Type P4M2. As type P4, but with outer layers replaced with 15mm Gyproc SoundBloc Moisture Resistant plasterboard (both sides).
Type P4M2M. As type P4, but with outer layers replaced with 15mm Gyproc SoundBloc Moisture Resistant plasterboard (both sides).
Type P4M2. As type P4, but with outer layers replaced with 15mm Gyproc SoundBloc Moisture Resistant plasterboard (both sides).
Type P4M2M. As type P4, but with outer layers replaced with 15mm Gyproc SoundBloc Moisture Resistant plasterboard (both sides).
Type P4M2. As type P4, but with outer layers replaced with 15mm Gyproc SoundBloc Moisture Resistant plasterboard (both sides).
Type P4M2M. As type P4, but with outer layers replaced with 15mm Gyproc SoundBloc Moisture Resistant plasterboard (both sides).
Type P4M2. As type P4, but with outer layers replaced with 15mm Gyproc SoundBloc Moisture Resistant plasterboard (both sides).
Type P4M2M. As type P4, but with outer layers replaced with 15mm Gyproc SoundBloc Moisture Resistant plasterboard (both sides).
Type P4M2. As type P4, but with outer layers replaced with 15mm Gyproc SoundBloc Moisture Resistant plasterboard (both sides).
Type P4M2M. As type P4, but with outer layers replaced with 15mm Gyproc SoundBloc Moisture Resistant plasterboard (both sides).
Type P4M2. As type P4, but with outer layers replaced with 15mm Gyproc SoundBloc Moisture Resistant plasterboard (both sides).
Type P4M2M. As type P4, but with outer layers replaced with 15mm Gyproc SoundBloc Moisture Resistant plasterboard (both sides).
Type P4M2. As type P4, but with outer layers replaced with 15mm Gyproc SoundBloc Moisture Resistant plasterboard (both sides).
Type P4M2M. As type P4, but with outer layers replaced with 15mm Gyproc SoundBloc Moisture Resistant plasterboard (both sides).
Type P4M2. As type P4, but with outer layers replaced with 15mm Gyproc SoundBloc Moisture Resistant plasterboard (both sides).
Type P4M2M. As type P4, but with outer layers replaced with 15mm Gyproc SoundBloc Moisture Resistant plasterboard (both sides).
Type P4M2. As type P4, but with outer layers replaced with 15mm Gyproc SoundBloc Moisture Resistant plasterboard (both sides).
Type P4M2M. As type P4, but with outer layers replaced with 15mm Gyproc SoundBloc Moisture Resistant plasterboard (both sides).
Type P4M2. As type P4, but with outer layers replaced with 15mm Gyproc SoundBloc Moisture Resistant plasterboard (both sides).
Type P4M2M. As type P4, but with outer layers replaced with 15mm Gyproc SoundBloc Moisture Resistant plasterboard (both sides).
Type P4M2. As type P4, but with outer layers replaced with 15mm Gyproc SoundBloc Moisture Resistant plasterboard (both sides).
Type P4M2M. As type P4, but with outer layers replaced with 15mm Gyproc SoundBloc Moisture Resistant plasterboard (both sides).
Type P4M2. As type P4, but with outer layers replaced with 15mm Gyproc SoundBloc Moisture Resistant plasterboard (both sides).
Type P4M2M. As type P4, but with outer layers replaced with 15mm Gyproc SoundBloc Moisture Resistant plasterboard (both sides).
Type P4M2. As type P4, but with outer layers replaced with 15mm Gyproc SoundBloc Moisture Resistant plasterboard (both sides).
Type P4M2M. As type P4, but with outer layers replaced with 15mm Gyproc SoundBloc Moisture Resistant plasterboard (both sides).
Type P4M2. As type P4, but with outer layers replaced with 15mm Gyproc SoundBloc Moisture Resistant plasterboard (both sides).
Type P4M2M. As type P4, but with outer layers replaced with 15mm Gyproc SoundBloc Moisture Resistant plasterboard (both sides).
Type P4M2. As type P4, but with outer layers replaced with 15mm Gyproc SoundBloc Moisture Resistant plasterboard (both sides).
Type P4M2M. As type P4, but with outer layers replaced with 15mm Gyproc SoundBloc Moisture Resistant plasterboard (both sides).
Type P4M2. As type P4, but with outer layers replaced with 15mm Gyproc SoundBloc Moisture Resistant plasterboard (both sides).
Type P4M2M. As type P4, but with outer layers replaced with 15mm Gyproc SoundBloc Moisture Resistant plasterboard (both sides).
Type P4M2. As type P4, but with outer layers replaced with 15mm Gyproc SoundBloc Moisture Resistant plasterboard (both sides).
Type P4M2M. As type P4, but with outer layers replaced with 15mm Gyproc SoundBloc Moisture Resistant plasterboard (both sides).
Type P4M2. As type P4, but with outer layers replaced with 15mm Gyproc SoundBloc Moisture Resistant plasterboard (both sides).
Type P4M2M. As type P4, but with outer layers replaced with 15mm Gyproc SoundBloc Moisture Resistant plasterboard (both sides).
Type P4M2. As type P4, but with outer layers replaced with 15mm Gyproc SoundBloc Moisture Resistant plasterboard (both sides).
Type P4M2M. As type P4, but with outer layers replaced with 15mm Gyproc SoundBloc Moisture Resistant plasterboard (both sides).
Type P4M2. As type P4, but with outer layers replaced with 15mm Gyproc SoundBloc Moisture Resistant plasterboard (both sides).
Type P4M2M. As type P4, but with outer layers replaced with 15mm Gyproc SoundBloc Moisture Resistant plasterboard (both sides).
Type P4M2M. As type P4, but with outer layers replaced with 15mm Gyproc SoundBloc Moisture Resistant plasterboard (both sides).
Type P4M2. As type P4, but with outer layers replaced with 15mm Gyproc SoundBloc Moisture Resistant plasterboard (both sides).
Type P4M2M. As type P4, but with outer layers replaced with 15mm Gyproc SoundBloc Moisture Resistant plasterboard (both sides).
Type P4M2. As type P4, but with outer layers replaced with 15mm Gyproc SoundBloc Moisture Resistant plasterboard (both sides).
Type P4M2M. As type P4, but with outer layers replaced with 15mm Gyproc SoundBloc Moisture Resistant plasterboard (both sides).
Type P4M2. As type P4, but with outer layers replaced with 15mm Gyproc SoundBloc Moisture Resistant plasterboard (both sides).
Type P4M2M. As type P4, but with outer layers replaced with 15mm Gyproc SoundBloc Moisture Resistant plasterboard (both sides).
Type P4M2. As type P4, but with outer layers replaced with 15mm Gyproc SoundBloc Moisture Resistant plasterboard (both sides).
Type P4M2M. As type P4, but with outer layers replaced with 15mm Gyproc SoundBloc Moisture Resistant plasterboard (both sides).
Type P4M2. As type P4, but with outer layers replaced with 15mm Gyproc SoundBloc Moisture Resistant plasterboard (both sides).
Type P4M2M. As type P4, but with outer layers replaced with 15mm Gyproc SoundBloc Moisture Resistant plasterboard (both sides).
Type P4M2. As type P4, but with outer layers replaced with 15mm Gyproc SoundBloc Moisture Resistant plasterboard (both sides).
Type P4M2. As type P4, but with outer layers replaced with 15mm Gyproc SoundBloc Moisture Resistant plasterboard (both sides).
Type P4M2. As type P4, but with outer layers replaced with 15mm Gyproc SoundBloc Moisture Resistant plasterboard (both sides).
Type P4M2. As type P4, but with outer layers replaced with 15mm Gyproc SoundBloc Moisture Resistant plasterboard (both sides).
Type P4M2. As type P4, but with outer layers replaced with 15mm Gyproc SoundBloc Moisture Resistant plasterboard (both sides).
Type P4M2. As type P4, but with outer layers replaced with 15mm Gyproc SoundBloc Moisture Resistant plasterboard (both sides).
Type P4M2. As type P4, but with outer layers replaced with 15mm Gyproc SoundBloc Moisture Resistant plasterboard (both sides).
Type P4M2. As type P4, but with outer layers replaced with 15mm Gyproc SoundBloc Moisture Resistant plasterboard (both sides).
Type P4M2. As type P4, but with outer layers replaced with 15mm Gyproc SoundBloc Moisture Resistant plasterboard (both sides).
Type P4M2. As type P4, but with outer layers replaced with 15mm Gyproc SoundBloc Moisture Resistant plasterboard (both sides).
Type P4M2. As type P4, but with outer layers replaced with 15mm Gyproc SoundBloc Moisture Resistant plasterboard (both sides).