

rev	alteration	date	by
-	First issue	14.12.16	SC
A	Show all windows	16.01.17	SC
B	Revise secondary glazing detail	28.03.17	SC
C	Add glazing colour specification	03.04.17	SC

WINDOWS SHOWN
IN ELEVATION

PARK STREET

BOARDROOM

MEETING ROOM

EXISTING ELEVATION
Scale 1:50



Existing front view

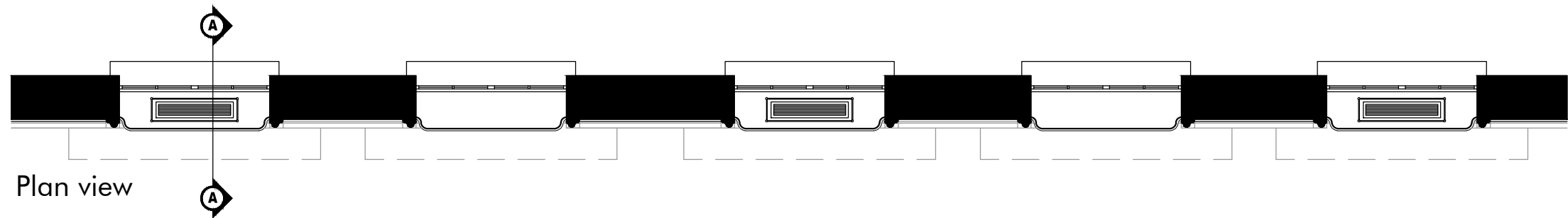

PROPOSED ELEVATION
Scale 1:50

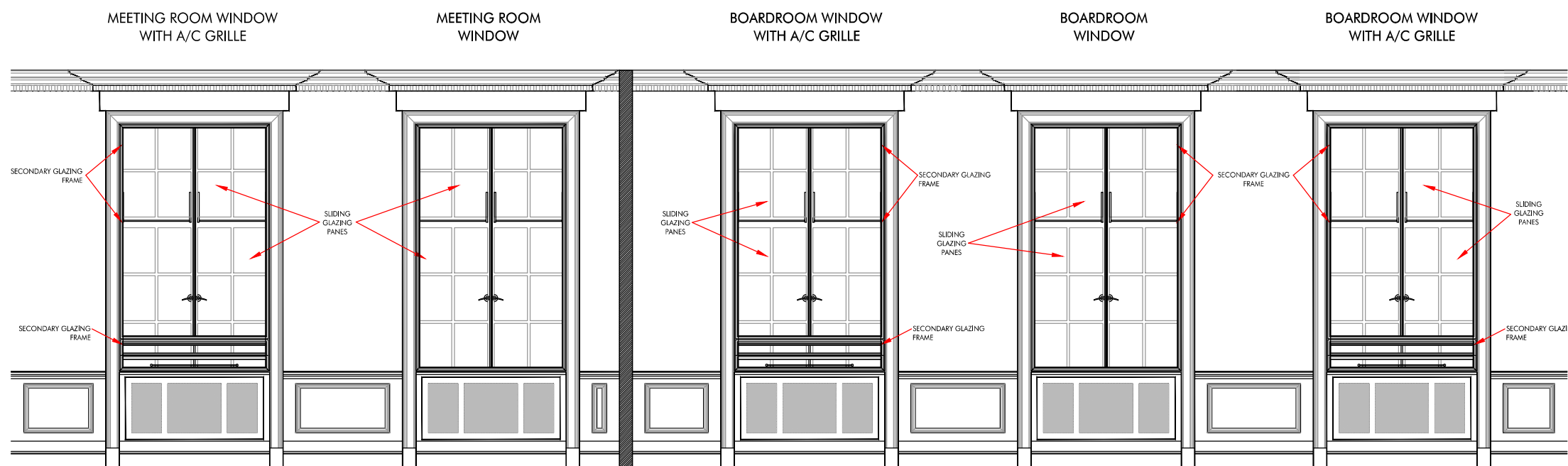

Proposed front view

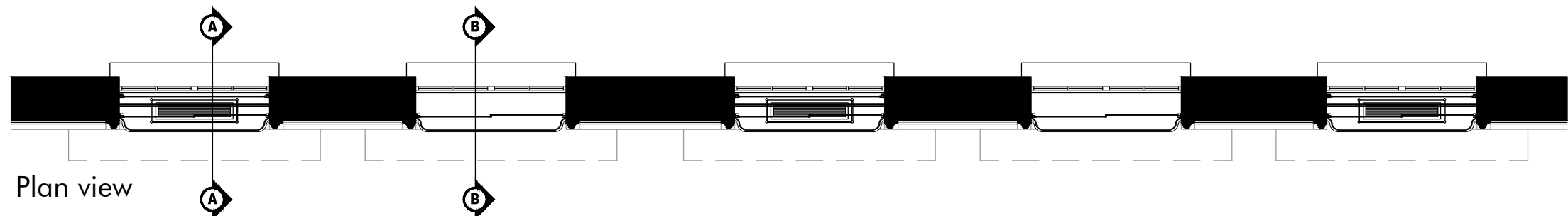

NOTE: SECONDARY GLAZING TO BE POWDER COATED TO THE NEAREST RAL COLOUR TO THE ADJACENT TIMBER

Section AA

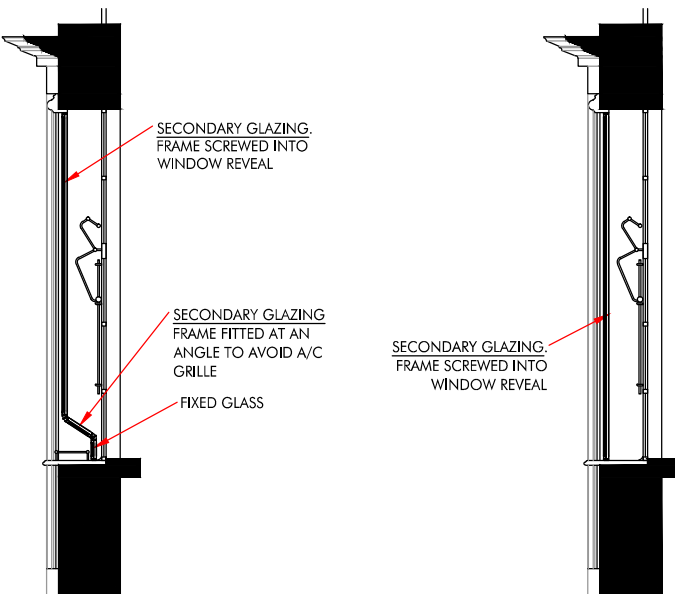

Section AA

Section BB

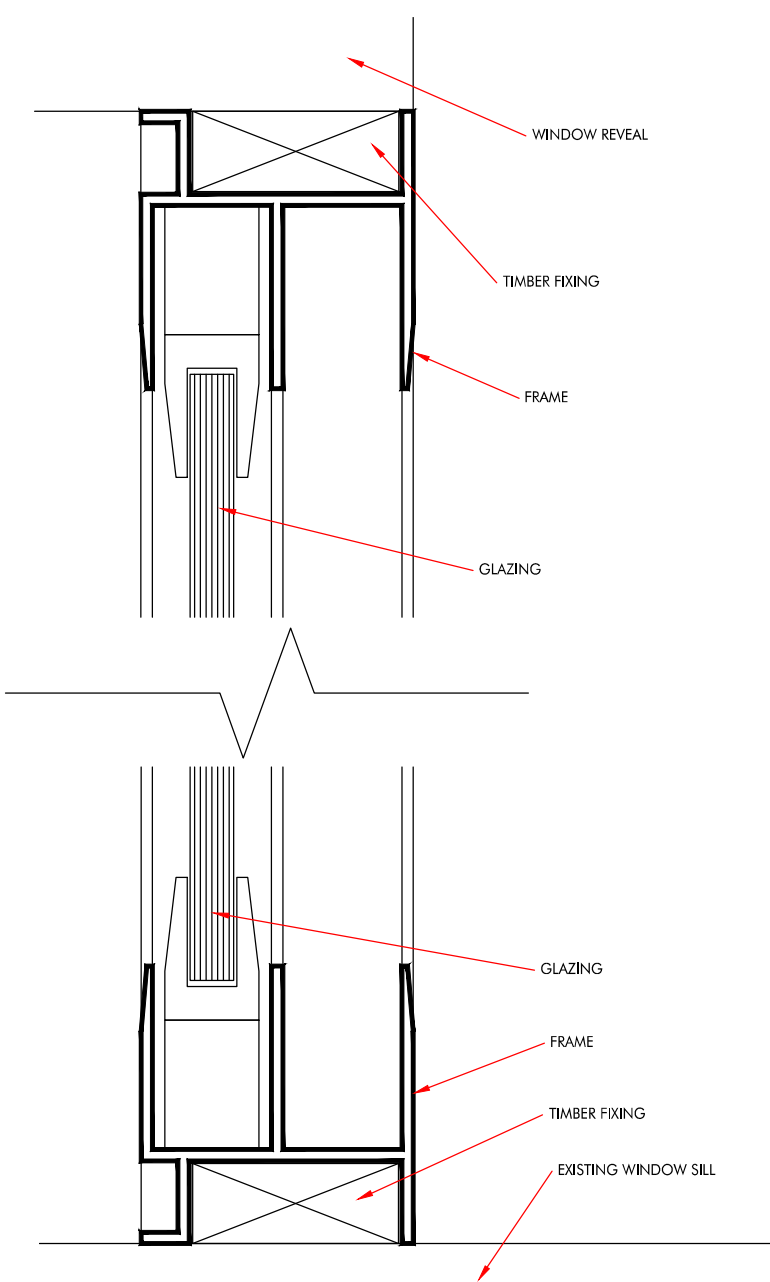
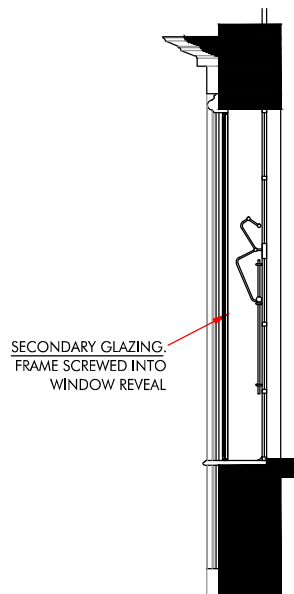

SECTION THRU GLAZING
Scale 1:1

officeprinciples

Head Office
6 Bennett Road
Reading RG2 0QX
T: +44(0)18 975 9750

London Showroom
Design Hub Clerkenwell
47 Gee Street
London EC1V 3RS
T: +44(0)203 096 0066

www.officeprinciples.com

CLIENT: FCB INFERNO
30 GREAT QUEEN STREET

PROJECT: SECONDARY GLAZING

PROPOSED DESIGN
DRAWING: DETAILED DRAWINGS

DATE: 03.04.17
SCALE: 1:20&1:50@A1
DRG.No.

DT-01
REVISION: C
CHKD:

All dimensions to be verified on site

FCB INFERNO