

Appendix L – Swept Path Analysis

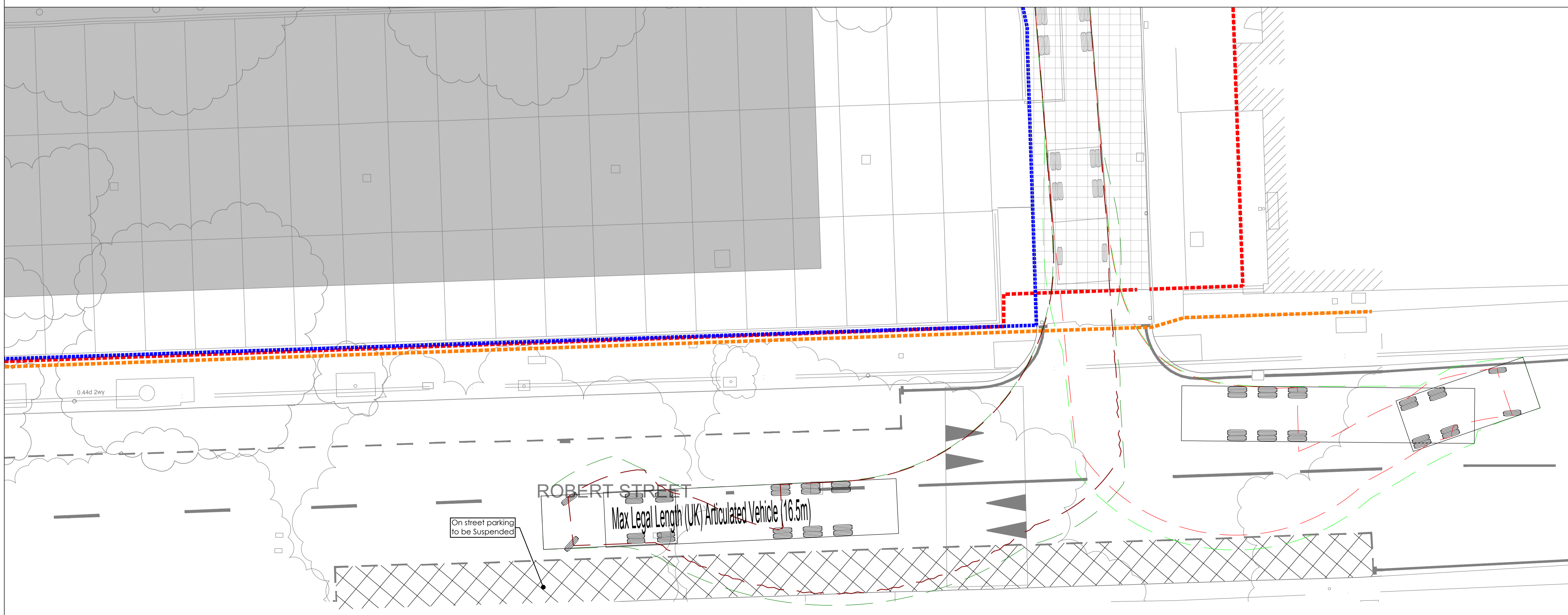

NOTES:

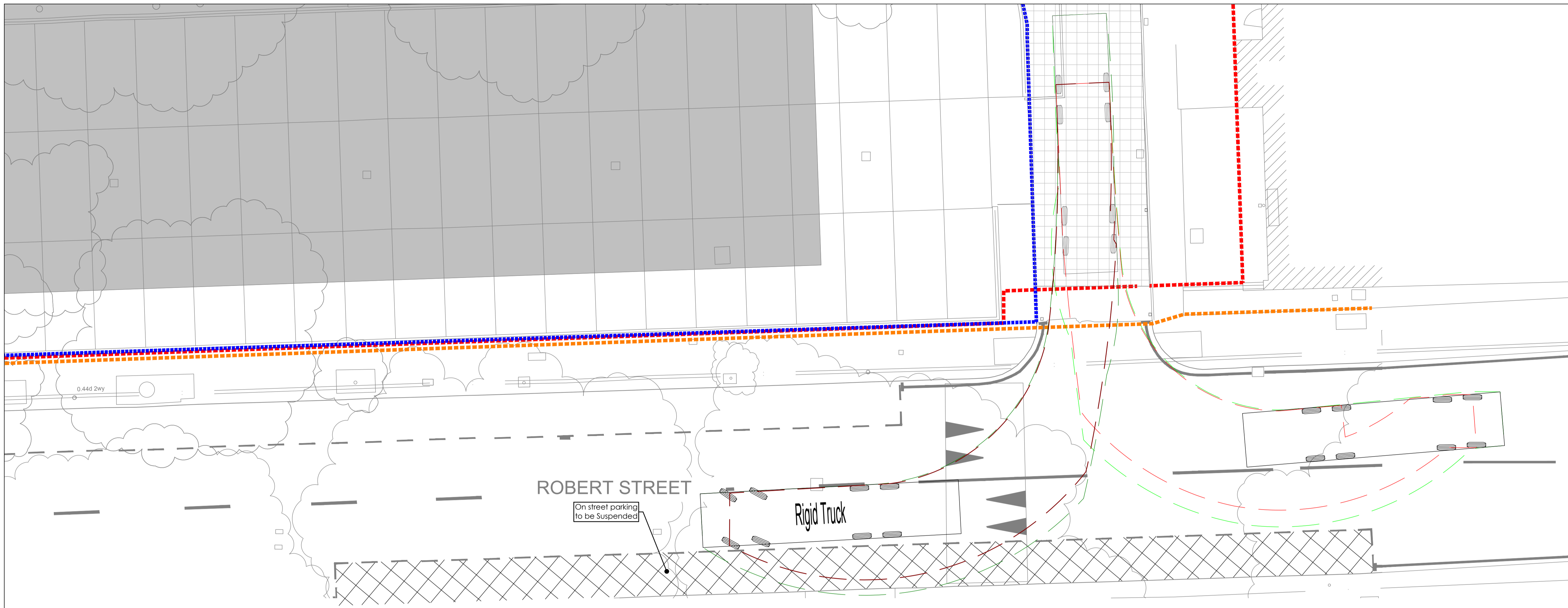
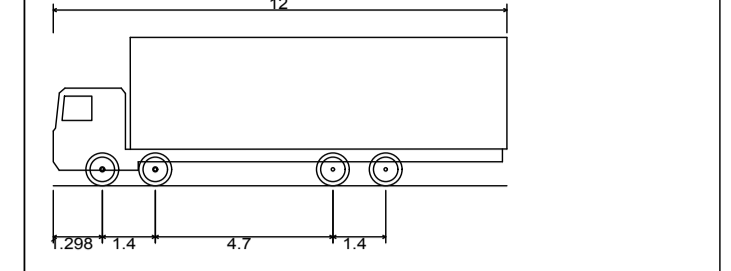

Rigid Truck
 Overall Length 12.000m
 Overall Width 2.500m
 Overall Body Height 3.928m
 Min Body Ground Clearance 0.412m
 Track Width 2.471m
 Lock to Lock Time 6.00s
 Kerb to Kerb Turning Radius 11.900m

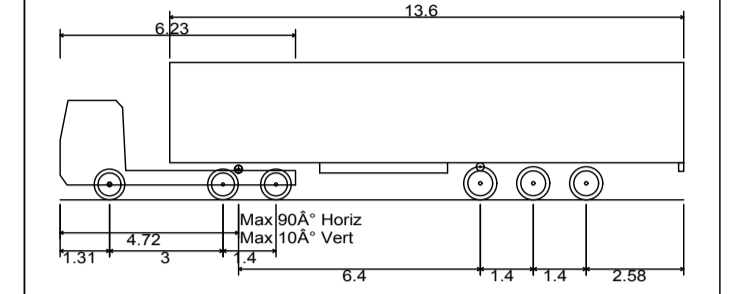

Max Legal Length (UK)
 Articulated Vehicle (16.5m)
 Overall Length 16.500m
 Overall Width 2.500m
 Overall Body Height 3.632m
 Min Body Ground Clearance 0.396m
 Max Track Width 2.500m
 Lock to Lock Time 6.00s
 Kerb to Kerb Turning Radius 6.870m

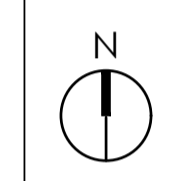

KEY:

	Proposed Building Footprint
	Unloading Area
	On street parking bays to be suspended

P01	16/10/15	SNN	TST	Initial Issue
MARK	DATE	BY	CHKD.	REVISION NOTES
			C.D.M.	

SIGNIFICANT RISKS AND HAZARDS:

IESIS SPECIAL STRUCTURES
 20 IRONMONGER LANE
 LONDON
 EC2V 8EP
 T: +44 (0)207 6002912
 www.iesis.net

PROJECT:
**Plot 1, Robert Street Car Park
 Regents Park Estate Infill**

DRAWING TITLE:
Vehicle Tracking Manoeuvres

STATUS: **INFORMATION**

SCALE AT A1:	DATE:	DRAWN:	CHECKED:
1:100	15/10/15	SNN	TST
JOB NUMBER:	DRAWING NUMBER:	REVISION:	
SE1238	311	P01	



NOTES:

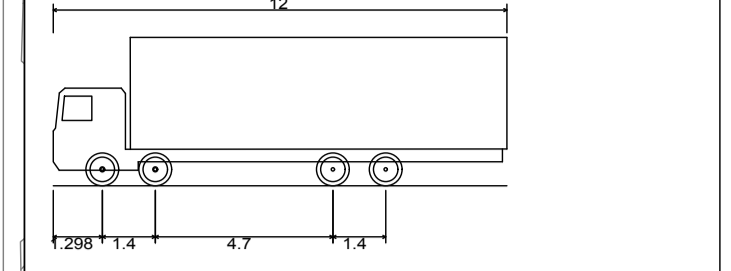

Rigid Truck
 Overall Length 12.000m
 Overall Width 2.500m
 Overall Body Height 3.928m
 Min Body Ground Clearance 0.412m
 Track Width 2.471m
 Lock to Lock Time 6.00s
 Kerb to Kerb Turning Radius 11.900m

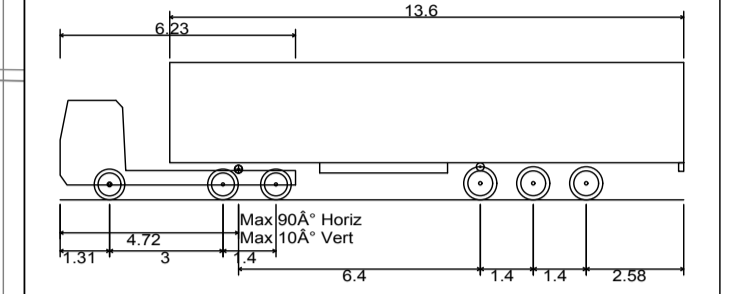

Max Legal Length (UK)
 Articulated Vehicle (16.5m)
 Overall Length 16.500m
 Overall Width 2.550m
 Overall Body Height 3.632m
 Min Body Ground Clearance 0.396m
 Max Track Width 2.500m
 Lock to Lock Time 6.00s
 Kerb to Kerb Turning Radius 6.870m

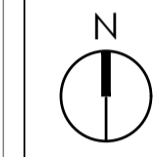

KEY:

- Proposed Building Footprint
- Unloading Area
- On street parking bays to be suspended

MARK	DATE	BY	CHKD.	REVISION NOTES
P01	16/10/15	SNN	TST	Initial Issue
C.D.M.				

SIGNIFICANT RISKS AND HAZARDS:

iesis SPECIAL STRUCTURES
 20 IRONMONGER LANE
 LONDON
 EC2V 8EP
 T: +44 (0)207 6002912
 www.iesis.net

PROJECT:
 Plot 2, Rydel Water Open Space
 Regents Park Estate Infill

DRAWING TITLE:
 Vehicle Tracking Manoeuvres

STATUS: INFORMATION			
SCALE AT A1:	DATE:	DRAWN:	CHECKED:
1:100	15/10/15	SNN	TST
JOB NUMBER:	DRAWING NUMBER:	REVISION:	
SE1238	312	P01	



NOTES:

Rigid Truck
 Overall Length 12.000m
 Overall Width 2.500m
 Overall Body Height 3.928m
 Min Body Ground Clearance 0.412m
 Track Width 2.471m
 Lock to Lock Time 6.00s
 Kerb to Kerb Turning Radius 11.900m

Max Legal Length UK Articulated Vehicle (16.5m)
 Overall Length 16.500m
 Overall Width 2.500m
 Overall Body Height 3.632m
 Min Body Ground Clearance 0.396m
 Max Track Width 2.500m
 Lock to Lock Time 6.00s
 Kerb to Kerb Turning Radius 6.870m

N

KEY:

- Proposed Building Footprint
- Unloading Area
- On street parking bays to be suspended

PO1	16/10/15	SNN	TST	Initial Issue
MARK	DATE	BY	CHKD.	REVISION NOTES
			C.D.M.	

SIGNIFICANT RISKS AND HAZARDS:

IESIS SPECIAL STRUCTURES
 20 IRONMONGER LANE
 LONDON
 EC2V 8EP
 T: +44 (0)207 6002912
 www.iesis.net

PROJECT:
**Plot 3, Varndell Street
 Regents Park Estate Infill**

DRAWING TITLE:
Vehicle Tracking Manoeuvres

STATUS: **INFORMATION**

SCALE AT A1:	DATE:	DRAWN:	CHECKED:
1:100	15/10/15	SNN	TST
JOB NUMBER:	DRAWING NUMBER:	REVISION:	
SE1238	313	P01	

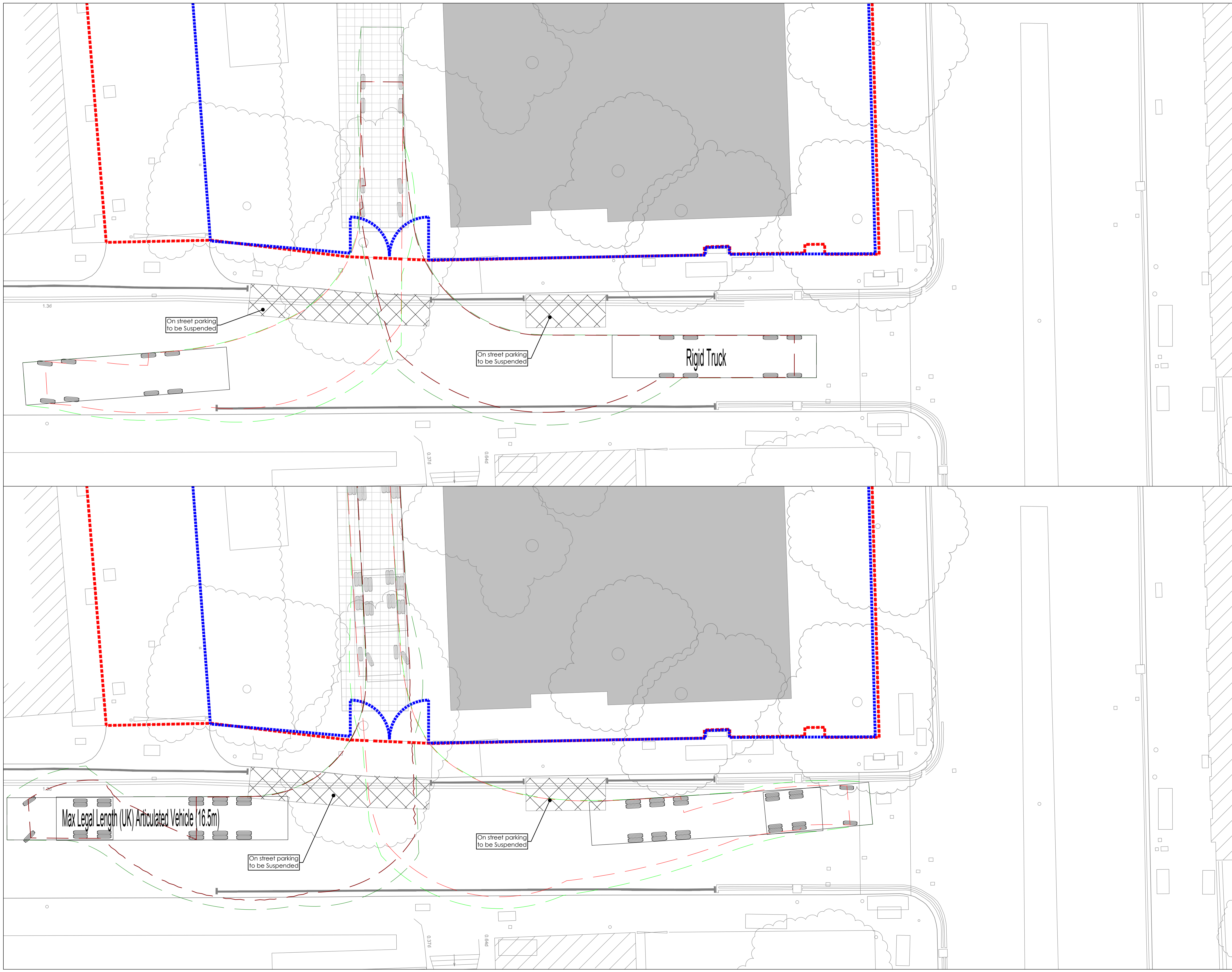

NOTES:

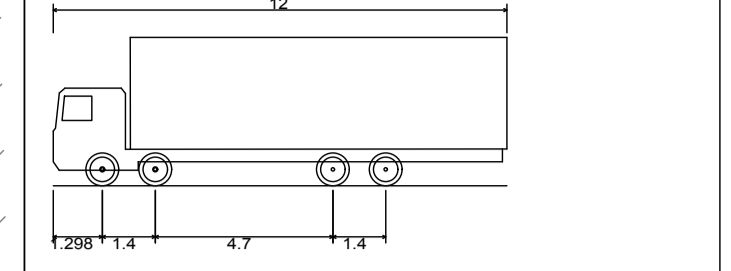

Rigid Truck
 Overall Length 12.000m
 Overall Width 2.500m
 Overall Body Height 3.928m
 Min Body Ground Clearance 0.412m
 Track Width 2.471m
 Lock to Lock Time 6.00s
 Kerb to Kerb Turning Radius 11.900m

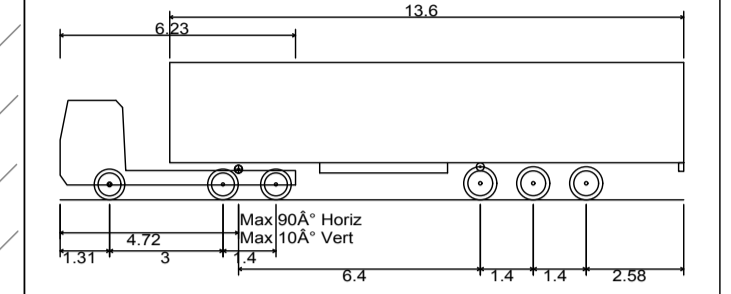

Max Legal Length (UK)
 Articulated Vehicle (16.5m)
 Overall Length 16.500m
 Overall Width 2.500m
 Overall Body Height 3.632m
 Min Body Ground Clearance 0.396m
 Max Track Width 2.500m
 Lock to Lock Time 6.00s
 Kerb to Kerb Turning Radius 6.870m

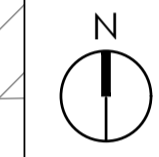

KEY:

	Proposed Building Footprint
	Unloading Area
	On street parking bays to be suspended

P01	16/10/15	SNN	TST	Initial Issue
MARK	DATE	BY	CHKD.	REVISION NOTES
			C.D.M.	

SIGNIFICANT RISKS AND HAZARDS:

IESIS SPECIAL STRUCTURES
 20 IRONMONGER LANE
 LONDON
 EC2V 8EP
 T: +44 (0)207 6002912
 www.iesis.net

PROJECT:
**Plot 4, Newlands
 Regents Park Estate Infill**

DRAWING TITLE:
Vehicle Tracking Manoeuvres

STATUS: **INFORMATION**

SCALE AT A1:	DATE:	DRAWN:	CHECKED:
1:100	15/10/15	SNN	TST
JOB NUMBER:	DRAWING NUMBER:	REVISION:	
SE1238	314	P01	

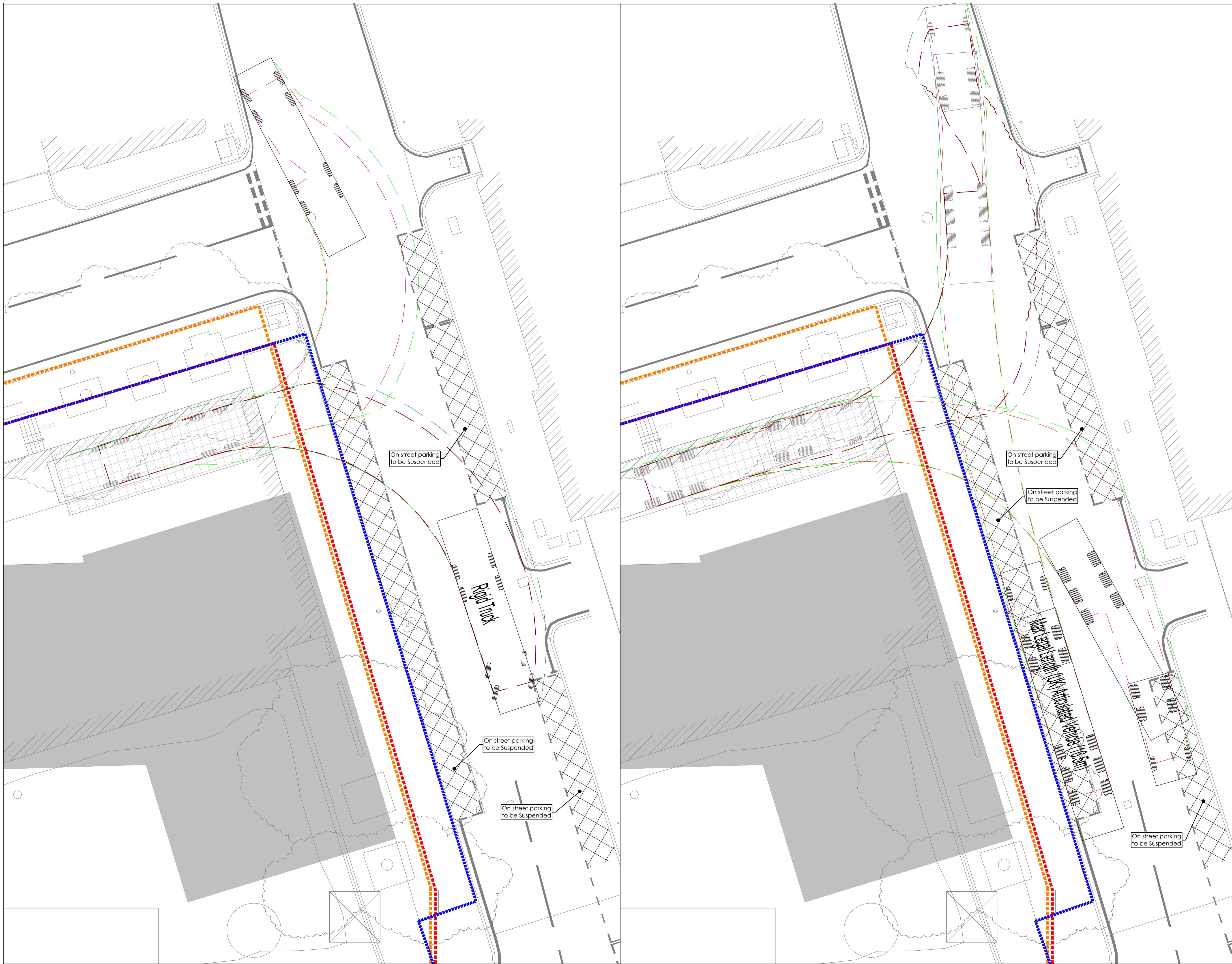

NOTES:

Rigid Truck
 Overall Length 12.000m
 Overall Width 2.500m
 Overall Body Height 3.928m
 Min Body Ground Clearance 0.412m
 Track Width 2.471m
 Lock to Lock Time 6.00s
 Kerb to Kerb Turning Radius 11.900m

Max Legal Length (UK)
 Articulated Vehicle (16.5m)
 Overall Length 16.500m
 Overall Width 2.500m
 Overall Body Height 3.632m
 Min Body Ground Clearance 0.396m
 Max Track Width 2.500m
 Lock to Lock Time 6.00s
 Kerb to Kerb Turning Radius 6.870m

N

KEY:

- Proposed Building Footprint
- Unloading Area
- On street parking bays to be suspended

P01	16/10/15	SNN	TST	Initial Issue
MARK	DATE	BY	CHKD.	REVISION NOTES
				C.D.M.

SIGNIFICANT RISKS AND HAZARDS:

iesis SPECIAL STRUCTURES
 20 IRONMONGER LANE
 LONDON
 EC2V 8EP
 T: +44 (0)207 6002912
 www.iesis.net

PROJECT:
 Plot 5, Dick Collins Hall
 Regents Park Estate Infill

DRAWING TITLE:
 Vehicle Tracking Manoeuvres

STATUS: **INFORMATION**

SCALE AT A1:	DATE:	DRAWN:	CHECKED:
1:100	15/10/15	SNN	TST
JOB NUMBER:	DRAWING NUMBER:	REVISION:	
SE1238	315	P01	



NOTES:

Rigid Truck
 Overall Length 12.000m
 Overall Width 2.500m
 Overall Body Height 3.928m
 Min Body Ground Clearance 0.412m
 Track Width 2.471m
 Lock to Lock Time 6.00s
 Kerb to Kerb Turning Radius 11.900m

Max Legal Length (UK)
 Articulated Vehicle (16.5m)
 Overall Length 16.500m
 Overall Width 2.500m
 Overall Body Height 3.632m
 Min Body Ground Clearance 0.396m
 Max Track Width 2.500m
 Lock to Lock Time 6.00s
 Kerb to Kerb Turning Radius 6.870m

KEY:

- Proposed Building Footprint
- Unloading Area
- On street parking bays to be suspended

PO1	16/10/15	SNN	TST	Initial Issue
MARK	DATE	BY	CHKD.	REVISION NOTES
				C.D.M.

SIGNIFICANT RISKS AND HAZARDS:

iesis SPECIAL STRUCTURES
 20 IRONMONGER LANE
 LONDON
 EC2V 8EP
 T: +44 (0)207 6002912
 www.iesis.net

PROJECT:
 Plot 6, Cape of Good Hope
 Regents Park Estate Infill

DRAWING TITLE:
 Vehicle Tracking Manoeuvres

STATUS: INFORMATION

SCALE AT A1:	DATE:	DRAWN:	CHECKED:
1:100	15/10/15	SNN	TST
JOB NUMBER:	DRAWING NUMBER:	REVISION:	
SE1238	316	PO1	



NOTES:

Rigid Truck
 Overall Length 12.000m
 Overall Width 2.500m
 Overall Body Height 3.928m
 Min Body Ground Clearance 0.412m
 Track Width 2.471m
 Lock to Lock Time 6.00s
 Kerb to Kerb Turning Radius 11.900m

Max Legal Length (UK)
 Articulated Vehicle (16.5m)
 Overall Length 16.500m
 Overall Width 2.500m
 Overall Body Height 3.632m
 Min Body Ground Clearance 0.396m
 Max Track Width 2.500m
 Lock to Lock Time 6.00s
 Kerb to Kerb Turning Radius 6.870m

N

KEY:

- Proposed Building Footprint
- Unloading Area
- On street parking bays to be suspended

P01	16/10/15	SNN	TST	Initial Issue
MARK	DATE	BY	CHKD.	REVISION NOTES
				C.D.M.

SIGNIFICANT RISKS AND HAZARDS:

iesis SPECIAL STRUCTURES
 20 IRONMONGER LANE
 LONDON
 EC2V 8EP
 T: +44 (0)207 6002912
 www.iesis.net

PROJECT:
 Plot 8, The Victory Pub
 Regents Park Estate Infill

DRAWING TITLE:
 Vehicle Tracking Manoeuvres

STATUS: INFORMATION

SCALE AT A1:	DATE:	DRAWN:	CHECKED:
1:100	15/10/15	SNN	TST
JOB NUMBER:	DRAWING NUMBER:	REVISION:	
SE1238	318	P01	

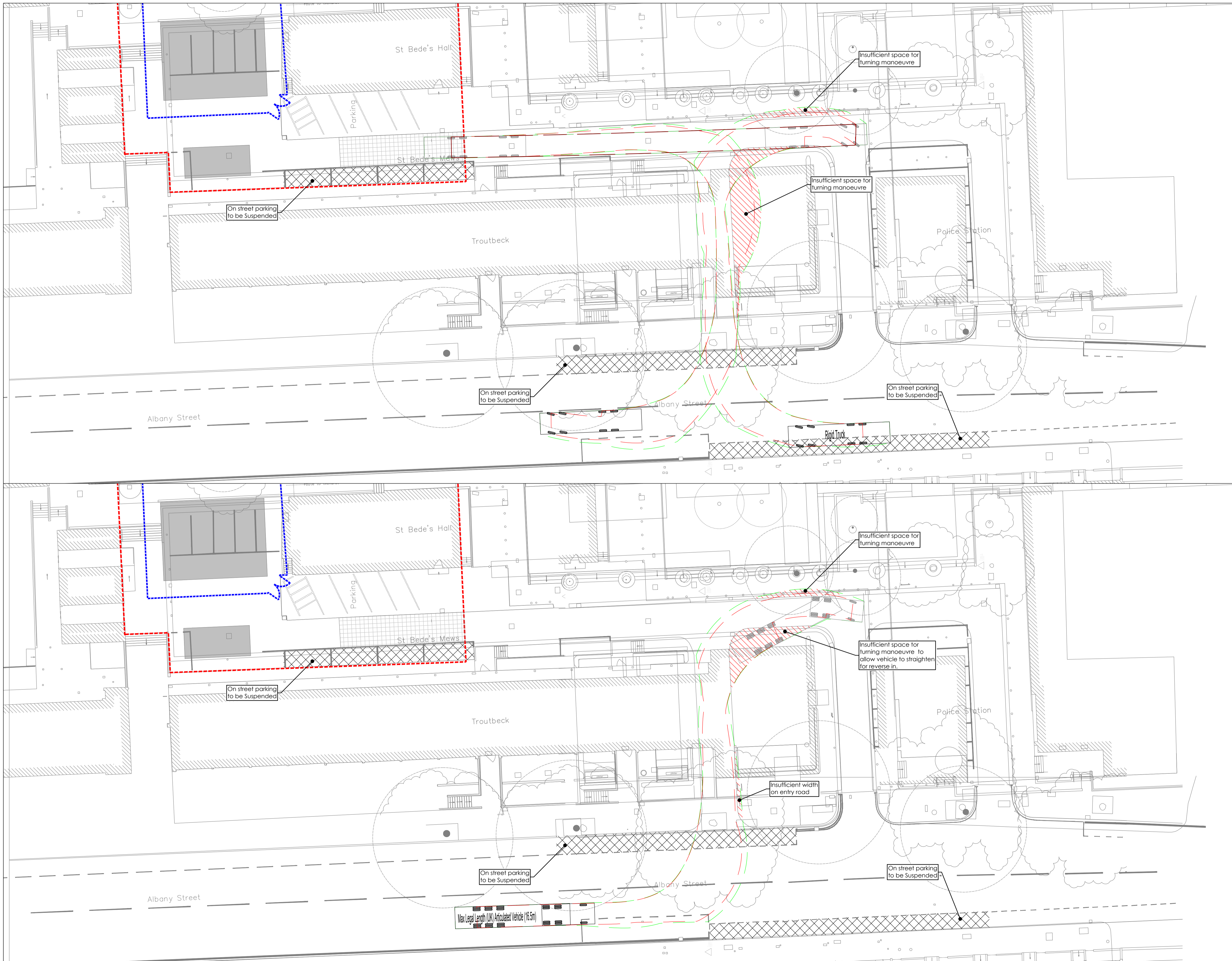

NOTES:

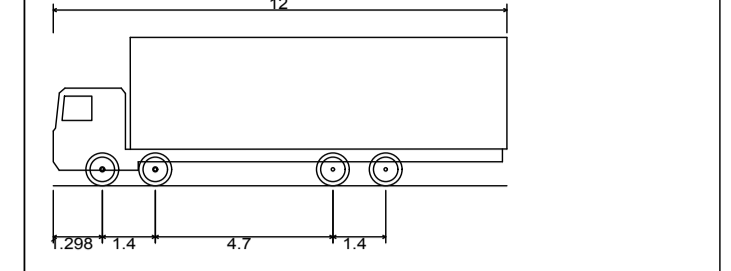

Rigid Truck
 Overall Length 12.000m
 Overall Width 2.500m
 Overall Body Height 3.928m
 Min Body Ground Clearance 0.412m
 Track Width 2.471m
 Lock to Lock Time 6.00s
 Kerb to Kerb Turning Radius 11.900m

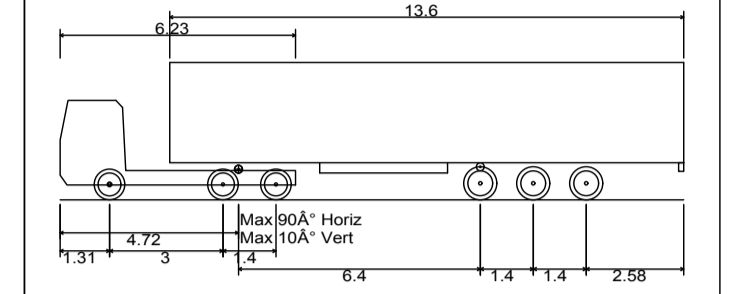

Max Legal Length (UK)
 Articulated Vehicle (16.5m)
 Overall Length 16.500m
 Overall Width 2.500m
 Overall Body Height 3.632m
 Min Body Ground Clearance 0.396m
 Max Track Width 2.500m
 Lock to Lock Time 6.00s
 Kerb to Kerb Turning Radius 6.870m

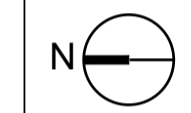

KEY:

	Proposed Building Footprint
	Unloading Area
	On street parking bays to be suspended
	Vehicle Manoeuvre over run - Insufficient space for turning

P01	16/10/15	SNN	TST	Initial Issue
MARK	DATE	BY	CHKD.	REVISION NOTES
			C.D.M.	

SIGNIFICANT RISKS AND HAZARDS:

IESIS SPECIAL STRUCTURES
 20 IRONMONGER LANE
 LONDON
 EC2V 8EP
 T: +44 (0)207 6002912
 www.iesis.net

PROJECT:
**Plot 9, St Bedes Mews
 Regents Park Estate Infill**

DRAWING TITLE:
Vehicle Tracking Manoeuvres

STATUS: **INFORMATION**

SCALE AT A1:	DATE:	DRAWN:	CHECKED:
1:200	15/10/15	SNN	TST
JOB NUMBER:	DRAWING NUMBER:	REVISION:	
SE1238	319	P01	