

Section K.K Break Out Area/ Reception Waiting Area

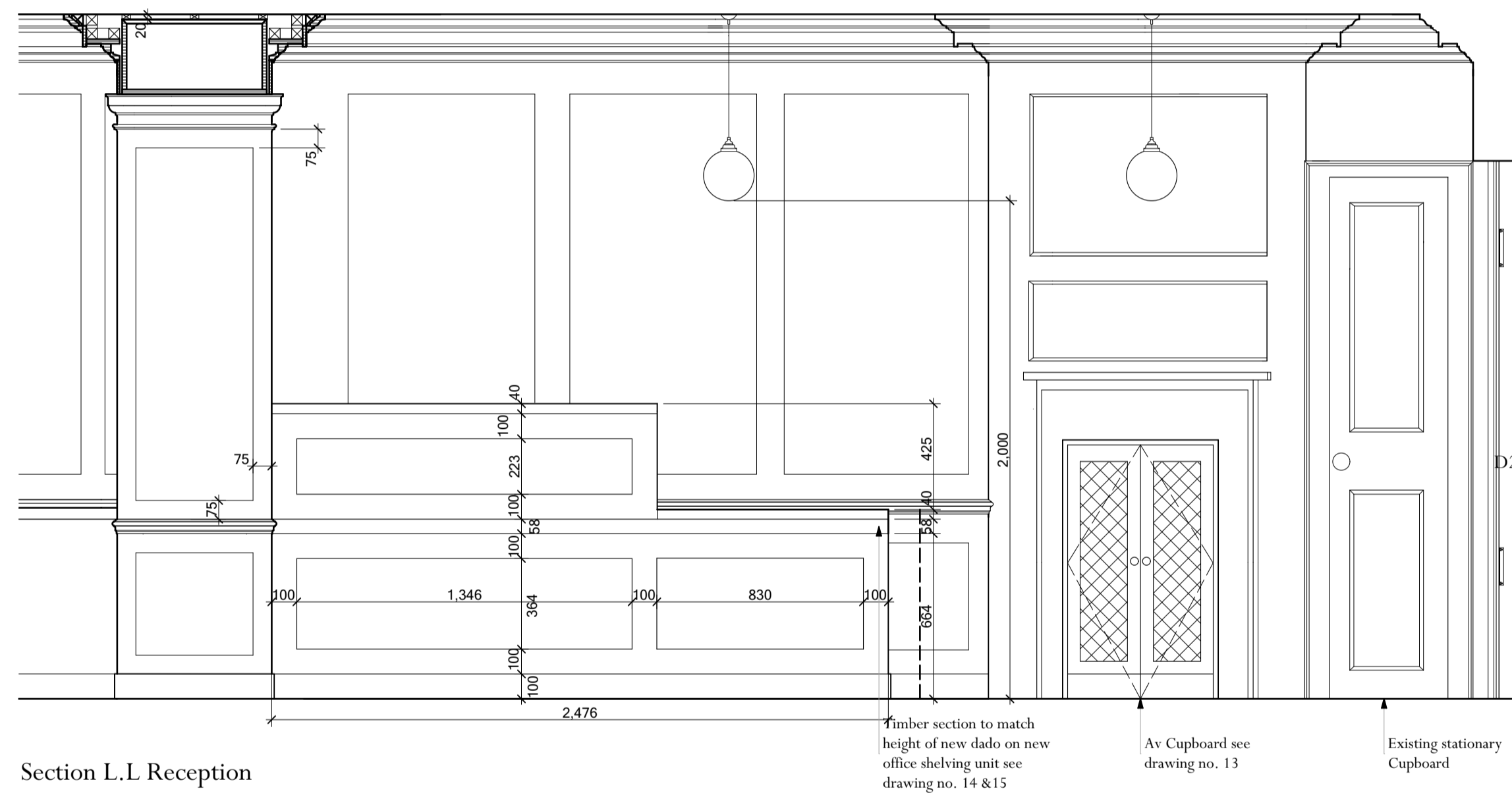

Section L.L Reception

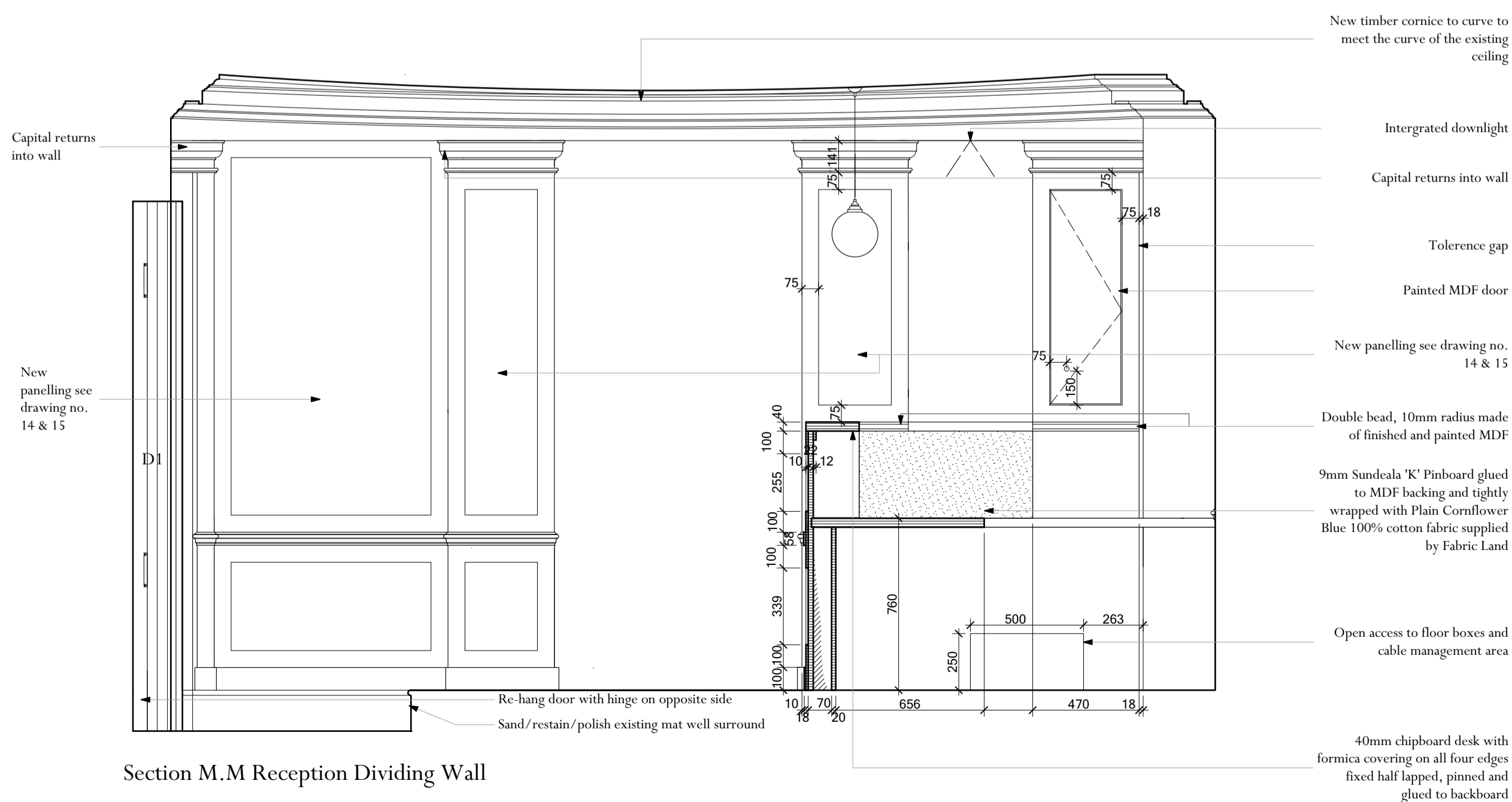

Section M.M Reception Dividing Wall

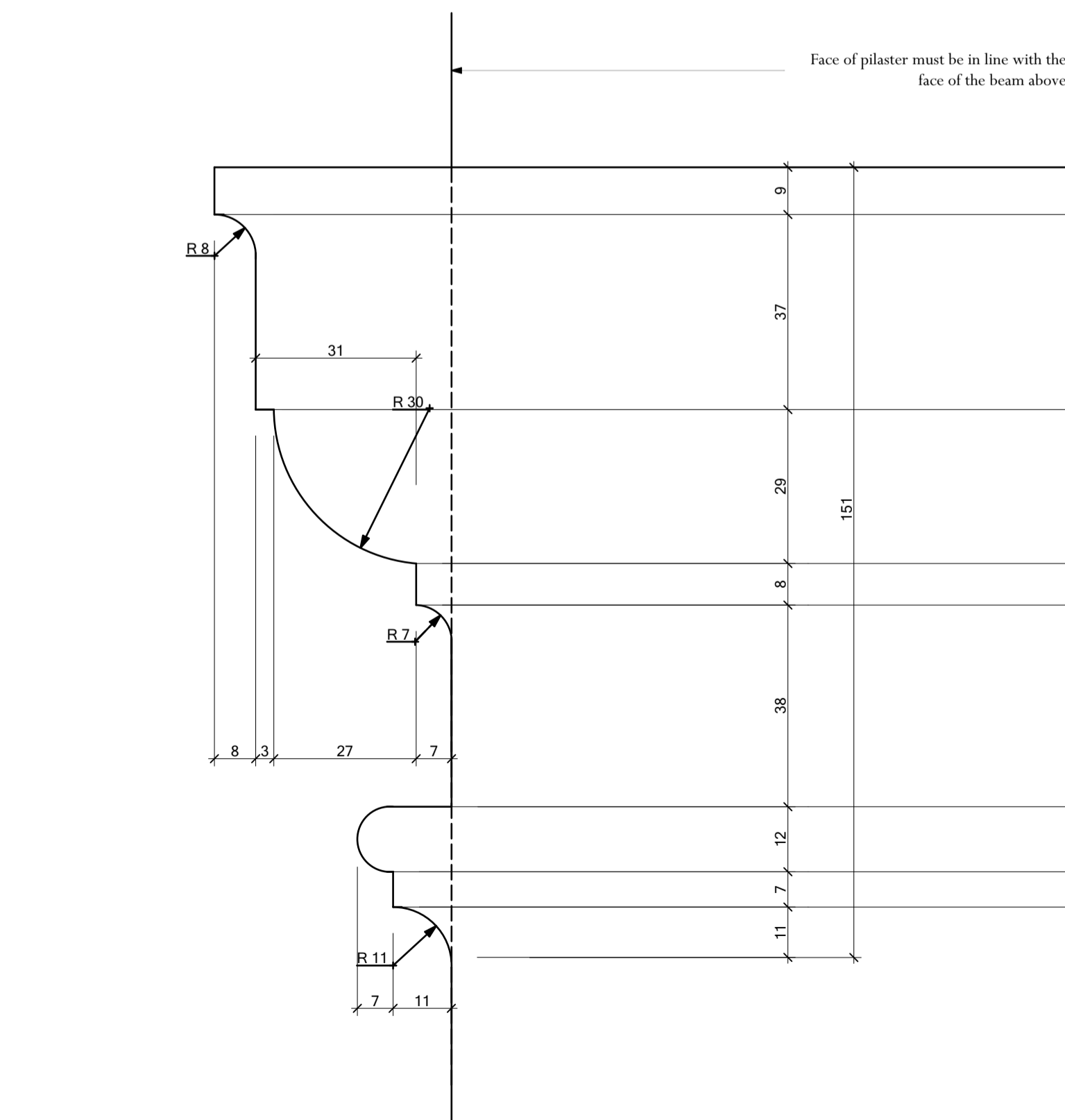
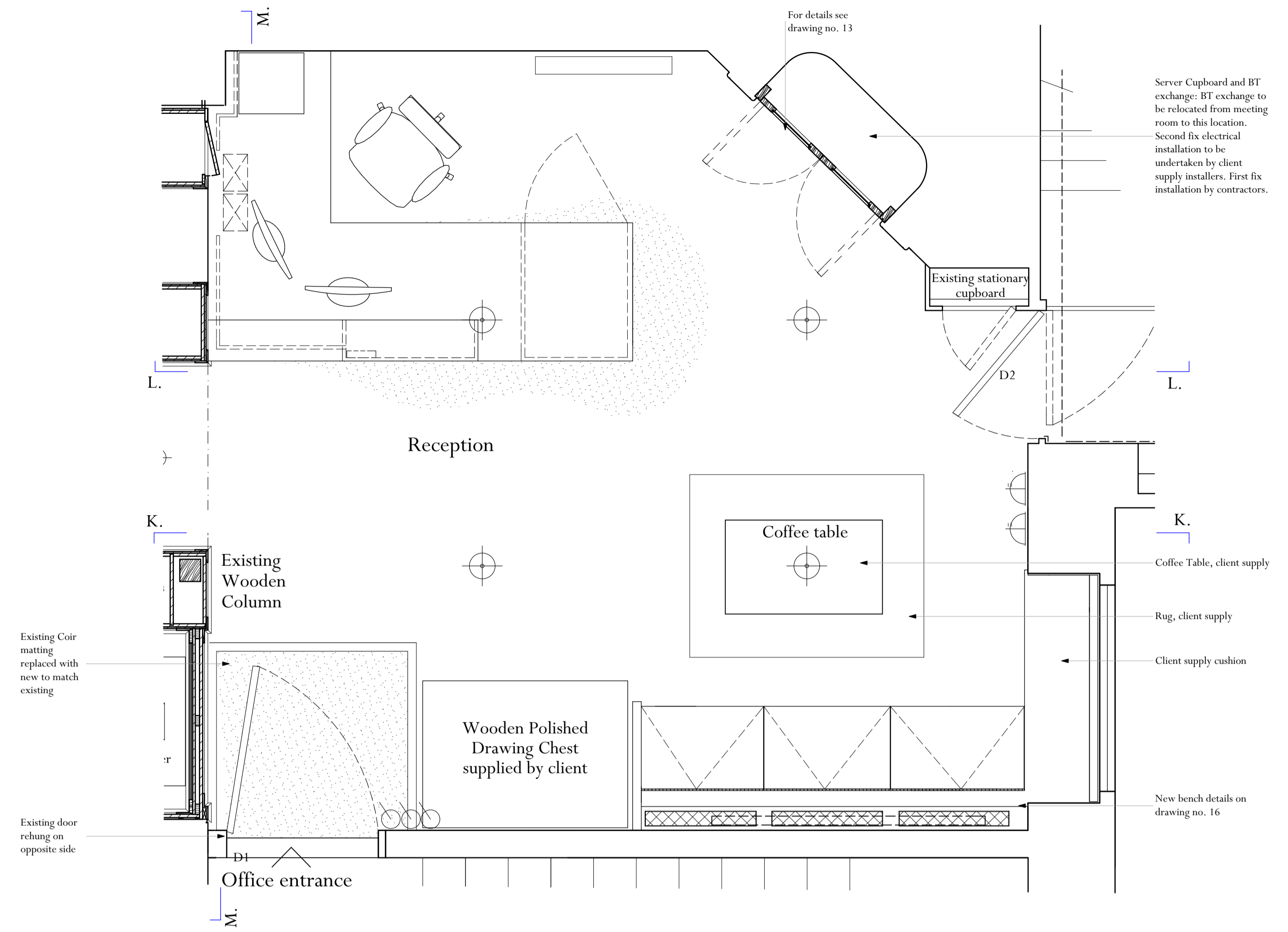

Detail 1: Tuscan Capital Detail 1:1

Rev	Date	Description	Initials
A	03.02.17	Issued for tender	

PROJECT 6 Queen Square Refurbishment
London

TITLE: Proposed Reception Elevations

SCALE: 1:20 & 1:1 @ A1

DATE: Jan. 2017

DRAWING No: 5861 09 A

DRAWN BY: A.H.

ADAM ARCHITECTURE

OLD HYDE HOUSE, 75 HYDE STREET
WINCHESTER, HAMPSHIRE, SO23 7DW
TELEPHONE: 01962 843843 FACSIMILE: 01962 843303
www.adamarchitecture.com contact@adamarchitecture.com

LONDON OFFICE: 6 QUEEN SQUARE, WC1N 3AT
TELEPHONE: 020 7841 0140 FACSIMILE: 01962 843303
ADAM ARCHITECTURE IS A TRADING NAME OF ADAM ARCHITECTURE LIMITED