

**standard notes**

1. Do not scale this drawing.  
2. All dimensions must be checked on site and any discrepancies verified with the architect.  
3. Unless shown otherwise, all dimensions are to structural surfaces.

THIS IS NOT A CONSTRUCTION DRAWING. IT IS UNSUITABLE FOR THE PURPOSE OF CONSTRUCTION AND MUST ON NO ACCOUNT BE USED AS SUCH.

**drawing notes**

- Setting-out of gate actuator and associated equipment to follow principals shown above. Any equipment not shown above (or on drawing S\_411) to be highlighted to architect prior to installation.

Final detail of gate actuator installation by specialist

----- : Indicative of 20mm surface fixed conduit. All fixings to be into mortar joints.

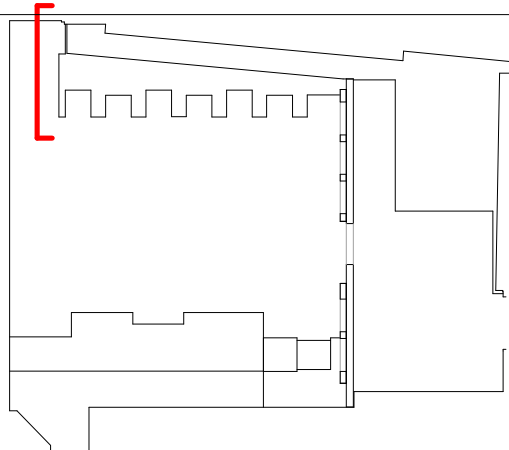

| revisions |          |    |                                   |
|-----------|----------|----|-----------------------------------|
| rev       | date     | by | amendment                         |
| C1        | 23.03.16 | LM | First Issue                       |
| C2        | 04.05.16 | FH | Card reader and dry riser amended |
| C3        | 18.05.16 | FH | Cleaners cabinet removed          |
| C4        | 29.09.16 | FH | Dry riser cabinets revised        |

|    |          |    |   |
|----|----------|----|---|
| C5 | 30.11.16 | FH | Revised to supplier information           |
| C6 | 20.12.16 | FH | Revised to supplier information           |
| C7 | 03.02.17 | FH | Revised following client and MEPH comment |

# Wilkins Terrace

## Balfour Beatty

**date**  
03/08/16

**client**  
Balfour Beatty

**scale**  
As indicated

**drawing**  
NE Key Assembly Section 02

**drawn**  
LM

**checked**  
PM

**drawing number**  
3247 · L · 207

**rev**  
C7

**Levitt Bernstein**  
1 Kingsland Passage  
London  
E8 2BB

t: 020 7275 7676  
fr: 020 7275 9348  
w: levittbernstein.co.uk  
e: post@levittbernstein.co.uk

**Levitt Bernstein**