

General Notes:

1. Dimensions should not be scaled from the drawings where accuracy is essential.
2. Details dimensions and levels to be checked on site by builder prior to commencement of works. Any works commenced prior to all necessary local authority approvals are entirely at the risk of the owner & builder.
3. Structural details are subject to exposure of existing construction and verification by L.A Surveyor and any necessary revised details are to be agreed with the L.A Surveyor prior to carrying out the affected works.
4. All materials are to be used in accordance with the manufacturers' guidelines and all relevant British Standards Codes of Practice & Regulation 7 of Building Regs.
5. All works are to be carried out in accordance with Local Authority requirements.
6. The intended works fall within the Party Wall Act 1996 and any adjoining owners affected must be notified prior to commencement of any works.
7. Thames Water Authority permission to be obtained if building over or adjacent to sewers within 3 metres. (Tel: 08459 200 800)
8. No part of the extension to project into adjoining boundary lines.



Town Planners & Architectural Consultants
 Est. 1988
 01689 875 999

Client:
 Mr W Chow

Project:
 237-239 West End Lane
 London
 NW6 1XN

Title:
 Decking with timber enclosure to forecourt

Drawn: R. Gökce

Drawing No. DP/2948/OF/01

Scale : 1:50 @ A3

Date : Jan. 2017

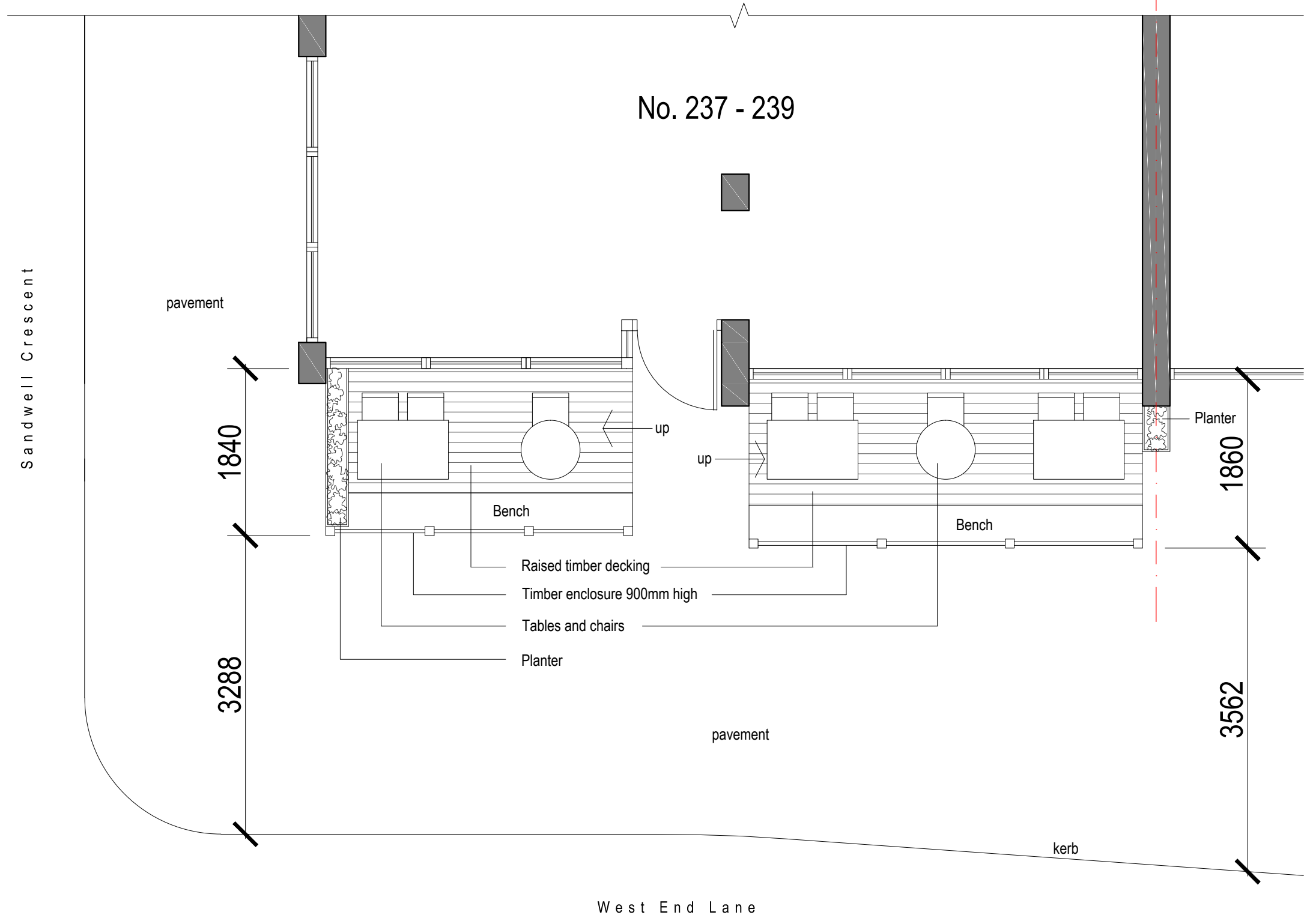

EXISTING GROUND FLOOR PLAN
 SCALE: 1/50

Printed drawings should be to scale when scaled off from the scale bar on the appropriate sized sheet.

