

APPENDIX 7.0

IN RELATION TO DISCHARGE OF CONDITION 3

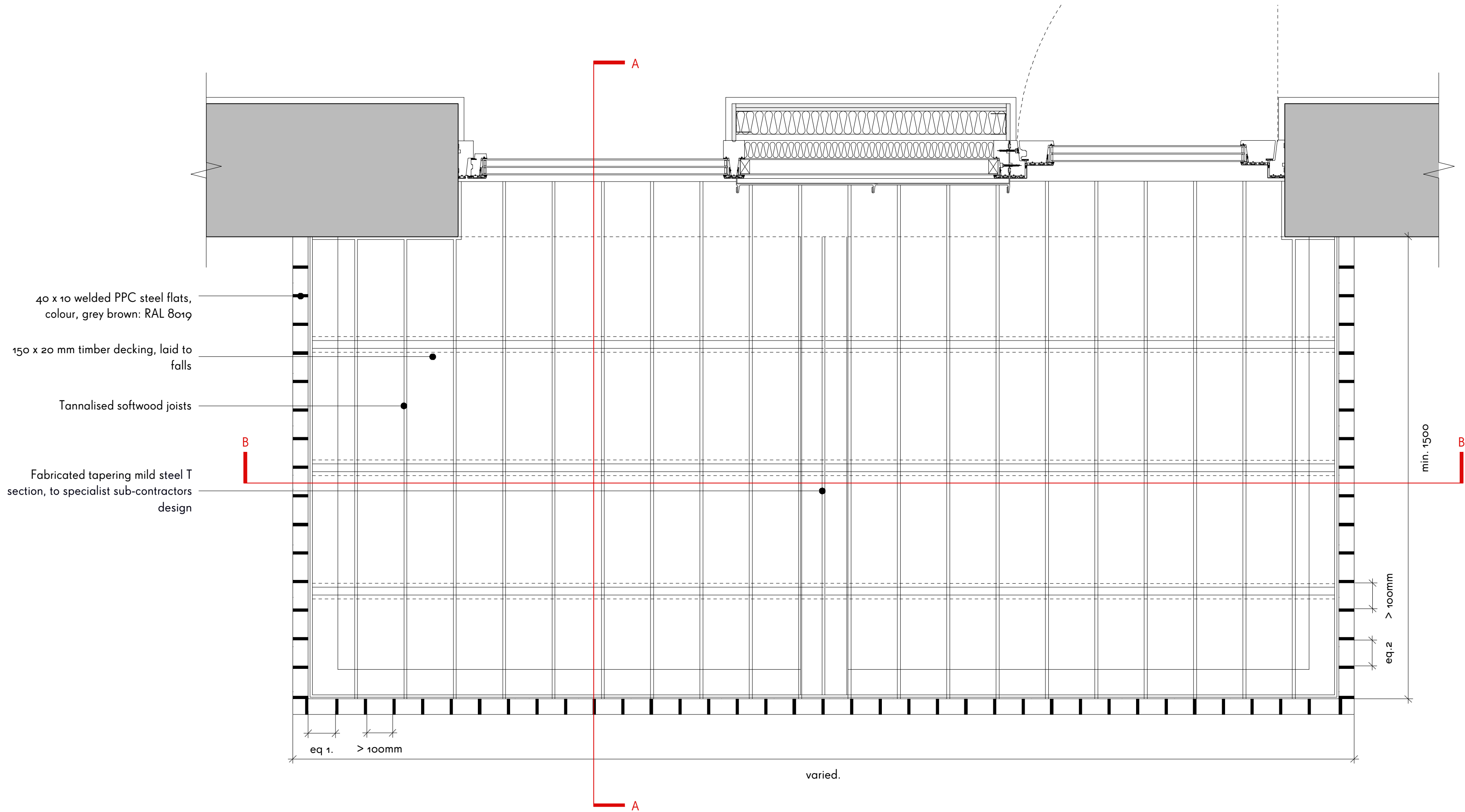

PLAN A
Typical balcony detailed plan

This drawing is prepared for the purposes of a planning application and to show design intent only. The information contained herein must not be used for costing, construction, engineering or any other purposes without agreement in writing from Waugh Thistleton Architects Ltd.

NOTES

Material Key:

- lstock cooksbridge yellow clamp stock
- Euromix mortar 'natural'
- VM zinc pigmento 'autumn red'
- RAL colour: 8019
- Portland stone coping

Fibre C FE ferro 'sahara'

NB. For further information on material specification and supplier details, please refer to section 1.0 'outline specifications' of the material specification document.

REV NOTES

DATE

CHK

**WAUGH
THISTLETON
ARCHITECTS**

77 LEONARD STREET LONDON EC2A 4QS
+44 (0) 207 6135737 WAUGHTHISTLETON.COM

STATUS

PLANNING

Job 277a Gray's Inn Road
Title Typical Balcony Detailed Plan
Sheet 1 of 9
Date October 2016
Scale 1:10 @ A2
Drawn JY

1_529-A-PL-511

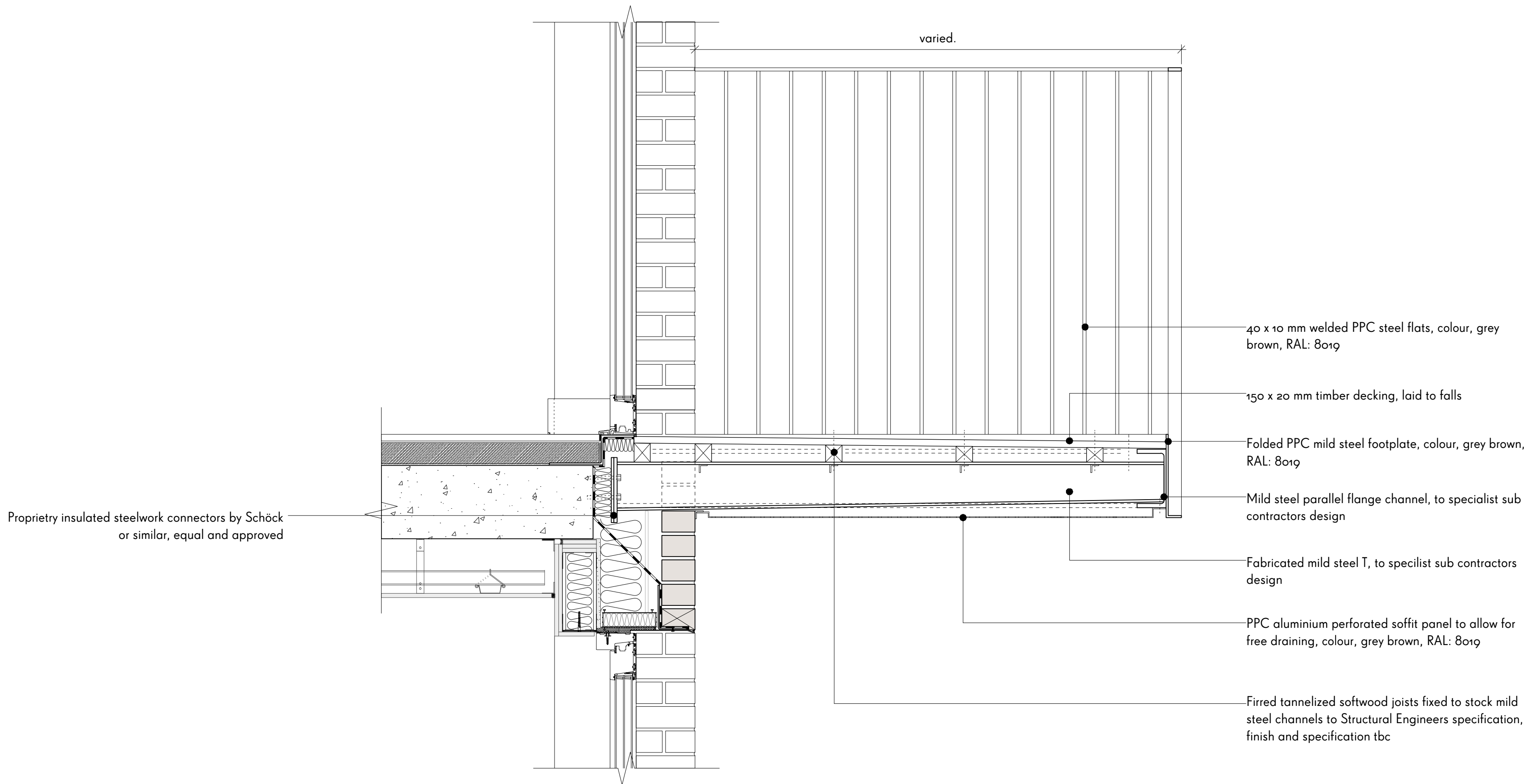

SECTION A-A
Typical balcony detailed section

This drawing is prepared for the purposes of a planning application and to show design intent only. The information contained herein must not be used for costing, construction, engineering or any other purposes without agreement in writing from Waugh Thistleton Architects Ltd.

NOTES

Material Key:

- 1bstock cooksbridge yellow clamp stock
- Euromix mortar 'natural'
- VM zinc pigmento 'autumn red'
- RAL colour: 8019
- Portland stone coping

Fibre C FE ferro 'sahara'

NB. For further information on material specification and supplier details, please refer to section 1.0 'outline specifications' of the material specification document.

REV NOTES

DATE

CHK

**WAUGH
THISTLETON
ARCHITECTS**

77 LEONARD STREET LONDON EC2A 4QS
+44 (0) 207 6135737 WAUGHTHISTLETON.COM

STATUS

PLANNING

Job 277a Gray's Inn Road
Title Typical Balcony Detailed Section AA
Sheet 2 of 9
Date October 2016
Scale 1:10 @ A2
Drawn JY

1_529-A-PL-512

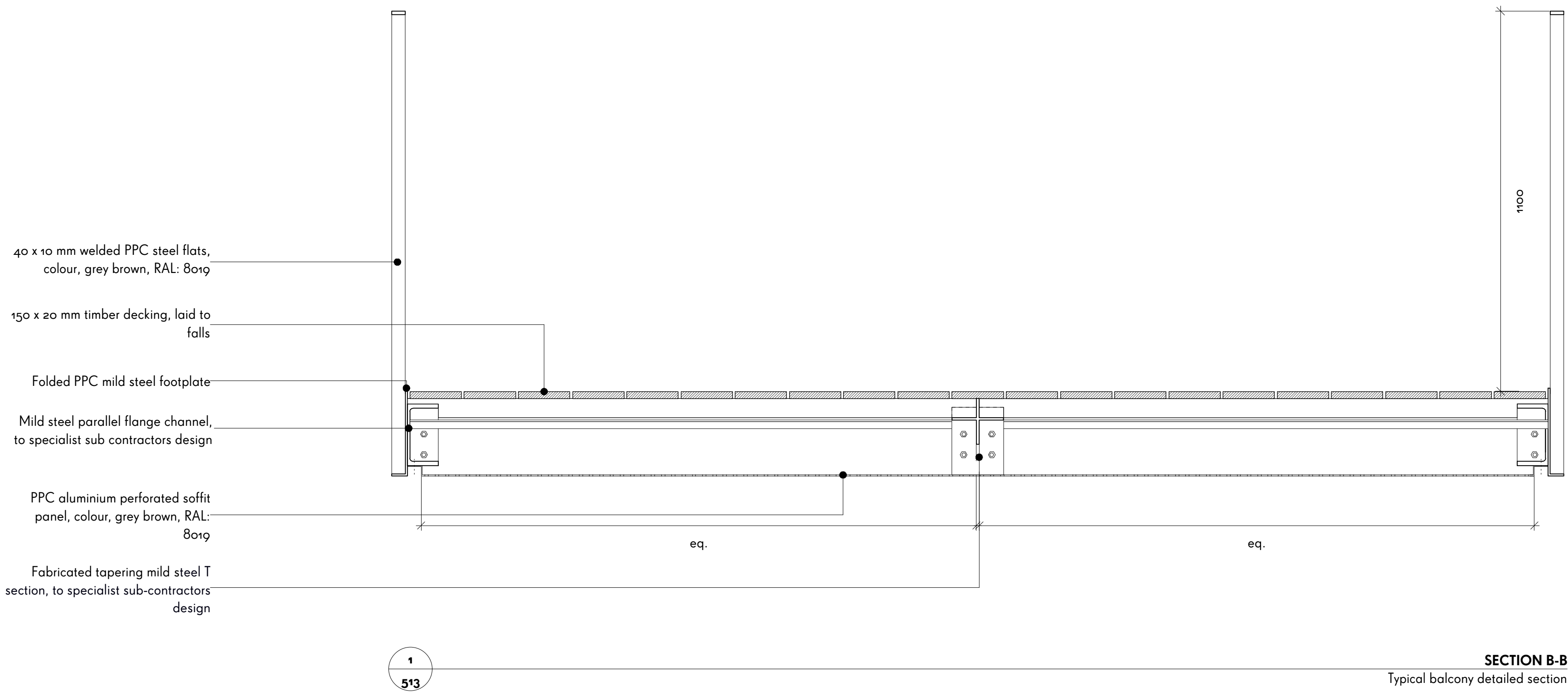

SECTION B-B

Typical balcony detailed section

This drawing is prepared for the purposes of a planning application and to show design intent only. The information contained herein must not be used for costing, construction, engineering or any other purposes without agreement in writing from Waugh Thistleton Architects Ltd.

NOTES

Material Key:

- lstock coaksbridge yellow clamp stock
- Euromix mortar 'natural'
- VM zinc pigmento 'autumn red'
- RAL colour: 8019
- Portland stone coping

Fibre C FE ferro 'sahara'

NB. For further information on material specification and supplier details, please refer to section 1.0 'outline specifications' of the material specification document.

REV NOTES

DATE

CHK

WAUGH
THISTLETON
ARCHITECTS

77 LEONARD STREET LONDON EC2A 4QS
+44 (0) 207 6135737 WAUGHTHISTLETON.COM

STATUS

PLANNING

Job 277a Gray's Inn Road
Title Typical Balcony Detailed Section BB
Sheet 3 of 9
Date October 2016
Scale 1:10 @ A2
Drawn JY

1_529-A-PL-513

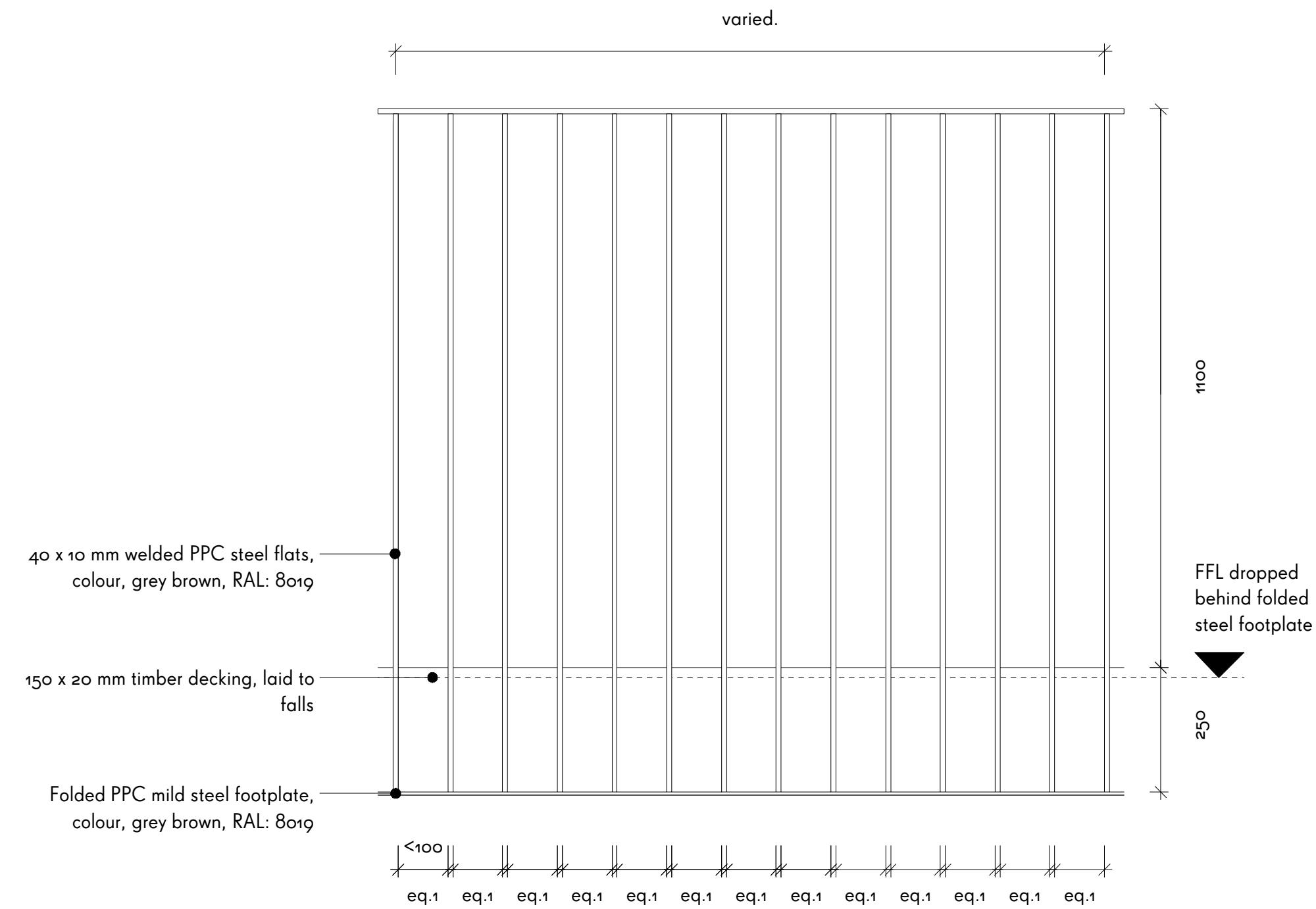

1
514

ELEVATION A
Typical balcony detailed elevation

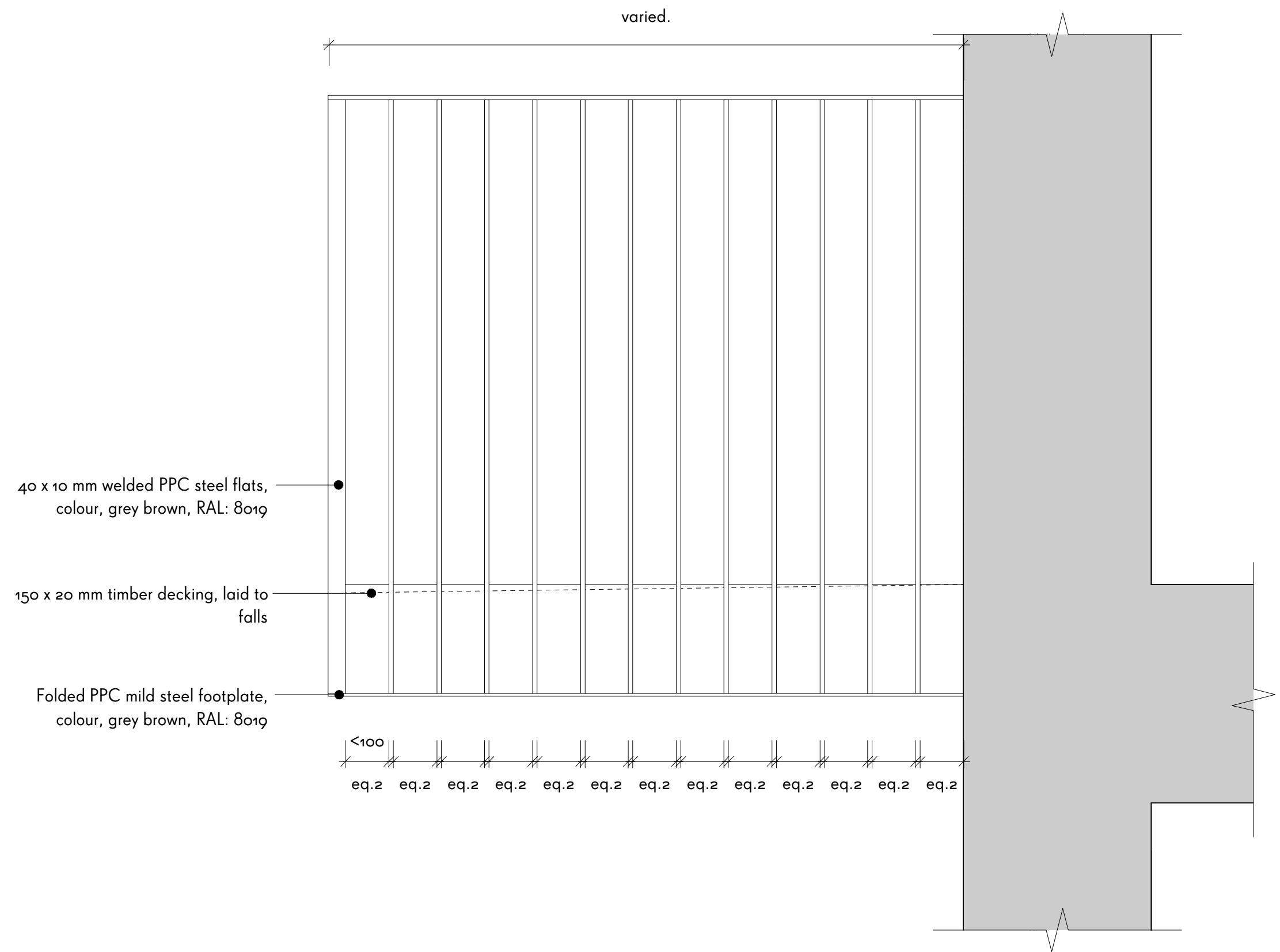

2
514

ELEVATION B
Typical balcony detailed elevation

This drawing is prepared for the purposes of a planning application and to show design intent only. The information contained herein must not be used for costing, construction, engineering or any other purposes without agreement in writing from Waugh Thistleton Architects Ltd.

NOTES

Material Key:

- lstock cooksbridge yellow clamp stock
- Euromix mortar 'natural'
- VM zinc pigmento 'autumn red'
- RAL colour: 8019
- Portland stone coping

Fibre C FE ferro 'sahara'

NB: For further information on material specification and supplier details, please refer to section 1.0 'outline specifications' of the material specification document.

REV NOTES

DATE

CHK

**WAUGH
THISTLETON
ARCHITECTS**

77 LEONARD STREET LONDON EC2A 4QS
+44 (0) 207 6135737 WAUGHTHISTLETON.COM

STATUS

PLANNING

Job 277a Gray's Inn Road
Title Typical Balcony Detailed Elevation
Sheet 4 of 9
Date October 2016
Scale 1:10 @ A2
Drawn JY

1_529-A-PL-514

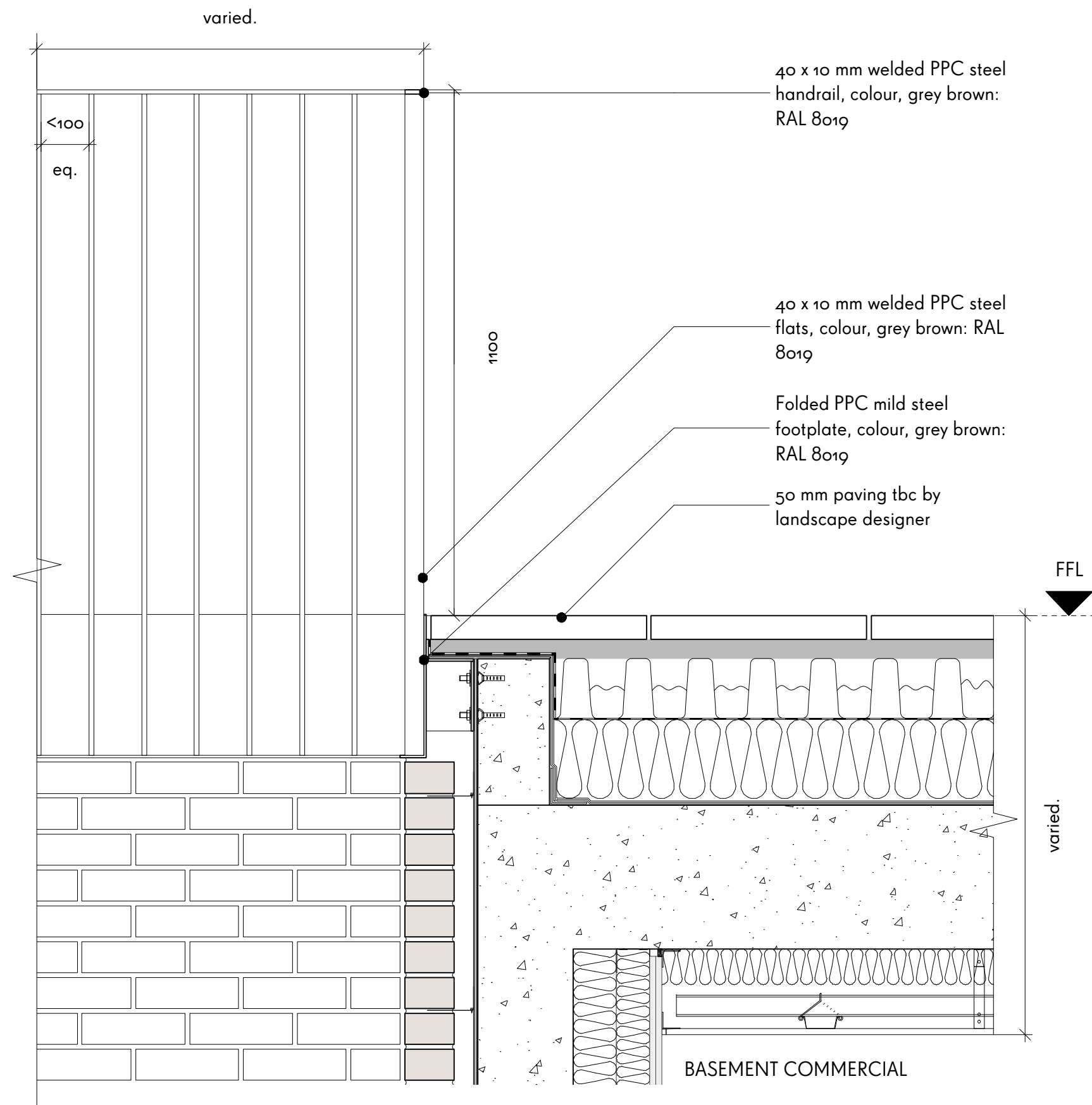

1
515

SECTION 01
Typical balustrade to lightwell

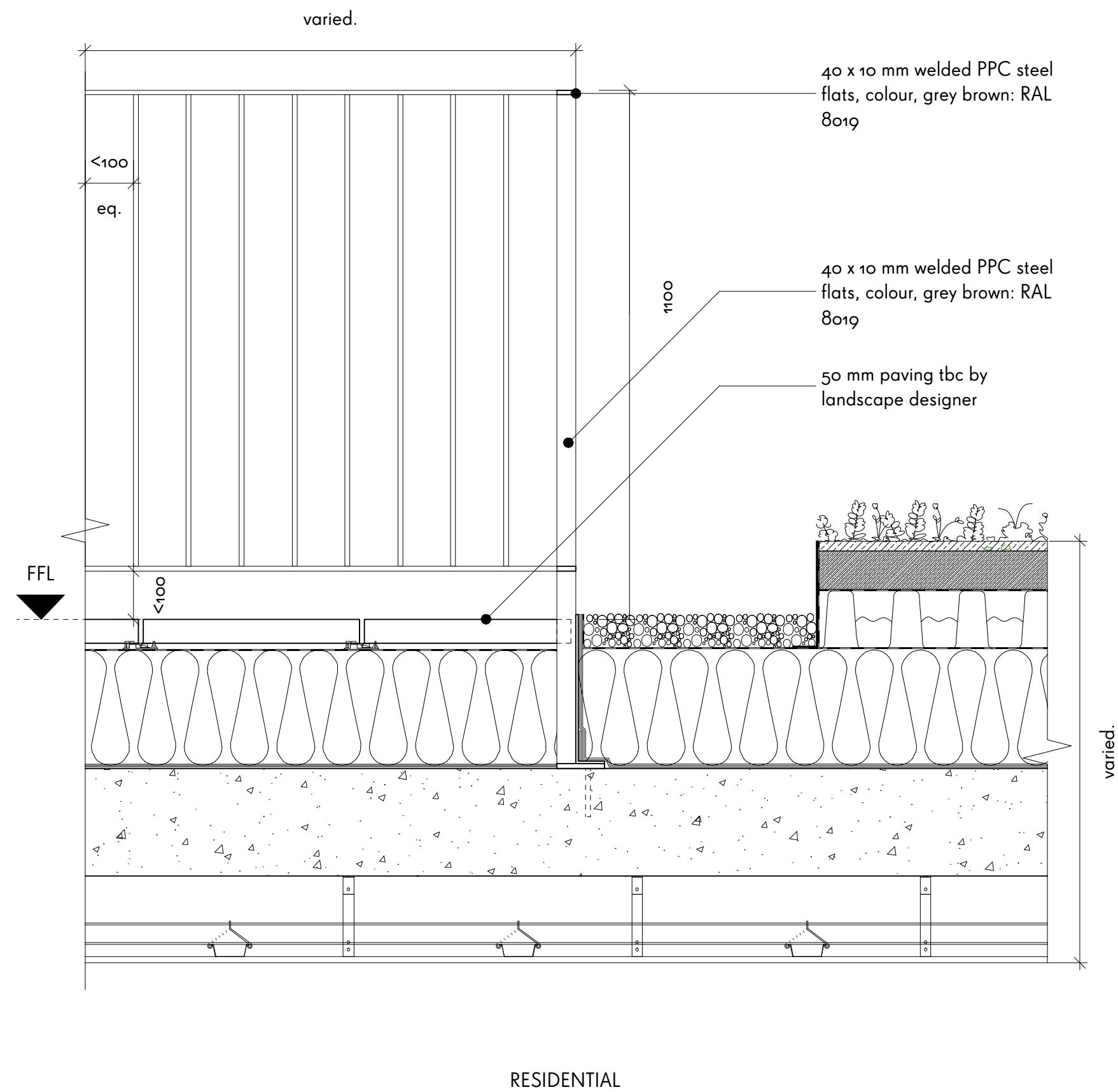

2
515

SECTION 02
Typical balustrade to lightwell

This drawing is prepared for the purposes of a planning application and to show design intent only. The information contained herein must not be used for costing, construction, engineering or any other purposes without agreement in writing from Waugh Thistleton Architects Ltd.

NOTES

Material Key:



NB. For further information on material specification and supplier details, please refer to section 1.0 'outline specifications' of the material specification document.

REV NOTES

DATE

CHK

**WAUGH
THISTLETON
ARCHITECTS**

77 LEONARD STREET LONDON EC2A 4QS
+44 (0) 207 6135737 WAUGHTHISTLETON.COM

STATUS

PLANNING

Job 277a Gray's Inn Road
Title Typical Balustrade Detailed Section
Sheet 5 of 9
Date October 2016
Scale 1:10 @ A2
Drawn JY

1_529-A-PL-515

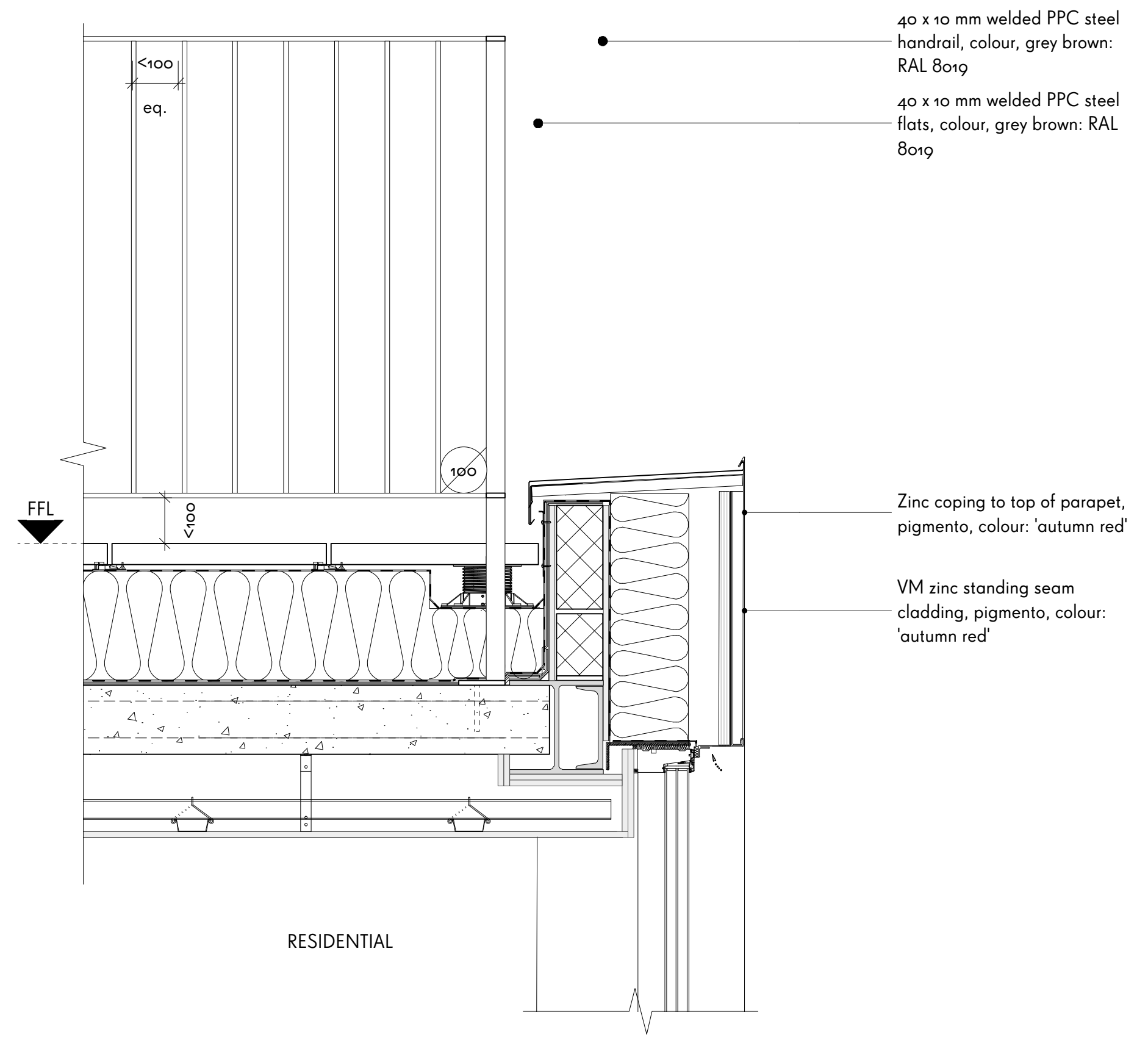
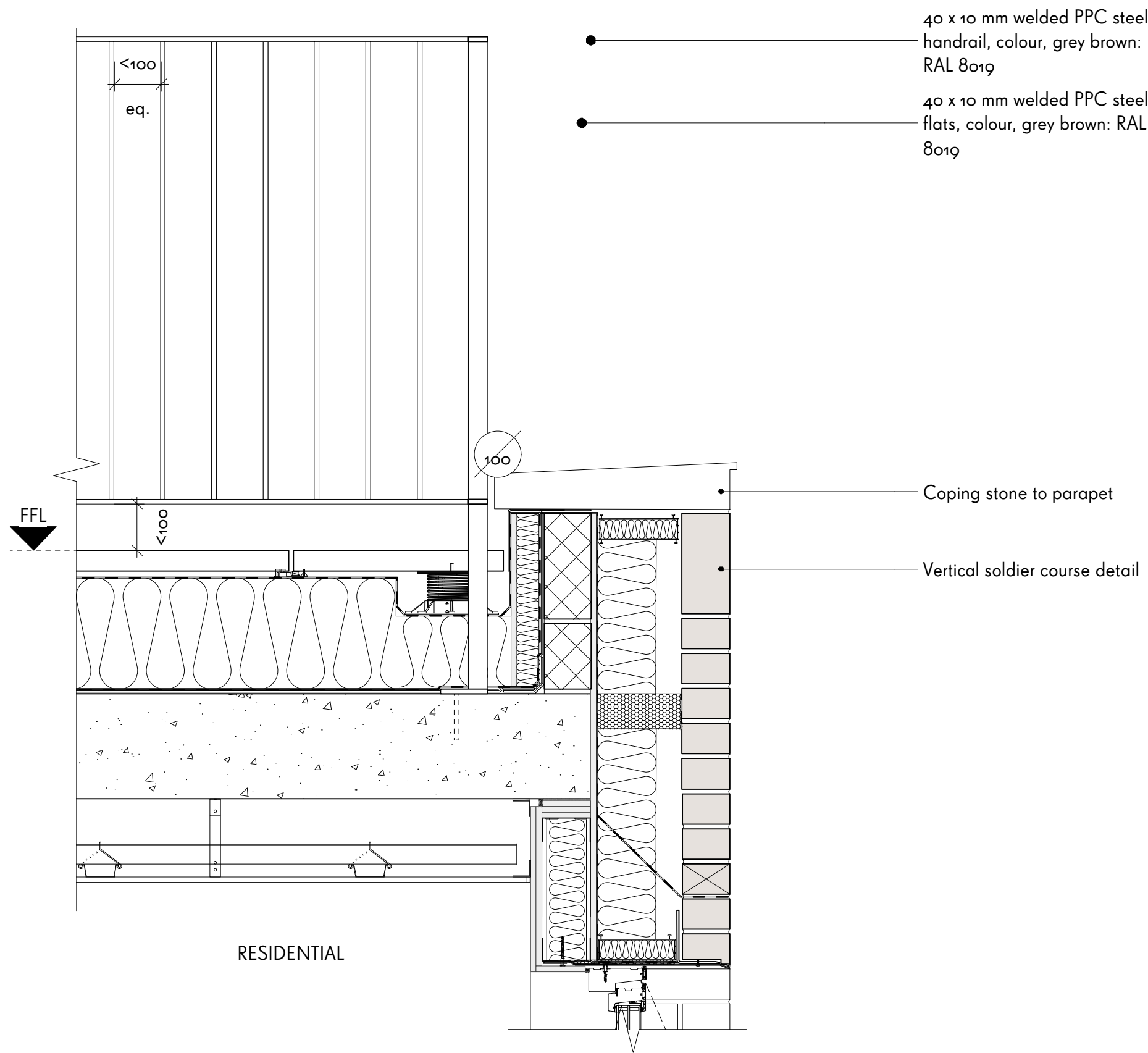

1
516

SECTION 03
Typical balustrade to parapet with coping stone

2
516

SECTION 04
Typical balustrade to zinc parapet

This drawing is prepared for the purposes of a planning application and to show design intent only. The information contained herein must not be used for costing, construction, engineering or any other purposes without agreement in writing from Waugh Thistleton Architects Ltd.

NOTES

Material Key:



NB: For further information on material specification and supplier details, please refer to section 1.0 'outline specifications' of the material specification document.

REV NOTES

DATE

CHK

**WAUGH
THISTLETON
ARCHITECTS**

77 LEONARD STREET LONDON EC2A 4QS
+44 (0) 207 6135737 WAUGHTHISTLETON.COM

STATUS

PLANNING

Job 277a Gray's Inn Road
Title Typical Balustrade Detailed Section
Sheet 6 of 9
Date October 2016
Scale 1:10 @ A2
Drawn JY

1_529-A-PL-516

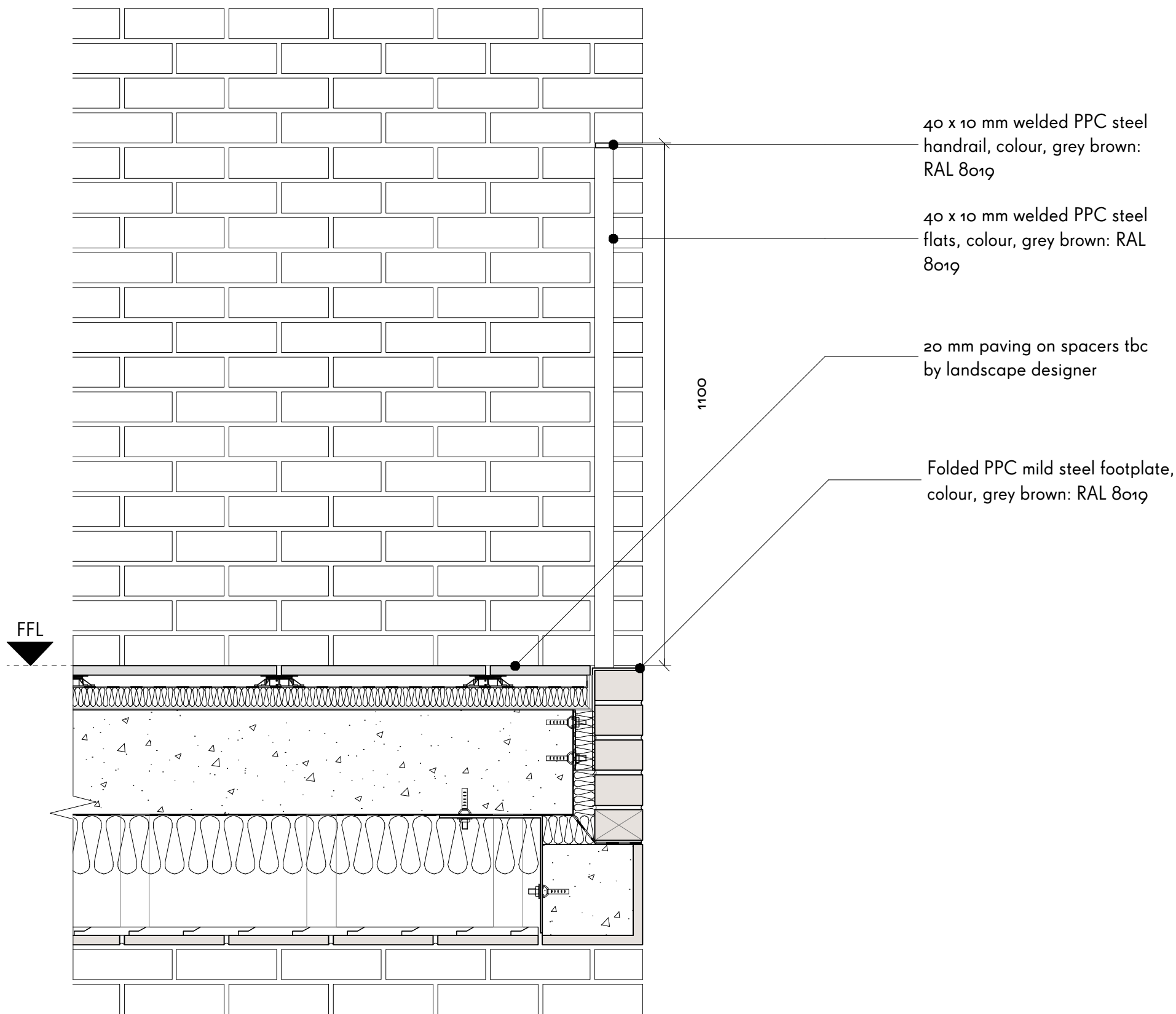

1
517

SECTION 05
Typical balustrade to precast parapet

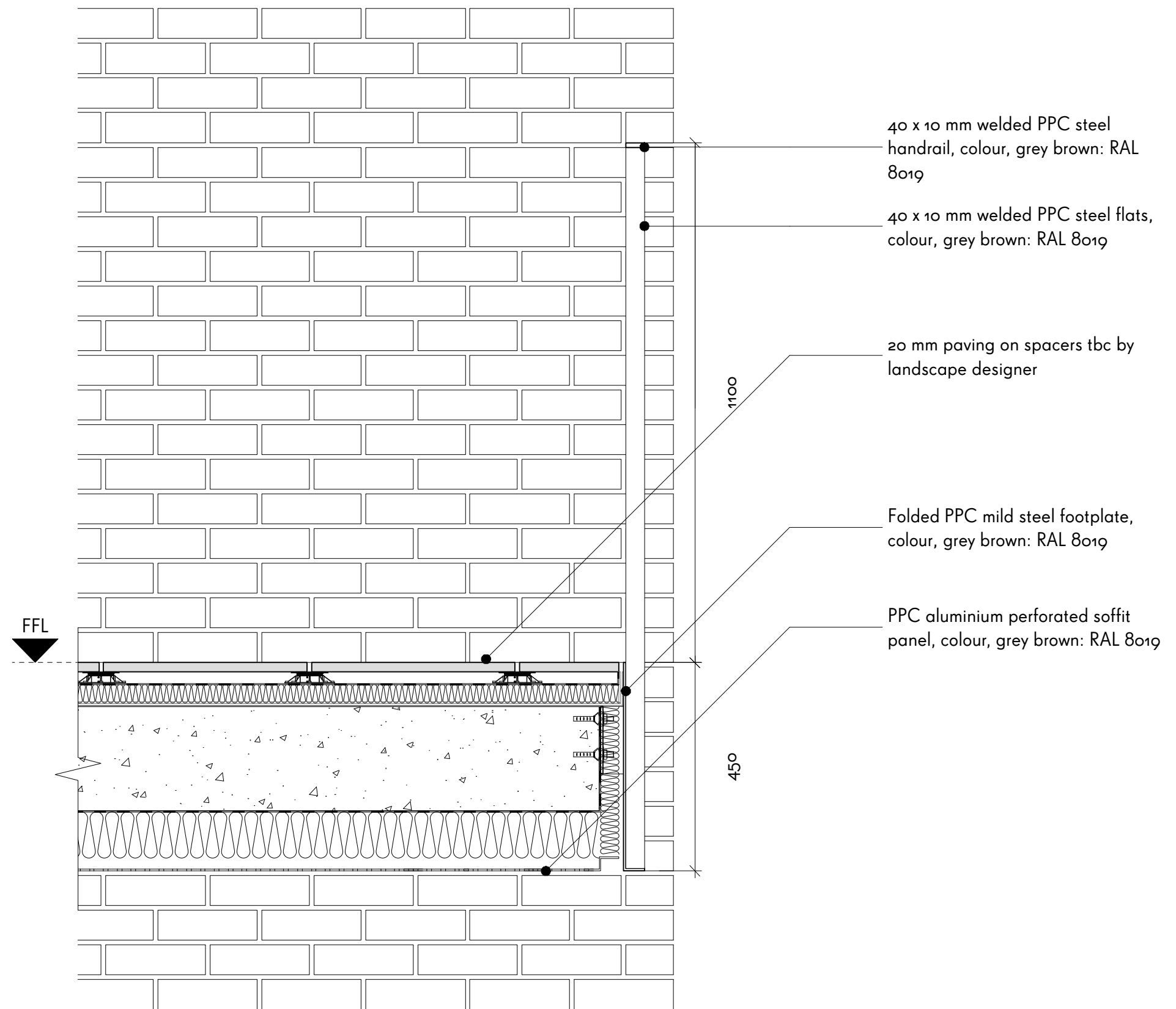

2
517

SECTION 06
Typical balustrade to slab edge

This drawing is prepared for the purposes of a planning application and to show design intent only. The information contained herein must not be used for costing, construction, engineering or any other purposes without agreement in writing from Waugh Thistleton Architects Ltd.

NOTES

Material Key:

- lstock cooksbridge yellow clamp stock
- Euromix mortar 'natural'
- VM zinc pigment 'autumn red'
- RAL colour: 8019
- Portland stone coping

Fibre C FE ferro 'sahara'

NB: For further information on material specification and supplier details, please refer to section 1.0 'outline specifications' of the material specification document.

REV NOTES

DATE

CHK

**WAUGH
THISTLETON
ARCHITECTS**

77 LEONARD STREET LONDON EC2A 4QS
+44 (0) 207 6135737 WAUGHTHISTLETON.COM

STATUS

PLANNING

Job 277a Gray's Inn Road
Title Typical Balustrade Detailed Section
Sheet 7 of 9
Date October 2016
Scale 1:10 @ A2
Drawn JY

1_529-A-PL-517

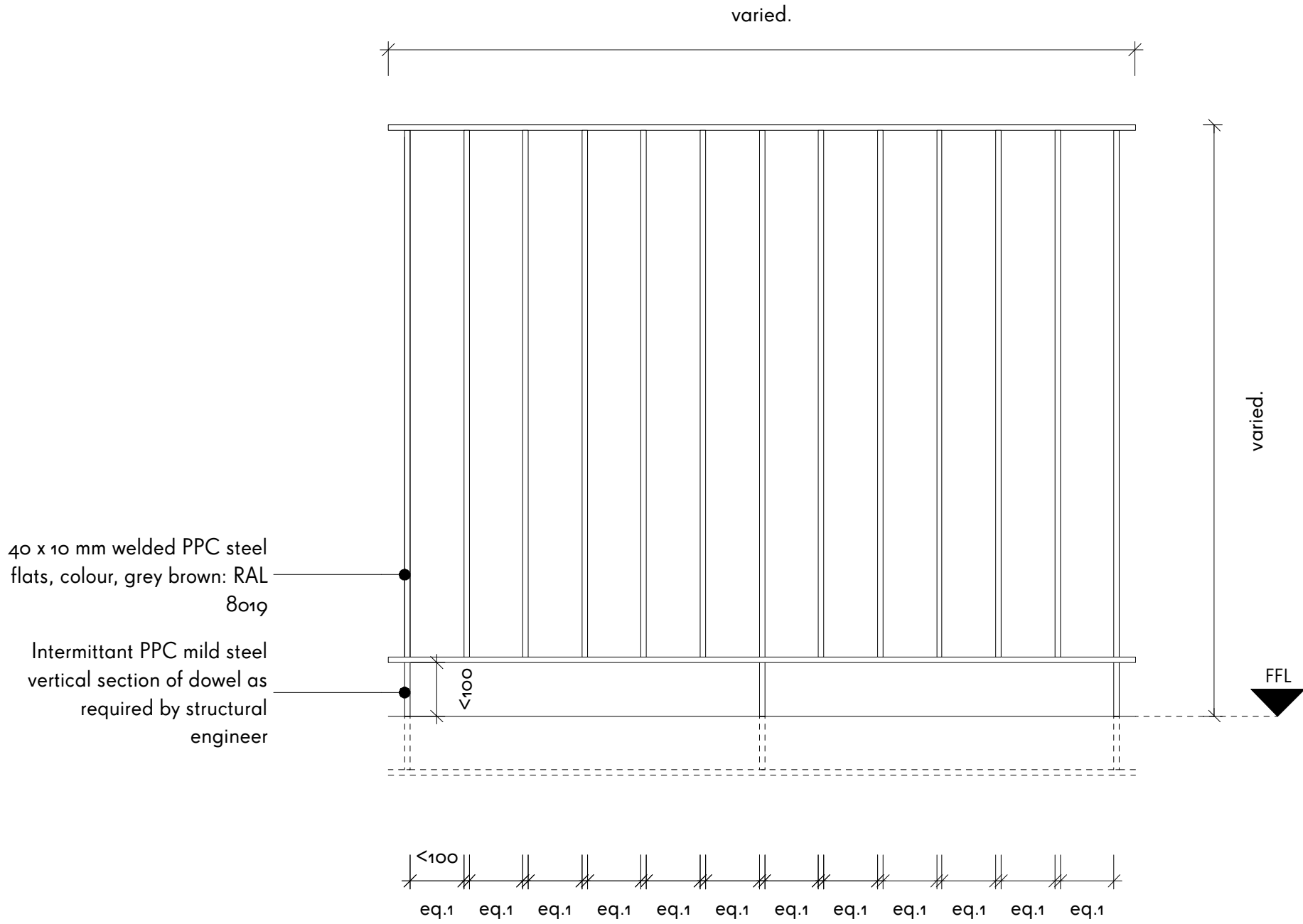

1
518

ELEVATION A
Typical balustrade detailed elevation

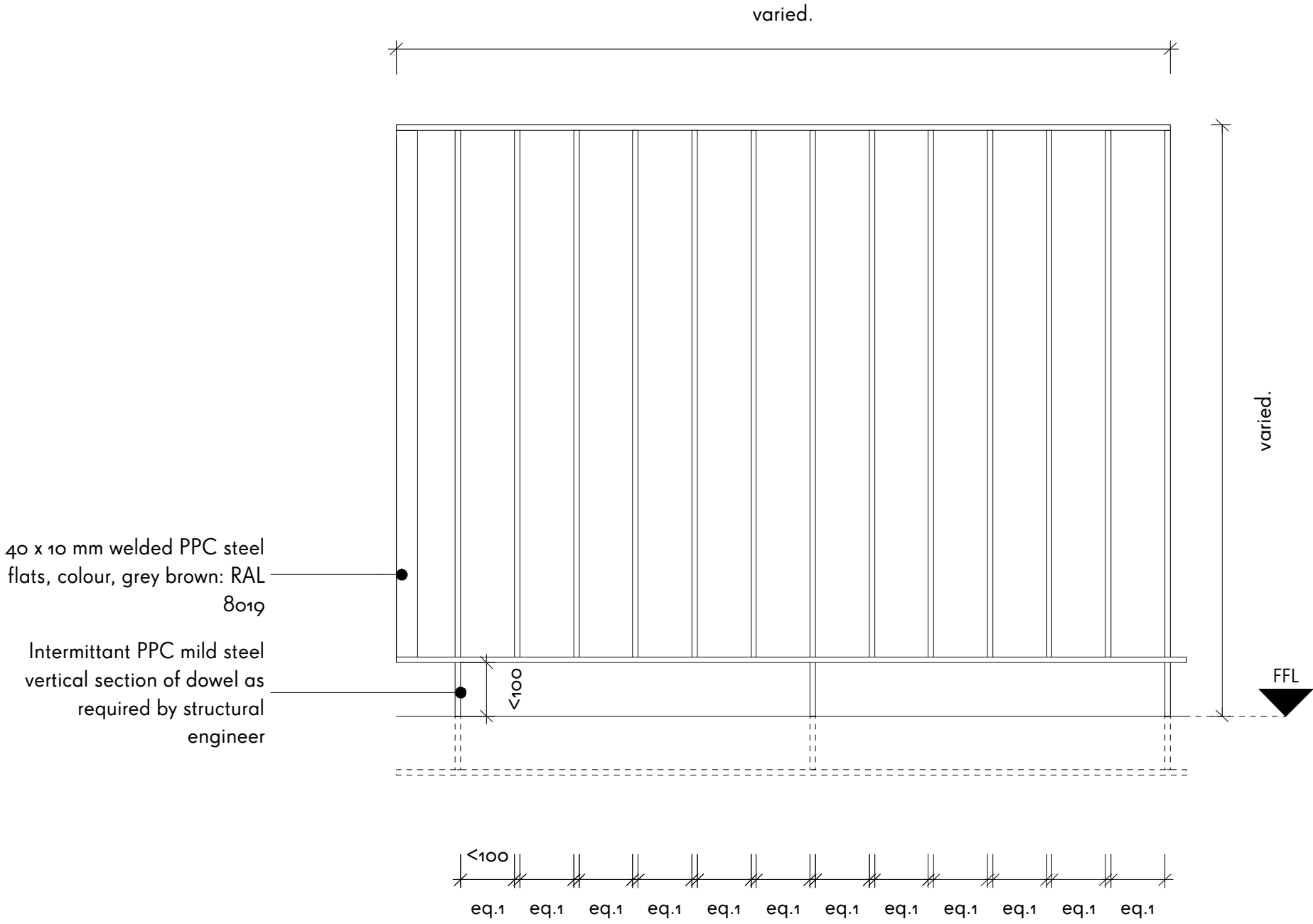

2
518

ELEVATION B
Typical balustrade detailed elevation

This drawing is prepared for the purposes of a planning application and to show design intent only. The information contained herein must not be used for costing, construction, engineering or any other purposes without agreement in writing from Waugh Thistleton Architects Ltd.

NOTES

Material Key:

- lstock cooksbridge yellow clamp stock
- Euromix mortar 'natural'
- VM zinc pigmento 'autumn red'
- RAL colour: 8019
- Portland stone coping

Fibre C FE ferro 'sahara'

NB. For further information on material specification and supplier details, please refer to section 1.0 'outline specifications' of the material specification document.

REV NOTES

DATE

CHK

**WAUGH
THISTLETON
ARCHITECTS**

77 LEONARD STREET LONDON EC2A 4QS
+44 (0) 20 76135737 WAUGHTHISTLETON.COM

STATUS

PLANNING

Job 277a Gray's Inn Road
Title Typical Balustrade Detailed Elevation
Sheet 8 of 9
Date October 2016
Scale 1:10 @ A2
Drawn JY

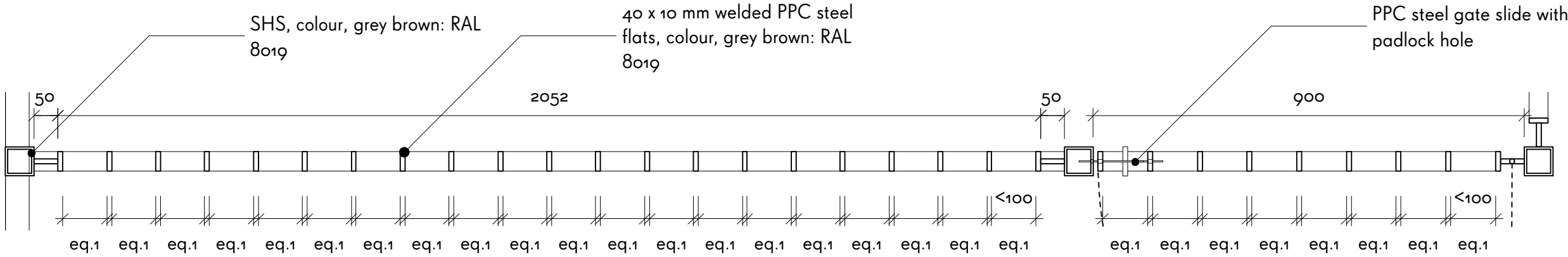

1
519

PLAN A
Typical gated fence to substation

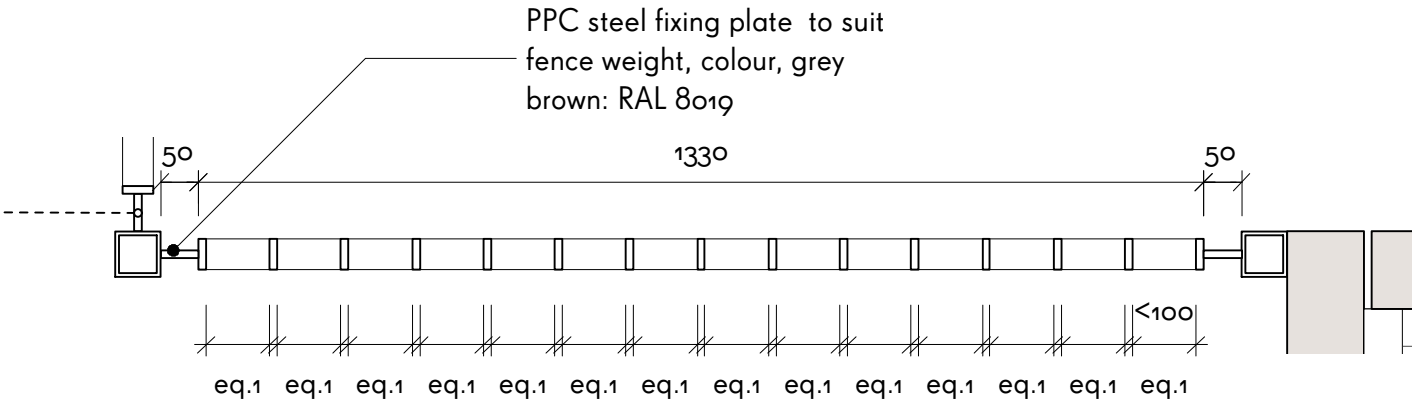

2
519

PLAN B
Typical gated fence to substation

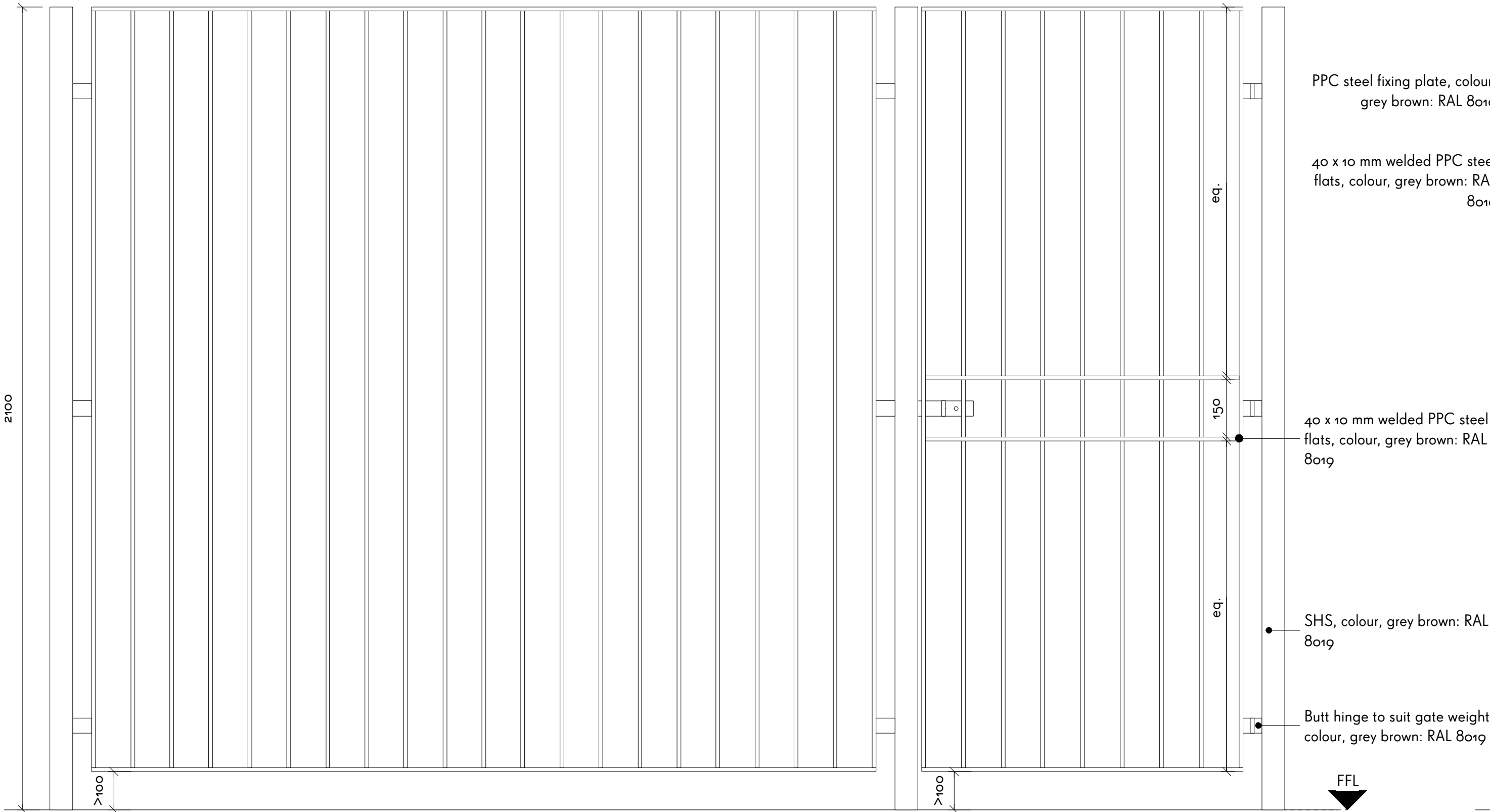

3
519

ELEVATION A
Typical gated fence to substation

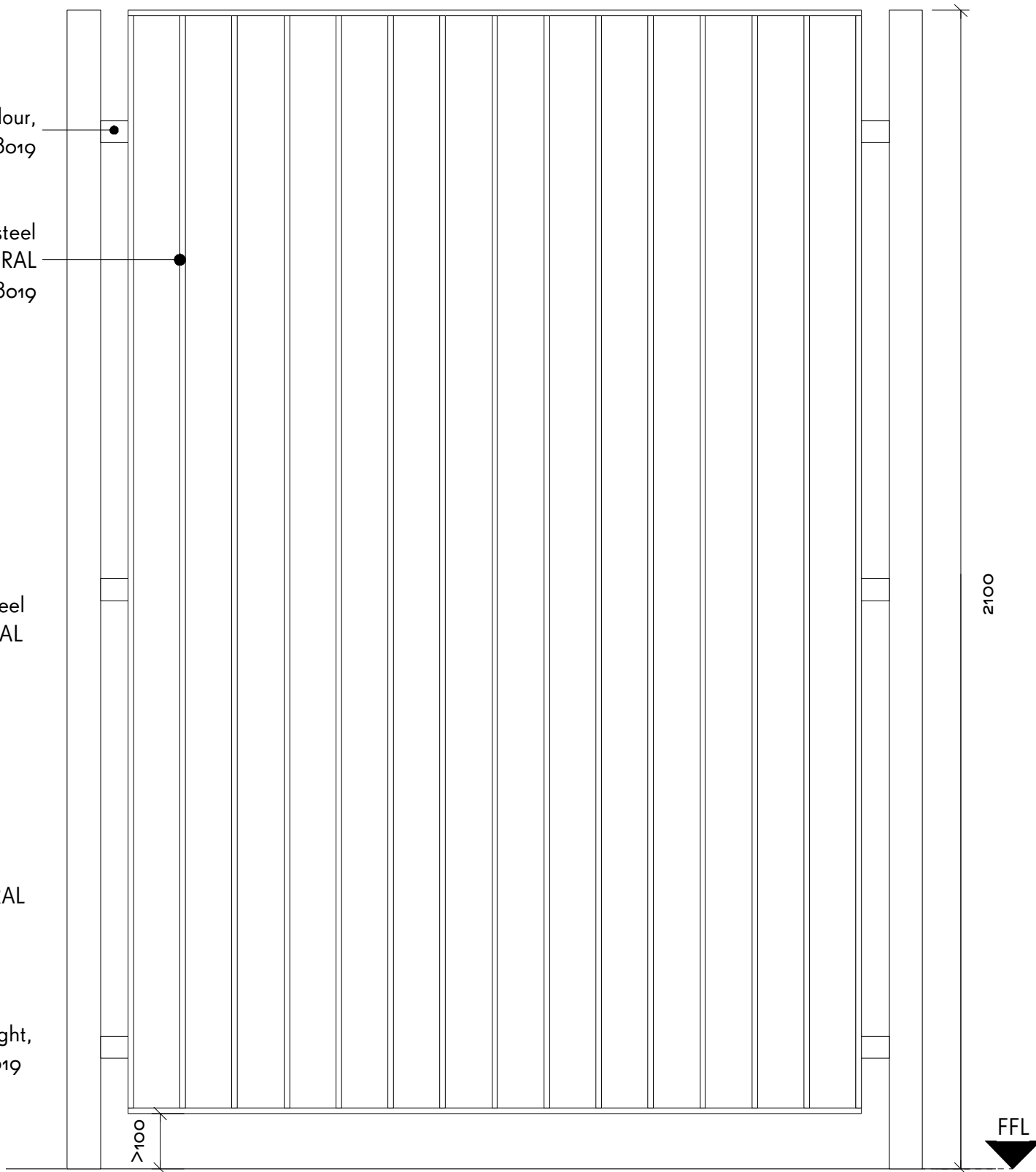

4
519

ELEVATION B
Typical gated fence to substation

NOTES

This drawing is prepared for the purposes of a planning application and to show design intent only. The information contained herein must not be used for costing, construction, engineering or any other purposes without agreement in writing from Waugh Thistleton Architects Ltd.

Material Key:

- 1bstock cooksbridge yellow clamp stock
- Euromix mortar 'natural'
- VM zinc pigmento 'autumn red'
- RAL colour: 8019
- Portland stone coping
- Fibre C FE ferro 'sahara'

NB: For further information on material specification and supplier details, please refer to section 1.0 'outline specifications' of the material specification document.

| REV | NOTES | DATE | CHK |
|-----|-------|------|-----|
| | | | |

**WAUGH
THISTLETON
ARCHITECTS**

77 LEONARD STREET LONDON EC2A 4QS
+44 (0) 207 6135737 WAUGHTHISTLETON.COM

| STATUS | |
|--------------|---|
| Job | 277a Gray's Inn Road |
| Title | Typical Fence Detailed Plan / Elevation Sheet 9 of 9 |
| Date | October 2016 |
| Scale | 1:10 @ A2 |
| Drawn | JY |

PLANNING