

EXISTING FRONT ELEVATION / STREETSCENE 1:100

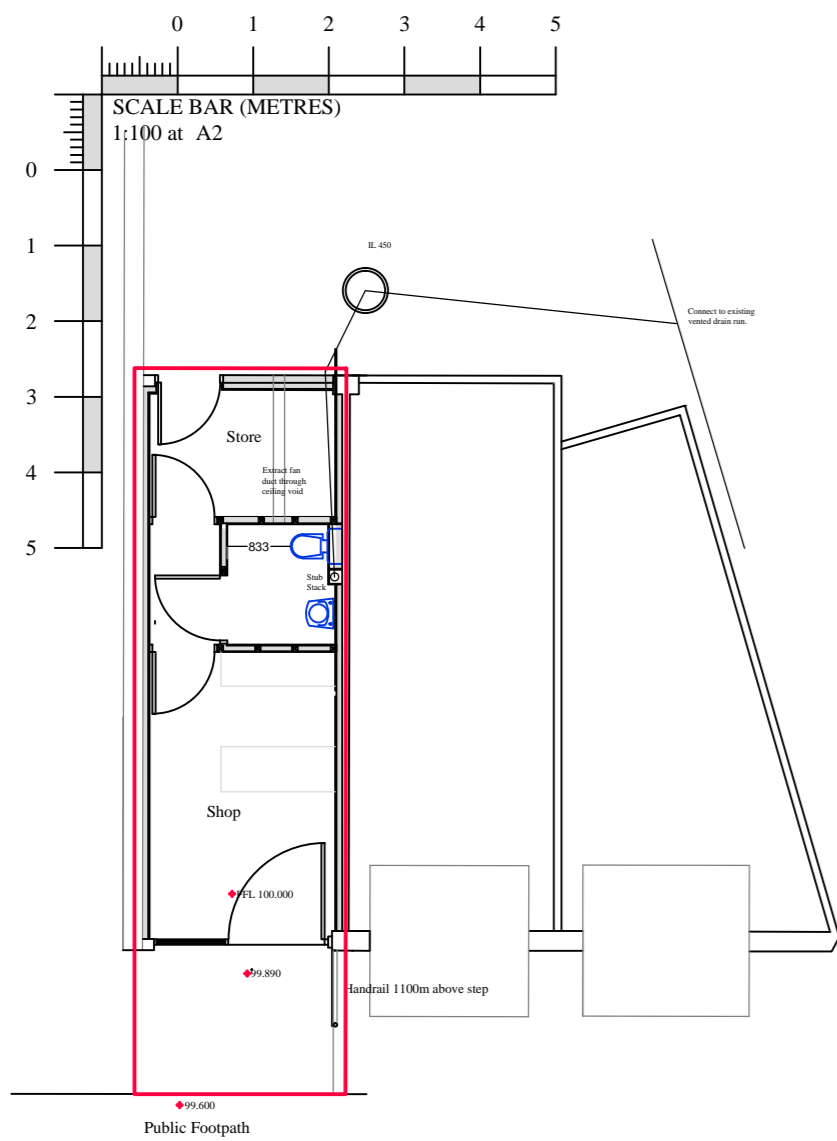

PROPOSED FRONT ELEVATION / STREETSCENE 1:100

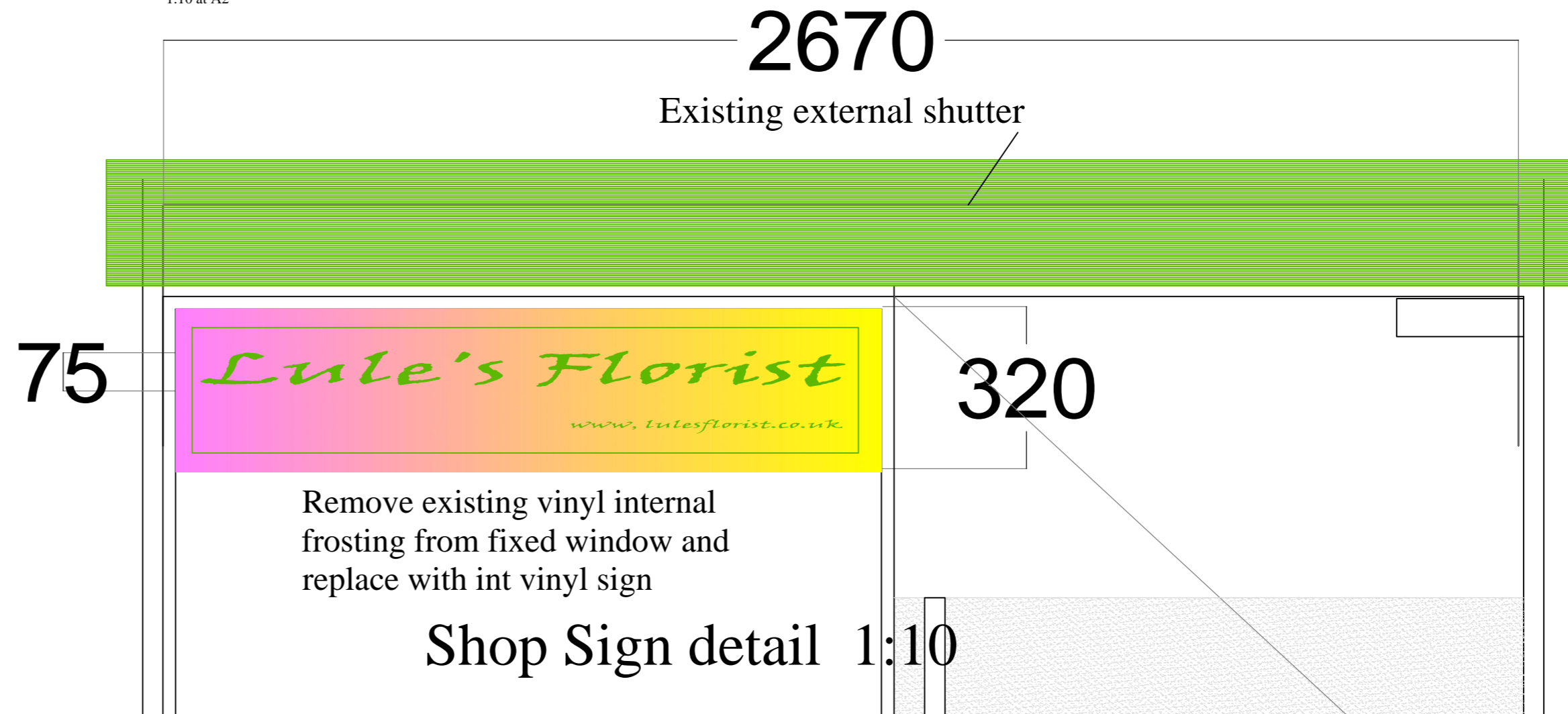

GROUND FLOOR & BLOCK PLAN 1:50  
(Existing & Proposed)

**Notes regarding Change of use**

Existing Front shutter in place for approx 7 years - projects 120mm from facing Brickwork

New Signage entirely internal - No additional lighting

Internal layout unaltered

Staffing - Max 2 people

Hours of business  
Max: 8am - 6pm Mon to Sun

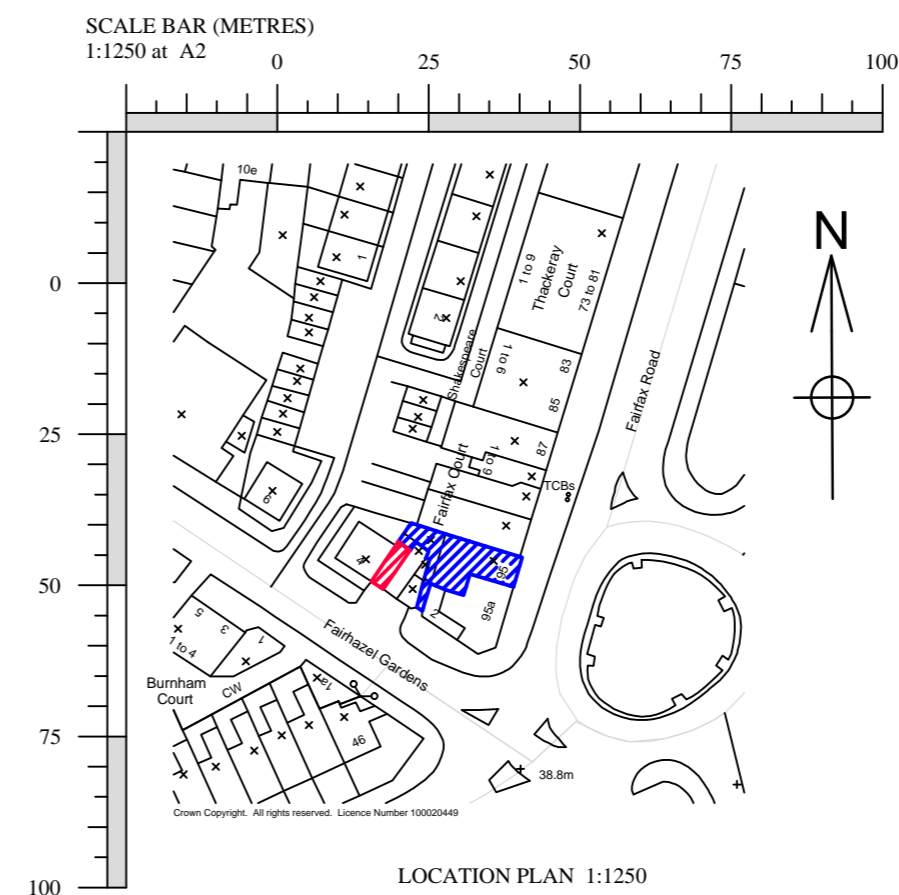

Rev:- C	Date:-15-03-17	Drawn by:- DJP
Details:- Corrected Frontage Detail		
Rev:- B	Date:-16-02-17	Drawn by:- DJP
Details:- Altered opening Hours		
Rev:- A	Date:-14-02-17	Drawn by:- DJP
Details:- Planning		
<b>adpractice ltd.</b>		
2 Mill Walk, Wheathampstead, Herts. AL4 8DT		
Tel: 01582 834361		www.adpractice.co.uk
Fax: 01582 832587		e-mail: enq@adpractice.co.uk
Client:- <b>G Farid - Savemore Supermarket</b>		
Job:- <b>Fairhazel Gardens Rear of 95 Fairfax Road Swiss Cottage</b>		
Detail:- <b>Change of Use to Florist</b>		
Scale:- <b>As shown</b>	Date:- <b>Jan 17</b>	Drawn by:- <b>DJP</b>
Drawing No:- <b>2415 - 01</b>		Rev:- <b>C</b>