

A512/1 - head of door Section

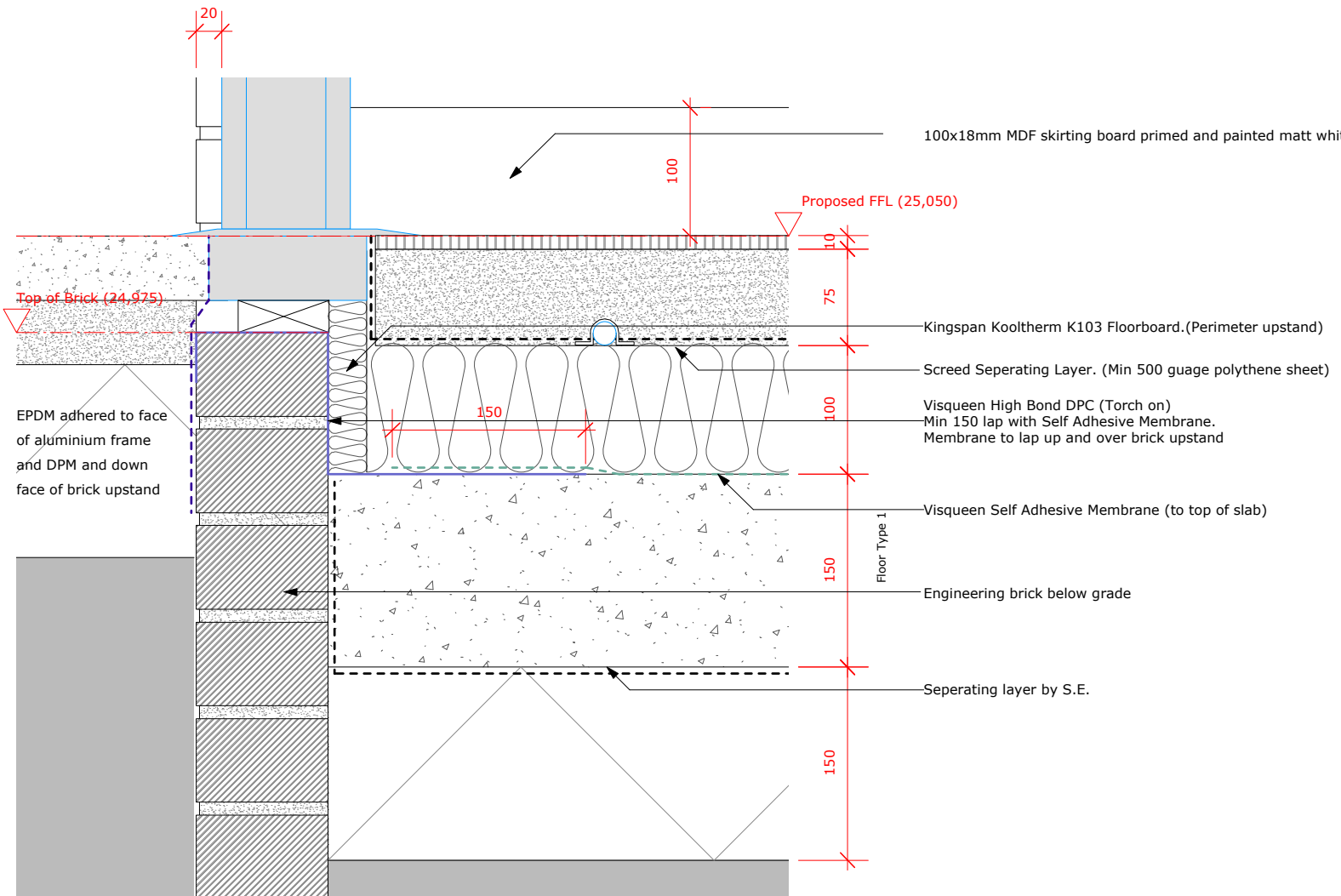

A512/2 - base of door Section

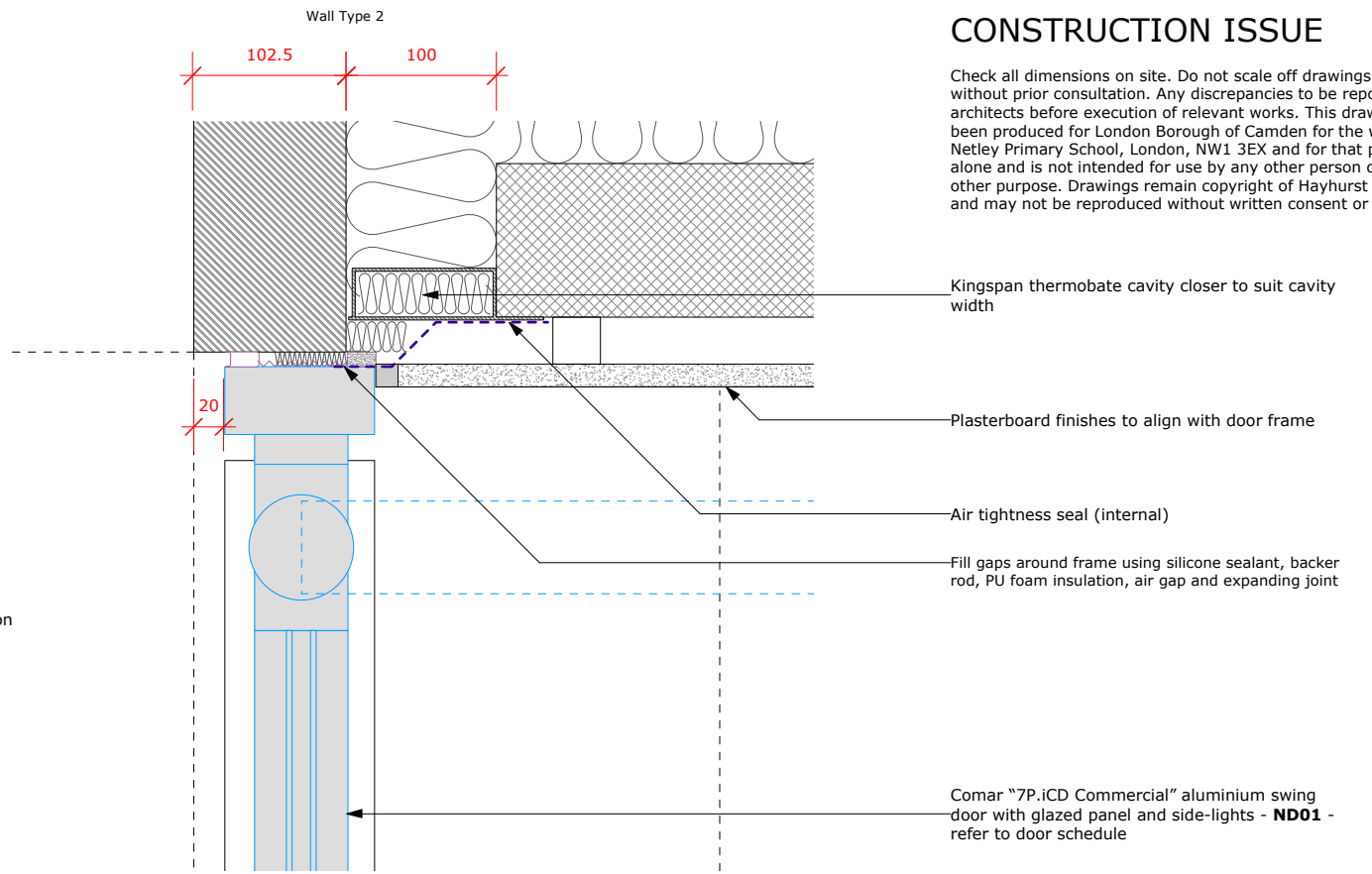

A512/3 - jamb of door Plan

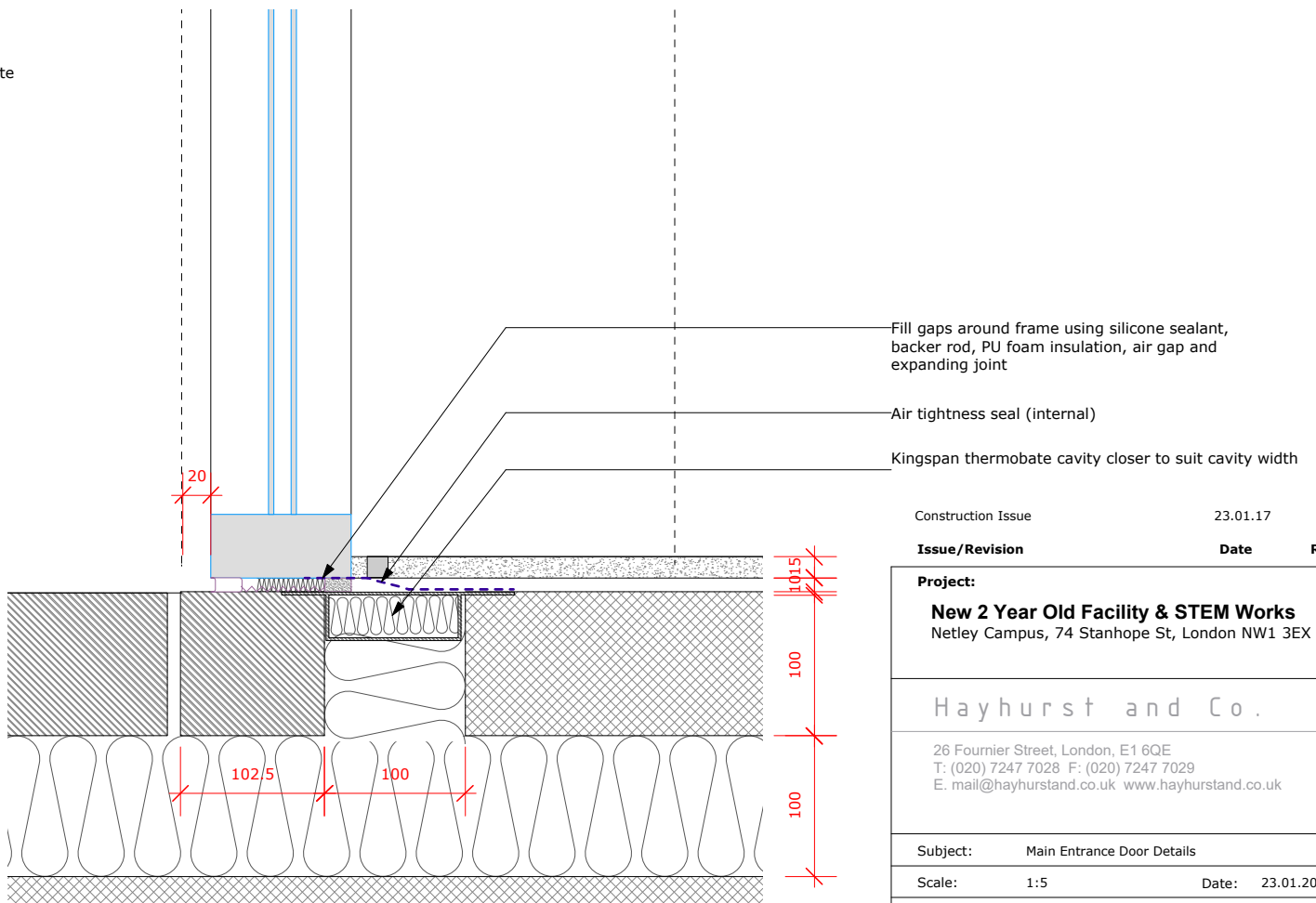

A512/4 - jamb of door Plan

## CONSTRUCTION ISSUE

Check all dimensions on site. Do not scale off drawings without prior consultation. Any discrepancies to be reported to architects before execution of relevant works. This drawing has been produced for London Borough of Camden for the works at Netley Primary School, London, NW1 3EX and for that project alone and is not intended for use by any other person or for any other purpose. Drawings remain copyright of Hayhurst and Co. and may not be reproduced without written consent or licence.

Kingspan thermobate cavity closer to suit cavity width

Plasterboard finishes to align with door frame

Air tightness seal (internal)

Fill gaps around frame using silicone sealant, backer rod, PU foam insulation, air gap and expanding joint

Comar '7P.iCD Commercial' aluminium swing door with glazed panel and side-lights - ND01 - refer to door schedule

Construction Issue	23.01.17	A
Issue/Revision	Date	Rev
<b>Project:</b> <b>New 2 Year Old Facility &amp; STEM Works</b> Netley Campus, 74 Stanhope St, London NW1 3EX		
Hayhurst and Co.		
26 Fournier Street, London, E1 6QE T: (020) 7247 7028 F: (020) 7247 7029 E. mail@hayhurstand.co.uk www.hayhurstand.co.uk		
Subject:	Main Entrance Door Details	
Scale:	1:5	Date: 23.01.2017
Original Size:	A3	
Drawing No.:	184 A512 A	