

**DO NOT SCALE FROM THIS DRAWING**  
 DRAWING TO BE READ IN CONJUNCTION WITH ALL OTHER ARCHITECTS AND ENGINEER'S CONTRACT DRAWING & SPECIFICATIONS. ANY DISCREPANCIES MUST BE BROUGHT TO THE ATTENTION OF THE ARCHITECT IMMEDIATELY.  
 THE CONTRACTOR MUST VERIFY ALL DIMENSIONS BY SITE MEASUREMENT BEFORE ORDERING MATERIALS OR MANUFACTURING COMPONENTS.  
 SUBSTITUTE MATERIALS & PRODUCTS TO THOSE NAMED WILL BE ACCEPTABLE IF PROVEN TO BE OF EQUAL OR HIGHER PERFORMANCE AND NOT IN CONFLICT WITH OTHER ELEMENTS.

NOTES  
 KEY:

-  Site Ownership
-  Consented Demolition associated with Application ref: 2013/512/L & 2014/792/P
-  Regularisation
-  Proposed demolition

Note:  
 For windows and doors please refer to schedules.

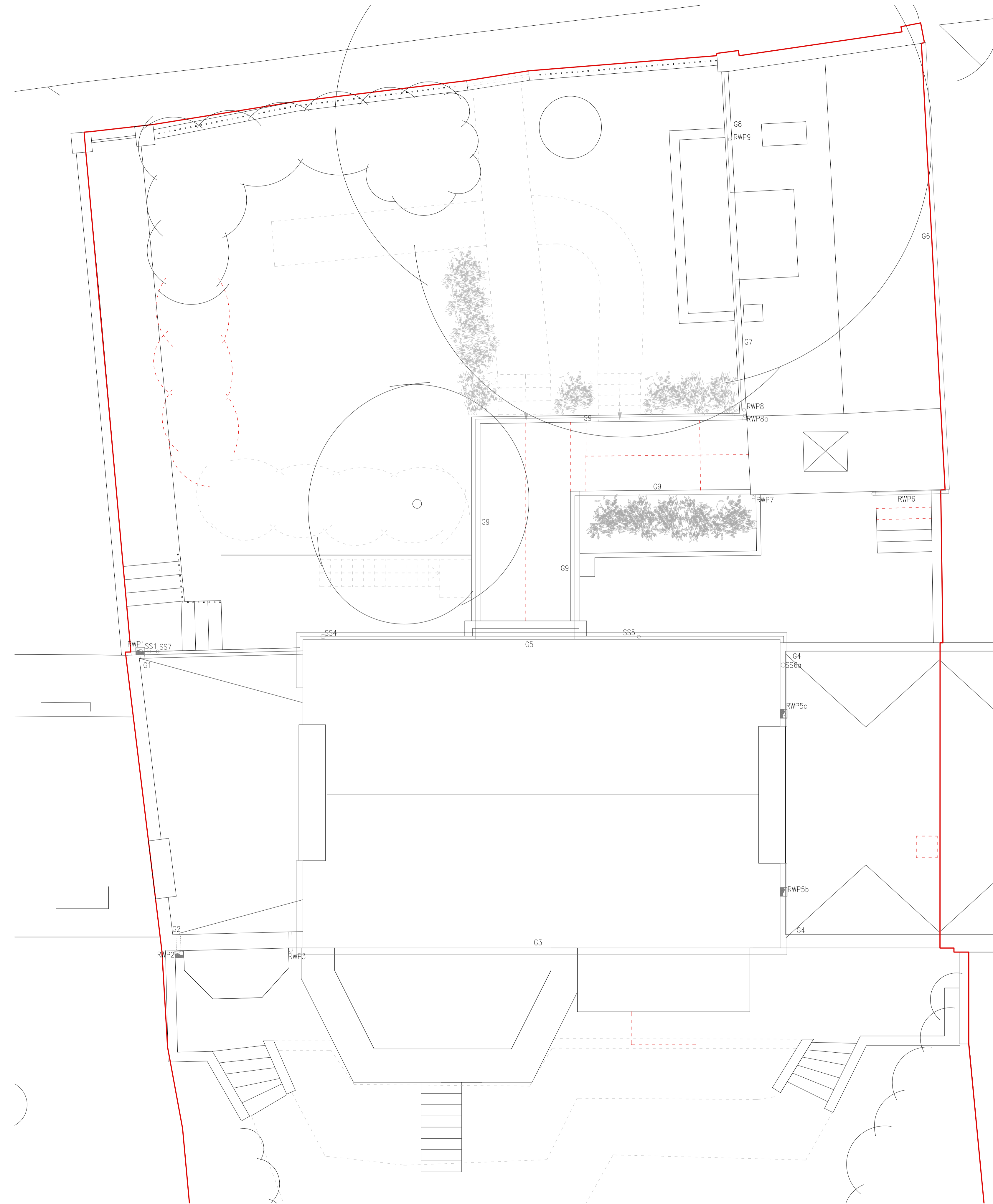

REV	DATE	DESCRIPTION
-	29.03.16	For Pre Application
A	06.05.16	General updates
B	18.11.16	For Planning
C	28.02.17	For Planning

**FOR PLANNING**

JOB TITLE  
**Keats Grove  
 Hampstead**

DRAWING TITLE  
**Roof Plan  
 Proposed Demolition**

JOB No	DWG No	REV
546	D05	C
DRAWN BY	SCALE (AT A1)	DATE
JMc	1:50 (1:100@A3)	Mar16

**RICHARD GRIFFITHS ARCHITECTS**  
 5 Maidstone Mews, 72-76 Borough High Street, London SE1 1GN  
 T +44(0)20 7357 8788 | F +44(0)20 7403 7887  
 E admin@rgarchitects.com | www.rgarchitects.com