

All dimensions to be verified on site. Figured dimensions to take precedence over those scaled. Any areas indicated on this drawing are for guidance only, no responsibility is taken for their accuracy.
 The drawing is the property of Applied Landscape Design Limited. Copying/PL is reserved by them and the drawing is issued on the condition that it is not copied, reproduced, altered or disclosed in any unauthorised person, either wholly or in part without the written consent of Applied Landscape Design Limited.

© 2016 Applied Landscape Design Limited. All rights reserved.

CDM/H&S:
 The works illustrated on this drawing have been reviewed against the Design CDM Risk Register and Significant Risks are noted as:

- Construction:
- Handling heavy materials / large pieces of stone
 - Working adjacent to structures
 - Working adjacent to existing structures (See H&S 8)
- Maintenance:
 Demolition:

NOTES / KEY:

REFERENCE DRAWINGS/DOCUMENTS

ALD731_GA002	Triplets Park General Arrangement
ALD731_HL101	Triplets Park Hard Landscape Key
ALD731_HL109 - HL112	Triplets Park Hard Landscape Layouts, Sheet 1-4

REVISIONS

no.	issued	date
C02	Bollard height amended. Issue for construction	09.03.17
C01	First Issue for Construction Hazard strip added	07.09.16
P02	Granite setts finish amended as requested	09.06.16
P01	First Issue for Information	16.05.16

no. issued date

CLIENT:



LANDSCAPE ARCHITECT:

The Threshing Barn
 Blenheim Park Buns
 Chichester, N. Gosport
 Oxfordshire, OX26 1TD
 Tel: 01859 249776
 Email: mall@appliedlandscape.co.uk



PROJECT:

TRIPLETS PARK
 KINGS CROSS CENTRAL

DRAWING TITLE:

TRIPLETS PARK TYPICAL DETAILS
 STREET FURNITURE
 FIXED BOLLARD

drawn:	scale:	
AJ	1:15 @ A3	
checked:	status:	
CW	Construction	
date:	xref file ref:	
06.05.2016	ALD731_LDbase	
PROJECT NO.	DRAWING NUMBER:	REVISION:
ALD731	LD904	C02

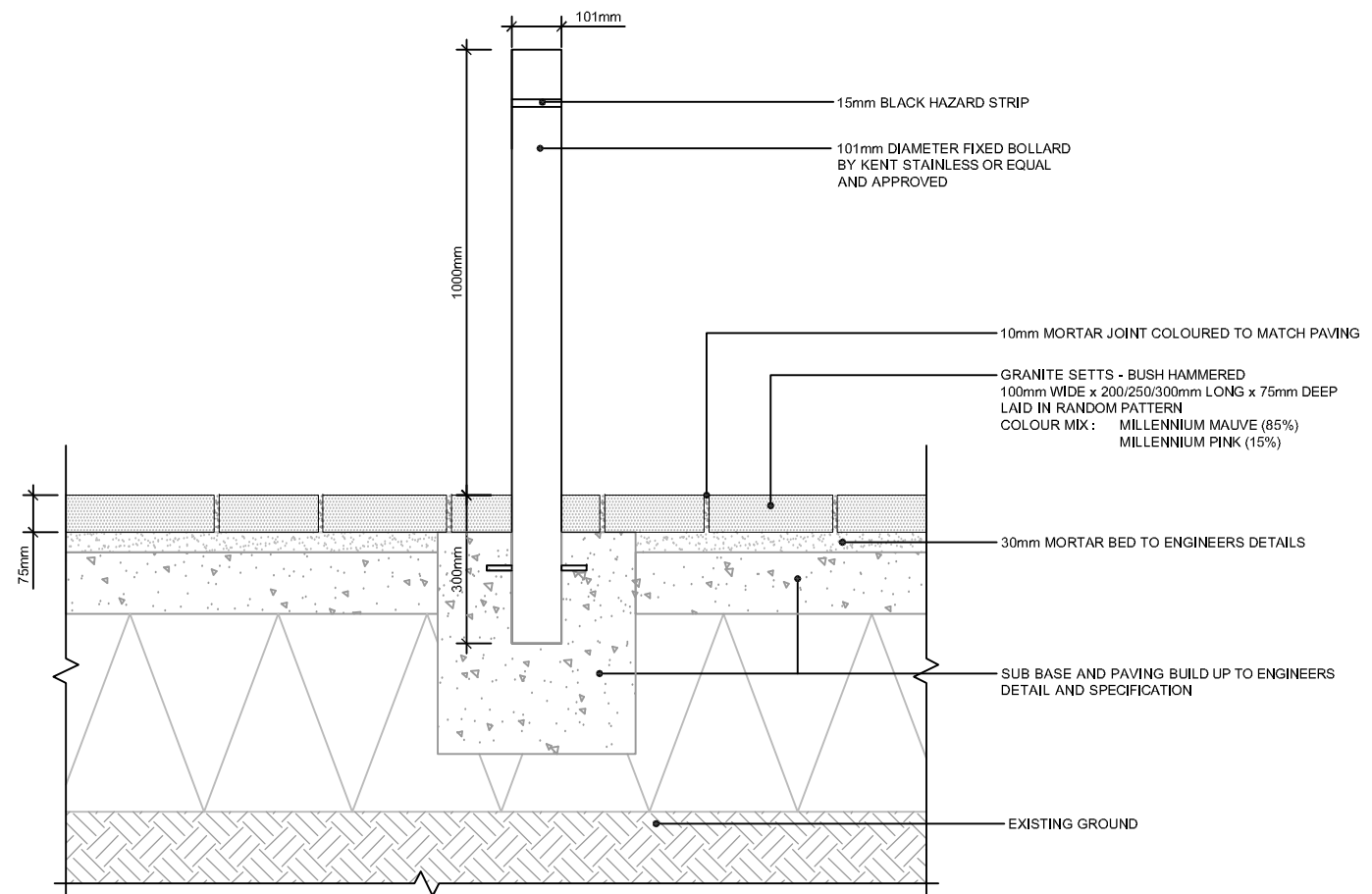

F04 SECTION THROUGH FIXED BOLLARD
 1:15 @ A3