

G12/001
NEW FLOOR C CHANNEL GRID SYSTEM TO AREA SHOWN WITH 2 HATCH ACCESS POINTS - REFER TO THEATRE CONSULTANT AND STRUCTURAL ENGINEER INFO.

L30/012
NEW BALUSTRADES TO PERIMETER NEW FLOOR LEVEL REFER TO THEATRE CONSULTANT INFO.

EXISTING ROOF TRUSSES

H11/001 **H11/002** **H72/01**
NEW ROOF PLANT ENCLOSURE: RAINSCREEN ENCLOSURE SUPPORTED BY A NEW STEEL FRAME. FLAT ROOF SYSTEM CONTINUES BELOW REFER TO STRUCTURAL ENGINEER INFO.

L25/003 **L20/021**
NEW ROOF EXTENSION WITH HANDRAIL ACCESS VIA ROOF HATCH

M40/04
NEW FLAT ROOF SYSTEM CONTINUES BELOW PLANT ENCLOSURE AND INTO SHARED DEMISE

02 FFL+30.39 m

01 FFL+26.89 m

00 FFL+23.00 m

02 FFL+30.39 m

01 FFL+26.89 m

00 FFL+23.00 m

L20/03
NEW STORE ROOM (FLOOR AND WALLS) REFER TO STRUCTURAL ENGINEER INFO.

EXISTING GET IN DOOR TO BE REFURBISHED REFER TO ACOUSTIC ENGINEER INFO.

X21/02
NEW MODULAR STAGE ROSTRA ZONE. REFER TO THEATRE ENGINEER INFO. ALL SUBSTAGE AND REMEDIAL WORKS, INCLUDING LEVELLING TO LOWER CONCRETE SLAB TO BE INCLUDED IN THE MAIN CONTRACT

L30/011 **L30/010**
CIRCLE: UPGRADE OF SEAT UPHOLSTERY AND FOAM SUBSTRUCTURE TO IMPROVE COMFORT LEVELS. REMODELING OF STAIRS AT CIRCLE LEVEL TO BE CONFIRMED. NEW MESH INFILLS TO EXISTING BALUSTRADES AND FINISHES TO ALL HAND RAILS REFER TO THEATRE CONSULTANT INFO.

L30/010
STALLS: UPGRADE OF SEAT UPHOLSTERY AND FOAM SUBSTRUCTURE TO IMPROVE COMFORT LEVELS. ADDITION OF TWO SEATS REFER TO THEATRE CONSULTANT INFO.

DO NOT SCALE

THE CONTRACTOR IS TO CHECK AND VERIFY ALL BUILDING AND SITE DIMENSIONS, LEVELS AND SEWER INVERT LEVELS AT CONNECTION POINTS BEFORE WORK STARTS.

THIS DRAWING IS TO BE READ AND CHECKED IN CONJUNCTION WITH ENGINEERS AND OTHER SPECIALIST DRAWINGS.

THE DRAWING AND THE WORKS DEPICTED ARE THE COPYRIGHT OF HAWORTH TOMPKINS LTD AND MAY NOT BE REPRODUCED EXCEPT BY WRITTEN PERMISSION.

NOTES

TO BE READ IN CONJUNCTION WITH GA PLANS, SECTIONS AND ELEVATIONS.

EXISTING FABRIC

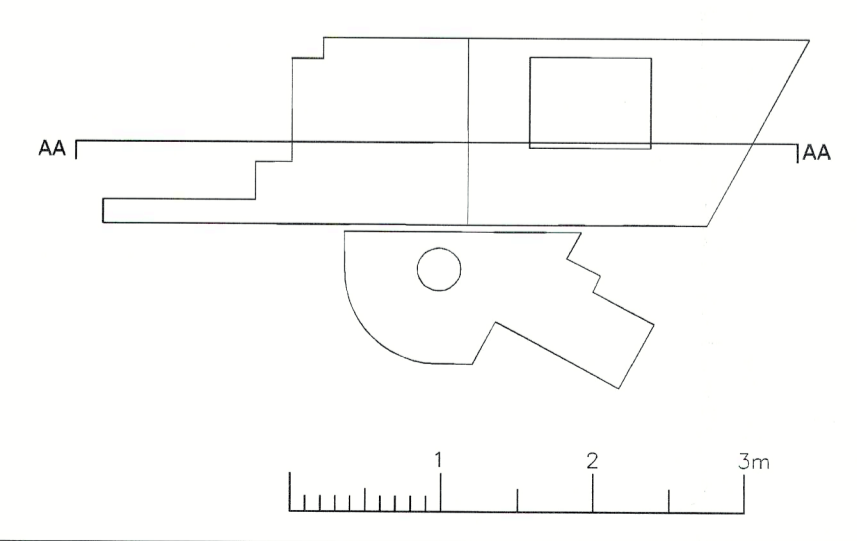

REV	DATE	DESCRIPTION
E	01.02.17	STAGE 3
D	24.11.16	STAGE 3 DRAFT
C	07.10.16	COSTING ISSUE
B	30.09.16	INFORMATION
A	26.09.16	INFORMATION
-	01.06.16	INFORMATION

Haworth Tompkins

33 Greenwood Place
London NW5 1LB
T +44 (0)20 7250 3225
W www.haworthtompkins.com

JOB **1445: DONMAR WAREHOUSE**

DRG **PROPOSED SECTION AA**

DRG No **1445-HT-S-200** REV **E**

SCALE **1:50@A1** DATE **01.02.17**

DRAWN BY _____ INSPECTED BY _____

DRAWING STATUS **STAGE 3**