

1 - 26  
Waterhouse  
Close

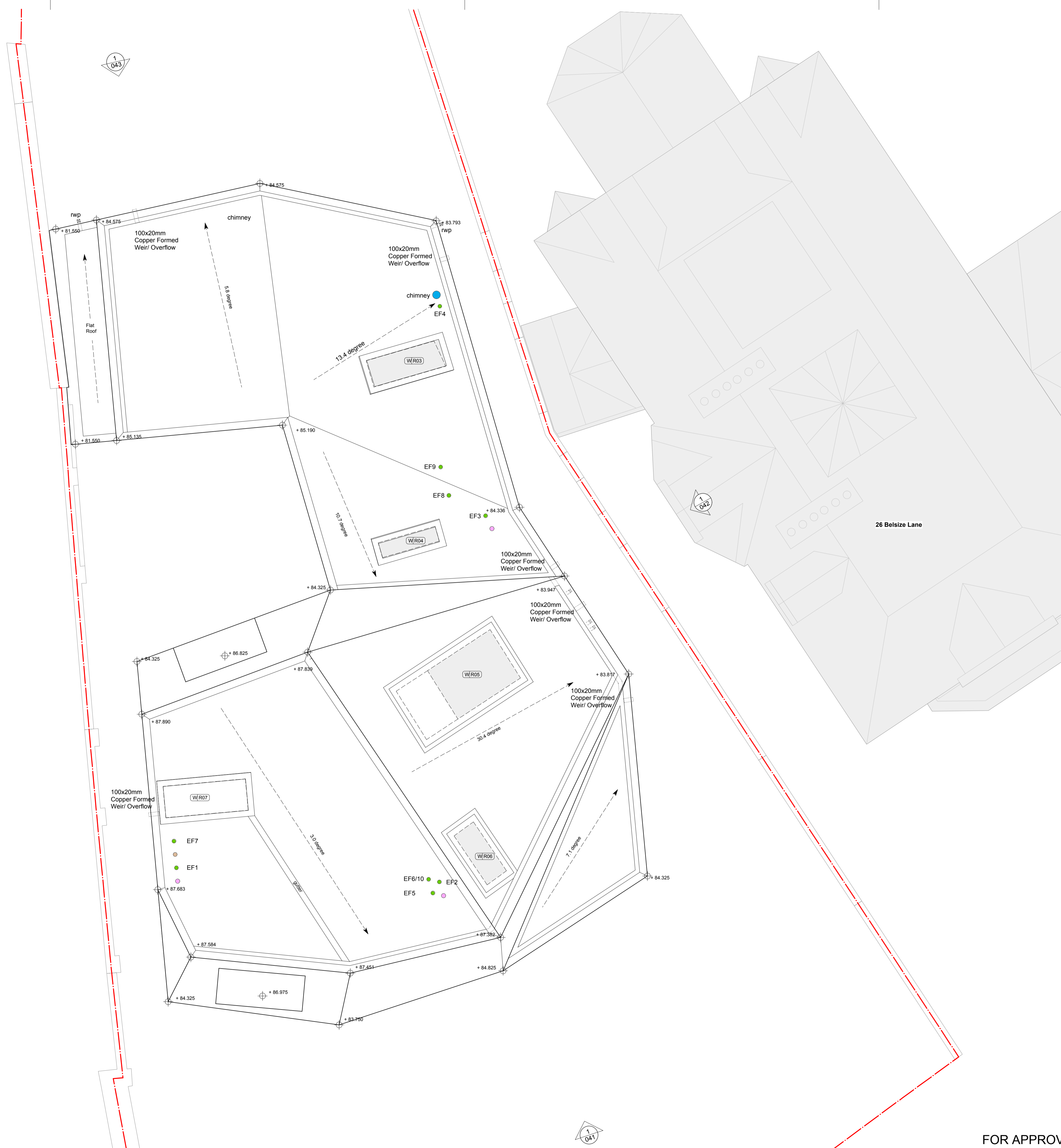

**Notes**  
**Note 1**  
 To be read in conjunction with Acoustic report 11377 PCR 01 & 02.  
 ● Chimney (gas fire) Approved 2014/0246/P  
 ● Concentric Flue Vent  
 ● Extract Vent  
 ● SVP

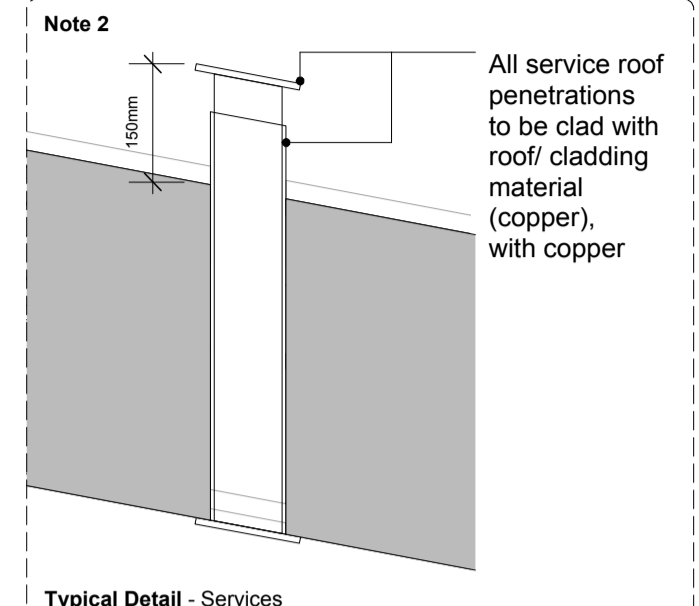

Typical Detail - Services

Revision	Date	Notes
1	15/03/17	Service roof penetrations shown; Gutter from W-R07 shown. Note 1 & 2 added. RWP's shown as square.

**Key Plan**

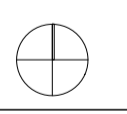

1. Do not scale drawings. All dimensions to be checked on site. Errors to be reported to architect. To be read in conjunction with all relevant architects services and engineers drawings.
2. Contractors, sub-contractors and suppliers to verify any critical dimensions on site prior to fabrication of any building element. Any discrepancies to be reported to the architect.
3. This drawing to be read in conjunction with all relevant specifications, engineers and specialist consultants information and any discrepancies reported prior to installation.



Project :	28 Belsize Lane
Title :	Roof Plan
Client :	Vivien & Edmund Bradley
Scale :	1:50 (A1), 1:100 (A3)
Date :	14. 03. 2017
Drawn By :	RM
Drawing :	2214_PL_035
Revision :	1