

Note: Survey drawings are based upon the drawings produced by The Gordon Tomalin Partnership, Consultant Land Surveyors, Basildon, Jan 2017.

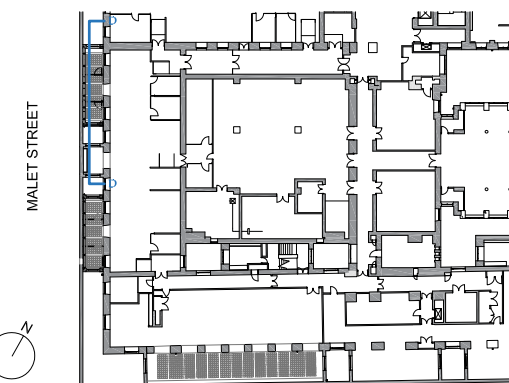

Notes:
 This drawing is the copyright of Giles Quarme and Associates and cannot be printed or re-produced without prior permission.
 Do not scale.
 This drawing has been based on survey information provided by others.
 All dimensions and setting out must be verified on site before commencement of the work, and any discrepancies notified to the architect.
 All windows and doors are to fit into existing openings.
 All dimensions are in millimetres unless stated otherwise.

Project and Project No:	SENATE HOUSE - 9706
Title:	PROPOSAL - Lightwell Section DD

GILES QUARME AND ASSOCIATES <i>(Chartered Architects)</i>	
7 BISHOPS TERRACE LONDON SE11 4UE	
Tel: (020) 7582 0748	Fax: (020) 7793 8807
E-mail: mail@quarme	

Drawing No:	9739 P (2) 23	Revision:	-	Drawn:	SMT
Date:	March 2017	Scale:	1:50@A3	Checked:	NB