

INDICATIVE BELOW GROUND DRAINAGE LAYOUT

PROPOSED DRAINAGE RUN THROUGH TREE RPA AT DEPTH 'C. 750mm TO BE HAND DUG.

NOTES

- 1) ONLY KEY MANHOLES ARE SHOWN AND POSITIONS ARE INDICATIVE
- 2) PROPOSED FWP/RWP LOCATIONS TBC BY MRE ENGINEER
- 3) APPROVAL FROM THAMES WATER REQUIRED TO MAKE NEW CONNECTION TO PUBLIC SEWER.
- 4) CCTV SURVEY TO CONFIRM CONDITION OF EXISTING DRAINAGE

KEY

- = PROPOSED COMBINED WATER DRAIN
- = EXISTING COMBINED WATER DRAIN
- = EXISTING SURFACE WATER DRAIN
- = EXISTING FOUL WATER DRAIN
- ***** = EXISTING DRAIN TO BE DEMOLISHED
- (with green dashes) = TREE ROOT PROTECTION AREA (SHOWN INDICATIVELY)
- (with red dashes) = PROPOSED DEVELOPMENT OUTLINE
- (with blue dashes) = RAIN WATER DOWN PIPE (INDICATIVE LOCATIONS)

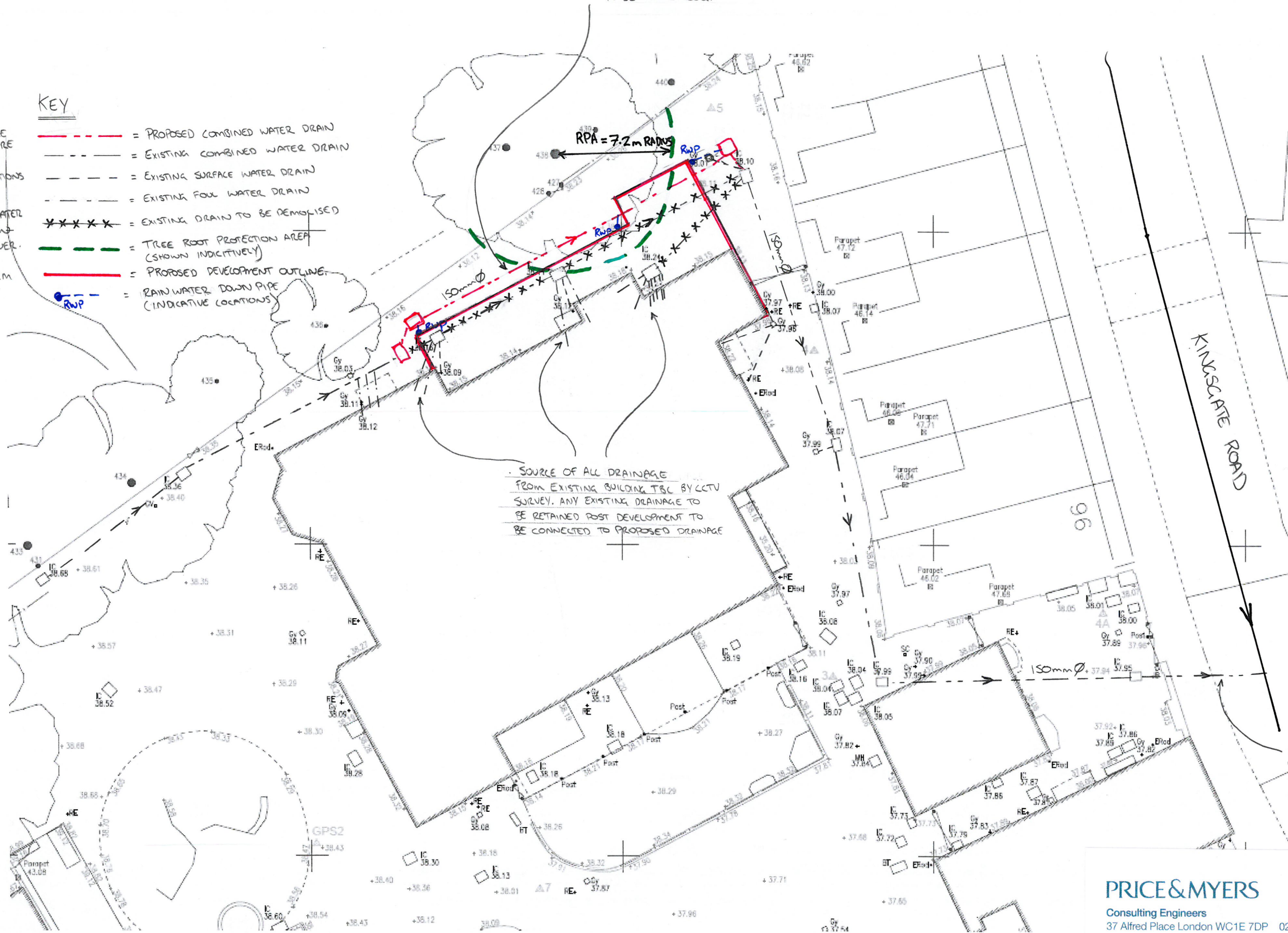

SOURCE OF ALL DRAINAGE FROM EXISTING BUILDING TBC BY CCTV SURVEY. ANY EXISTING DRAINAGE TO BE RETAINED POST DEVELOPMENT TO BE CONNECTED TO PROPOSED DRAINAGE

EXISTING COMBINED WATER DRAIN DISCHARGES PUBLIC SEWER IN KINGSGATE ROAD

PRICE & MYERS
 Consulting Engineers
 37 Alfred Place London WC1E 7DP 020 7631 5128

Job No 24220-002 Page SKD02 Ver. -
 Date 23/02/17 Eng JL Chd -
 Job KINGSGATE PRIMARY SCHOOL.