

**DOUBLE SIDED TIMBER SLEEPER BENCH  
(MAIN ENTRANCE)**

TOP PLAN VIEW 1:10

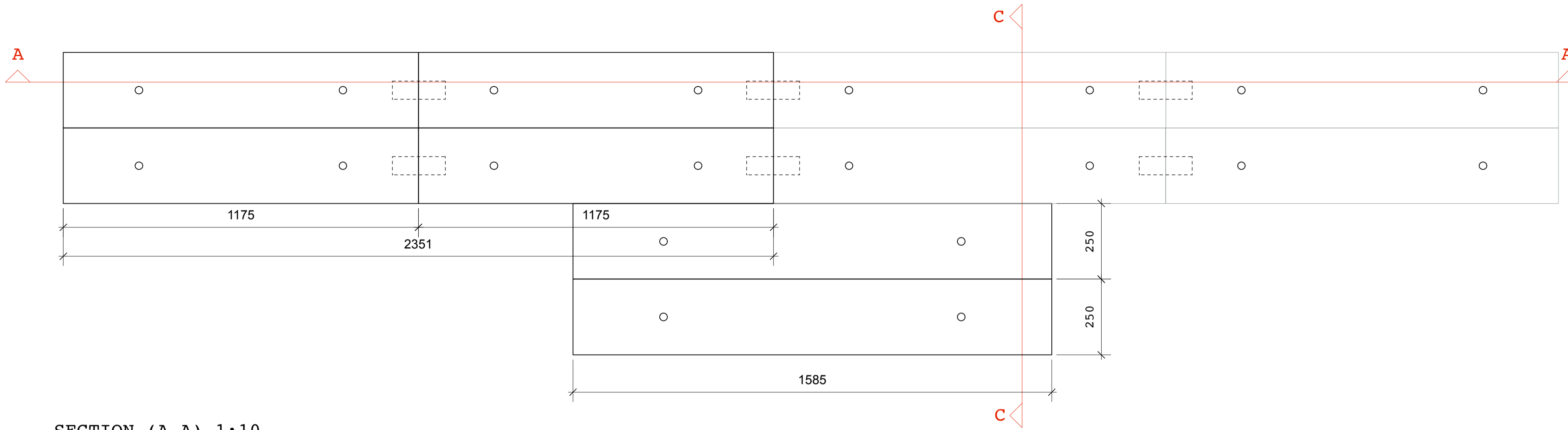

SECTION (A-A) 1:10

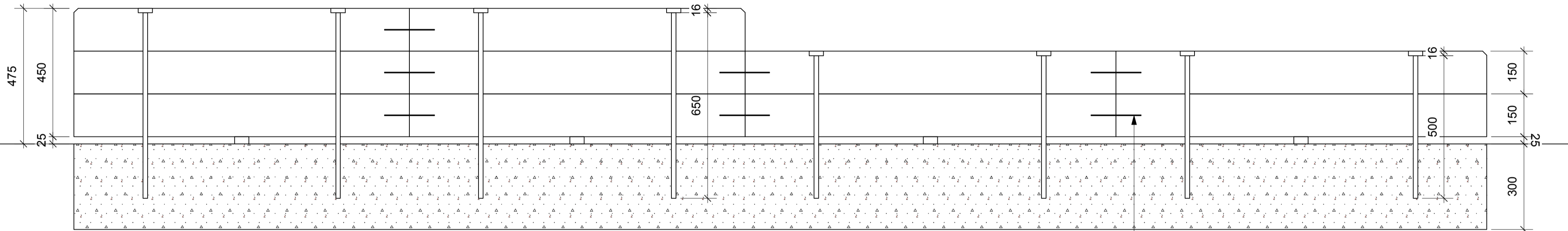

60mm x 175 mm concealed, galvanised, flat jointing steel plate connecting timber sleepers horizontally with countersunk timber bolts M10 (4 no.)

SECTION (C-C) 1:10

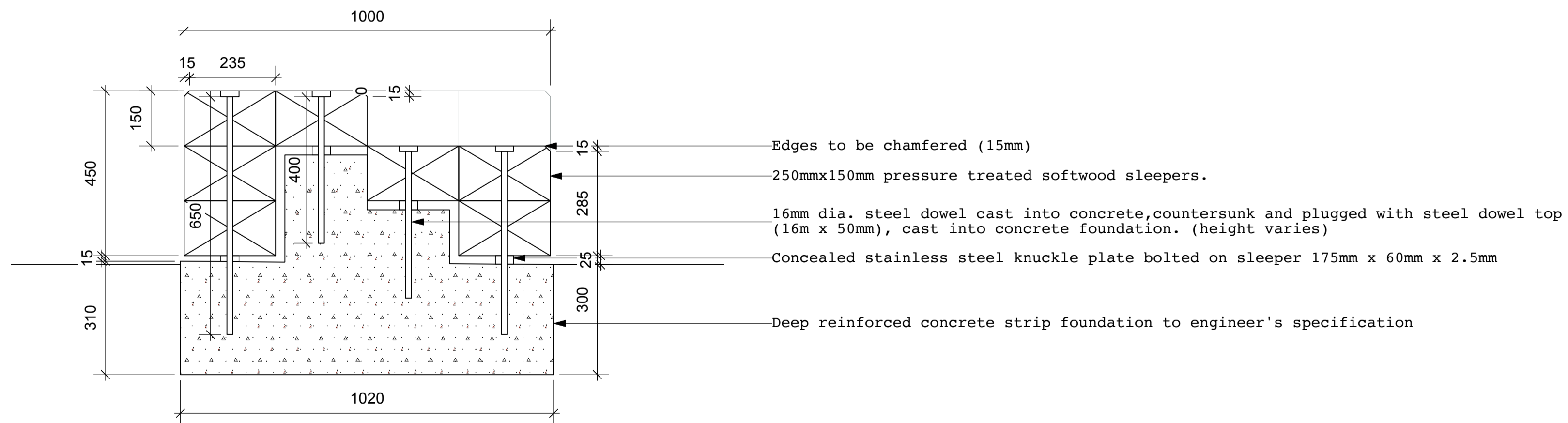

- Edges to be chamfered (15mm)
- 250mmx150mm pressure treated softwood sleepers.
- 16mm dia. steel dowel cast into concrete, countersunk and plugged with steel dowel top (16mm x 50mm), cast into concrete foundation. (height varies)
- Concealed stainless steel knuckle plate bolted on sleeper 175mm x 60mm x 2.5mm
- Deep reinforced concrete strip foundation to engineer's specification

LOCATION PLAN 1:100



-Refer to engineer's details for build up / specification.  
-For general arrangements refer to current revision of K1037.F.08.HSL1.

**JCLA**

3A Iliffe Yard  
LONDON SE17 3QA  
Telephone  
+44 (0)207 703 3270

www.jcla.co.uk

**Notes**

- Do not scale from drawings.
- To be read in conjunction with all relevant Architects', Services and Structural Engineers' drawings.
- All existing site, tree and building information has been compiled from different sources.
- All dimensions to be checked on site.

**Revisions**

**PLANNING  
CONDITION ISSUE**

**Project** Kingsgate Liddell  
**Project No.** KL037  
**Client** Camden council  
**Date** 18.01.2017  
**Scale** 1:10/100 @ A1  
**Drawing Name.** Double sided bench  
**Dwg No.** KL037.F.SD.503

Revision \*