

**ACOUSTIC BARRIER FENCE**  
TBC

DETAIL 409A  
SECTION 1:10  
(Northern fence)

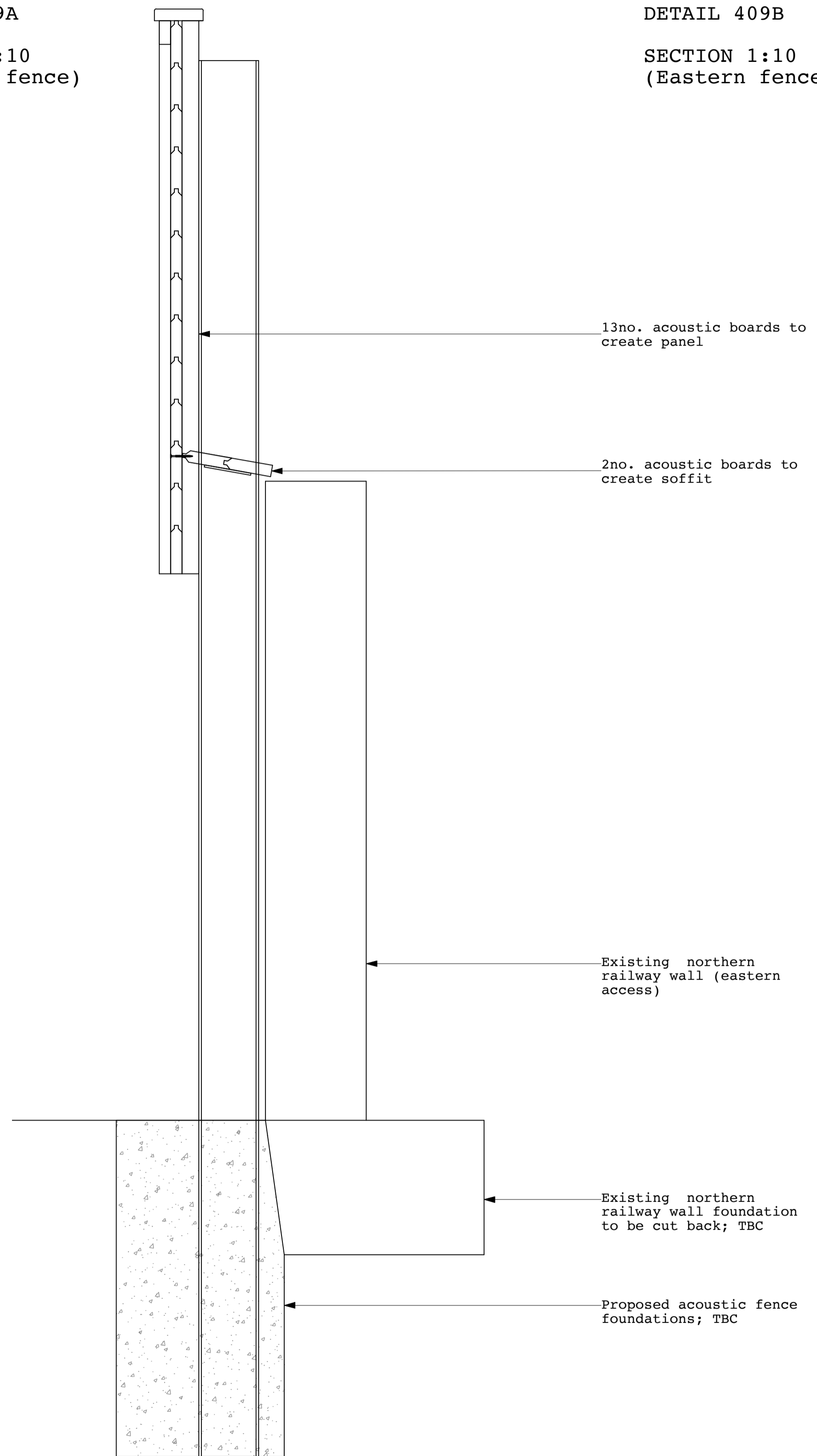

DETAIL 409B  
SECTION 1:10  
(Eastern fence)

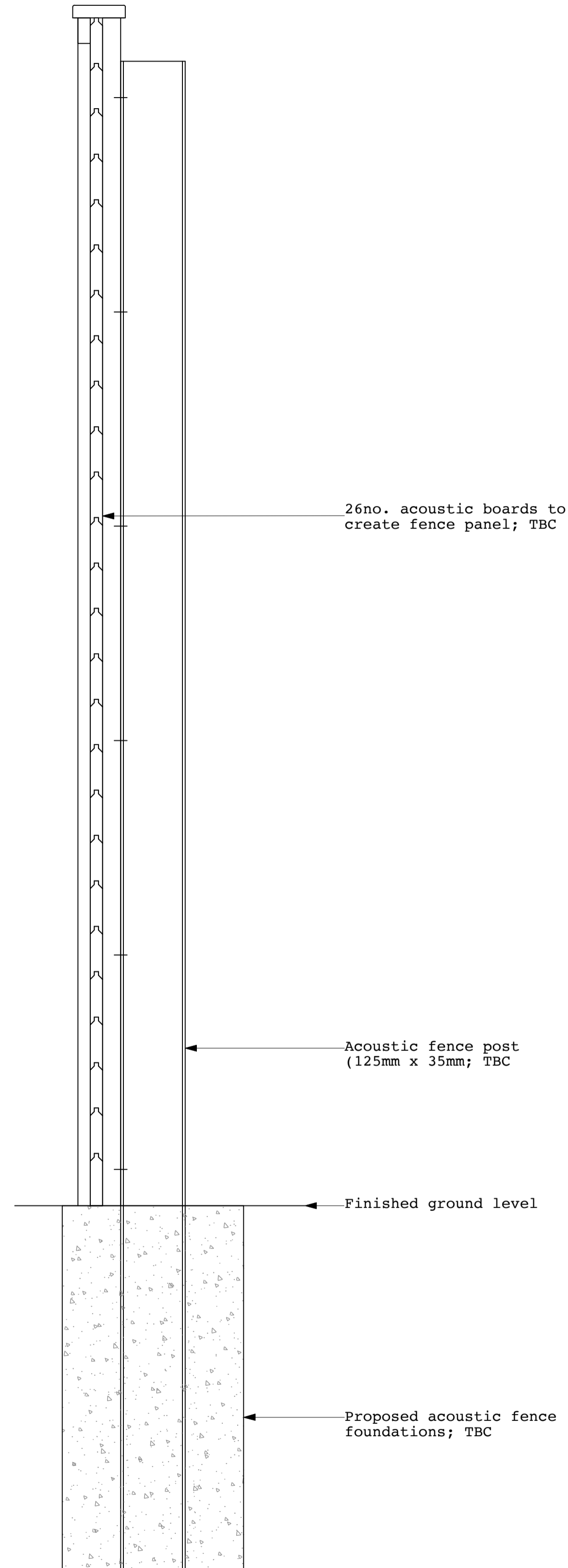

LOCATION PLAN 1:500

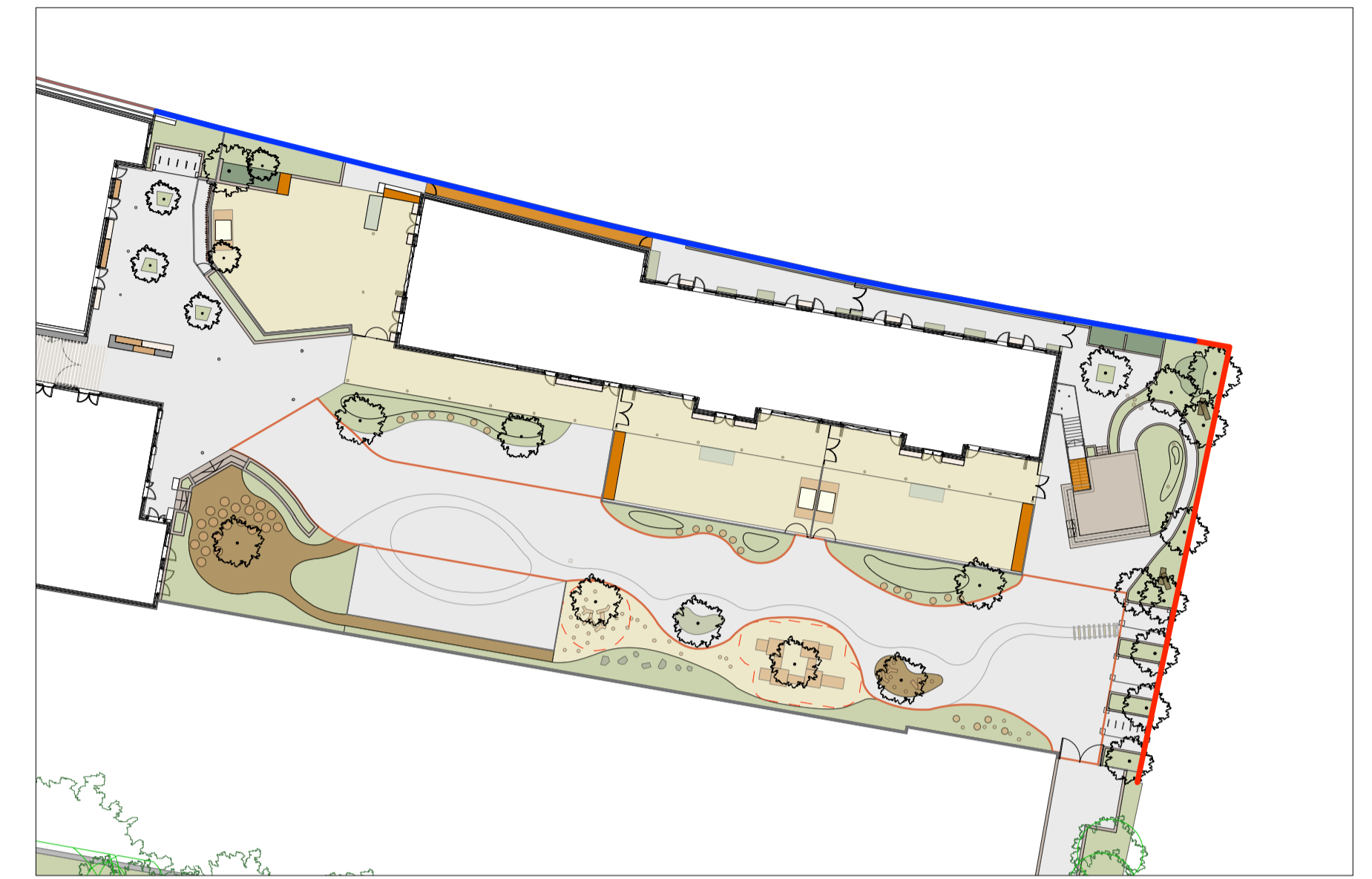

- Detail 409A  
Acoustic fence fixed on existing railway wall (northern railway wall fence)
- Detail 409B  
Acoustic fence fixed adjacent to existing railway wall (eastern railway wall fence)

Notes

- Design intend as per specialist contractor's drawings; TBC
- Specialist contractor's drawings to be submitted for approval

**JCLA**

3A Iliffe Yard  
LONDON SE17 3QA  
Telephone  
+44 (0)207 703 3270

www.jcla.co.uk

Notes

- Do not scale from drawings.
- To be read in conjunction with all relevant Architects', Services and Structural Engineers' drawings.
- All existing site, tree and building information has been compiled from different sources.
- All dimensions to be checked on site.

Revisions

-

**PLANNING  
CONDITION ISSUE**

**Project** Kingsgate Liddell

**Project No.** KL037

**Client** Camden council

**Date** 18.01.2017

**Scale** 1:10/20/100 @ A1

**Drawing Name.** Acoustic barrier (northern railway wall/eastern wall)

**Dwg No.** KL037.F.SD.409

Revision

\*