

**DOUBLE METAL GATE**  
(NORTHERN STRIP STORAGE CANOPY)

SECTION 1:10

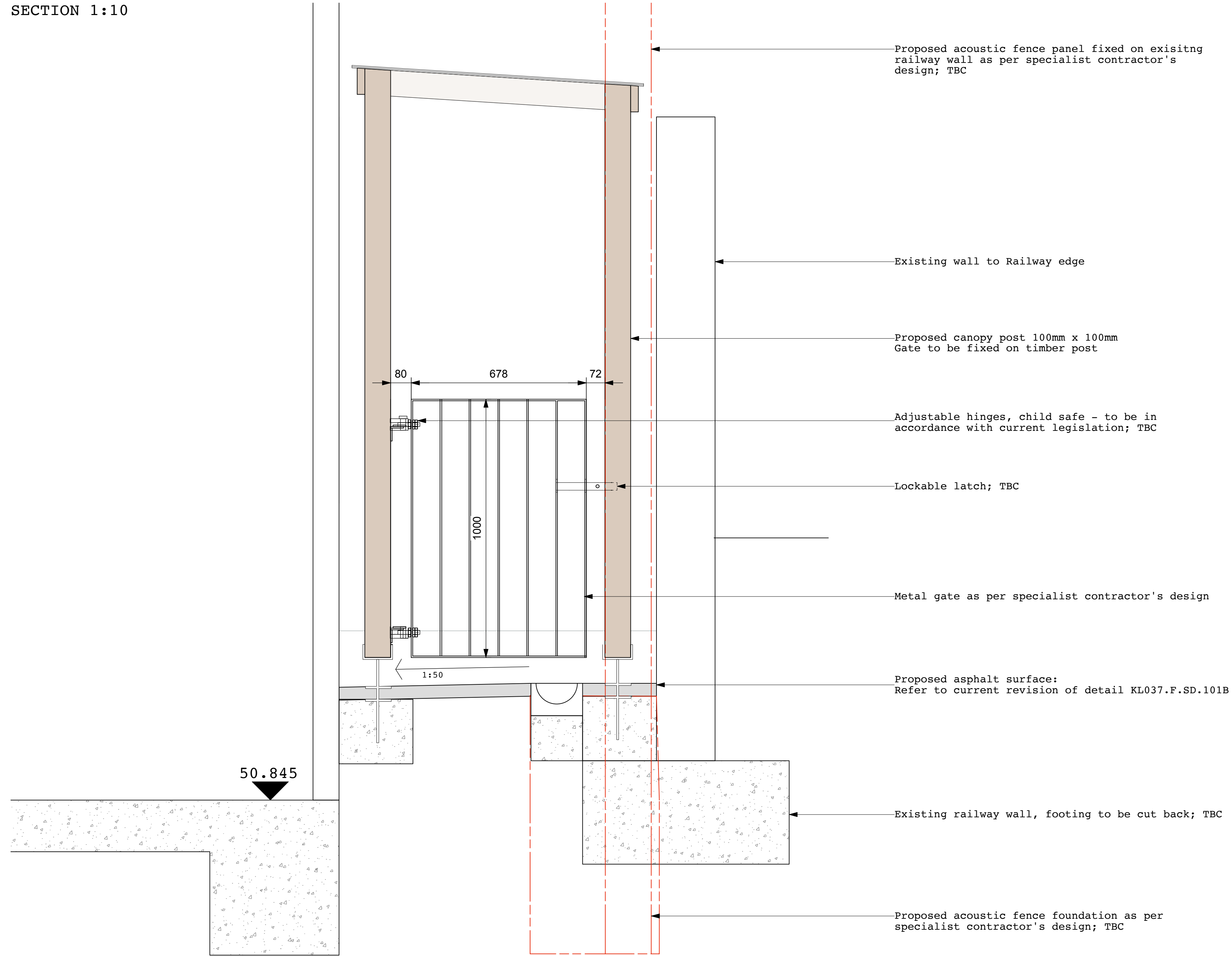

LOCATION PLAN 1:200

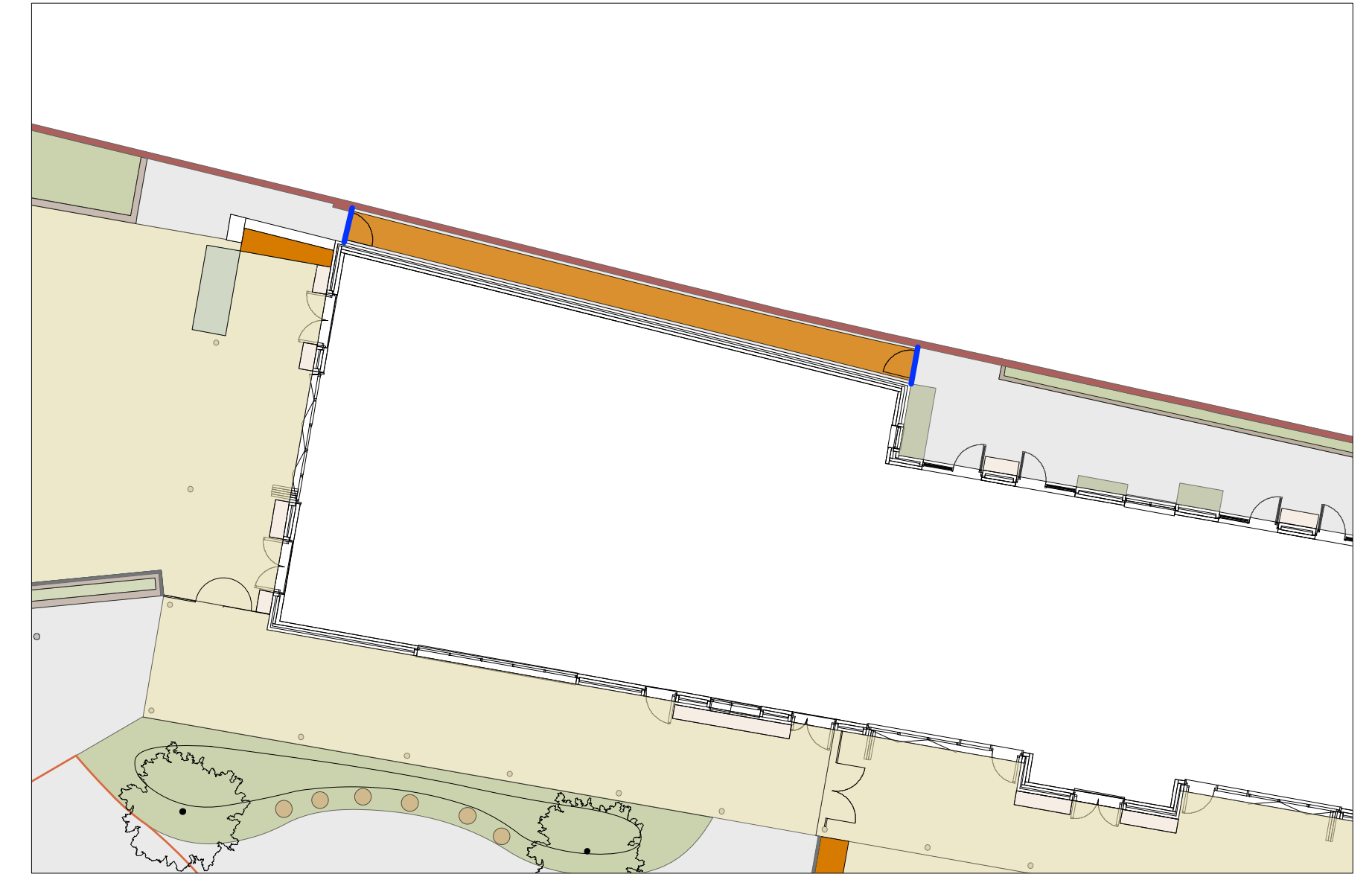

Notes

- Gap traps 72-130mm
- Specialist contractor's drawings to be submitted for approval
- Gates to include gates under collonade walkway (4 no. pairs) and 2 no. single exit from reception area

**JCLA**

3A Iliffe Yard  
LONDON SE17 3QA  
Telephone  
+44 (0)207 703 3270

www.jcla.co.uk

Notes

- Do not scale from drawings.
- To be read in conjunction with all relevant Architects', Services and Structural Engineers' drawings.
- All existing site, tree and building information has been compiled from different sources.
- All dimensions to be checked on site.

Revisions

-

**PLANNING  
CONDITION ISSUE**

<b>Project</b>	Kingsgate Liddell	<b>Revision</b>	*
<b>Project No.</b>	KL037		
<b>Client</b>	Camden council		
<b>Date</b>	18.01.2017		
<b>Scale</b>	1:10/20/100 @ A1		
<b>Drawing Name.</b>	Double gate low height (playground northern strip)		
<b>Dwg No.</b>	KL037.F.SD.405		