

Existing Foundation Arrangement of Perimeter Walls Based Upon Trial Hole Information As Shown On Drg L15/284/12- 507

		L15/284/12	
		REVISION	
MM/DD/YY			
1	02/02/17	Redrawn	
2	---/---/---	...	
3	---/---/---	...	
4	---/---/---	...	
5	---/---/---	...	

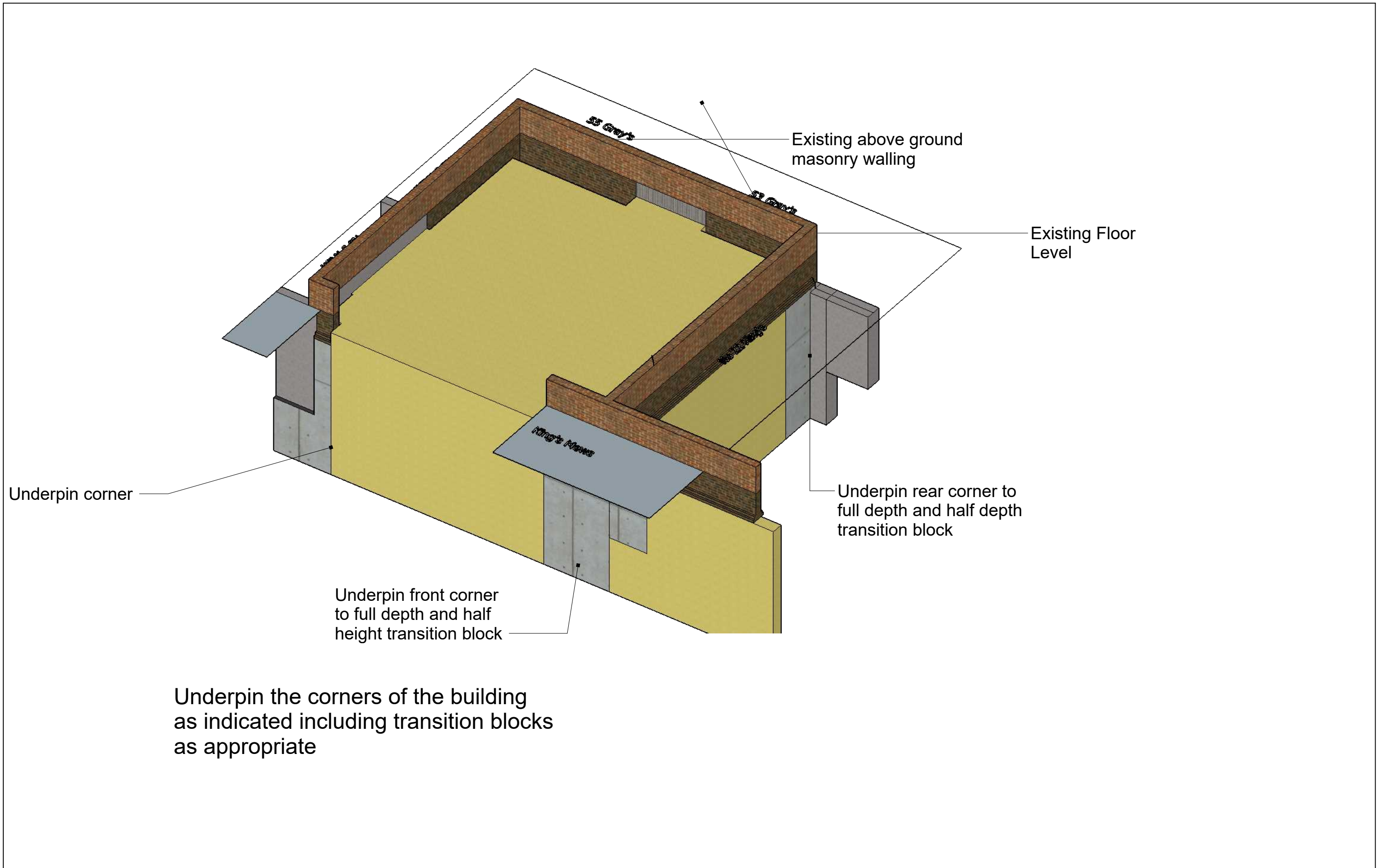

Underpin the corners of the building as indicated including transition blocks as appropriate

L15/284/12		
	MM/DD/YY	REVISION
1	02/02/17	Redrawn
2	---/---/---	...
3	---/---/---	...
4	---/---/---	...
5	---/---/---	...

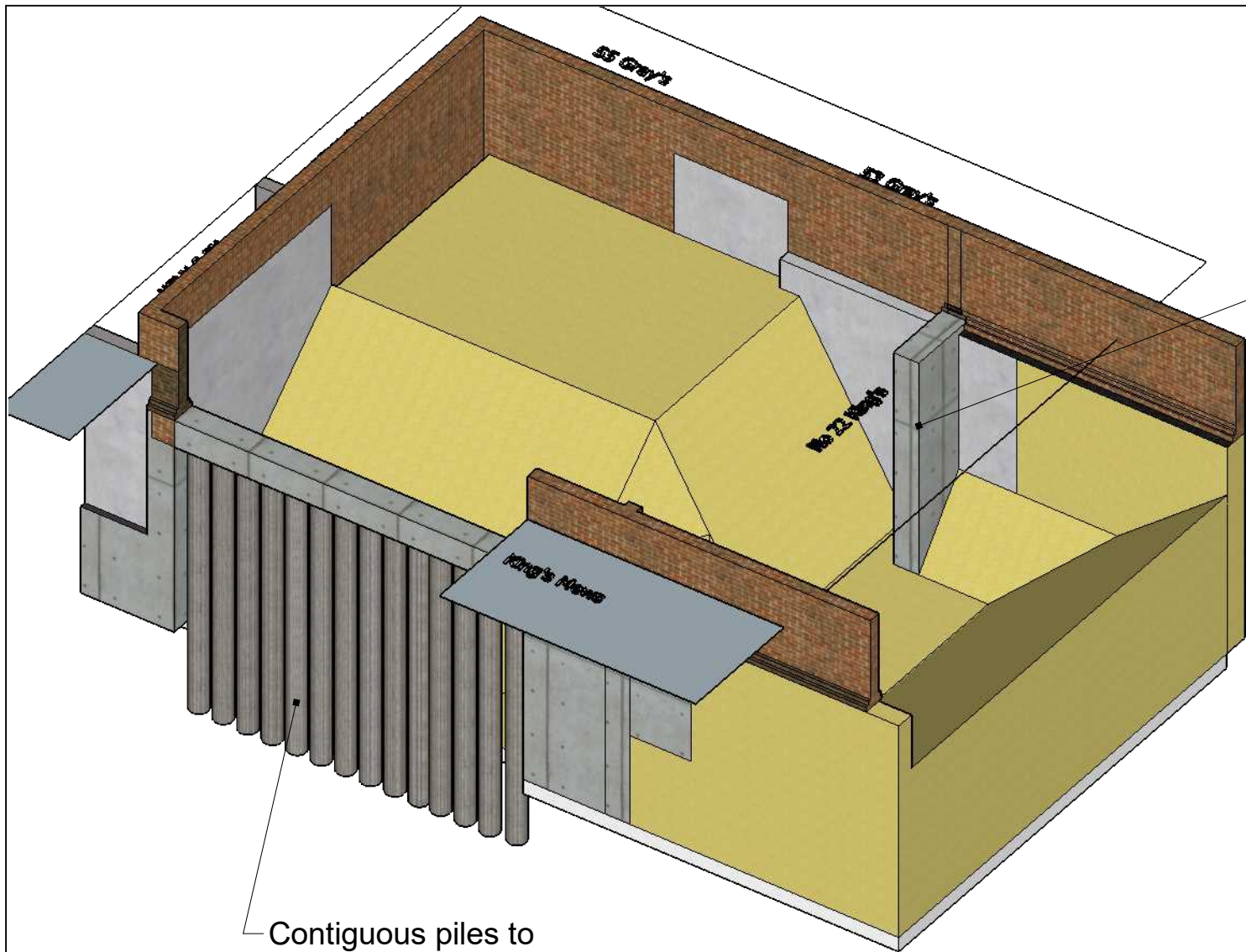

Contiguous piles to front elevation

Demolish party wall and reduce dig ground locally. Ensure batters do not exceed 1:3 slope and do not extend below depth of existing perimeter foundations

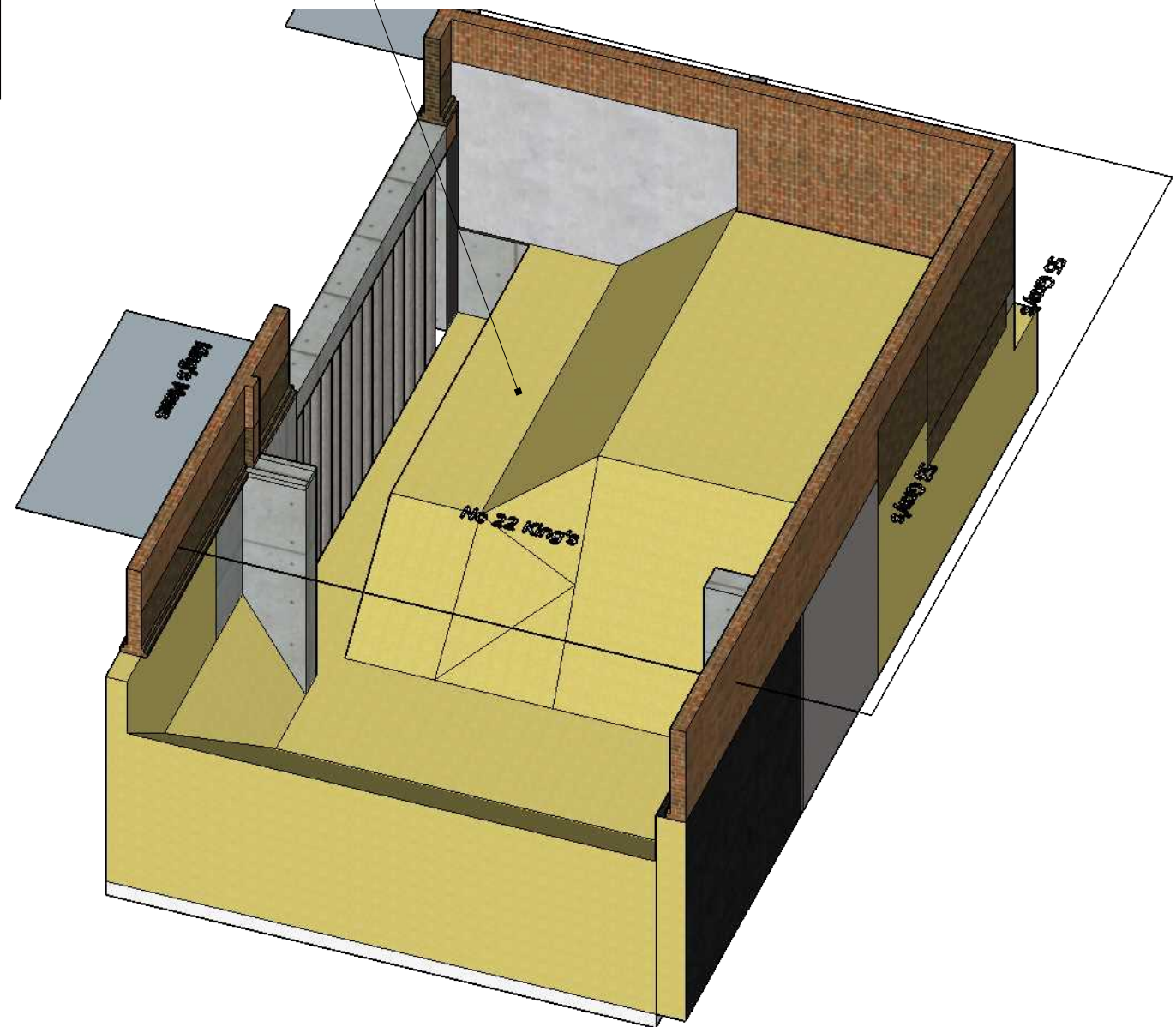

Demolish the Party Wall between 21/22 and reduce dig ground levels as appropriate

		REVISION
MM/DD/YY		
1	02/02/17	Redrawn
2	---/---/---	...
3	---/---/---	...
4	---/---/---	...
5	---/---/---	...

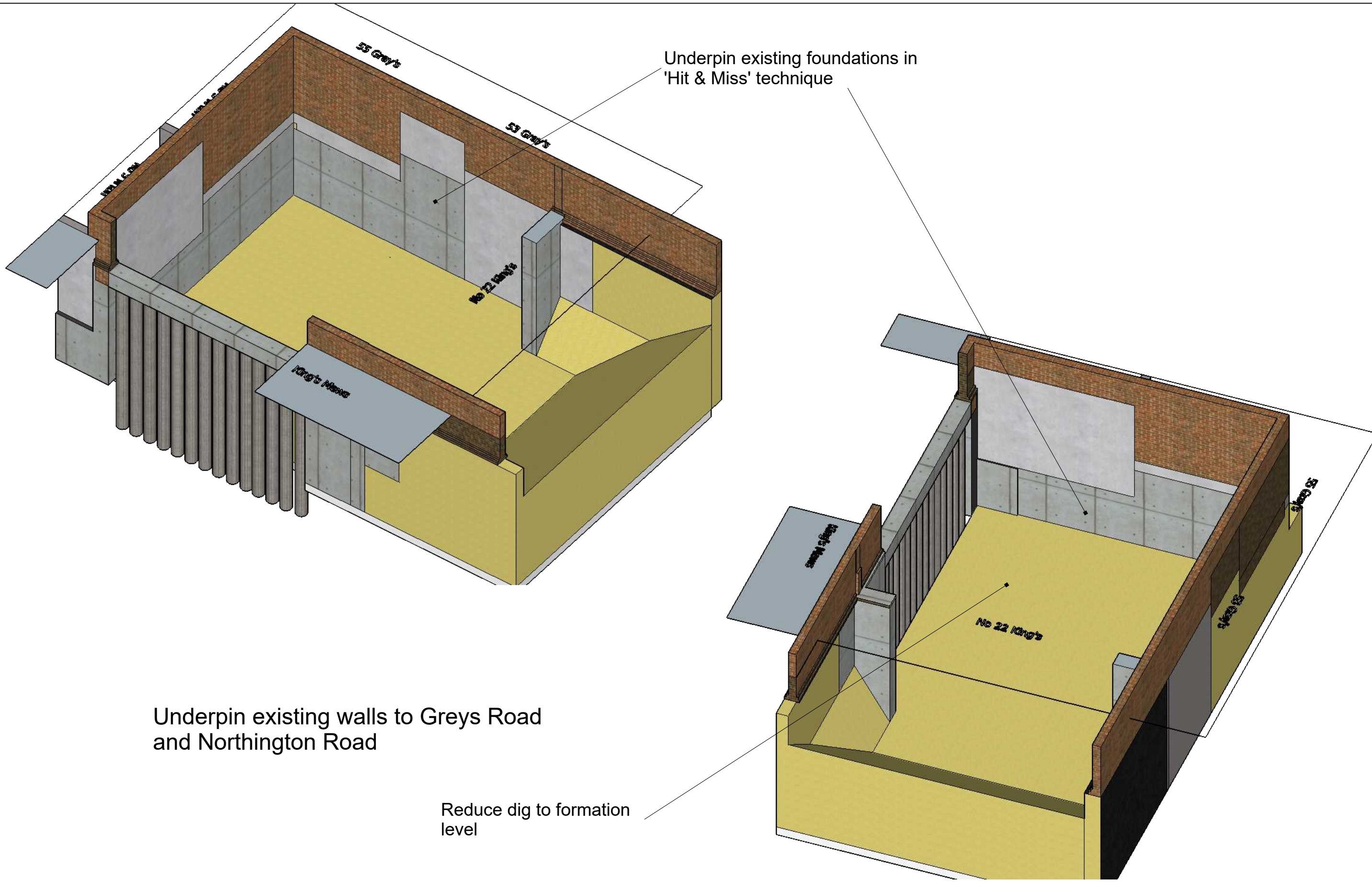

Underpin existing walls to Greys Road and Northington Road

Reduce dig to formation level

PROPOSED DEVELOPMENT - KING'S MEWS LONDON
Foundation Construction Method - 603

Capital & Provincial (Worthing) Ltd

L15/284/12

		REVISION
MM/DD/YY		
02/02/17	Redrawn	
---	...	
---	...	
---	...	
---	...	

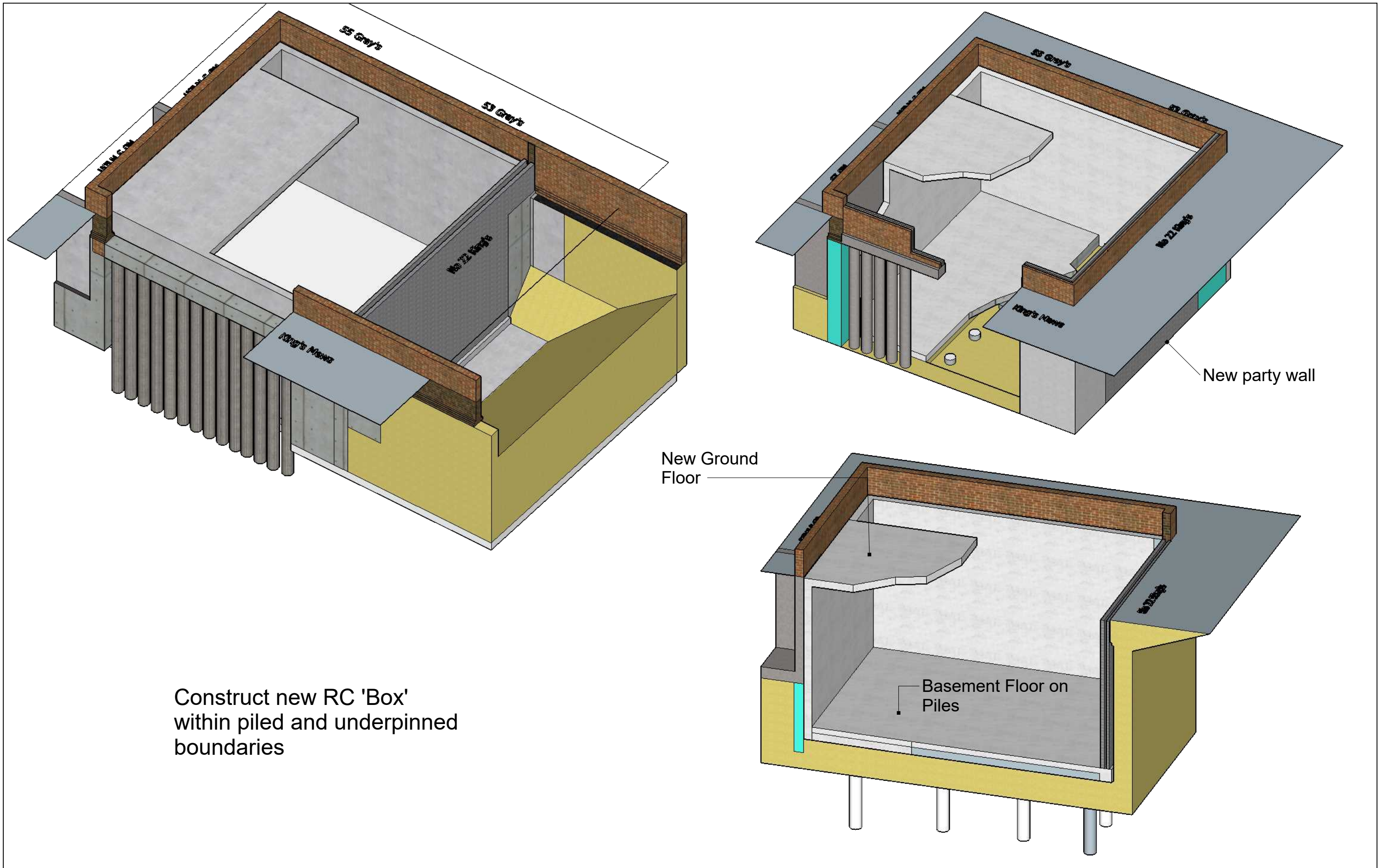

Construct new RC 'Box'
within piled and underpinned
boundaries

		REVISION
MM/DD/YY		
1	02/02/17	Redrawn
2	---/---/---	...
3	---/---/---	...
4	---/---/---	...
5	---/---/---	...