

SITE PLAN EXISTING 1:500

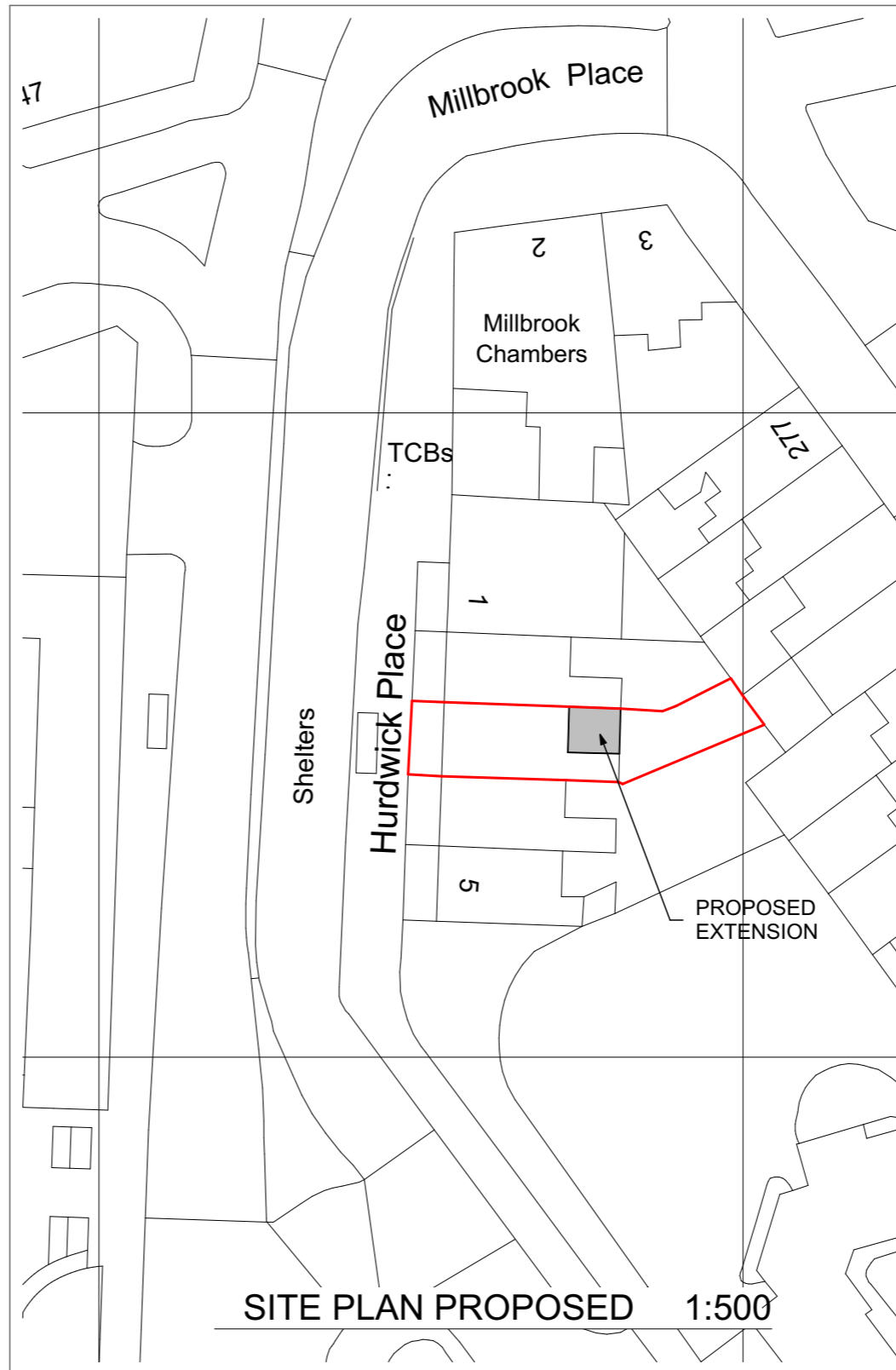

SITE PLAN PROPOSED 1:500

KEY — SITE BOUNDARY

AREA: 0,0140ha
 SITE COVERAGE EXISTING - 46.03%
 SITE COVERAGE PROPOSED - 56.10%

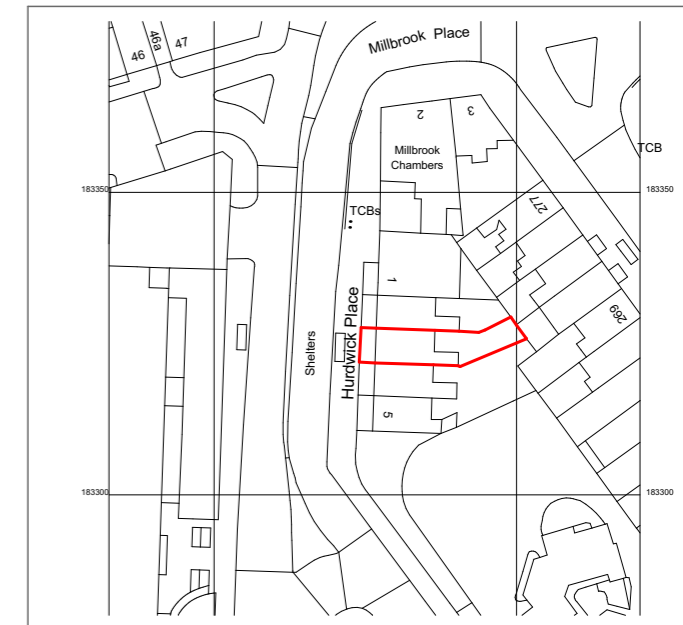

SITE LOCATION PLAN 1:1250

0 10 20 30 40 50m SCALE 1:1250

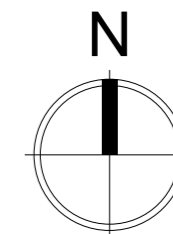

REVISION HISTORY	CODE	DATE

build LONDON
 ARCHITECTURE

36-38 OLD DEVONSHIRE ROAD, BALHAM,
 LONDON SW12 9RB

m: 020 86733380 e: architecture@buildlondon.com www.buildlondon.com

Client
MARTIN GRIFFITHS

Job Title
**RECONFIGURATION OF A
 LOWER GROUND FLAT**

3A HURDWICK PLACE, LONDON, NW1 2JE,

Drawing Title
SITE PLAN

Drawn by	Date	Checked by	Date
PL	07.02.2017	MT	07.02.2017

Scale	Drawing Status
1:1250, 1:500@A3	PLANNING

Drawing number	Revision
16130_PLN_01	0

© Crown copyright 2016. Supplied by mapserve.co.uk a licensed Ordnance Survey partner number 100053143
 Reproduction in whole or part is prohibited without the prior permission of Ordnance Survey

0 10 20 30 40 50m

SCALE 1:500