

# PARTITION TYPE 1

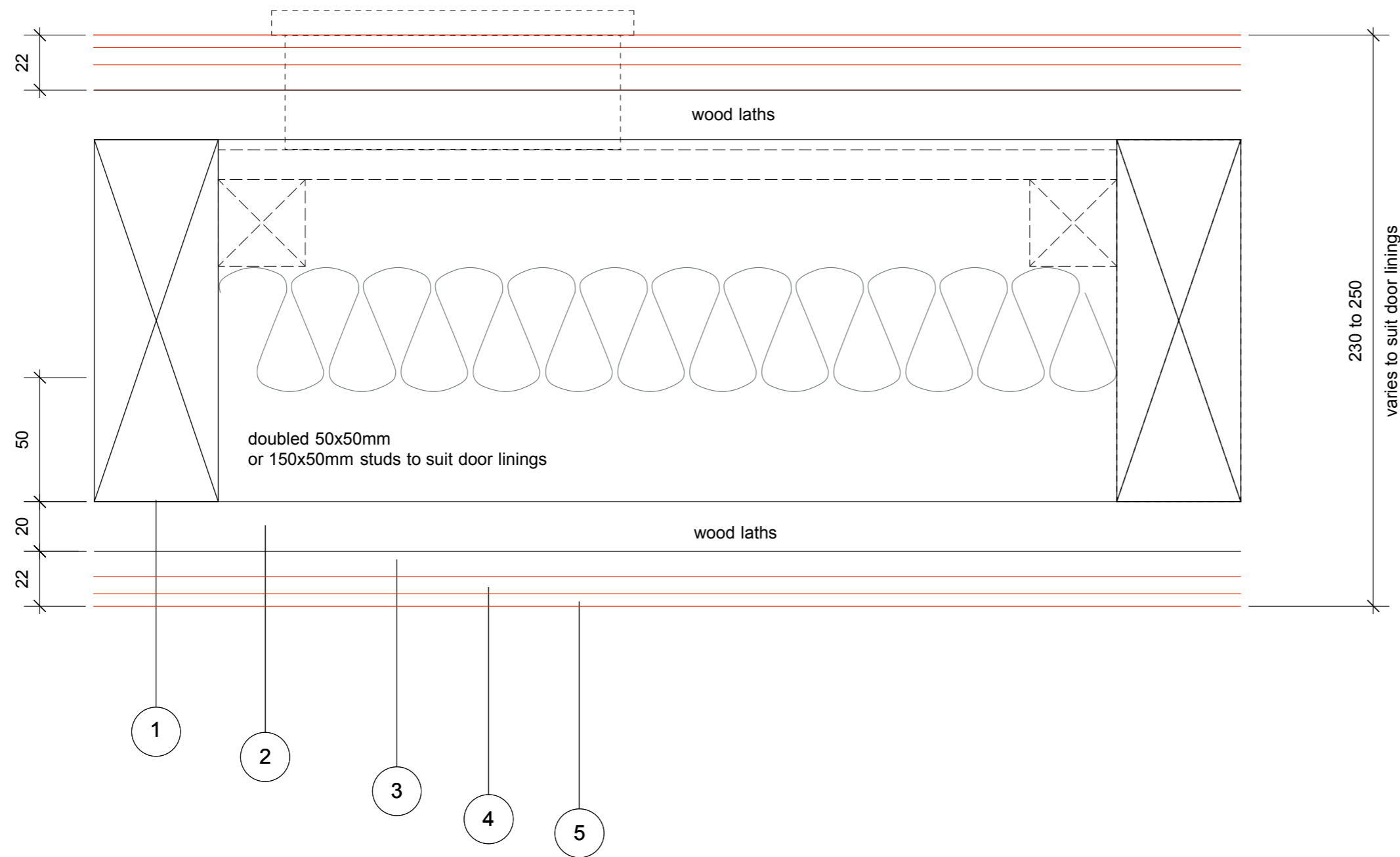

## NOTES FOR THE APPLICATION OF LIME PLASTER ON WOODEN LATHS

### Preparation

50mm Riven Chestnut laths at 6mm spacing fixed to timber studs using galvanised lath nails. Spray a mist of cold water on the lath before applying the scratch coat.

### First Coat of Lime Plaster.

Using a ratio of 1 part Lime putty to 2 & 1/2 to 3 parts sharp washed sand with evenly distributed horse hair throughout the mortar and working to a layer of 10mm thick pushed into and across pre wet laths at a 45° degree angle to the laths. Allow the plaster to set to set hard protecting from heat and draughts.

### Second Coat of Lime Plaster.

Using the same ratio as before but without horse hair apply the float coat wetting the base coat with a fine mist prior to applying plaster to a thickness of 7mm. Scratch the surface and leave to set in preparation for the finish coat.

### Finish Coat of Lime Plaster.

For the final coat use a fine mix of 1 part Lime putty to 2 parts well graded super fine sand. Wet down the surface before application with a fine mist spray allowing time for the water to absorb into the plaster then apply the top coat of approximately 5mm. Rule off and leave for a few hours. When ready rub up the finish coat using a plastic or wooden trowel to bring back the fat until the required finish has been reached. Light crazing can be rubbed up and trowelled out.

# PARTITION TYPE 2

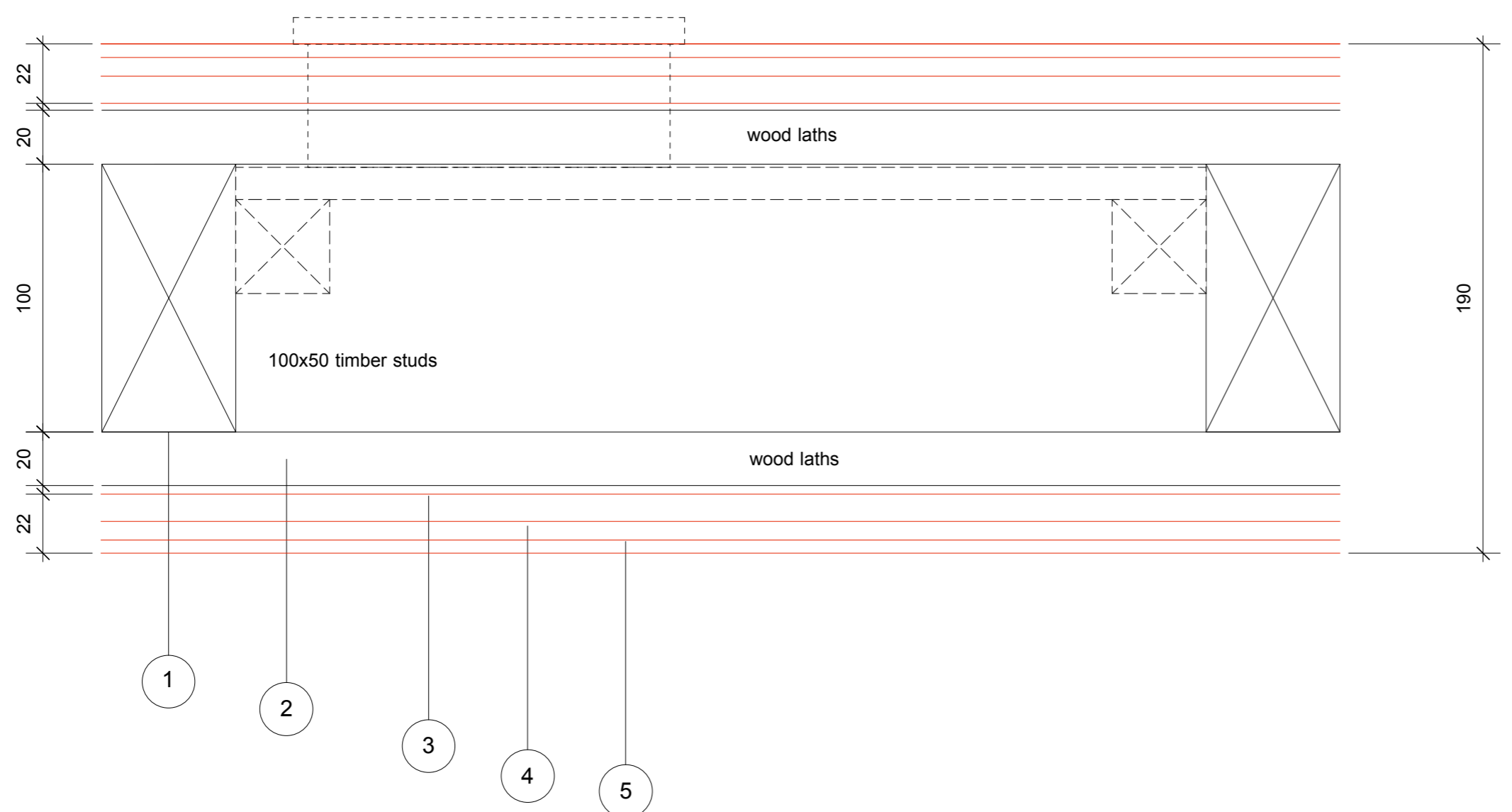

# PARTITION TYPE 3

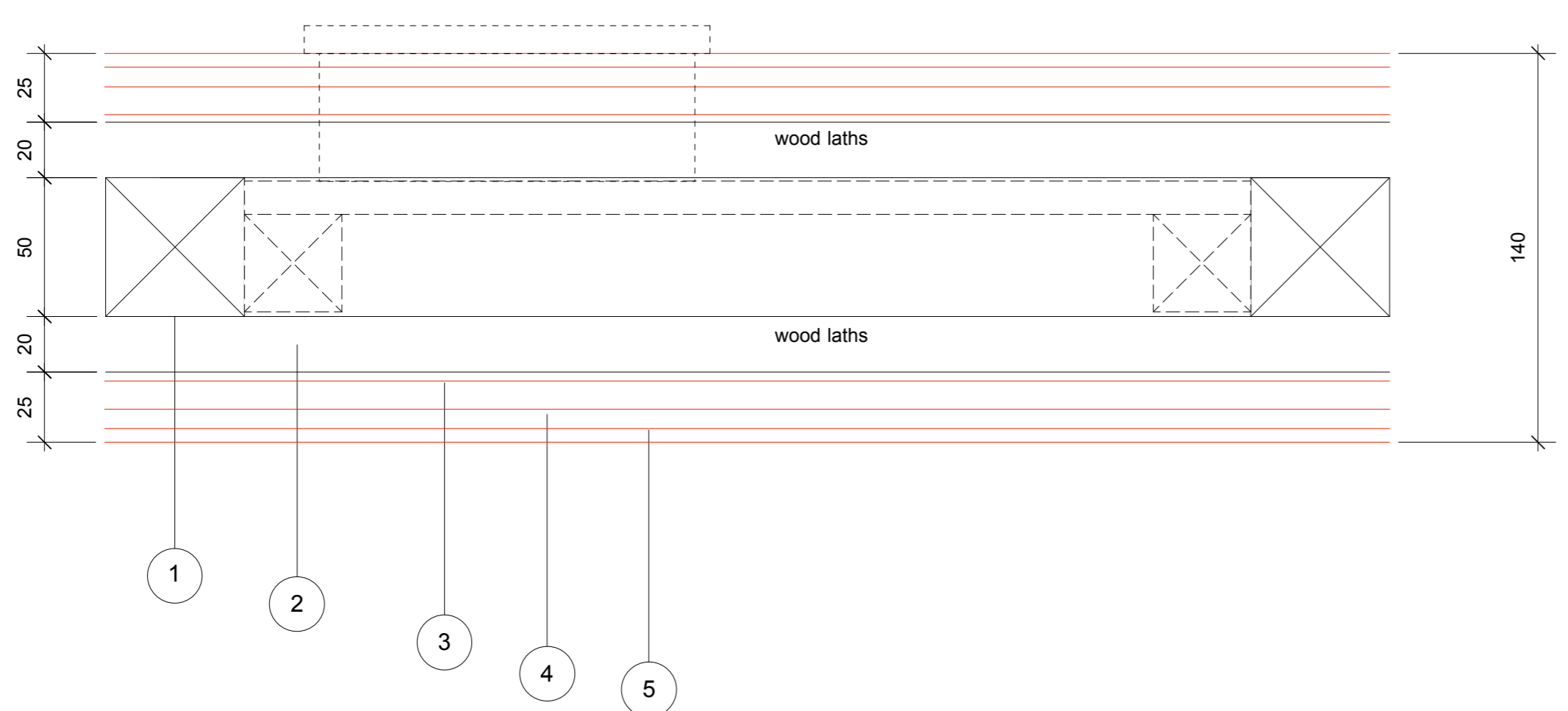

## Notes

1. Timber stud partition
2. 50mm Riven Chestnut laths at 6mm spacing fixed to timber studs using galvanised lath nails.
3. 10mm 1st coat of Lime plaster  
1 part lime putty to 2 1/2 parts of sharp washed sand with horse hair.
4. 7mm 2nd coat of Lime plaster  
1 part lime putty to 2 1/2 parts of sharp washed sand without horse hair. Scratch coat.
5. 5mm top coat of Lime plaster  
1 part lime putty to 2 parts of fine sand.

## 1:2 TYPICAL PARTITIONS - PLAN DETAIL - 1

## PLANNING AND LISTED BLDG CONSENT SUBMISSION

NB: Final details of all interior elements and specifications are subject to review by client's consultant historians and may be subject to subsequent design development

**A1** 1:2 @ A1  
1:4 @ A3

 11, Notham Road, London, W11 2BP Tel: 020 7229 9375 Fax: 020 7221 4172	DRAWING <b>TYPICAL PARTITION DETAIL - 1</b>	DRWG. N° <b>492/sk-01</b>
	PROJECT <b>THE ELMS, FITZROY PARK, N6 6HS</b>	Rev. <b>B</b>
	CLIENT <b>ELM INTERNATIONAL LTD</b>	Scale <b>1:2@ A1</b>
		Date <b>Nov 2016</b>
	Drawn	

DO NOT SCALE FROM THIS DRAWING. ALL DIMENSIONS TO BE CHECKED ON SITE AND DISCREPANCIES REPORTED TO ARCHITECT