

# Section

Scale 1:10

Location Plan #1065997

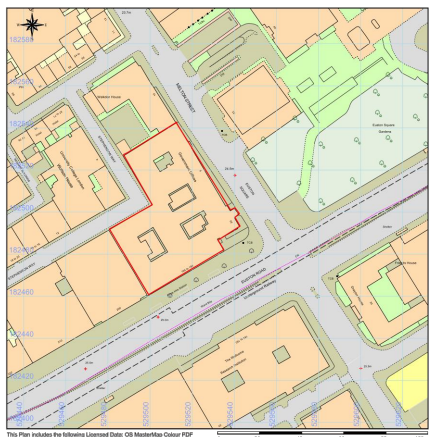

This Plan includes the following Licensed Data: OS MasterMap Colour PIP  
 Ordnance Survey (© Crown Copyright and Database Right) 2016. All rights reserved.  
 Reproduced in whole or in part in accordance with the terms and conditions of  
 Ordnance Survey. The representation of a road, track or path from an extract of a  
 digital map. The representation of buildings, structures, boundaries, etc. is a representation of  
 Ordnance Survey. Ordnance Survey is a registered trademark of Ordnance Survey.  
 Scale: 1:1250, paper size: A4

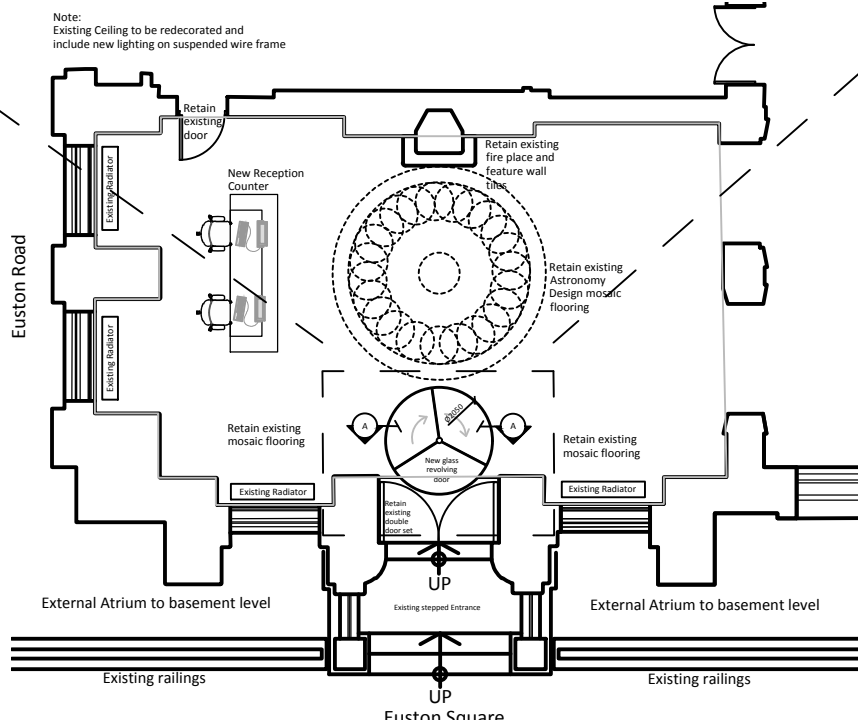
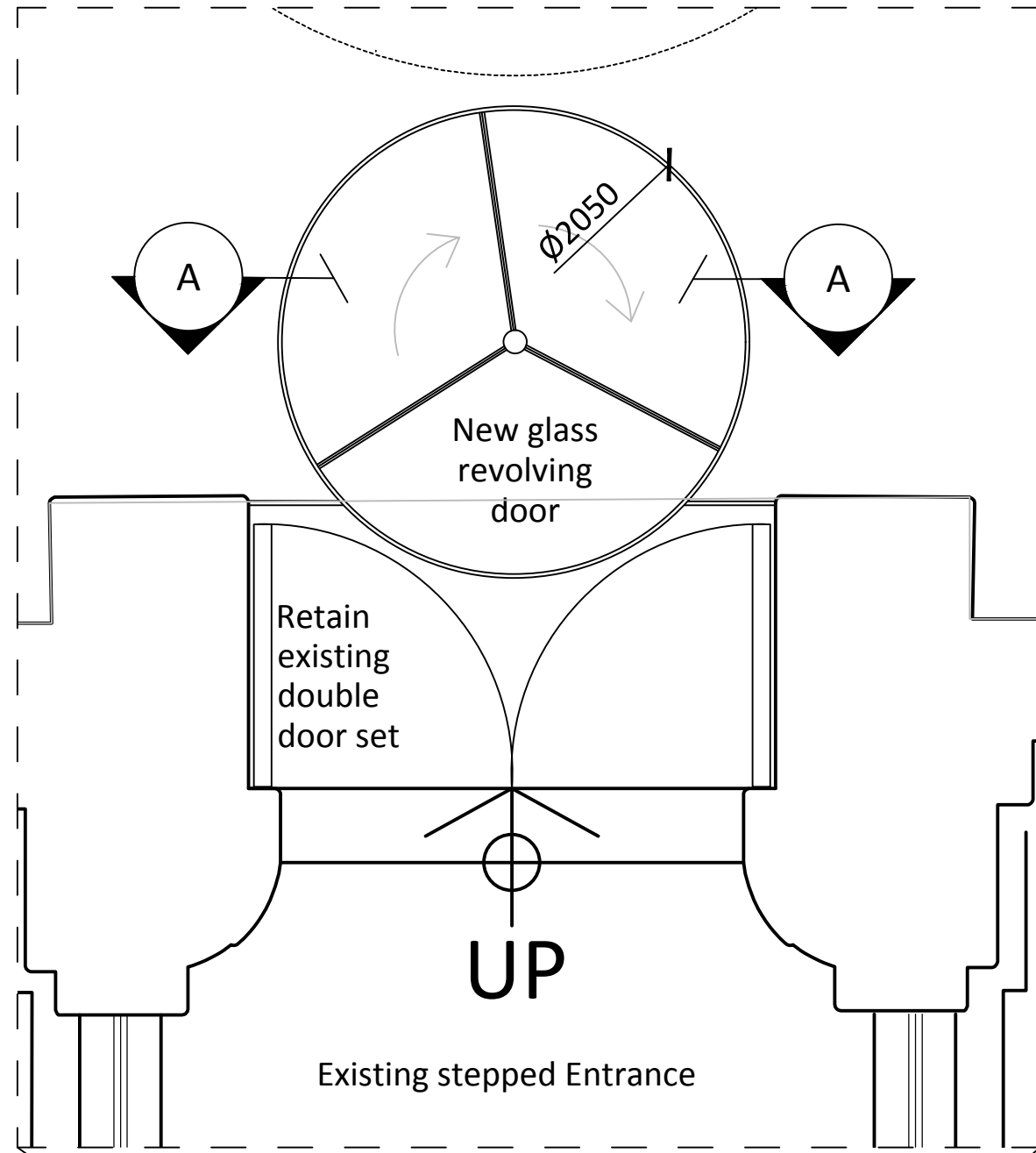

Proposed Lobby

area  
 Fourfront Group

THE DRAWING IS NOT TO BE SCALED  
 THE ORIGINAL CONTRACTOR SHALL BE CONSULTED ON ANY REVISIONS OR AMENDMENTS

THIS DRAWING IS PROTECTED BY COPYRIGHT AND IS NOT TO BE REPRODUCED IN WHOLE OR IN PART UNLESS AUTHORIZED BY area

DRAWING TO BE READ IN CONJUNCTION WITH SCOPE OF WORKS

CEILING HEIGHT	4000MM
BEAM HEIGHT	
WINDOW HEIGHT	
SILL HEIGHT	

THIS DRAWING IS ON RECYCLED PAPER

DATE	REVISIONS	SIGN	CHKD
09.03.17	A	MODIFIED REVOLVING DOOR AND INCLUDED DOOR ELEVATION	PM

area  
 Fourfront Group

The Old Post Office  
 33 Station Road,  
 Egham,  
 Surrey TW20 9LA

5th Floor,  
 Counting House,  
 53 Tooley Street,  
 London SE1 2QN

T. 01784 274000 | T. 020 7089 6000

info@areasq.co.uk | www.areasq.co.uk

DRAWING STATUS

INFORMATION ONLY

CLIENT  
 Royal College of General Practitioners

PROJECT  
 30 Euston Square  
 London  
 NW1 2FB

TITLE  
 Ground Floor - Reception  
 New Glazed Revolving Door

SCALE  
 1:50, 1:10@ A0

DATE  
 Dec 2016

DRAWN  
 PM

CHECKED

PROJECT NO	BLDG.	FLOOR	DETAIL	REV.
5850 - 03		G		A