

SCALE (@ A3) 1 : 1250

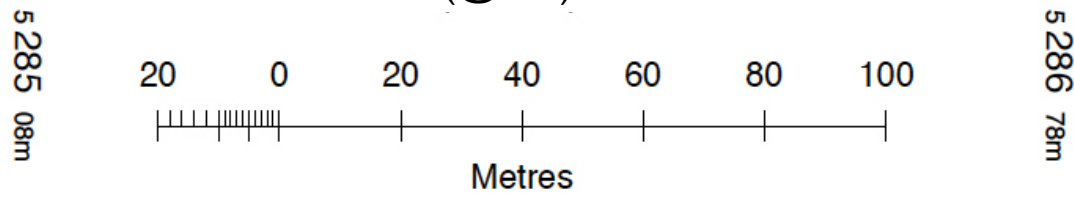

LOCATION PLAN

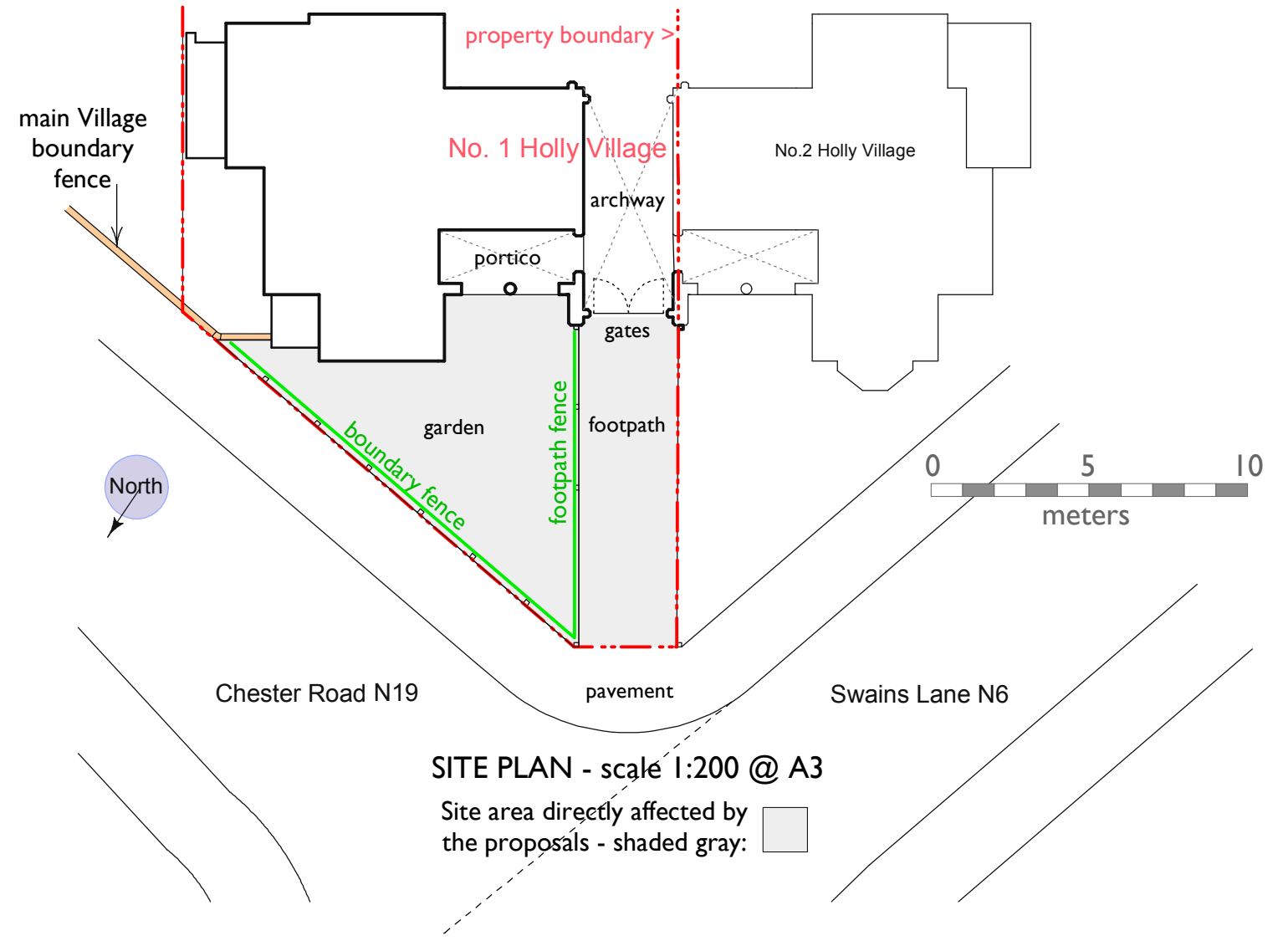

SITE PLAN - scale 1:200 @ A3

Site area directly affected by the proposals - shaded gray:



photo: c.1870

Swains Lane

Proposed 14 no. (replacement) posts & chains with new ground finishes to footpath at entrance to 1 Holly Village, London N6 6QJ

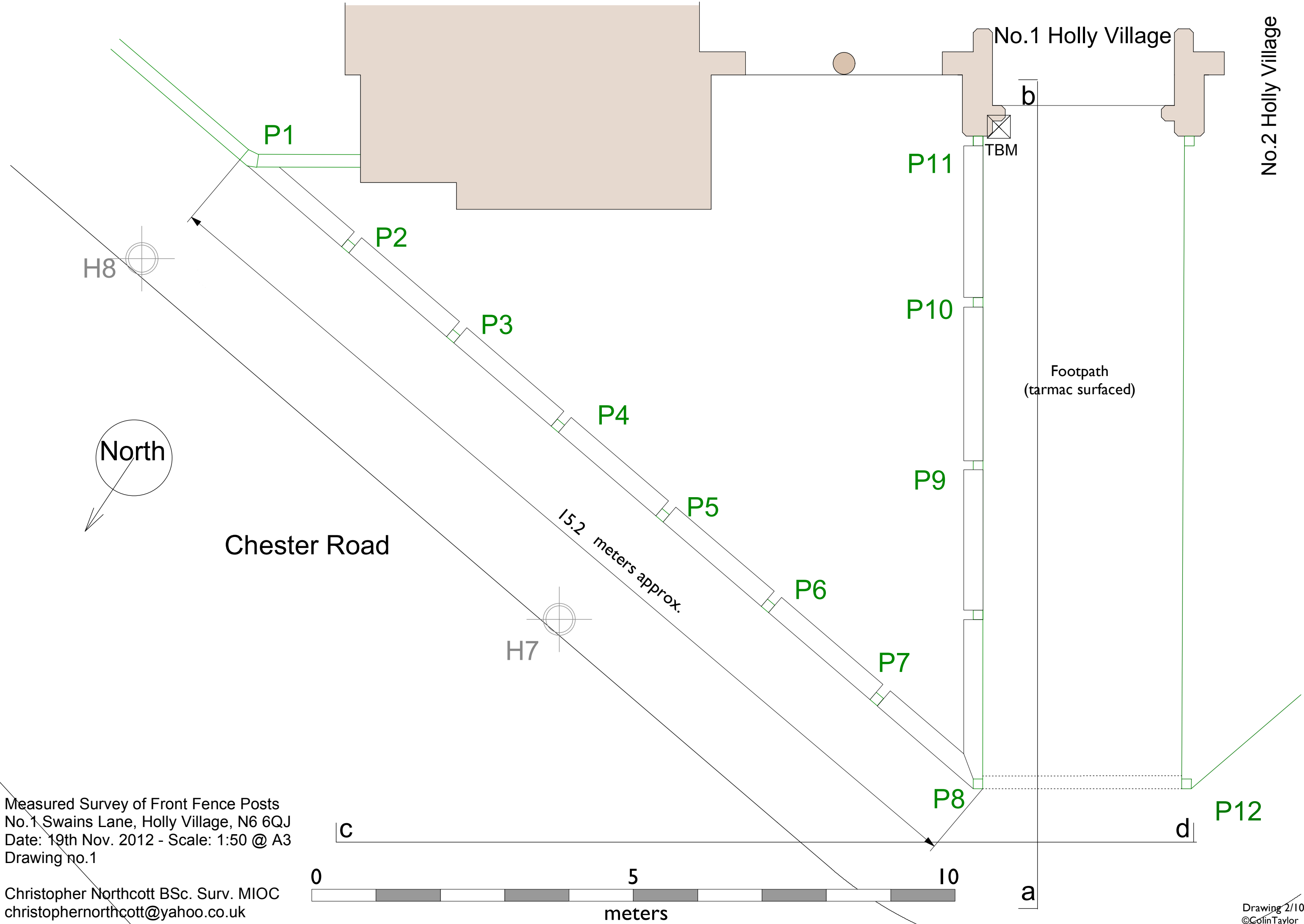

Measured Survey of Front Fence Posts
 No.1 Swains Lane, Holly Village, N6 6QJ
 Date: 19th Nov. 2012 - Scale: 1:50 @ A3
 Drawing no.1

Christopher Northcott BSc. Surv. MIOC
 christophernorthcott@yahoo.co.uk

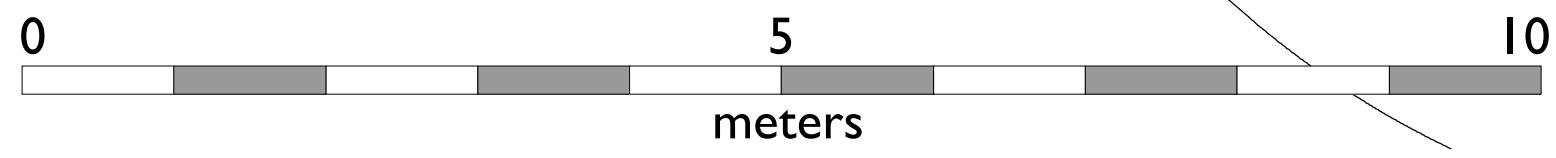

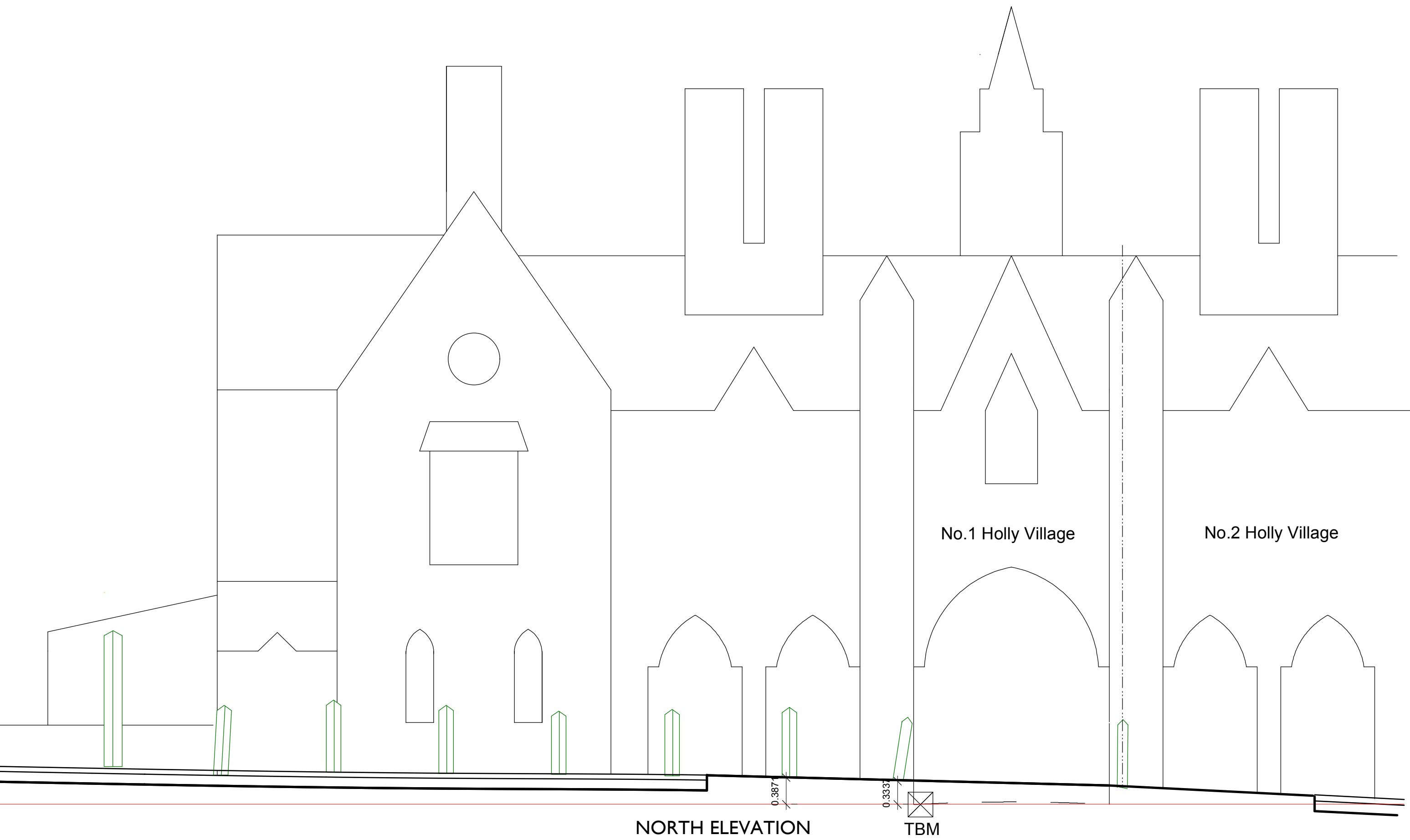

C d

Measured Survey of Front Fence Posts
 No.1 Swains Lane, Holly Village, N6 6QJ
 Date: 19th Nov. 2012 - Scale: 1:50 @ A3
 Drawing no.2

Christopher Northcott BSc. Surv. MIOC
 christophernorthcott@yahoo.co.uk

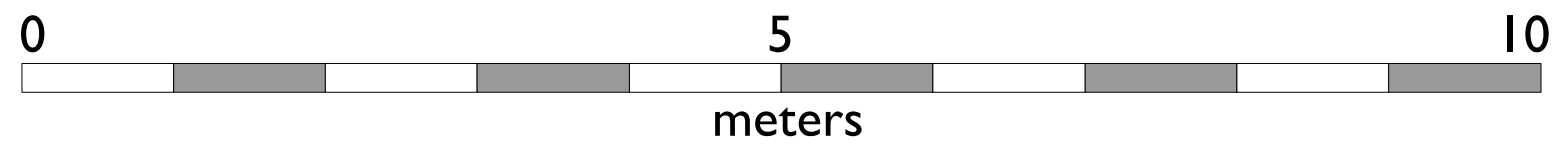

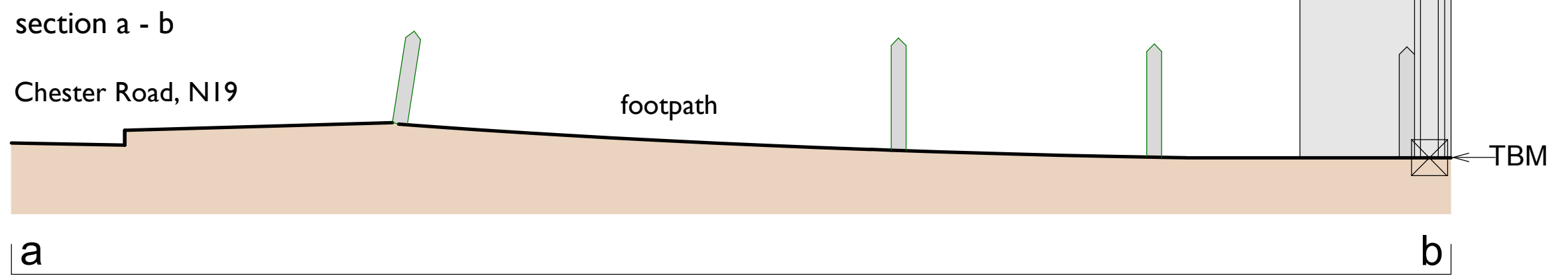
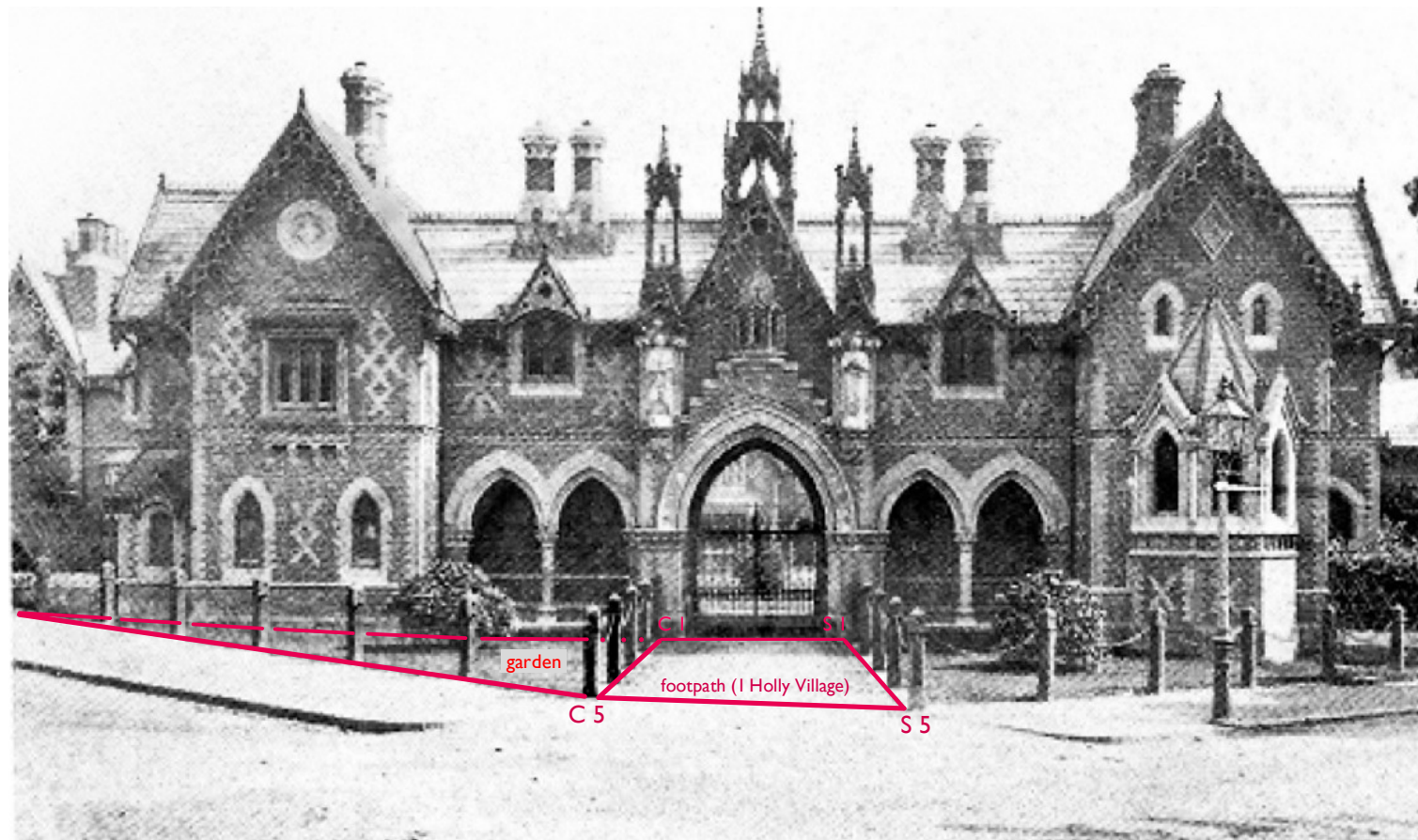

Measured Survey of Front Fence Posts
 No.1 Swains Lane, Holly Village, N6 6QJ
 Date: 19th Nov. 2012 - Scale: 1:50 @ A3
 Drawing no.3

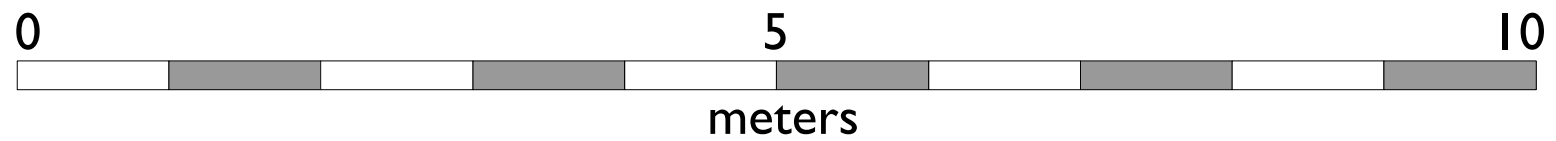

Christopher Northcott BSc. Surv. MIOC
 christophernorthcott@yahoo.co.uk

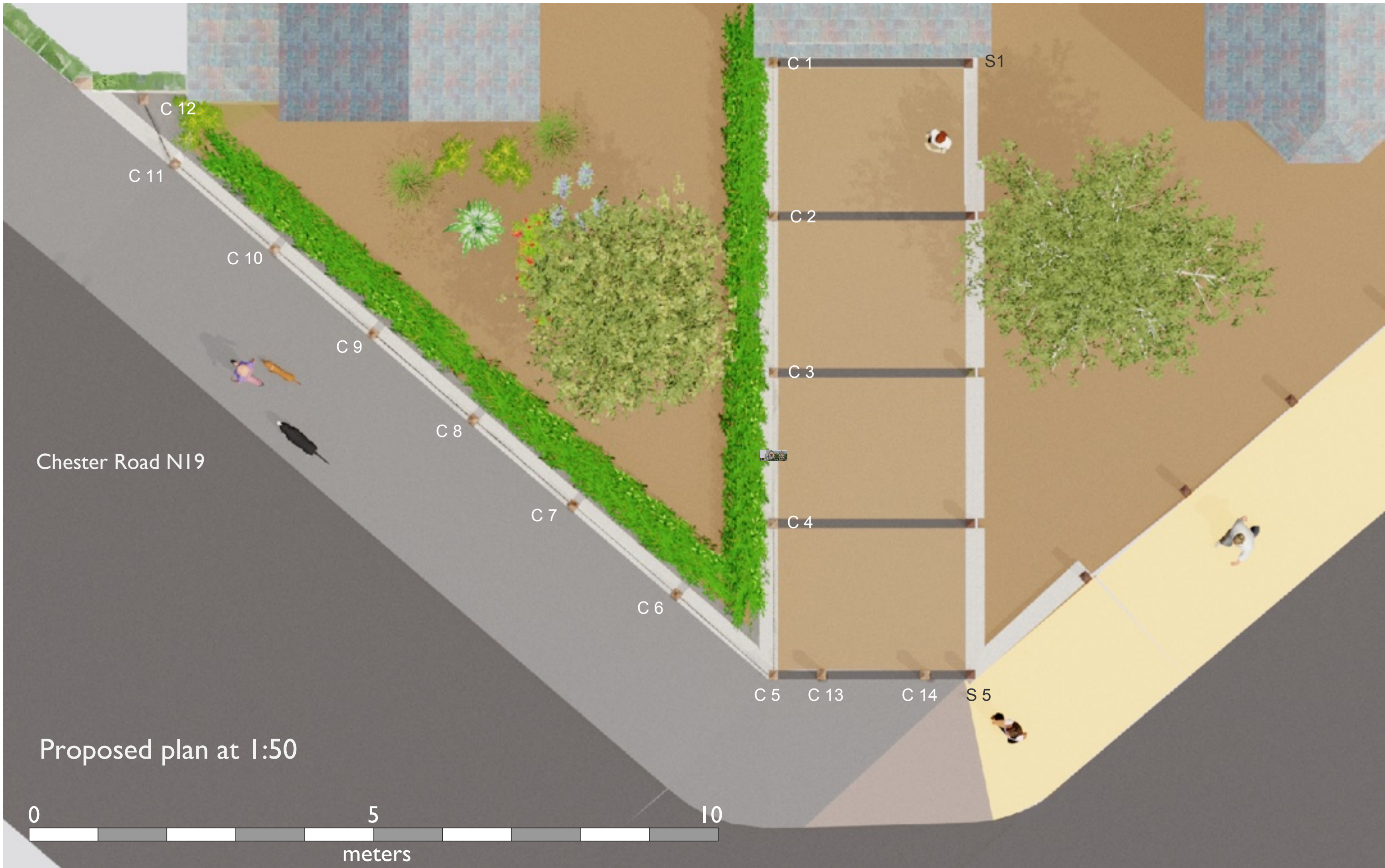

Chester Road NI9

Proposed plan at 1:50

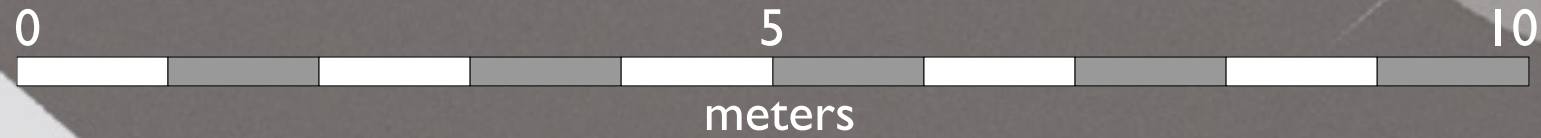





view toward Chester Road

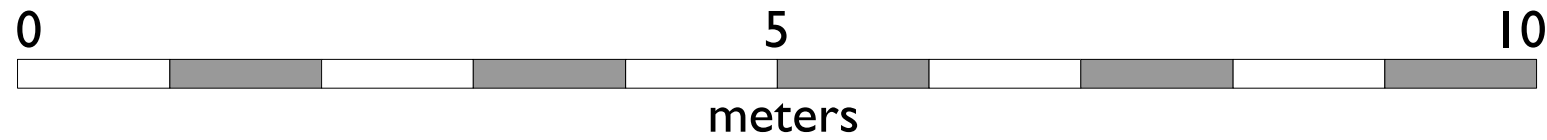
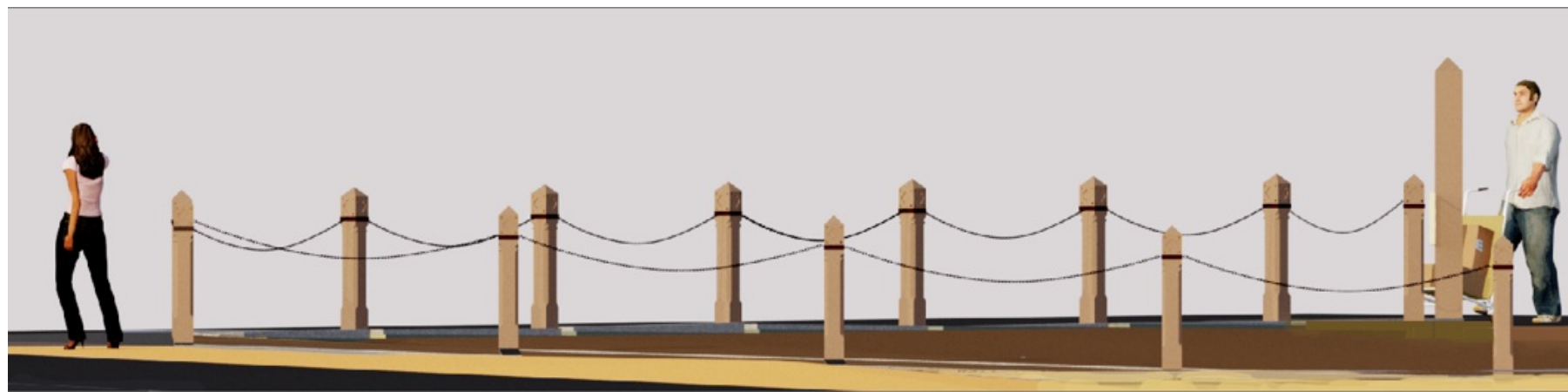

footpath elevation (C1 to C5) at 1:50 (@ A3) & C 6 to C 12



height: 1,050 mm.

Oak post & collar:
as proposed

Oak post & collar:
as original (CI)



Garden proposal:
low hedge, gravel and planting

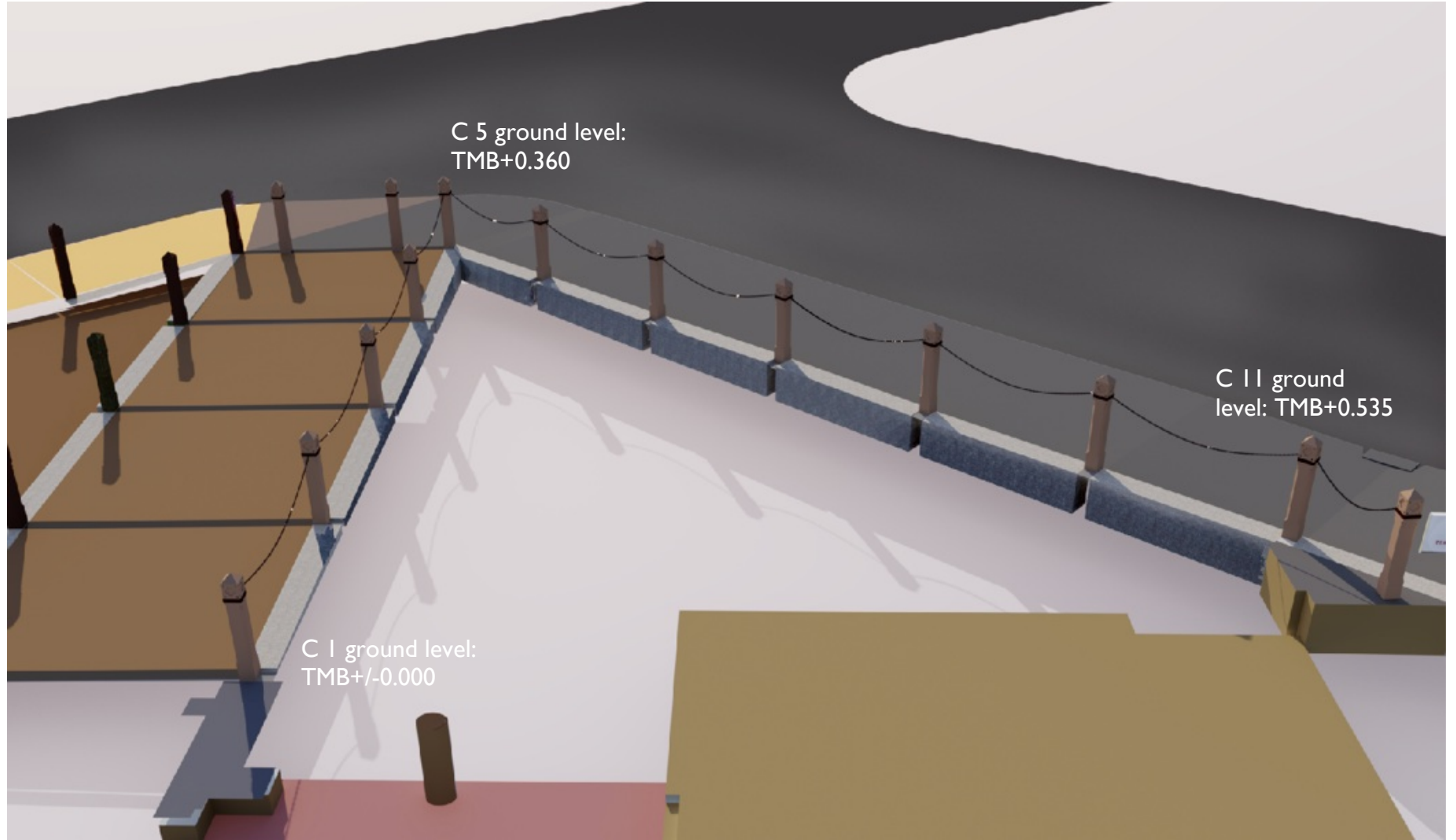

Ground levels:
diagram shows continuous rise
from C I to C II and C 12

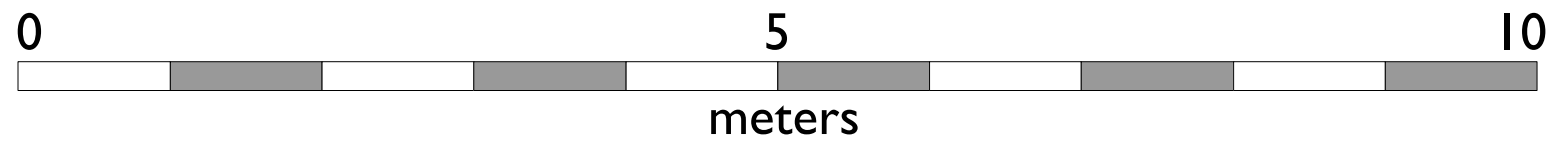

Elevation to Chester Road/ Swains Lane: scale 1:50 @ A3

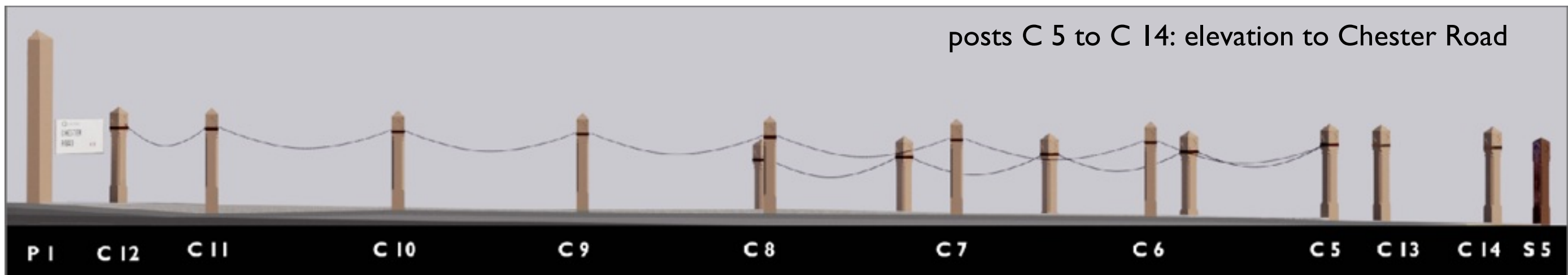

posts C 5 to C 14: elevation to Chester Road



The Proposal:
A RETURN TO A CLEAR VIEW
OF THE ELEVATION AS VISIBLE AS 1870