





BUILDING DESIGN PARTNERSHIP LTD SHALL HAVE NO RESPONSIBILITY FOR ANY USE MADE OF THIS DOCUMENT OTHER THAN FOR THAT WHICH IT WAS PREPARED AND ISSUED.
 ALL DIMENSIONS SHOULD BE CHECKED ON SITE.
 DO NOT SCALE FROM THIS DRAWING.
 ANY DRAWING ERRORS OR DIVERGENCES SHOULD BE BROUGHT TO THE ATTENTION OF BUILDING DESIGN PARTNERSHIP LTD AT THE ADDRESS SHOWN BELOW.

NOTES

EXISTING BUILDING SURVEY INFORMATION BY PLOWMAN CRAVEN, TO BE READ IN CONJUNCTION WITH ALL RELEVANT PROJECT INFORMATION.

REFER TO SERVICES ENGINEERS DRAWINGS FOR DETAILS OF PROPOSED PLANT INC, RISERS, DUCTS, FLUES, EXTRACT GRILLES, LOUVRES, ETC, AND ASSOCIATED BUILDERS WORK.

KEY:

-  GREY TONE INDICATES EXISTING STRUCTURE RETAINED
-  HATCH INDICATES AREA OF NEW CONSTRUCTION
-  LOCATIONS WHERE OPENINGS CAN BE REINSTATED IF REQUIRED
-  HATCH INDICATES AREAS WITH NEW CEILINGS

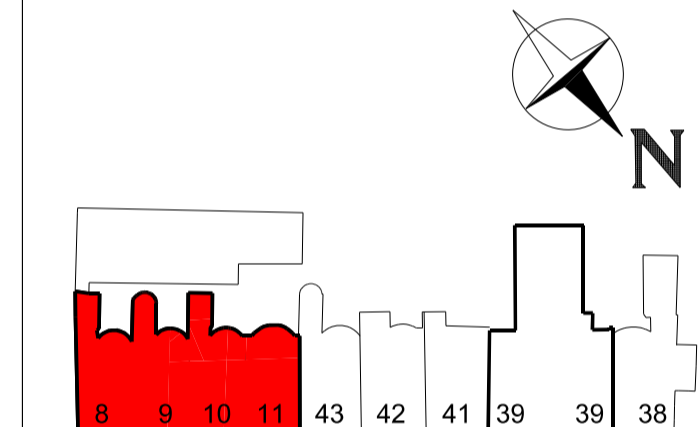

REVISION DESCRIPTION	DRAWN	CHECKED	DATE
Listed Building Consent Application			03/11/16
- Location of new service risers identified			
- New ceiling installed in toilets, 340mm approx. lower than existing ceiling prior to work commencing on site			
- Existing openings in party walls between properties 8MS & 10MS and 9MS & 10MS enclosed with fire protected panels to avoid major works should there be a requirement to reinstate openings at a later stage			
- 2.01.D01, 2.01.D05, 2.01.D08 new four panel half glazed fire doors			
Listed Building Consent Application - Rev B			18/11/16
- Infill in party walls already consented			



BDP.

16 Brewhouse Yard
 Clerkenwell
 London EC1V 4LJ
 United Kingdom
 T +44 (0)20 7812 8000
 F +44 (0)20 7812 8399
 www.bdp.com

PROJECT TITLE	
British Museum Perimeter Properties Refurbishment	
PROJECT NUMBER	
P2002323	
DATE	SCALE
No.8 - No.11 Montague Street	1:50 @ A1
Proposed Series	1:100 @ A3
Plan	DATE
Second Floor Level	03/11/2016
Listed Building Consent Application	REVISION
(20)AP012	Rev B

AS PROPOSED

No.8

No.9

No.10

No.11