

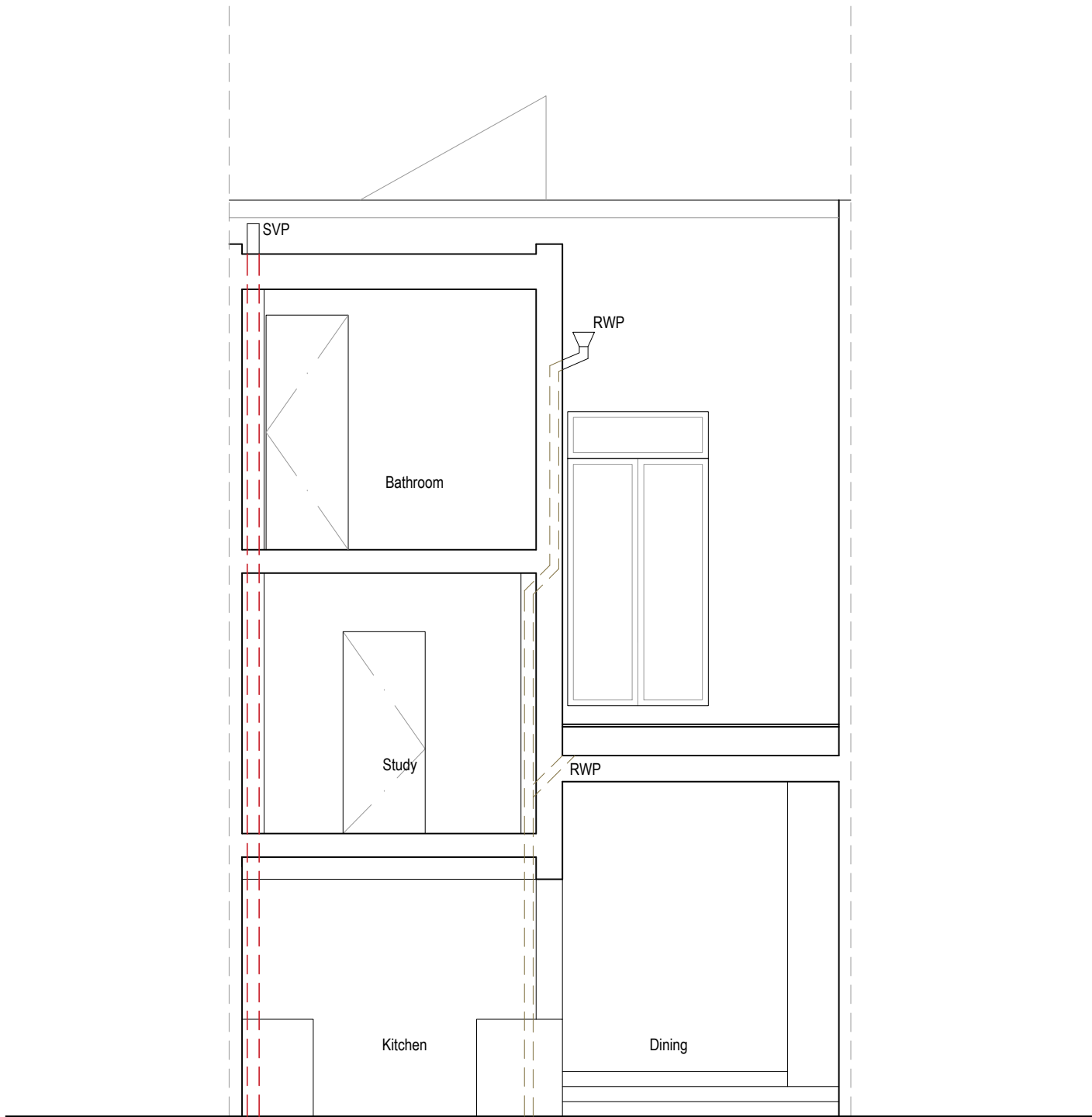

1 Existing Rear Elevation

Scale 1:50 at A3

0m 1 2m



2 Existing Section B-B

Scale 1:50 at A3

0m 1 2m

General Notes:

1. Please do not scale from this drawing.
2. All dimensions to be checked on site by the contractor.
3. All references to drawings refer to current revision of that drawing.
4. Structural services information shown is indicative only. Refer to consultants drawings for details and setting out.
5. All work and materials to be in accordance with current applicable statutory legislation and to comply with all relevant codes of practice and British standards.
6. Please report all drawing errors and omissions to the architect.

Rev Notes:

A. XX.XX.XX - XXXX

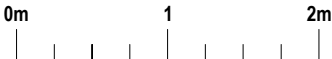

Rich Architecture
25B Lloyd Baker Street, London, WC1X 9AT
T | 0207 096 0652 E | info@rich.uk.com
www.richarchitecture.co.uk

Project:
16 HARMOOD STREET, LONDON NW1 8DJ

Drawing Title:
EXISTING REAR ELEVATION & SECTION BB

Date:
30.02.17

Scale:
1:50 @ A3

Drawing No:
512-P04