

Netley Primary School

Swept Analysis

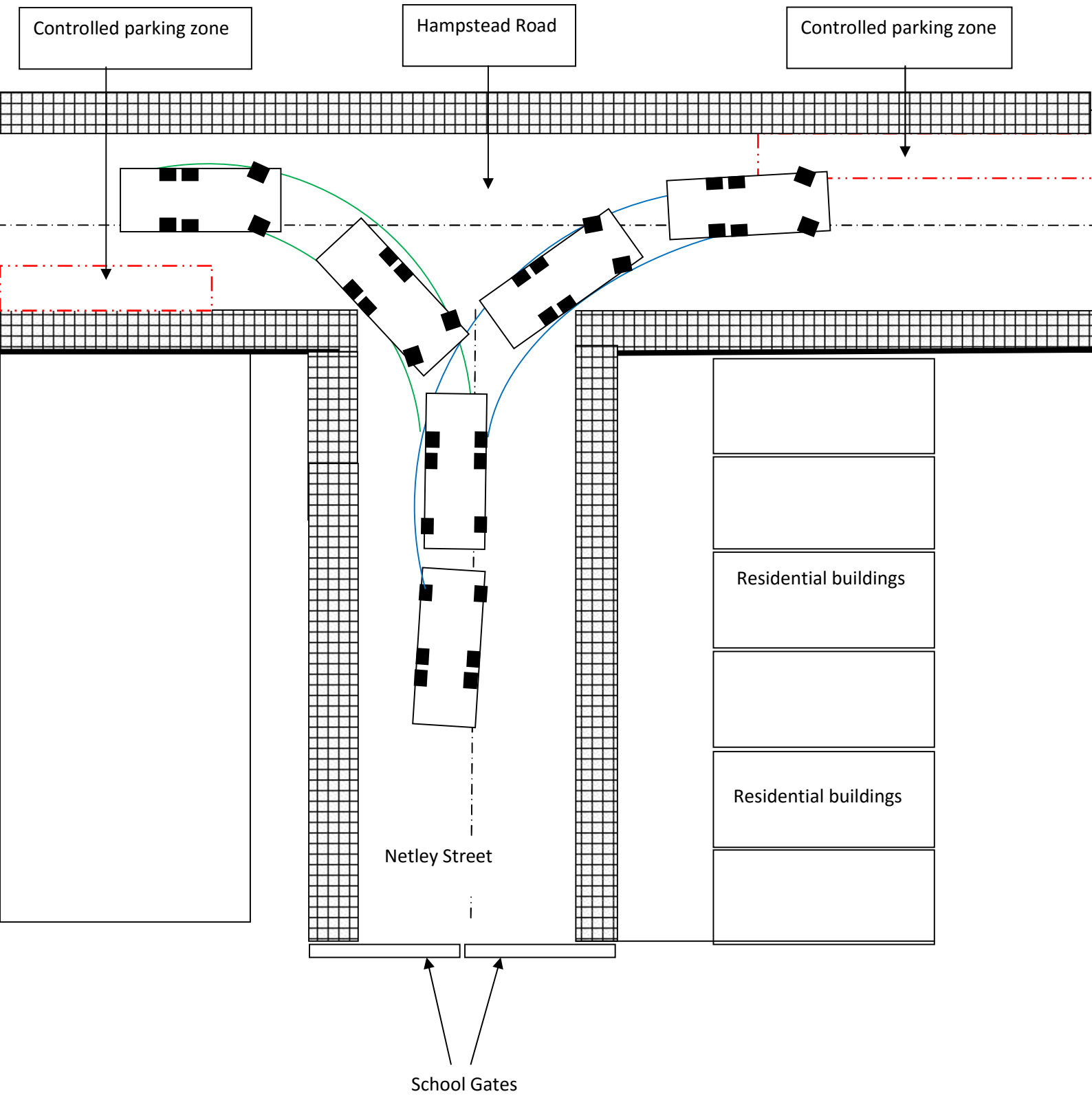

Netley Primary School

At the Rear of the School there is a no through road called Netley street to service the school and the residential properties Adjacent.

Netley Streey is a junction with Hampstead Road, it runs along the North boundary of the school so is very close to all of the construction phases of the project.

Hampstead Road, in the vicinity of the site, is a double carriageway two way street and is subject to 30mph speed limit. Annual average daily traffic flow on Hampstead Road is approximately 10,000 vehicles with approximately 1,000 vehicles during the peak hours.

Access into and out off Netley Street will be carefully managed by two banksmen in order to ensure the safe operation of the deliveries including for highway safety on Hampstead Road. It is not anticipated that the amount of inbound and outbound operational vehicle trips during the morning and/or evening peak hours would give rise to any significant traffic impacts with respect to the safe ingress and egress of vehicles. The small number of additional vehicular trips generated during the construction phase of the proposed development will be insufficient to have any significant detrimental impact on the local road network, since they represent less than a 1% increase in peak hour traffic flow. Similarly the relatively small number of public transport and non-motorised (walking and cycling) trips generated by the proposed development will also be insufficient to have a significant detrimental impact on local bus services and pedestrian and cyclist facilities in the vicinity.

As mentioned in the previous paragraph, relatively few vehicle movements are anticipated to be generated by the construction works associated with the proposed development and appropriate arrangements for the management and control of construction traffic movements to minimise adverse impacts have been put in place and discussed with all our suppliers, this includes the issuing of time slots for deliveries to ensure lorries are not waiting in the surrounding roads for access to site. Also, sub-contractors are limited to one vehicle to ensure parking for only necessary vehicles in the surrounding roads. Consequently, the construction traffic associated with the proposed development is not anticipated to be sufficient to have a significant adverse impact on the road network.