

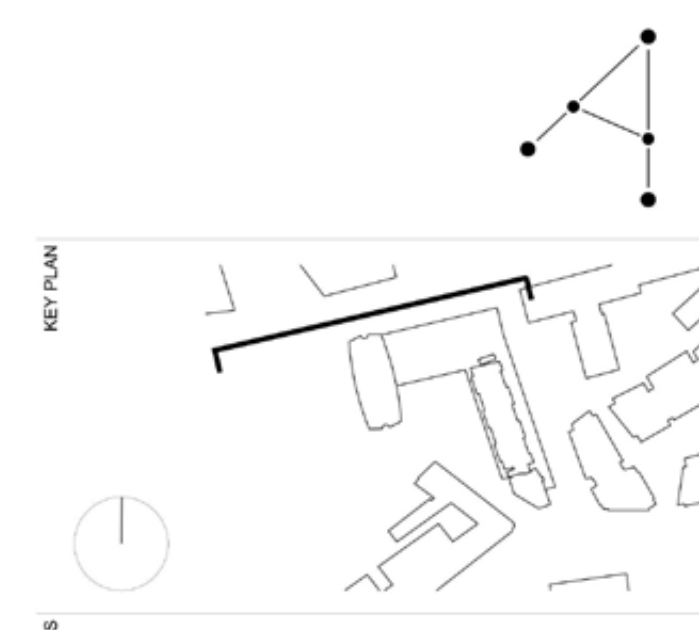

- 41.303m CPL THIRD FLOOR SSL (potentially varies)
- 37.624m CPL SECOND FLOOR SSL (potentially varies)
- 4571
- 33.053m CPL UPPER LINK BRIDGE SSL (potentially varies)
- 31.529m CPL FIRST FLOOR SSL (potentially varies)
- 28.688m CPL MEZZANINE FLOOR SSL (potentially varies)
- 3134 2839
- CPL GROUND FLOOR SSL (potentially varies)
- 3966
- 21.589m BASEMENT SSL (potentially varies)
- 2939
- 18.650m SUB BASEMENT SSL (potentially varies)

NOTES
 DO NOT SCALE FROM THIS DRAWING.
 CONTRACTOR TO CHECK ALL DIMENSIONS ON SITE.
 ANY DISCREPANCIES TO BE REPORTED TO THE ARCHITECT IMMEDIATELY.
 THE SURVEY INFORMATION CONTAINED IN THIS DRAWING WAS PROVIDED BY PLOWMAN CRAVEN SURVEY DRAWINGS DEC 2011 - OCT 2012.
 COPYRIGHT RICK MATHER ARCHITECTS LLP ©

REVISIONS	PL3	10.02.17	MINOR MATERIAL AMENDMENT
PL2	15.09.14	NON-MATERIAL AMENDMENT / LISTED BUILDING	
PL1	01.04.13	PLANNING ISSUE	
REV	DATE	DESCRIPTION	



STATUS **PLANNING**

RICK MATHER ARCHITECTS ©
 123 Camden High Street London NW1 7JR
 T: 020 7284 1727 F: 020 7287 7528
 info@rickmather.com www.rickmather.com

JOB **Centre Point**
 101-103 New Oxford Street
 London, WC1A 1DD **APP 1A**

TITLE **PROPOSED ELEVATION**
 NORTH (NEW OXFORD STREET) ELEVATION
 AMALGAMATED DRAWINGS

DRAWN	DT	JOB #	DWG #	REV		
		552	19502-CPA	PL3		
CHECKED	DW	SCALE@A1	SIZE	DATE	REV	DATE
		1:250	A1	APR 13		10.02.17