

BUILDING DESIGN PARTNERSHIP LTD SHALL HAVE NO RESPONSIBILITY FOR ANY USE MADE OF THIS DOCUMENT OTHER THAN FOR THAT WHICH IT WAS PREPARED AND ISSUED.
 ALL DIMENSIONS SHOULD BE CHECKED ON SITE.
 DO NOT SCALE FROM THIS DRAWING.
 ANY DRAWING ERRORS OR DIVERGENCES SHOULD BE BROUGHT TO THE ATTENTION OF BUILDING DESIGN PARTNERSHIP LTD AT THE ADDRESS SHOWN BELOW.

- NOTES**
- EXISTING BUILDING SURVEY INFORMATION BY FLOWMAN CRAVEN, TO BE READ IN CONJUNCTION WITH ALL RELEVANT PROJECT INFORMATION.
 - REFER TO SERVICES ENGINEERS DRAWINGS FOR DETAILS OF PROPOSED PLANT INC. RISERS, DUCTS, FLUES, EXTRACT GRILLES, LOUVRES, ETC. AND ASSOCIATED BUILDERS WORK.
- KEY:**
- GREY TONE INDICATES EXISTING STRUCTURE RETAINED
 - HATCH INDICATES AREA OF NEW CONSTRUCTION
 - NO WORKS TO BE CARRIED OUT TO THIS AREA

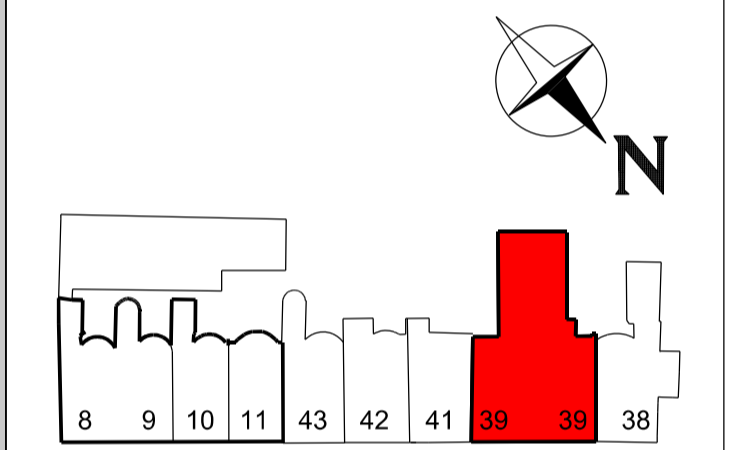

REVISION DESCRIPTION	DRAWN	CHECKED	DATE
Issue for Construction	JT	JT	19/01/16
Issue for Construction - Rev A	RC	JT	09/03/16
- Existing lightwell to remain with proposed decking - Proposed external french doors into 39RS/1/013 - Existing store 39RS/1/013 converted into office			
Issue for Construction - Rev B	RC	JT	14/06/16
- Existing corridor 39RS/1/006 converted into store room with new door from traverse corridor - Existing door blocked up between 39RS/1/006 & 39RS/1/015			



BDP.

16 Brewhouse Yard
 Clerkenwell
 London EC1V 4LJ
 United Kingdom
 T +44 (0)20 7812 8000
 F +44 (0)20 7812 8399
 www.bdp.com

PROJECT TITLE	British Museum Perimeter Properties Refurbishment
PROJECT NUMBER	P2002323
DRAWING TITLE	No.39 Russell Square Proposed Series Plan Basement Level 1 of 2 Issue for Construction
SCALE	1:50 @ A1 1:100 @ A3
DATE	19/01/2016
DRAWING NO.	(20)AP016
REVISION	REV B

AS CONSENTED