

NOTE:  
ALL CEILING ELECTRICAL WIRING WILL RUN ALONG EXISTING JOIST NOTCHES.

DUE TO THE CURRENT CONDITION OF MODERN PLASTERBOARD CEILING TO BE RE-BOARDED.

ALL LIGHTING COMPONENTS TO WORK WITH REPLACEMENT CEILING.

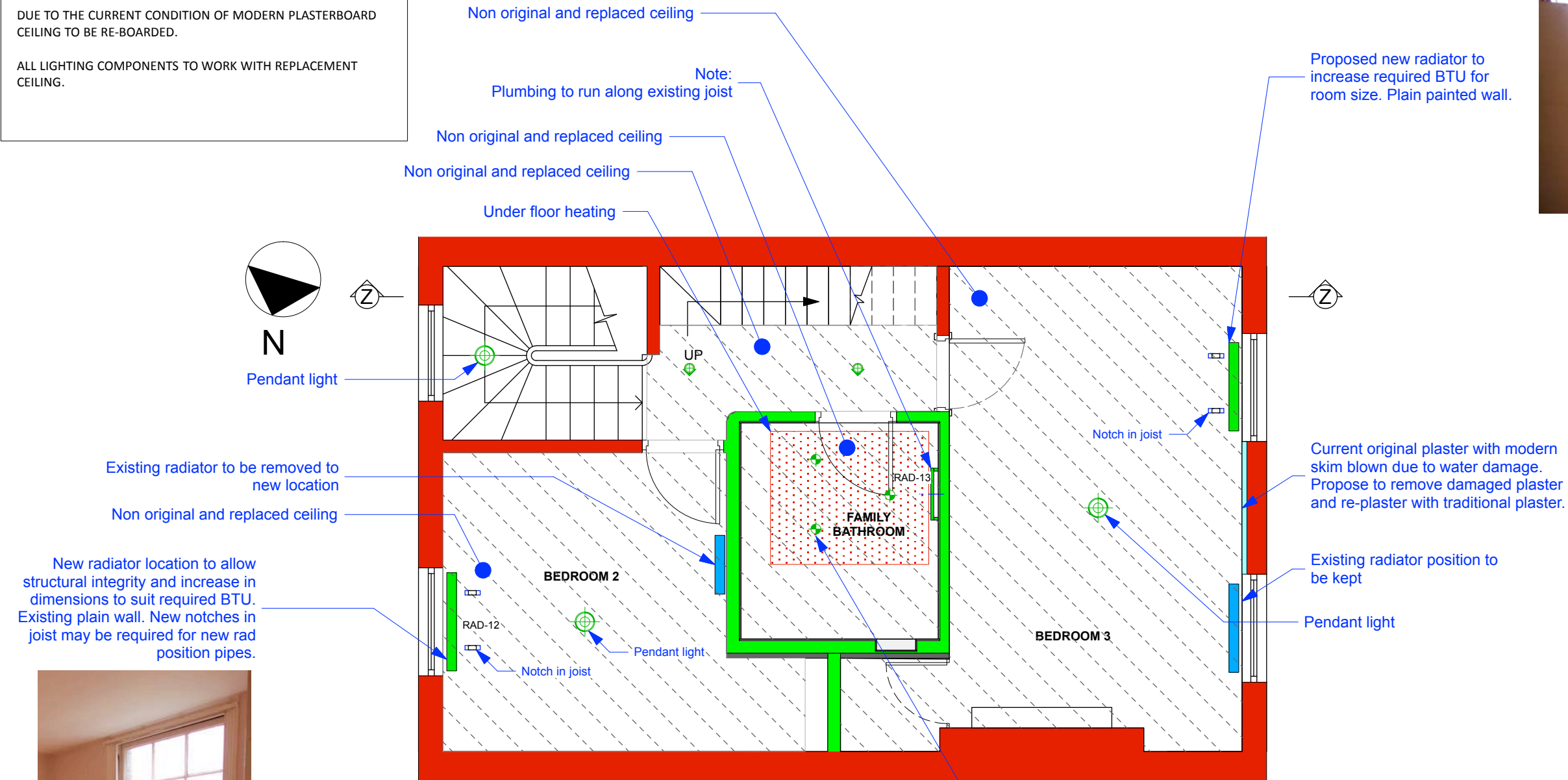

1 PROPOSED SECOND FLOOR M&E PLANNING AMENDMENTS  
Scale: 1:50

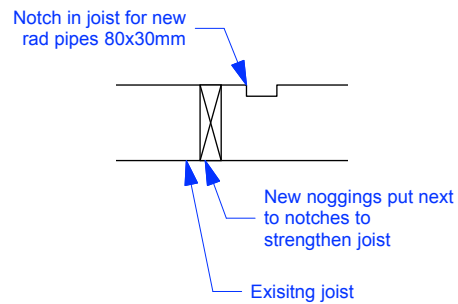

LEGEND - RADIATORS  
 PROPOSED RADIATOR POSITION  
 EXISTING RADIATOR POSITION

LEGEND  
 Existing Walls  
 Existing Non Historic Walls (Post 1973) to be demolished  
 New walls  
 Existing Originals Historic Wall (c 1835) to be demolished  
 Existing Non Historic Walls (Post 1973)  
 Existing wall proposed to be re-plastered using traditional plaster

ISSUE: A DATE: 11.01.17 COMMENT: Issue for Planning Only  
Issue for Planning Only

CallenderHoworth		Morelands 5-23 Old Street London EC1V 9HL T: 020 7336 8560 F: 020 7549 2152 W: www.callenderhoworth.com	
Job no.	<b>1198</b>	Job title <b>4 OVAL ROAD</b>	
Drawing no.	<b>133</b>	Drawing title <b>PROPOSED SECOND FLOOR M&amp;E PLANNING AMENDMENTS &amp; REPLACEMENT PLASTER</b>	
Scale	1:50	Size	A3
		Drawn	ML
		Revision	<b>A</b>

All works to be in accordance with relevant standards, British building codes, and other relevant codes, and with manufacturer recommendations and instructions. All dimensions to be checked on site. Do not scale from this drawing.