

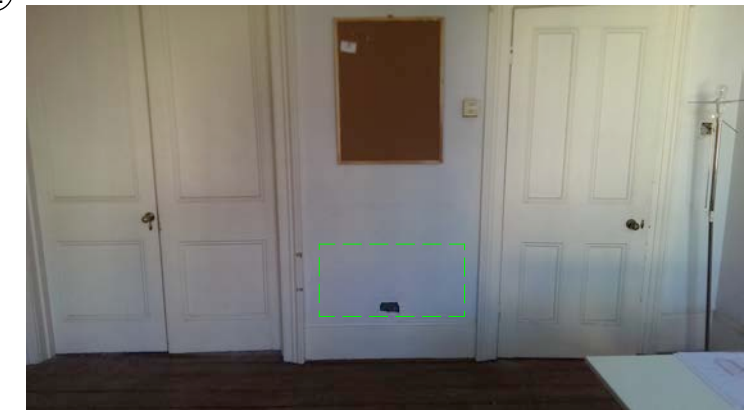

NOTE:
ALL CEILING ELECTRICAL WIRING WILL RUN ALONG EXISTING JOIST NOTCHES.

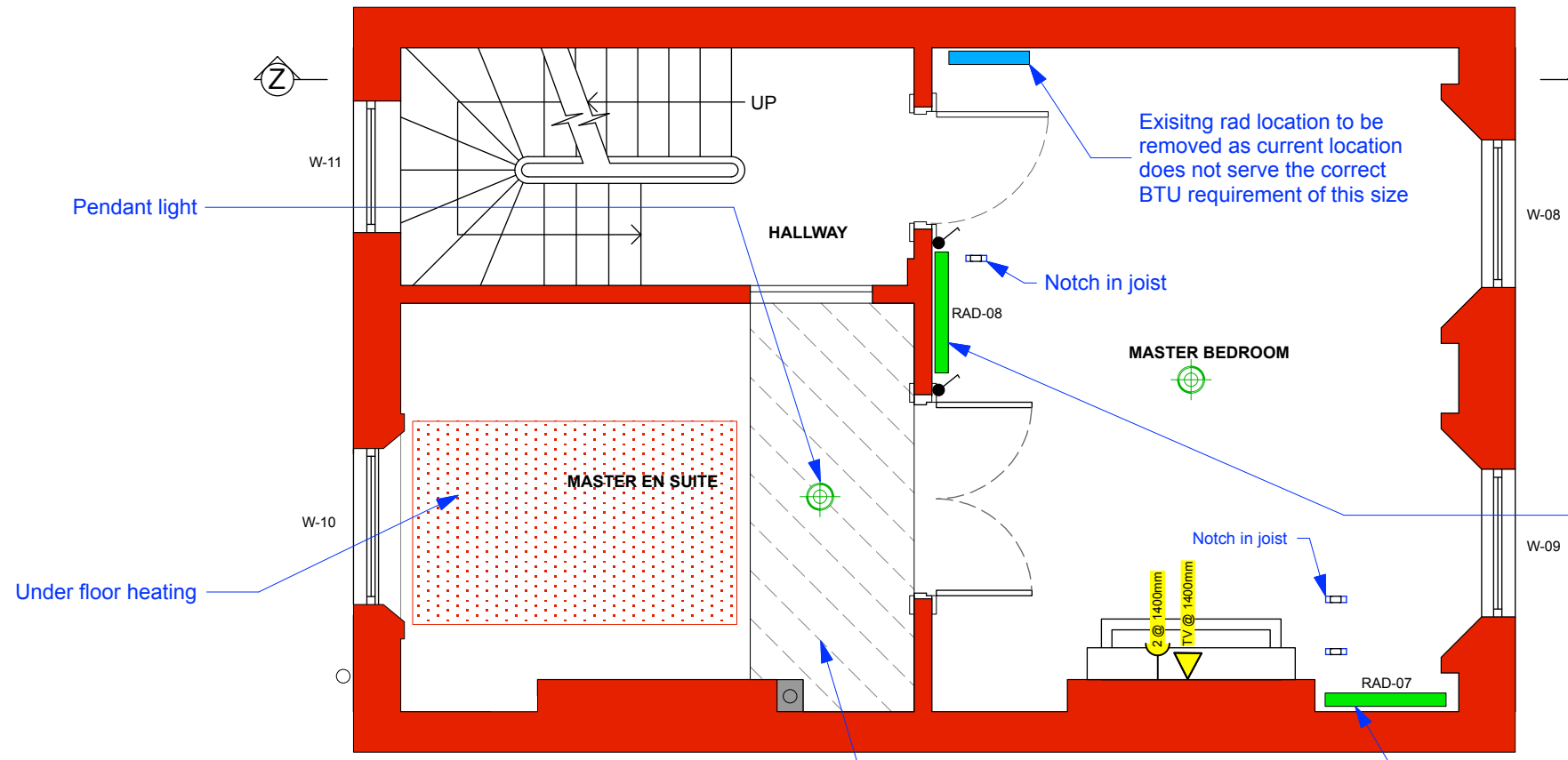

Proposed new radiator location to work best with the existing M&E configuration and BTU requirements. Existing plain wall. New notches may be required in joist for new rad pipes.

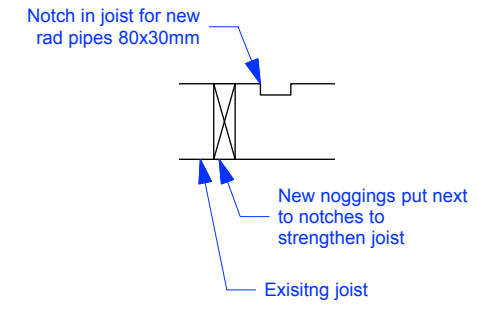

Proposed new radiator location to increase BTU output. Existing plain wall. New notches in joist may be required for new rad positions.

1 PROPOSED FIRST FLOOR M&E PLANNING AMENDMENTS
Scale: 1:50

ISSUE:	DATE:	COMMENT:
B	11.01.17	Issue for Planning Only
A	04.01.17	Issue for Planning Only
-	-	Issue for Planning Only

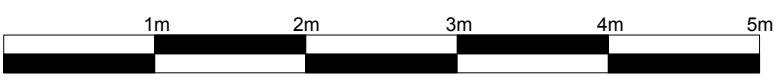

LEGEND - RADIATORS
 PROPOSED RADIATOR POSITION
 EXISTING RADIATOR POSITION

LEGEND
 Existing Walls
 Existing Non Historic Walls (Post 1973) to be demolished
 New walls
 Existing Originals Historic Wall (c 1835) to be demolished
 Existing Non Historic Walls (Post 1973)

CallenderHoworth		Morelands 5-23 Old Street London EC1V 9HL		T: 020 7336 8560 F: 020 7549 2152 W: www.callenderhoworth.com	
Job no.	1198	Job title	4 OVAL ROAD		
Drawing no.	132	Drawing title	PROPOSED FIRST FLOOR M&E PLANNING AMENDMENTS		
Scale	1:50	Size	A3	Drawn	ML
				Revision	B

All works to be in accordance with relevant standards, British building codes, and other relevant codes, and with manufacturer recommendations and instructions. All dimensions to be checked on site. Do not scale from this drawing.