

8 BISHAM GARDENS, N6

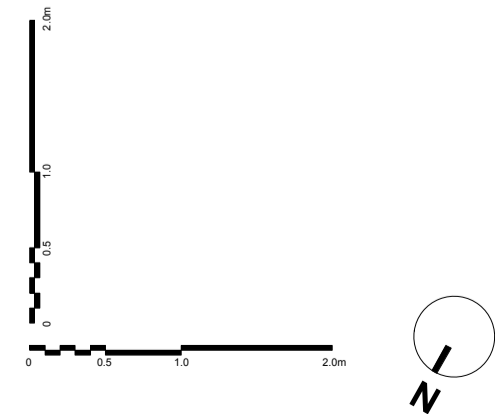
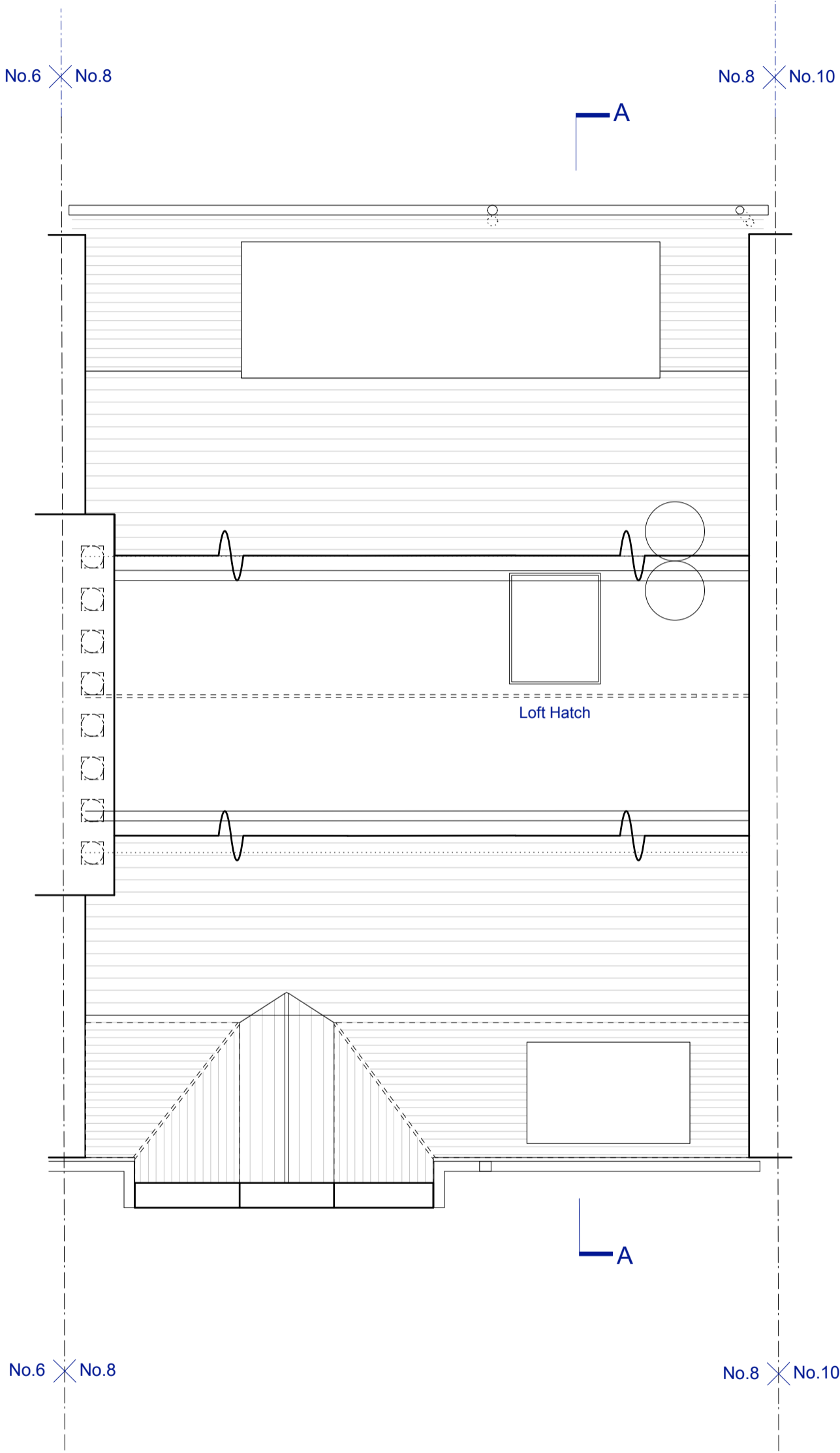

EXISTING GALLERY PLAN

DRAWING STATUS: ISSUED FOR PLANNING APPLICATION

JEFF KAHANE + ASSOCIATES
 A R C H I T E C T S

136 Royal College Street
 London NW1 7TA
 Telephone 020 7336 0990
 Facsimile 020 7336 6890
 VAT number 523 0556 66
 Jeff Kahane MA (Cantab), Dip. Arch, RIBA

client	DENIS HERBSTEIN + PATRICIA WALBY			
job	8 BISHAM GARDENS, N6			
drawing	EXISTING GALLERY PLAN			
date	drawn	scale	drawing no.	REV.
FEB 2017	MG	1:50@A3	723_EX_140	