

SYSTEM

WINDOWS MANUFACTURED FROM CLEMENT EB24 SUITE OF HOT ROLLED M.S. SECTIONS, GENERALLY IN ACCORDANCE WITH BS6510

LONG LEG

FINISH

HOT DIP GALVANISED TO BS EN ISO 1461.

POWDER COATED TO BS6497 / BS EN 13438

POLYESTER POWDER COATED RAL 9010 (WHITE) SEMI GLOSS

INFILL PANEL TO BE POWDERCOATED TO MATCH FRAME.

HARDWARE & ATTACHMENTS

ALL OPENING LIGHTS EDPM WEATHERSTRIPPED - EB24

SIDE HUNG CASEMENT

2No. FREE EXTENDED HINGES, POWDERCOATED TO MATCH FRAME

1No. 158SF-SC 'HAMPSTEAD' HANDLE, IN SATIN CHROME FINISH.

1No. B375/200-SC PEGSTAY, IN SATIN CHROME FINISH

1No. J BANKS NON-LOCKING RESTRICTOR TO BE FITTED, RESTRICTED TO 90mm OPENING.

PEGSTAY TO BE POSITIONED SO IT LOCATES ON FIRST HOLE AT 90mm OF OPENING.
- (W1) ONLY

TOP HUNG CASEMENT

2No. S05285F HINGES- POWDERCOATED TO MATCH FRAME

1No. B375/155-SC PEGSTAY, IN SATIN CHROME FINISH - LOCKING STAY

DOUBLE DOOR - OUTWARD OPENING

ACTIVE LEAF

3No. B12605F BUTT HINGES, POWDERCOATED TO MATCH FRAME

1No. MA 178 CONCEALED FRICTION ADJUSTER

FRICTION ADJUSTER SET TO OPEN TO A MAXIMUM OF 130° (APPROXIMATELY)

2No. No. 85 NON-LOCKING FACE BOLTS, SATIN CHROME FINISH. 1No. FITTED TO TOP AND 1No. FITTED TO BOTTOM .

BOLT TO TOP TO BE 150mm, BOLT TO BOTTOM TO BE 150mm LONG.

1No. FA3005-SC 'KENSINGTON' HANDLE IN SATIN CHROME FINISH

1No. SCHLOSSER 35/35 EUROPROFILE CYLINDER TO BE FITTED, IN CHROME FINISH - KEYED ALIKE

1No. 1433 WILKA LOCK, 45mm BACKSET.

SLAVE LEAF

3No. B12605F BUTT HINGES, POWDERCOATED TO MATCH FRAME

1No. MA 178 CONCEALED FRICTION ADJUSTER

FRICTION ADJUSTER SET TO OPEN TO A MAXIMUM OF 130° (APPROXIMATELY)

2No. No. 85 NON-LOCKING CONCEALED BOLTS, SATIN CHROME FINISH. 1No. FITTED TO TOP AND 1No. FITTED TO BOTTOM .

BOLT TO TOP TO BE 150mm, BOLT TO BOTTOM TO BE 150mm LONG.

GLAZING

PREPARED FOR & SUPPLIED WITH CLEMENT 24mm FLUSH EDGED SEALED UNITS; WITH PUSH-IN BEADS,

G+s 20 X 3 STEEL FLAT INSIDE (FLUSH JOINTS), WITH B12841 ALUMINIUM ATTACHED OUTSIDE

'T'-BARS TO BE PROVIDED WITH FLUSH JOINTS

GLAZING GLASKET - BLACK.

SPACER BAR - WHITE W.E.T.

SILICONE CAPPING - WHITE.

PERIMETER POINTING - WHITE.

OUTSIDE GLAZED

VENTS FACTORY GLAZED

GLASS SPECIFICATION:-

G1

OUTER - 4mm LOW IRON

CAVITY - 16mm ARGON

INNER - 4mm PLANITHERM TOTAL PLUS

G2

OUTER - 4mm TOUGHENED LOW IRON

CAVITY - 16mm ARGON

INNER - 4mm TOUGHENED PLANITHERM TOTAL PLUS

ALL SAFETY GLASS WILL CARRY THE OBLIGATORY MARKING, THIS IS REQUIRED TO BE NOTICEABLE

GENERAL

SUPPLY, FIX & GLAZE

WINDOW(S) AND DOOR(S) DIRECTLY FIXED TO OPENING.

TOTAL WINDOWS = 5

TOTAL DOORS = 1

BEDDED WITH UNIVERSAL BEDDING COMPOUND

FOR BEAD CLIP POSITIONS AND LENGTHS PLEASE REFER TO DRAWINGS BCP1 REV B (FOR OUTSIDE GLAZED) AND/OR

BCP2 REV B (FOR INSIDE GLAZED)

NOTE

ALL SPECIFICATION TO BE CONFIRMED BY CLIENT.

CASEMENTS

SIDE HUNG CASEMENTS = 8

TOP HUNG CASEMENTS = 3

FIXED LIGHTS = 4

DOOR LEAFS = 2

INSULATED PANELS = 2

FOLDER = 0

BOTTOM HUNG CASEMENTS = 0

VERTICAL PIVOTS = 0









HORIZONTAL PIVOTS = 0

DIRECT GLAZED UNITS = 0

Copyright Reserved 2013
CLEMENT WINDOWS LTD
This product is protected by the provisions of the Copyright, Design & Patents Act 1988
This drawing is the property of Clement Windows Ltd.
It is forbidden to copy, re-produce or use these details in any way (including transfer to another party) without the express authority/permission of Clement Windows Ltd in writing.

NOTES

1. DO NOT SCALE
2. PLEASE NOTE THAT ALL PRODUCT ARE SUBJECT TO MANUFACTURING TOLERANCE OF +0mm / -2mm
3. ALL DRAWINGS APPROVED FOR MANUFACTURE WILL INCUR COSTS IF CHANGED
4. PLEASE NOTE THAT FITTINGS WITH MOVING PARTS WHICH ARE SPECIFIED AS POWDERCOATED TO MATCH FRAME (IF APPLICABLE). CLEMENTS CANNOT GUARANTEE THE POWDERCOAT FINISH DUE TO THE METAL TO METALCONTACT OF MOVING PARTS.

Legend	
SH = Side Hung	DL = Door Leaf
TH = Top Hung	FL = Fixed Lights
BH = Bottom Hung	IP = Insulated Panels
VP = Vertical Pivot	HP = Horizontal Pivot
FD = Folder	
FFL = Finshed Floor Level	SSL = Structural Slab Level
EGL = External Ground Level	
UBC = Universal Bedding Compound	
 = Silicone	 = Masonry
 = Universal Bedding Compound	 = Obscure Glass
 = Kicking / Infill Panel	 = Weld
 = Glazing Tape	 = Internal Finishes

DATE	REV	INT	COMMENTS
------	-----	-----	----------

REVISIONS

CLEMENT
creating light...beautifully

For Information

Drawing Title
SPECIFICATION SHEET

Project/Site

Contractor/Client

Architect
-

Scale @ A1: 1:1 **Drawn By:**

Date: **Checked by:**

Clement House
Haslemere
Surrey, GU27 1HR
Tel: 01428 643393
Fax: 01428 644436
E-mail: JTurnerSmith@clementwg.co.uk

Drawing No. **Revision**

ELEVATIONS VIEWED FROM OUTSIDE

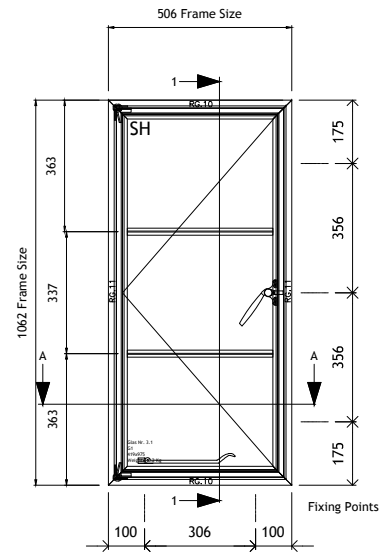

1No. Required
W1 Master Bedroom

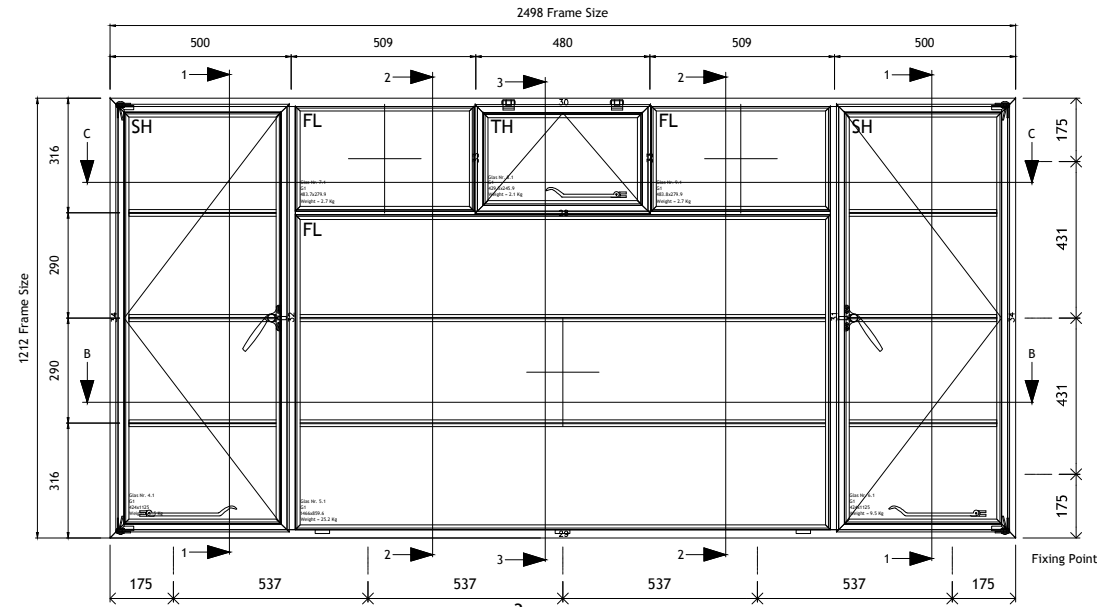

3No. Required
W2 Playroom
W4 Living Room
W5 - Kitchen

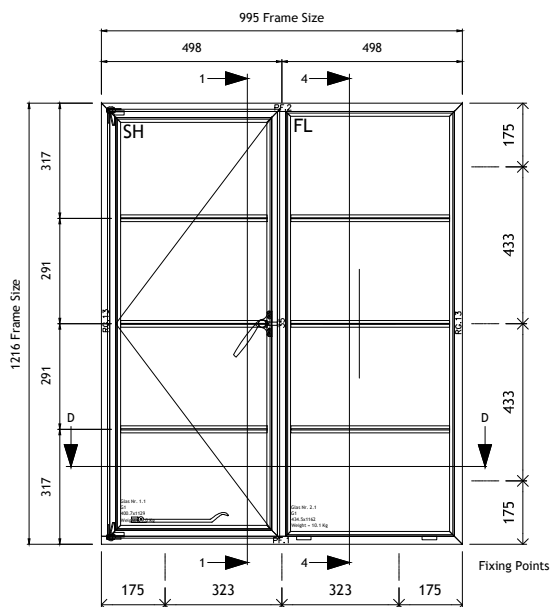

1No. Required
W3 Kitchen

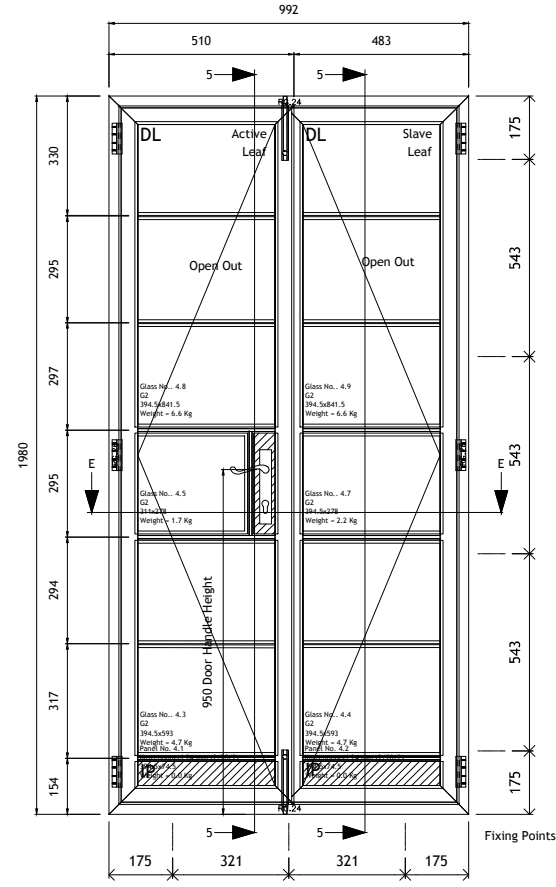

1No. Required
D1 - Stairs

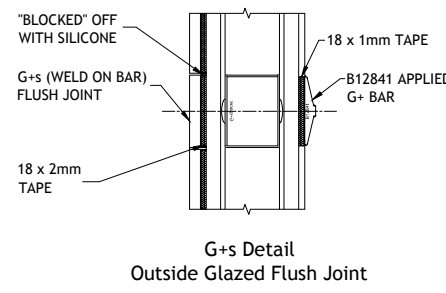

G+s Detail
Outside Glazed Flush Joint

Copyright Reserved 2013
CLEMENT WINDOWS LTD
This product is protected by the provisions of the Copyright, Design & Patents Act 1988
It is forbidden to copy, re-produce or use these details in any way (including transfer to another party) without the express authority/permission of Clement Windows Ltd in writing.

- NOTES:
- DO NOT SCALE
 - PLEASE NOTE THAT ALL PRODUCT ARE SUBJECT TO MANUFACTURING TOLERANCE OF +0mm / -2mm
 - ALL DRAWINGS APPROVED FOR MANUFACTURE WILL INCUR COSTS IF CHANGED
 - PLEASE NOTE THAT FITTINGS WITH MOVING PARTS WHICH ARE SPECIFIED AS POWDERCOATED TO MATCH FRAME (IF APPLICABLE). CLEMENTS CANNOT GUARANTEE THE POWDERCOAT FINISH DUE TO THE METAL TO METAL CONTACT OF MOVING PARTS.

Legend

SH = Side Hung	DL = Door Leaf
TH = Top Hung	FL = Fixed Lights
BH = Bottom Hung	IP = Insulated Panels
VP = Vertical Pivot	HP = Horizontal Pivot
FD = Folder	

FFL = Finished Floor Level	SSL = Structural Slab Level
EGL = External Ground Level	
UBC = Universal Bedding Compound	

	= Silicone		= Masonry
	= Universal Bedding Compound		= Obscure Glass
	= Kicking / Infill Panel		= Weld
	= Glazing Tape		= Internal Finishes

DATE	REV	INT	COMMENTS
------	-----	-----	----------

REVISIONS

CLEMENT
creating light...beautifully

For Information

Drawing Title
ELEVATION DRAWING

Project/Site

Contractor/Client

Architect

Scale @ A1: 1:10

Drawn By:

Date:

Checked by:

Clement House
Haslemere
Surrey, GU27 1HR
Tel: 01428 643393
Fax: 01428 644436
E-mail: chris.harrod@clementwg.co.uk

Drawing No.

Revision

Copyright Reserved 2013
 CLEMENT WINDOWS LTD
 This product is protected by the provisions of the Copyright, Design & Patents Act 1988
 It is forbidden to copy, re-produce or use these details in any way (including transfer to another party) without the express authority/permission of Clement Windows Ltd in writing.

- NOTES:**
- DO NOT SCALE
 - PLEASE NOTE THAT ALL PRODUCT ARE SUBJECT TO MANUFACTURING TOLERANCE OF +0mm / -2mm
 - ALL DRAWINGS APPROVED FOR MANUFACTURE WILL INCUR COSTS IF CHANGED
 - PLEASE NOTE THAT FITTINGS WITH MOVING PARTS WHICH ARE SPECIFIED AS POWDERCOATED TO MATCH FRAME (IF APPLICABLE). CLEMENTS CANNOT GUARANTEE THE POWDERCOAT FINISH DUE TO THE METAL TO METAL CONTACT OF MOVING PARTS.

Legend

SH = Side Hung	DL = Door Leaf
TH = Top Hung	FL = Fixed Lights
BH = Bottom Hung	IP = Insulated Panels
VP = Vertical Pivot	HP = Horizontal Pivot
FD = Folder	

FFL = Finished Floor Level SSL = Structural Slab Level
 EGL = External Ground Level
 UBC = Universal Bedding Compound

= Silicone	= Masonry
= Universal Bedding Compound	= Obscure Glass
= Kicking / Infill Panel	= Weld
= Glazing Tape	= Internal Finishes

INTERNAL

Section 1 - 1

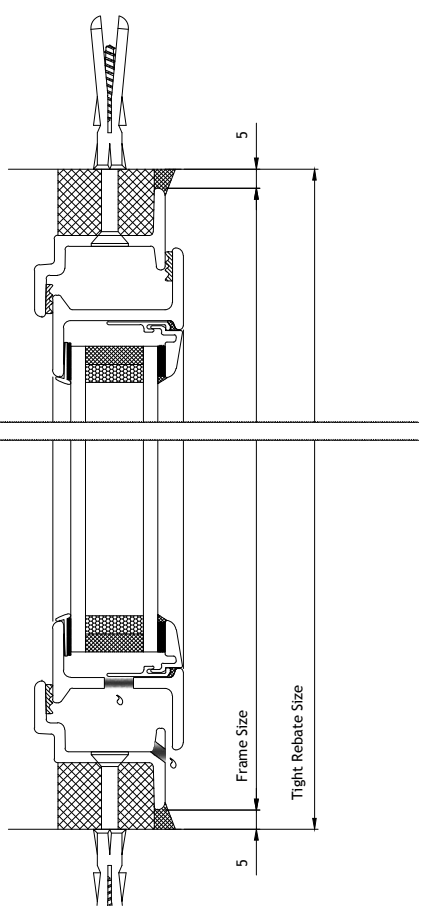

EXTERNAL

INTERNAL

Section 2 - 2

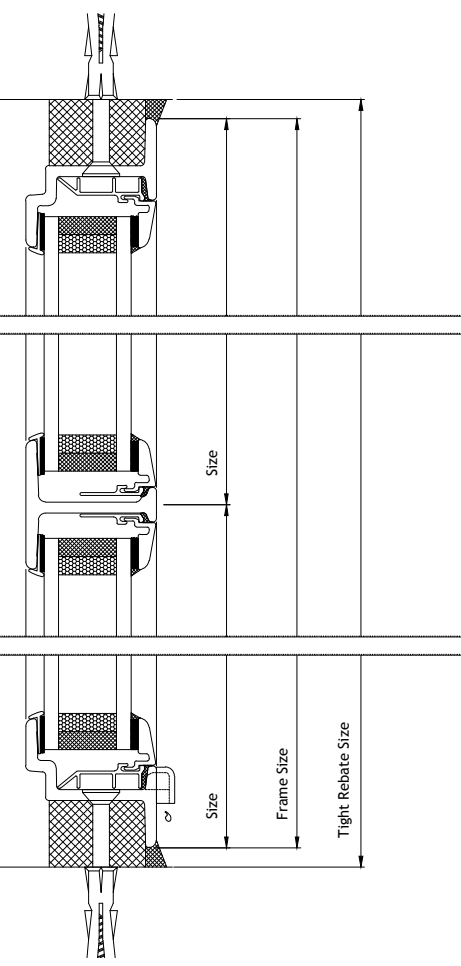

EXTERNAL

INTERNAL

Section 3 - 3

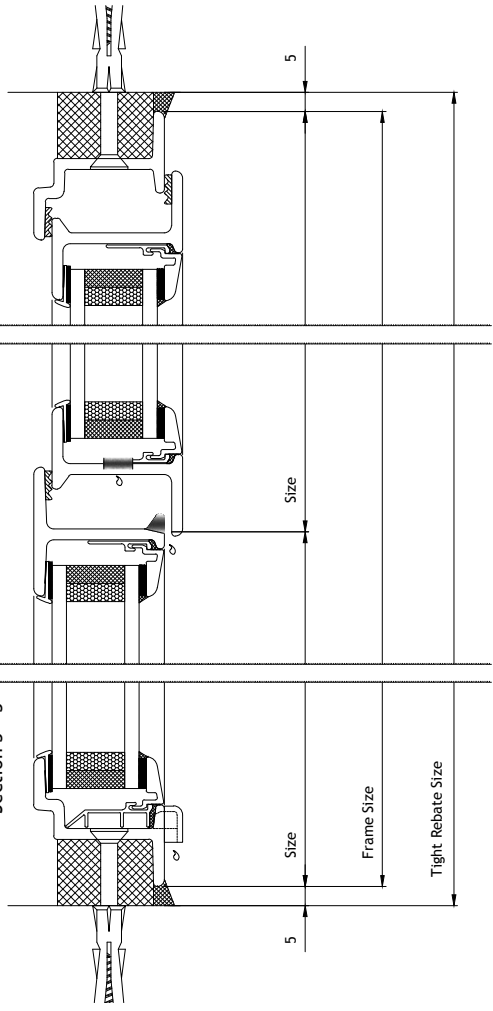

EXTERNAL

INTERNAL

Section 4 - 4

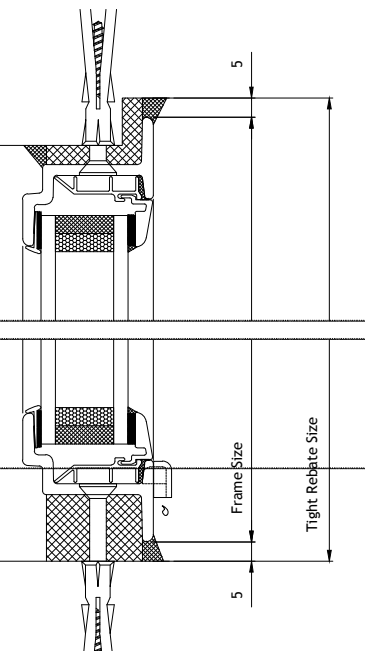

EXTERNAL

DATE	REV	INT	COMMENTS
------	-----	-----	----------

REVISIONS

CLEMENT
creating light...beautifully

For Information

Drawing Title
 SECTION DETAILS

Project/Site

Contractor/Client

Architect

Scale @ A1: 1:1 **Drawn By:**

Date: **Checked by:**

Clement House
 Haslemere
 Surrey, GU27 1HR
 Tel: 01428 643393
 Fax: 01428 644436
 E-mail: chris.harrod@clementwg.co.uk

Drawing No. **Revision**

Copyright Reserved 2013
 CLEMENT WINDOWS LTD
 This product is protected by the provisions of the Copyright, Design & Patents Act 1988
 This drawing is the property of Clement Windows Ltd.
 It is forbidden to copy, re-produce or use these details in any way (including transfer to another party) without the express authority/permission of Clement Windows Ltd in writing.

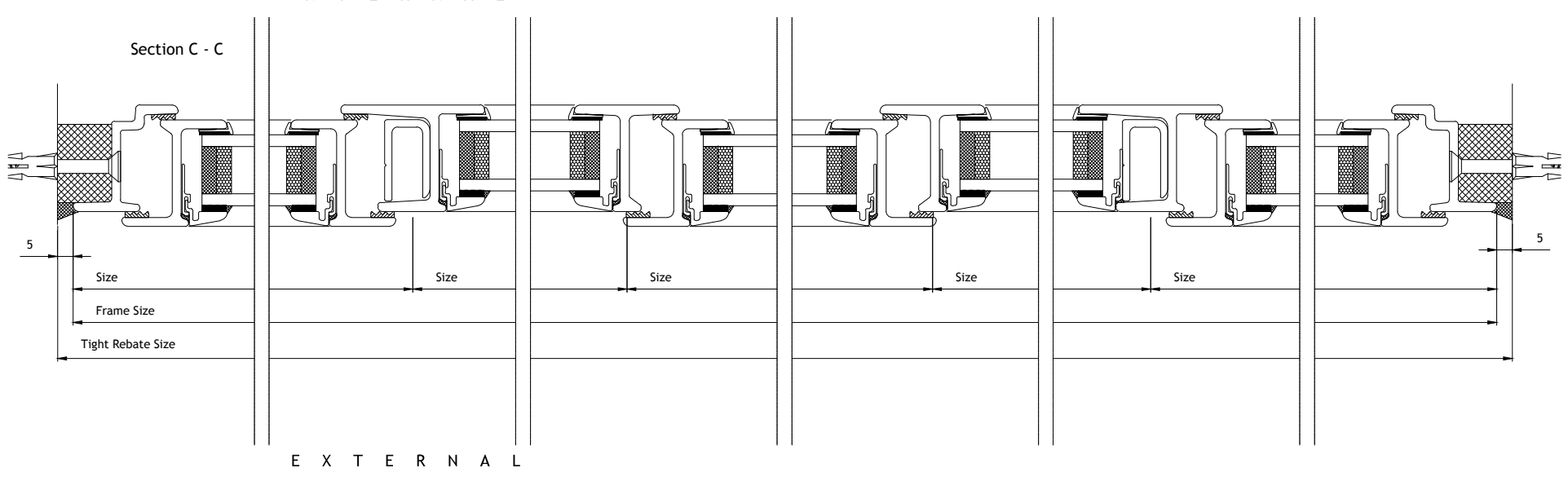
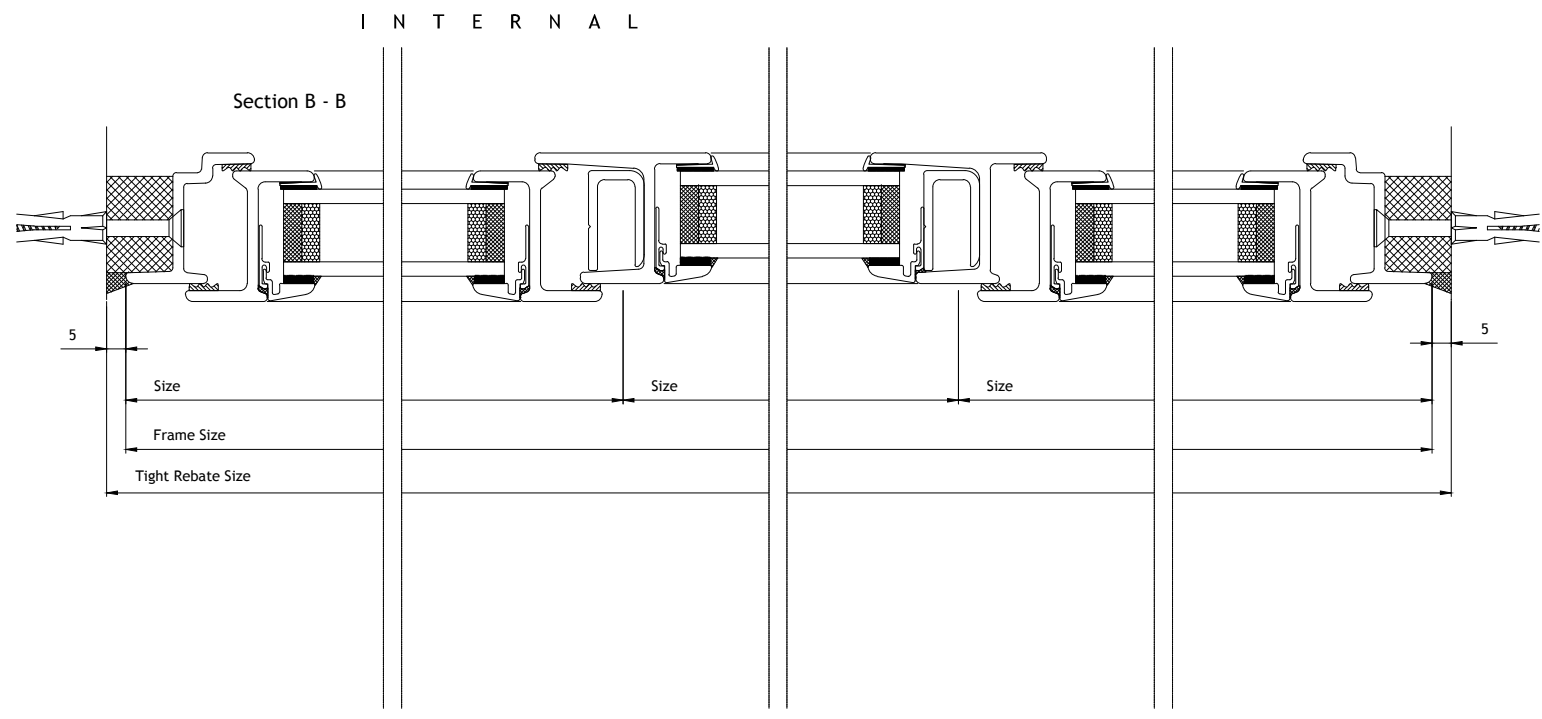
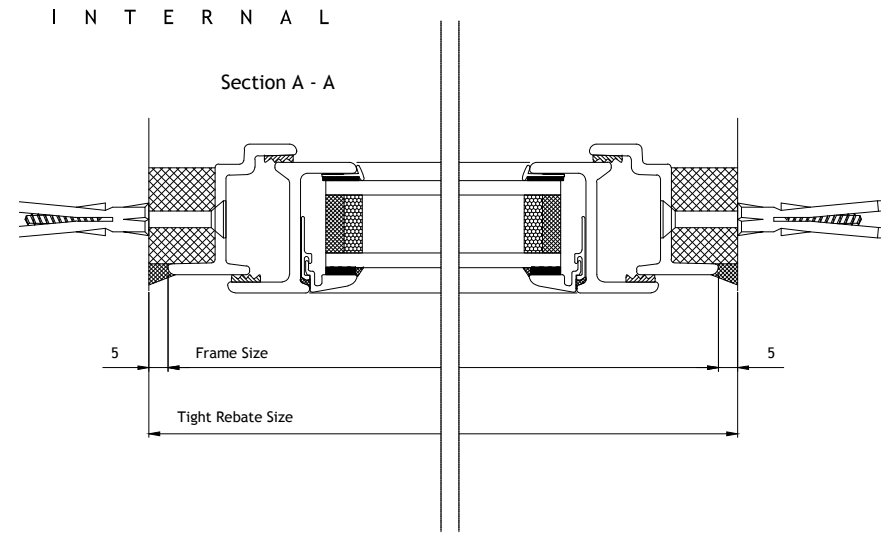

- NOTES
- DO NOT SCALE
 - PLEASE NOTE THAT ALL PRODUCT ARE SUBJECT TO MANUFACTURING TOLERANCE OF +0mm / -2mm
 - ALL DRAWINGS APPROVED FOR MANUFACTURE WILL INCUR COSTS IF CHANGED
 - PLEASE NOTE THAT FITTINGS WITH MOVING PARTS WHICH ARE SPECIFIED AS POWDERCOATED TO MATCH FRAME (IF APPLICABLE). CLEMENTS CANNOT GUARANTEE THE POWDERCOAT FINISH DUE TO THE METAL TO METAL CONTACT OF MOVING PARTS.

Legend

SH = Side Hung	DL = Door Leaf
TH = Top Hung	FL = Fixed Lights
BH = Bottom Hung	IP = Insulated Panels
VP = Vertical Pivot	HP = Horizontal Pivot
FD = Folder	
FFL = Finished Floor Level	SSL = Structural Slab Level
EGL = External Ground Level	
UBC = Universal Bedding Compound	

= Silicone	= Masonry
= Universal Bedding Compound	= Obscure Glass
= Kicking / Infill Panel	= Weld
= Glazing Tape	= Internal Finishes

DATE	REV	INT	COMMENTS
REVISIONS			

CLEMENT
creating light...beautifully

For Information

Drawing Title
 SECTION DETAILS

Project/Site

Contractor/Client

Architect

Scale @ A1: 1:1
 Date: Drawn By:

Checked by:

Clement House
 Haslemere
 Surrey, GU27 1HR
 Tel: 01428 643393
 Fax: 01428 644436
 E-mail: chris.harrod@clementwg.co.uk

Drawing No.	Revision
-------------	----------

Copyright Reserved 2013
 CLEMENT WINDOWS LTD
 This product is protected by the provisions of the Copyright, Design & Patents Act 1988
 This drawing is the property of Clement Windows Ltd.
 It is forbidden to copy, re-produce or use these details in any way (including transfer to another party) without the express authority/permission of Clement Windows Ltd in writing.

- NOTES**
- DO NOT SCALE
 - PLEASE NOTE THAT ALL PRODUCT ARE SUBJECT TO MANUFACTURING TOLERANCE OF +0mm / -2mm
 - ALL DRAWINGS APPROVED FOR MANUFACTURE WILL INCUR COSTS IF CHANGED
 - PLEASE NOTE THAT FITTINGS WITH MOVING PARTS WHICH ARE SPECIFIED AS POWDERCOATED TO MATCH FRAME (IF APPLICABLE). CLEMENTS CANNOT GUARANTEE THE POWDERCOAT FINISH DUE TO THE METAL TO METAL CONTACT OF MOVING PARTS.

Legend

SH = Side Hung	DL = Door Leaf
TH = Top Hung	FL = Fixed Lights
BH = Bottom Hung	IP = Insulated Panels
VP = Vertical Pivot	HP = Horizontal Pivot
FD = Folder	
FFL = Finished Floor Level	SSL = Structural Slab Level
EGL = External Ground Level	
UBC = Universal Bedding Compound	

= Silicone	= Masonry
= Universal Bedding Compound	= Obscure Glass
= Kicking / Infill Panel	= Weld
= Glazing Tape	= Internal Finishes

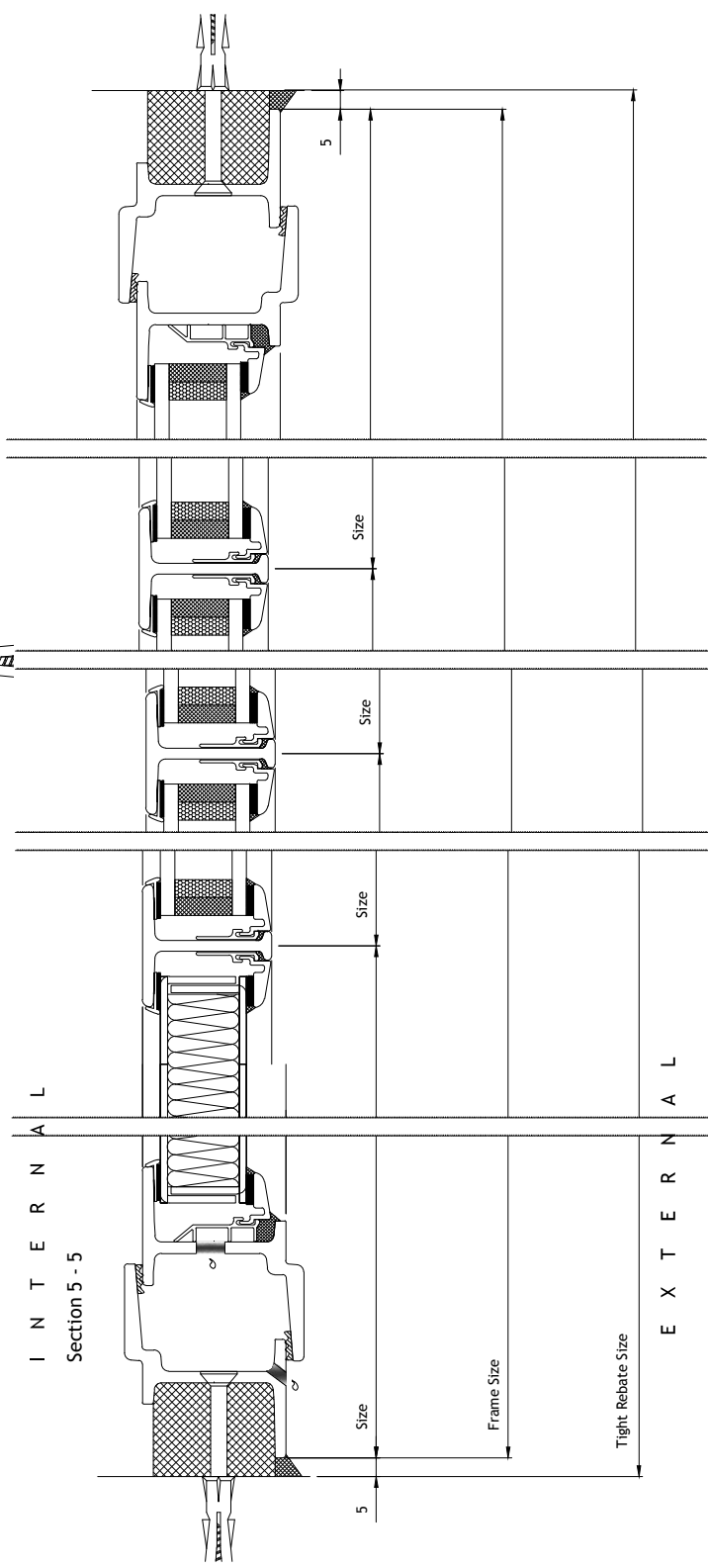
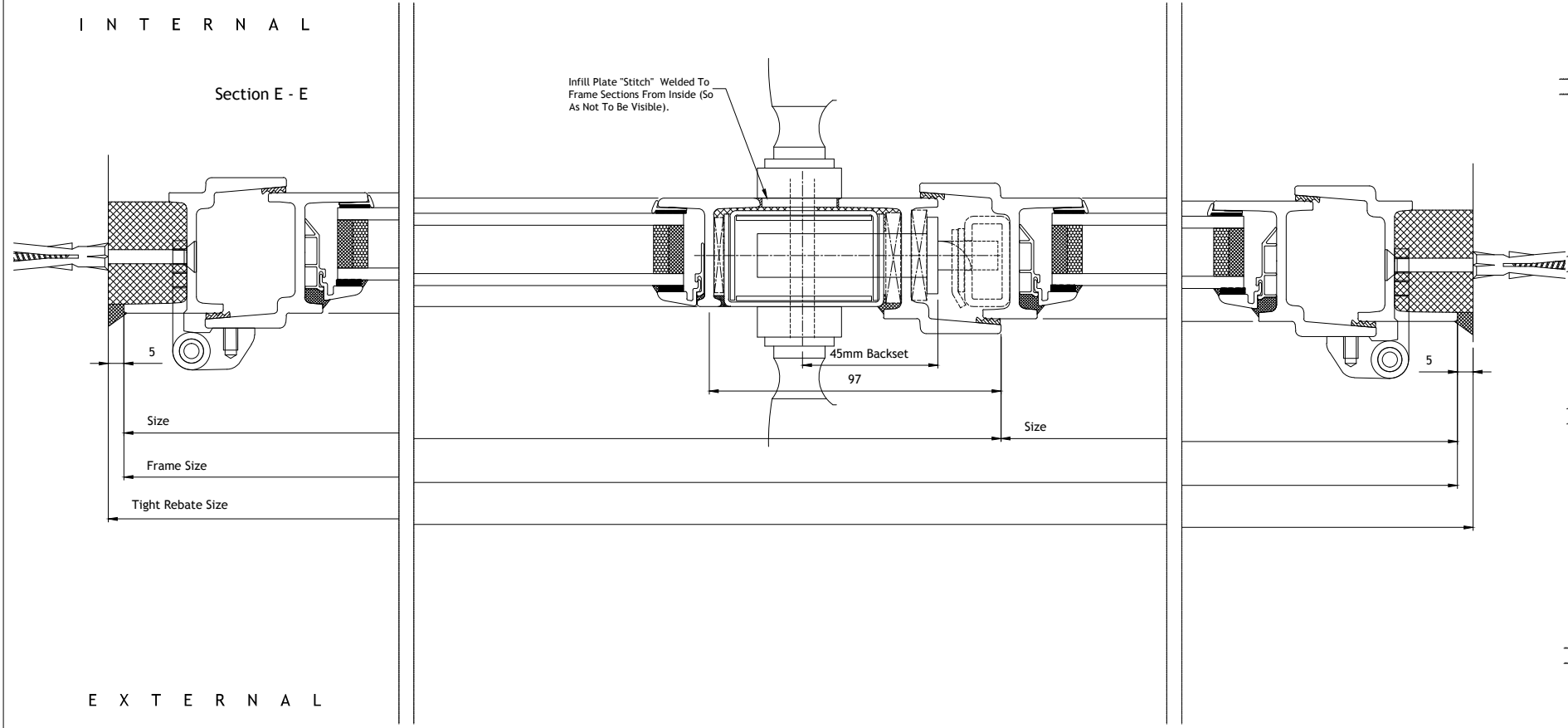
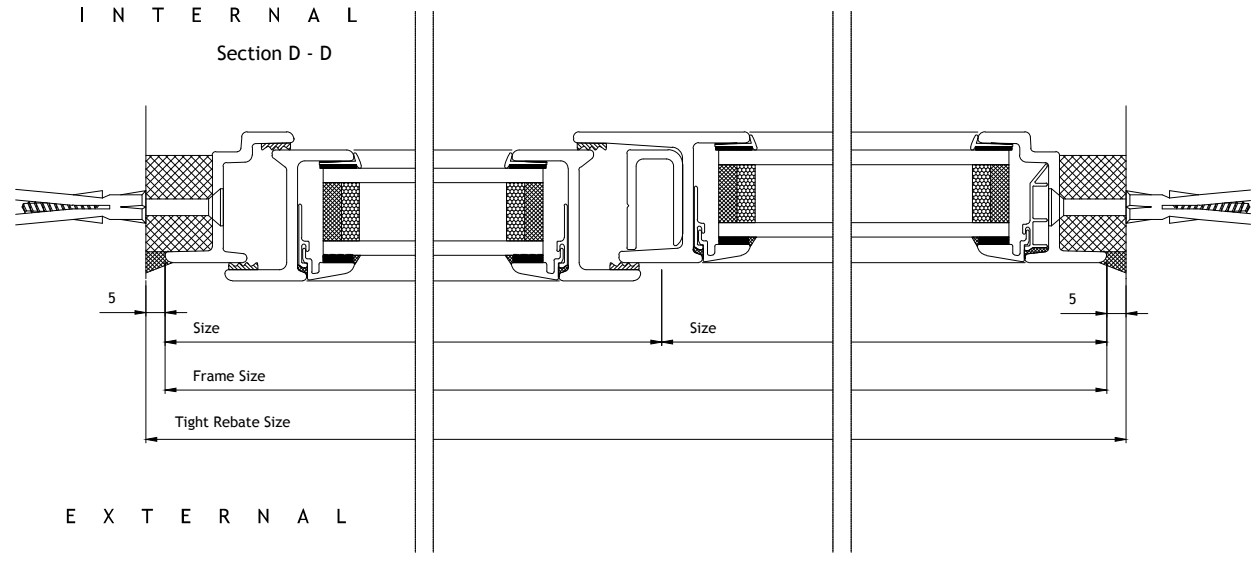

DATE	REV	INT	COMMENTS
REVISIONS			

CLEMENT
creating light...beautifully

For Information

Drawing Title SECTION DETAILS	
Project/Site -	
Contractor/Client -	
Architect -	
Scale @ A1: 1:1	Drawn By:
Date:	Checked by:
Clement House Haslemere Surrey, GU27 1HR Tel: 01428 643393 Fax: 01428 644436 E-mail: chris.harrod@clementwg.co.uk	

Drawing No.	Revision
--------------------	-----------------

SYSTEM

WINDOWS MANUFACTURED FROM CLEMENT EB24 SUITE OF HOT ROLLED M.S. SECTIONS, GENERALLY IN ACCORDANCE WITH BS6510
LONG AND EQUAL LEG

FINISH

HOT DIP GALVANISED TO BS EN ISO 1461.
POWDER COATED TO BS6497 / BS EN 13438
POLYESTER POWDER COATED RAL 7021 (BLACK GREY) MATT
INFILL PANEL TO BE POWDERCOATED TO MATCH FRAME.

HARDWARE & ATTACHMENTS

ALL OPENING LIGHTS EDPM WEATHERSTRIPPED - EB24

ACTIVE LEAF

3No. B1260SF BUTT HINGES, POWDERCOATED TO MATCH FRAME

2No. No. 85 NON-LOCKING FACE BOLTS, POWDERCOATED TO MATCH FRAME. 1No. FITTED TO TOP AND 1No. FITTED TO BOTTOM. BOLT TO TOP TO BE 300mm, BOLT TO BOTTOM TO BE 150mm LONG. PLEASE NOTE THAT CLEMENTS CANNOT GUARANTEE THE POWDERCOAT FINISH DUE TO THE METAL TO METAL CONTACT OF MOVING PARTS.

1No. FA3005 'KENSINGTON' HANDLE - POWDERCOATED TO MATCH FRAME

PLEASE NOTE THAT CLEMENTS CANNOT GUARANTEE THE POWDERCOAT FINISH DUE TO THE METAL TO METAL CONTACT OF MOVING PARTS.

1No. SCHLOSSER 35/35 EUROPROFILE CYLINDER TO BE FITTED, IN CHROME FINISH - KEYED ALIKE

1No. 1433 WILKA LOCK, 45mm BACKSET.

1No. SCREW-ON CABIN EYE, POWDER COATED TO MATCH FRAME TO BE SUPPLIED LOOSE FOR FIXING ON SITE.

1No. 200mm CABIN HOOK, POWDERCOATED TO MATCH FRAME. PLEASE NOTE THAT CLEMENTS CANNOT GUARANTEE THE POWDERCOAT FINISH DUE TO THE METAL TO METAL CONTACT OF MOVING PARTS.

1No. BROOK VENT (4000sq/mm), TO BE POWDERCOATED TO MATCH FRAME.

SLAVE LEAF

3No. B1260SF BUTT HINGES, POWDERCOATED TO MATCH FRAME

2No. No. 85 NON-LOCKING CONCEALED BOLTS, POWDERCOATED TO MATCH FRAME. 1No. FITTED TO TOP AND 1No. FITTED TO BOTTOM. BOLT TO TOP TO BE 300mm, BOLT TO BOTTOM TO BE 150mm LONG. PLEASE NOTE THAT CLEMENTS CANNOT GUARANTEE THE POWDERCOAT FINISH DUE TO THE METAL TO METAL CONTACT OF MOVING PARTS.

1No. SCREW-ON CABIN EYE, POWDER COATED TO MATCH FRAME TO BE SUPPLIED LOOSE FOR FIXING ON SITE.

1No. 200mm CABIN HOOK, POWDERCOATED TO MATCH FRAME. PLEASE NOTE THAT CLEMENTS CANNOT GUARANTEE THE POWDERCOAT FINISH DUE TO THE METAL TO METAL CONTACT OF MOVING PARTS.

1No. BROOK VENT (4000sq/mm), TO BE POWDERCOATED TO MATCH FRAME.

1No. - DUMMY HANDLE (FIXED SPINDLE)

GLAZING

PREPARED FOR & SUPPLIED WITH CLEMENT 24mm FLUSH EDGED SEALED UNITS; WITH PUSH-IN BEADS,

'T'-BARS TO BE PROVIDED WITH FLUSH JOINTS

GLAZING GLASKET - BLACK.
SPACER BAR - BLACK W.E.T.
SILICONE CAPPING - BLACK.
PERIMETER POINTING - BLACK.

OUTSIDE GLAZED
VENTS FACTORY GLAZED

GLASS SPECIFICATION:-

G2
OUTER - 4mm TOUGHENED LOW IRON
CAVITY - 16mm ARGON
INNER - 4mm TOUGHENED PLANITHERM TOTAL PLUS

ALL SAFETY GLASS WILL CARRY THE OBLIGATORY MARKING, THIS IS REQUIRED TO BE NOTICEABLE

GENERAL

SUPPLY, FIX & GLAZE

WINDOW(S) DIRECTLY FIXED TO OPENING.

TOTAL DOORS = 1
COUPLED AND BEDDED WITH UNIVERSAL BEDDING COMPOUND

FOR BEAD CLIP POSITIONS AND LENGTHS PLEASE REFER TO DRAWINGS BCP1 REV B (FOR OUTSIDE GLAZED) AND/OR BCP2 REV B (FOR INSIDE GLAZED)

NOTE

ALL SPECIFICATION TO BE CONFIRMED BY CLIENT.









CASEMENTS

SIDE HUNG CASEMENTS = 0
TOP HUNG CASEMENTS = 0
FIXED LIGHTS = 2
DOOR LEAFS = 2
INSULATED PANELS = 0
FOLDER = 0
BOTTOM HUNG CASEMENTS = 0
VERTICAL PIVOTS = 0
HORIZONTAL PIVOTS = 0
DIRECT GLAZED UNITS = 0

Copyright Reserved 2013
CLEMENT WINDOWS LTD
This product is protected by the provisions of the Copyright, Design & Patents Act 1988
This drawing is the property of Clement Windows Ltd.
It is forbidden to copy, re-produce or use these details in any way (including transfer to another party) without the express authority/permission of Clement Windows Ltd in writing.

NOTES.

- DO NOT SCALE
- PLEASE NOTE THAT ALL PRODUCT ARE SUBJECT TO MANUFACTURING TOLERANCE OF +0mm / -2mm
- ALL DRAWINGS APPROVED FOR MANUFACTURE WILL INCUR COSTS IF CHANGED
- PLEASE NOTE THAT FITTINGS WITH MOVING PARTS WHICH ARE SPECIFIED AS POWDERCOATED TO MATCH FRAME (IF APPLICABLE). CLEMENTS CANNOT GUARANTEE THE POWDERCOAT FINISH DUE TO THE METAL TO METALCONTACT OF MOVING PARTS.

Legend	
SH = Side Hung	DL = Door Leaf
TH = Top Hung	FL = Fixed Lights
BH = Bottom Hung	IP = Insulated Panels
VP = Vertical Pivot	HP = Horizontal Pivot
FD = Folder	
FFL = Finished Floor Level	SSL = Structural Slab Level
EGL = External Ground Level	
UBC = Universal Bedding Compound	
 = Silicone	 = Masonry
 = Universal Bedding Compound	 = Obscure Glass
 = Kicking / Infill Panel	 = Weld
 = Glazing Tape	 = Internal Finishes

DATE	REV	INT	COMMENTS
------	-----	-----	----------

REVISIONS

CLEMENT
creating light...beautifully

For Information

Drawing Title
SECTION DETAILS

Project/Site

Contractor/Client

Architect

Scale @ A1:

Drawn By:

Date:

Checked by:

Clement House
Haslemere
Surrey, GU27 1HR
Tel: 01428 643393
Fax: 01428 644436
E-mail: JTurnerSmith@clementwg.co.uk

Drawing No.

Revision

ELEVATIONS VIEWED FROM OUTSIDE

Copyright Reserved 2013
 CLEMENT WINDOWS LTD
 This product is protected by the provisions of the Copyright, Design & Patents Act 1988
 It is forbidden to copy, re-produce or use these details in any way (including transfer to another party) without the express authority/permission of Clement Windows Ltd in writing.

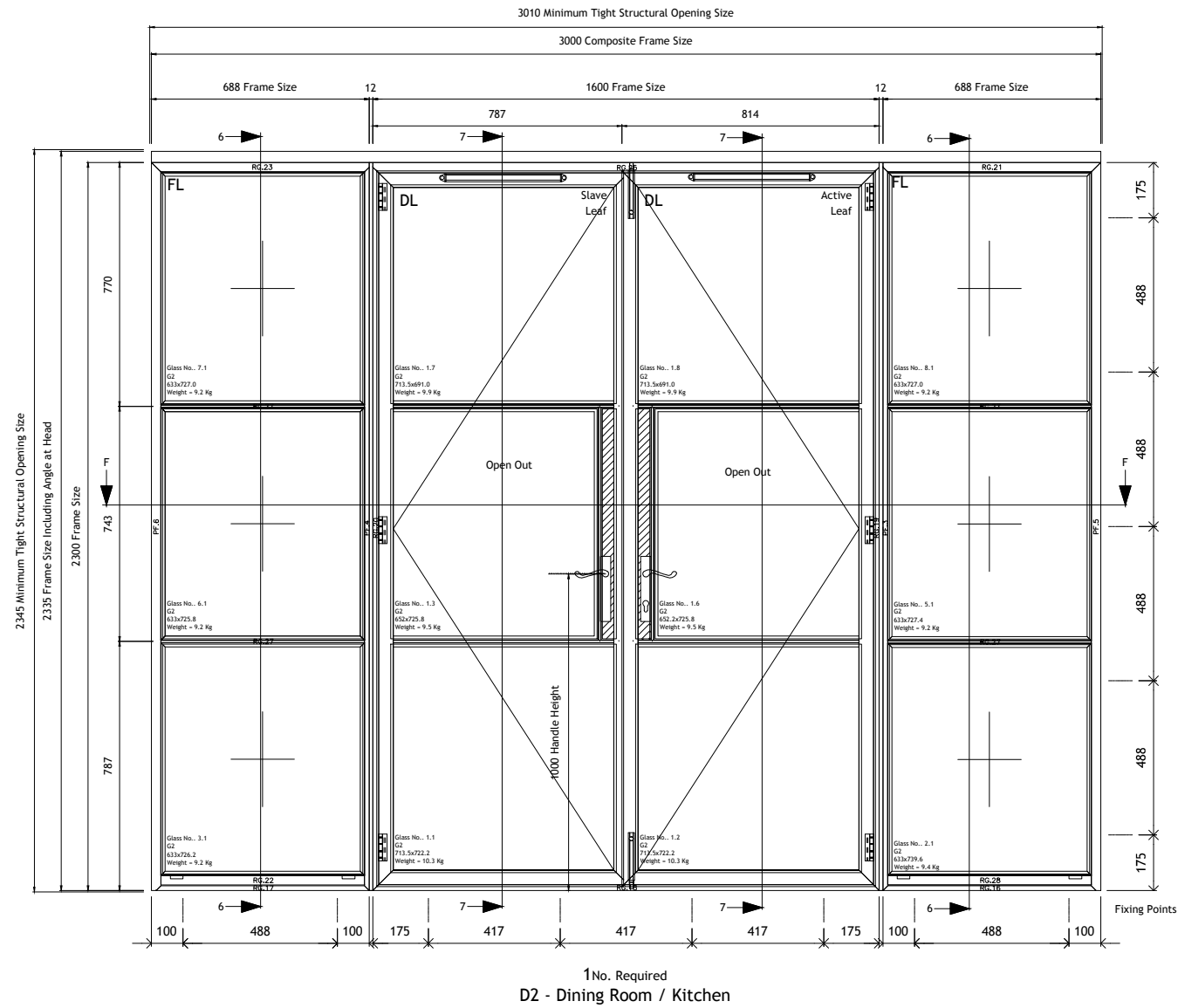

- NOTES:
- DO NOT SCALE
 - PLEASE NOTE THAT ALL PRODUCT ARE SUBJECT TO MANUFACTURING TOLERANCE OF +0mm / -2mm
 - ALL DRAWINGS APPROVED FOR MANUFACTURE WILL INCUR COSTS IF CHANGED
 - PLEASE NOTE THAT FITTINGS WITH MOVING PARTS WHICH ARE SPECIFIED AS POWDERCOATED TO MATCH FRAME (IF APPLICABLE). CLEMENTS CANNOT GUARANTEE THE POWDERCOAT FINISH DUE TO THE METAL TO METAL CONTACT OF MOVING PARTS.

Legend

SH = Side Hung	DL = Door Leaf
TH = Top Hung	FL = Fixed Lights
BH = Bottom Hung	IP = Insulated Panels
VP = Vertical Pivot	HP = Horizontal Pivot
FD = Folder	

FFL = Finished Floor Level SSL = Structural Slab Level
 EGL = External Ground Level
 UBC = Universal Bedding Compound

= Silicone	= Masonry
= Universal Bedding Compound	= Obscure Glass
= Kicking / Infill Panel	= Weld
= Glazing Tape	= Internal Finishes

DATE	REV	INT	COMMENTS
------	-----	-----	----------

REVISIONS

CLEMENT
creating light...beautifully

For Information

Drawing Title
 ELEVATION DRAWING

Project/Site

Contractor/Client

Architect

Scale @ A1: 1:10 Drawn By:

Date: Checked by:

Clement House
 Haslemere
 Surrey, GU27 1HR
 Tel: 01428 643393
 Fax: 01428 644436
 E-mail: chris.harrod@clementwg.co.uk

Drawing No. Revision

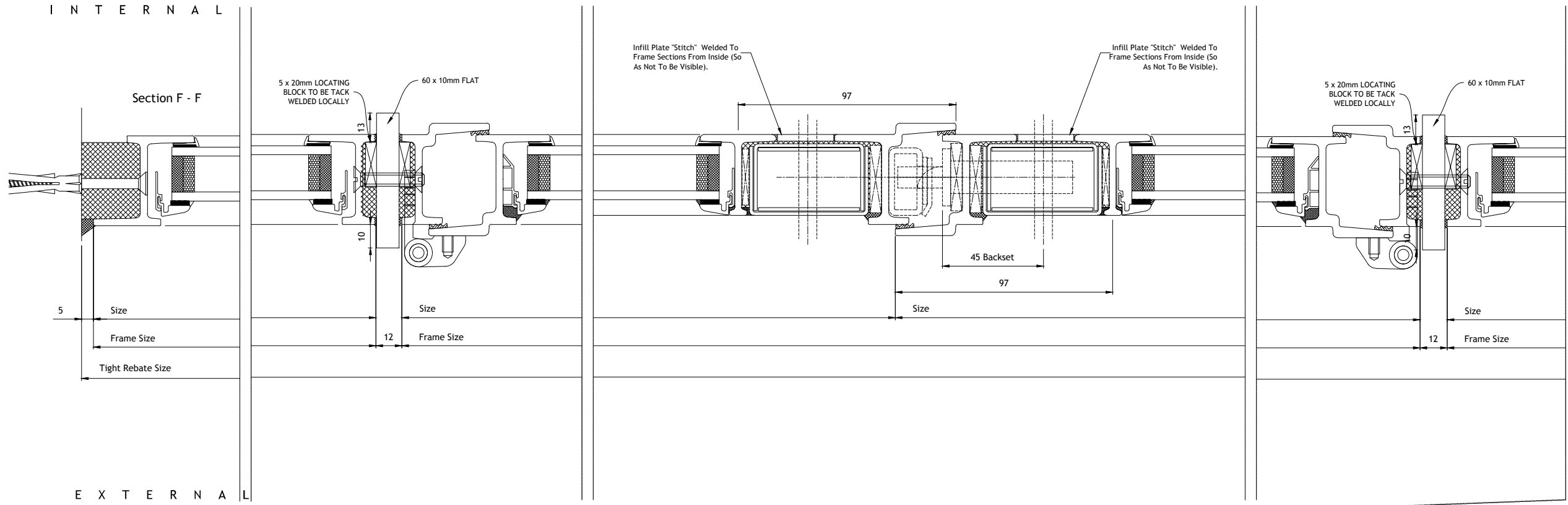

Copyright Reserved 2013
 CLEMENT WINDOWS LTD
 This product is protected by the provisions of the Copyright, Design & Patents Act 1988
 It is forbidden to copy, re-produce or use these details in any way (including transfer to another party) without the express authority/permission of Clement Windows Ltd in writing.

- NOTES:**
- DO NOT SCALE
 - PLEASE NOTE THAT ALL PRODUCT ARE SUBJECT TO MANUFACTURING TOLERANCE OF +0mm / -2mm
 - ALL DRAWINGS APPROVED FOR MANUFACTURE WILL INCUR COSTS IF CHANGED
 - PLEASE NOTE THAT FITTINGS WITH MOVING PARTS WHICH ARE SPECIFIED AS POWDERCOATED TO MATCH FRAME (IF APPLICABLE). CLEMENTS CANNOT GUARANTEE THE POWDERCOAT FINISH DUE TO THE METAL TO METAL CONTACT OF MOVING PARTS.

Legend

SH = Side Hung	DL = Door Leaf
TH = Top Hung	FL = Fixed Lights
BH = Bottom Hung	IP = Insulated Panels
VP = Vertical Pivot	HP = Horizontal Pivot
FD = Folder	

FFL = Finished Floor Level	SSL = Structural Slab Level
EGL = External Ground Level	
UBC = Universal Bedding Compound	

= Silicone	= Masonry
= Universal Bedding Compound	= Obscure Glass
= Kicking / Infill Panel	= Weld
= Glazing Tape	= Internal Finishes

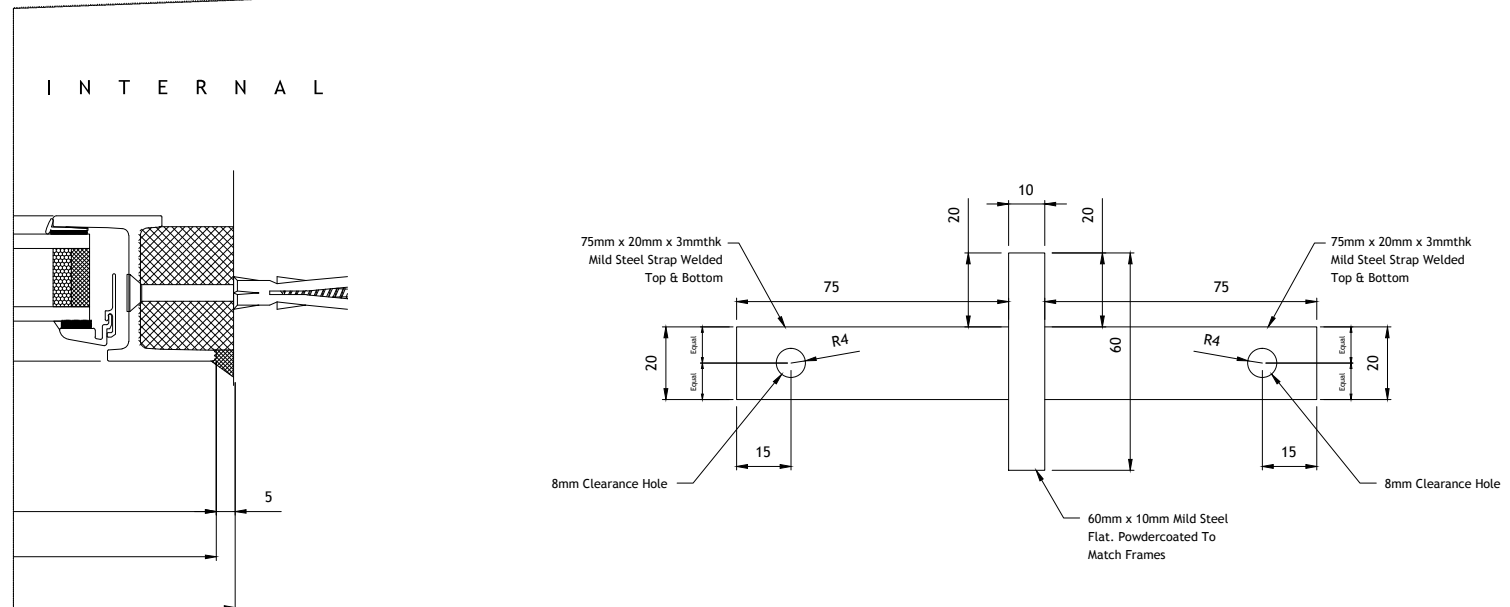

Fixing strap at top and bottom of mullions.

DATE	REV	INT	COMMENTS
------	-----	-----	----------

REVISIONS



For Information

Drawing Title
SECTION DETAILS

Project/Site

Contractor/Client

Architect

Scale @ A1: 1:1 **Drawn By:**

Date: **Checked by:**

Clement House
 Haslemere
 Surrey, GU27 1HR
 Tel: 01428 643393
 Fax: 01428 644436
 E-mail: chris.harrod@clementwg.co.uk

Drawing No. **Revision**

Copyright Reserved 2013
 CLEMENT WINDOWS LTD
 This product is protected by the provisions of the Copyright, Design & Patents Act 1988
 This drawing is the property of Clement Windows Ltd.
 It is forbidden to copy, re-produce or use these details in any way (including transfer to another party) without the express authority/permission of Clement Windows Ltd in writing.

- NOTES**
- DO NOT SCALE
 - PLEASE NOTE THAT ALL PRODUCT ARE SUBJECT TO MANUFACTURING TOLERANCE OF +0mm / -2mm
 - ALL DRAWINGS APPROVED FOR MANUFACTURE WILL INCUR COSTS IF CHANGED
 - PLEASE NOTE THAT FITTINGS WITH MOVING PARTS WHICH ARE SPECIFIED AS POWDERCOATED TO MATCH FRAME (IF APPLICABLE). CLEMENTS CANNOT GUARANTEE THE POWDERCOAT FINISH DUE TO THE METAL TO METAL CONTACT OF MOVING PARTS.

Legend

SH = Side Hung	DL = Door Leaf
TH = Top Hung	FL = Fixed Lights
BH = Bottom Hung	IP = Insulated Panels
VP = Vertical Pivot	HP = Horizontal Pivot
FD = Folder	

FFL = Finished Floor Level	SSL = Structural Slab Level
EGL = External Ground Level	
UBC = Universal Bedding Compound	

= Silicone	= Masonry
= Universal Bedding Compound	= Obscure Glass
= Kicking / Infill Panel	= Weld
= Glazing Tape	= Internal Finishes

DATE	REV	INT	COMMENTS
------	-----	-----	----------

REVISIONS



For Manufacture

Drawing Title
SECTION DETAILS

Project/Site

Contractor/Client

Architect

Scale @ A1: 1:1 **Drawn By:**

Date: **Checked by:**

Clement House
 Haslemere
 Surrey, GU27 1HR
 Tel: 01428 643393
 Fax: 01428 644436
 E-mail: chris.harrod@clementwg.co.uk

Drawing No. **Revision**

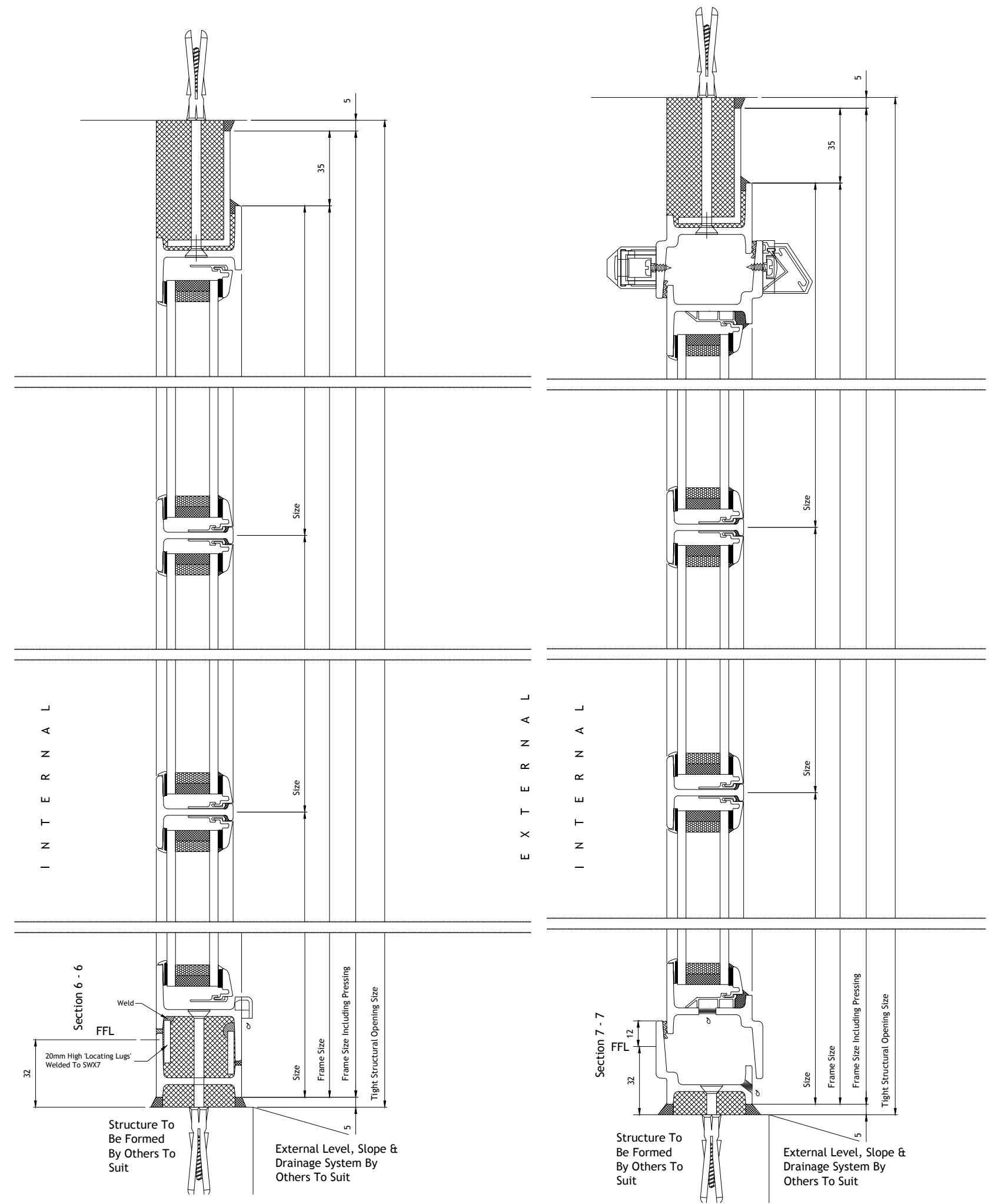

I N T E R N A L

E X T E R N A L

I N T E R N A L

E X T E R N A L

PRESSING SPECIFICATION

TO BE FABRICATED FROM 3mmthk ALUMINIUM, POWDERCATED TO MATCH FRAMES

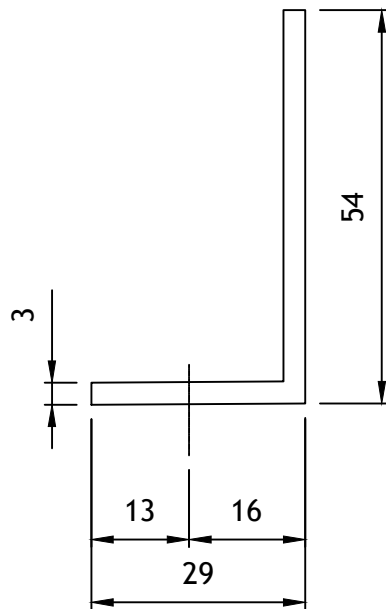

1 No. Required @ 3000mm
D2 Angle Pressing

	Copyright Reserved 2013, CLEMENT WINDOWS LTD This product is protected by the provisions of the Copyright, Design & Patents Act 1988		DRAWING TITLE: Pressing Detail	DRAWING No.
	EMAIL: info@clementwg.co.uk WEBSITE: www.clementwindows.co.uk DETAILS SUBJECT TO CHANGE WITHOUT NOTICE	DATE:	CLIENT:	REVISION: -