

For General Notes Refer to Drawing No.2

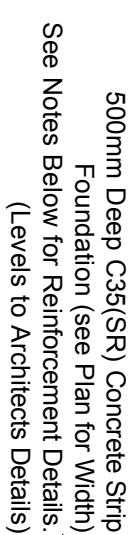

- ## NEW FLOOR NOTES
- Concrete Slab Floor to be 250mm Deep C-35(SF) Ground Bearing
  - New Basement Slab at Both High & Low Levels
  - Split High & Low floor Levels (Top of SSL & FFL to Architects Details)
  - Reinforcement : A-252 Mesh Top (25mm Cover), A333 Mesh Bottom (33mm Cover)
  - 40d Lap Between Foundation Base Starter Bars & Slab Reinforcement, Water Bar (or Smaller) Water Proof Joints Between Edges of Concrete Slab & Foundation Base Joins
  - Internal Insulation, Finishes is Waterproofing to Architects Specification
  - Damage Floor Slab to Specialist Contractors Specification.

- ## NEW FOUNDATION NOTES
- New Basement Retaining Wall & Strip Foundations to be 500mm Deep
  - C-35/5(R) Ground Bearing Concrete Section at Both High & Low Levels
  - Depth of High Level Bases Adjoining to Low Level Foundations to Match level (Top of SS & FFL to Architects Details)
  - Transition Bases Raising 500mm Between Lower & Higher Levels to be Cast as Necessary.
  - Reinforcement to Strip Foundation: Top to Main Stab, A-252 Mesh Upper (25mm Cover) A-393 Mesh Lower (35mm Cover), With Further A-393 Mesh to Base (50mm Cover).
  - Reinforcement to Bases to Match with Retaining Wall Stems (see Sections for Details)
  - Starter Bars to Wall to Extend 800mm Above Top of SSL of Foundation Base.
  - Retaining Wall Bases to be Cast in 1000mm Wide Sequences Sections (see plan for sequence)
  - Water Bar (or Similar) Water Proof Joints Between Edge of Concrete Slab & Foundation Base Joints.
  - Internal Insulation, Finishes & Waterproofing to Architects Specification.

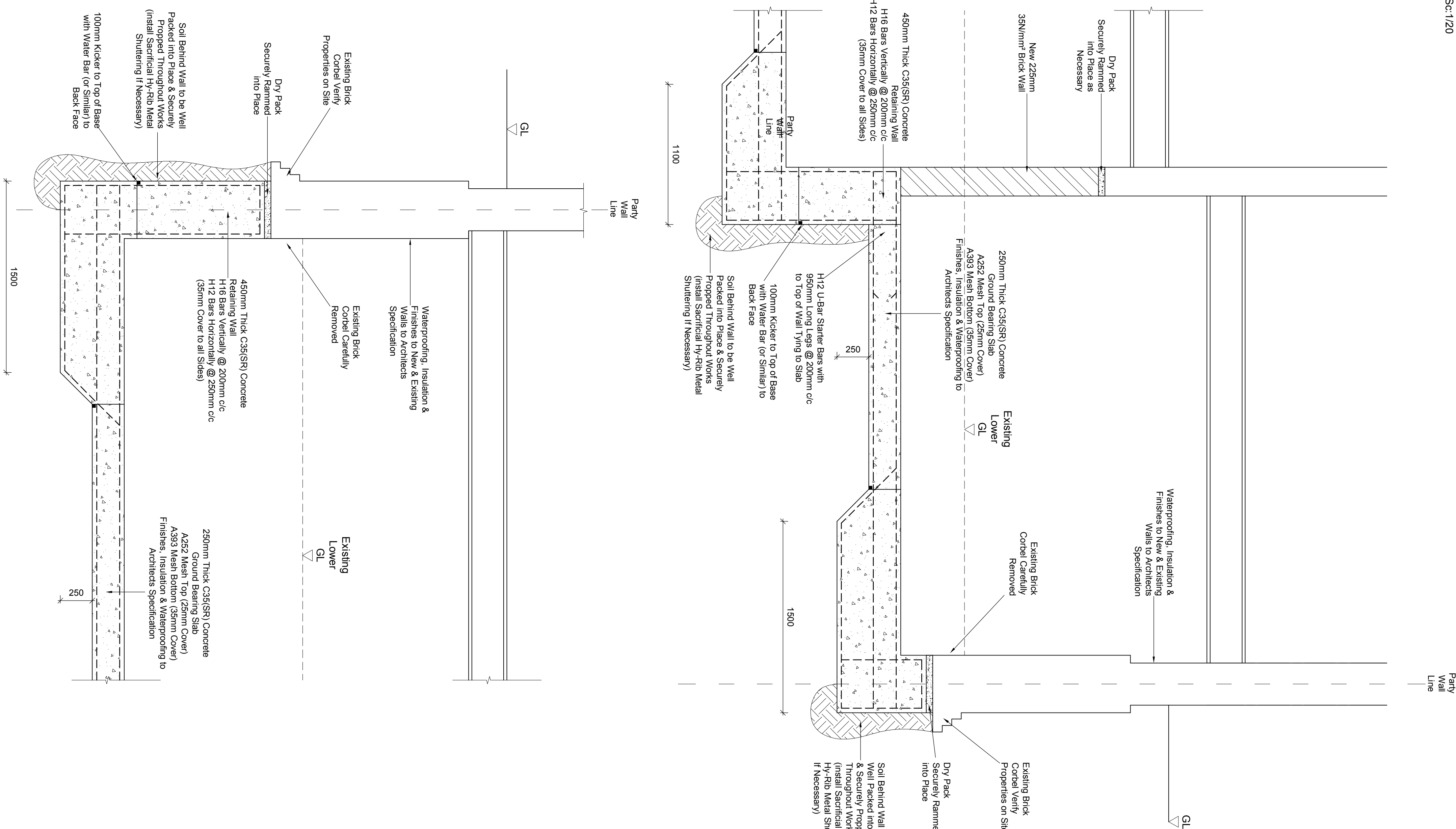

Title:		Foundation Plan & Details			
Preliminary					
Project:	28 CANNFIELD GARDENS, LONDON, NW6	Drawn:	1	Rev	A
Job No.	15-440	Scale	1/50@A1		
Eng. Pos.	15-440				
4 Edward Square, London N1 0SE Tel: 020-7637 5177 Fax: 020-7631 3211 4 Bide Lane, London NW 3XJ Tel: 020-8959 1066 Fax: 020-8906 8633		North Morin Restrictor Associates Consulting Civil & Structural Engineers			
Author	A	29/12/16	Sequenced Bases to latest Spec	PS	
Rev		Date	Description	A/R	

- | Reinforced Concrete Slabs             |                                                                                                                                                                                                                                       |
|---------------------------------------|---------------------------------------------------------------------------------------------------------------------------------------------------------------------------------------------------------------------------------------|
| 1.                                    | All dimensions to be verified on site.                                                                                                                                                                                                |
| 2.                                    | Read in conjunction with architect's drawings.                                                                                                                                                                                        |
| 3.                                    | Reinforced concrete beams/slab will be cast in grade 35/45mm concrete and reinforced in accordance with design information and reinforcement schedules, provided by the engineer (see current contract 25/4/2018).                    |
| 4.                                    | Ready mix concrete must be obtained from a plant, which holds a current certificate of accreditation under the quality scheme for ready mix concrete. No concrete is to be placed when the ambient air temperature is less than 5 °C. |
| 5.                                    | Reinforcement shall be to BS 8110.                                                                                                                                                                                                    |
| 6.                                    | Reinforcement shall be to BS 8110.                                                                                                                                                                                                    |
| 7.                                    | All main bars to be Grade 500 (high yield) steel, with a minimum diameter of 12mm. All secondary (high yield) stress steel otherwise (in which case see BS 4449, Grade 250 (old spec)).                                               |
| 8.                                    | Reinforcement to be fixed adequately using 'pig' wire as steel jigs.                                                                                                                                                                  |
| 9.                                    | Concrete cover to be min 35mm cover, unless stated otherwise on drawings.                                                                                                                                                             |
| 10.                                   | Unless noted otherwise on drawings, all reinforcement is to be applied and fixed (where it is required) to the upper face.                                                                                                            |
| 11.                                   | All works to be approved by the building control officer.                                                                                                                                                                             |
| 12.                                   | All waterproofing and damage to architect's specification.                                                                                                                                                                            |
| 13.                                   | No work is to commence on site prior to building control approval of structural details.                                                                                                                                              |
| 14.                                   | Drawings to be fixed with reinforcing applications (including diagonal/cross details) & reinforcement specification.                                                                                                                  |
| <b>Excavation for retaining walls</b> |                                                                                                                                                                                                                                       |
| 1.                                    | Total cut to be retained to confirm existence of any existing structure                                                                                                                                                               |
| 2.                                    | Working in strips not exceeding 1m long excavate to required depth adjacent to existing structure                                                                                                                                     |
| 3.                                    | Lap reinforcement on adequate splices, cast new concrete and allow 24 hours cure.                                                                                                                                                     |
| 4.                                    | New excavate two adjacent strips without allowing 3 days between operations.                                                                                                                                                          |
| 5.                                    | Formwork may but is installed correctly between bays and walls.                                                                                                                                                                       |
| 6.                                    | Contractor will reinforcement & allow for bonding reinforcement to existing concrete to required height.                                                                                                                              |
| 7.                                    | Leisure ground behind new foundation & wall is to be retained to required height. Retaining requires to ensure the during construction.                                                                                               |
| 8.                                    | When adjacent sections are opened up the exposed face of the wall must be finished with a coat of all loose material & sealed to form a good key.                                                                                     |
| 9.                                    | Foundations to be 1000mm wide unless noted otherwise.                                                                                                                                                                                 |
| 10.                                   | All new concrete below ground to be sulphate resisting cement, Grade 35.                                                                                                                                                              |
| 11.                                   | Reinforcement shall be to BS-8110 with main bars to be grade 500(high yield).                                                                                                                                                         |
| 12.                                   | Ready mix concrete must be delivered from a plant, which holds a current certificate of accreditation under the quality scheme for ready mix concrete.                                                                                |
| 13.                                   | No concrete is to be placed when the ambient air temperature is less than 5 °C.                                                                                                                                                       |