

1 DT01 EXTERNAL GLAZED DOOR

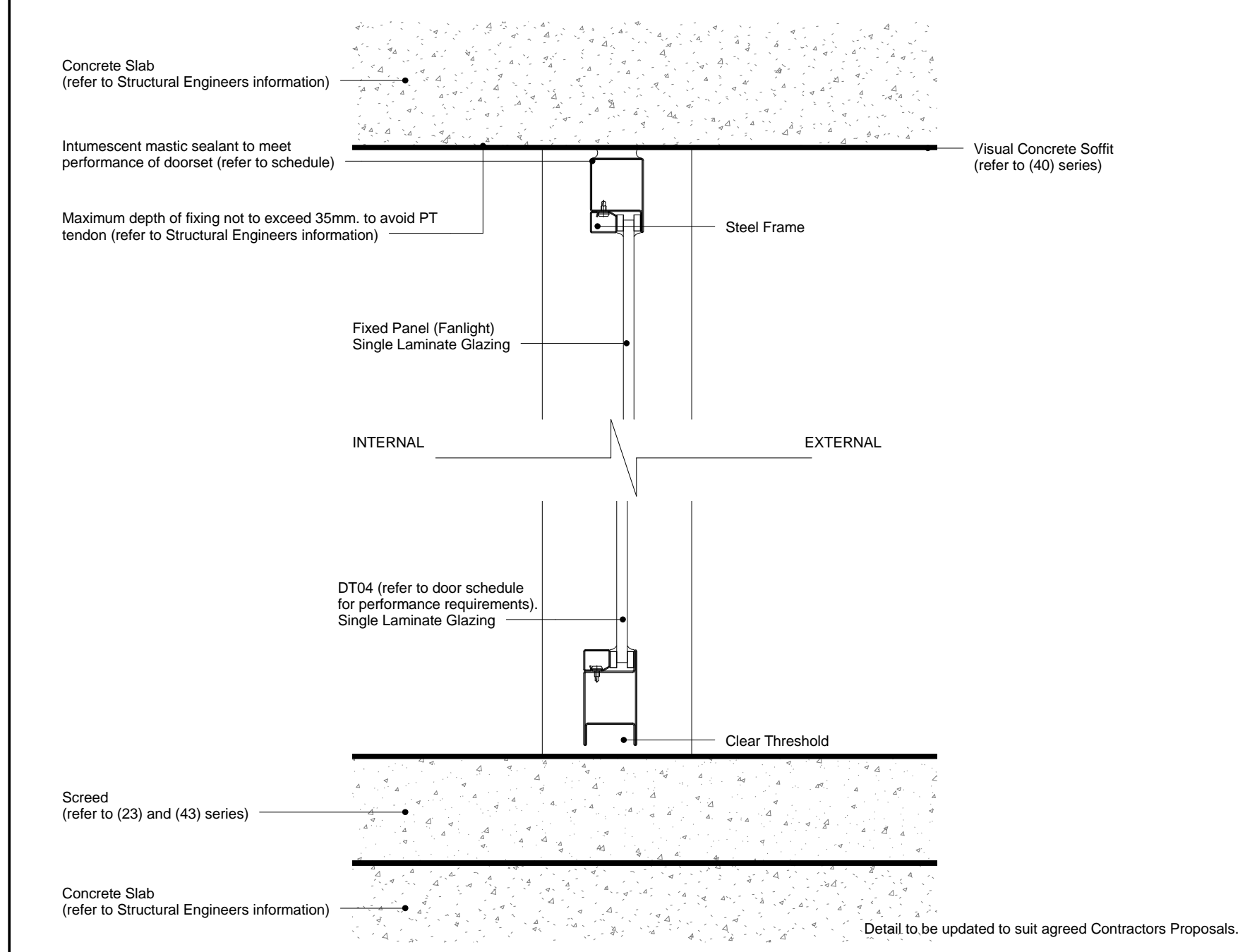

4 DT04 GLAZED DOOR

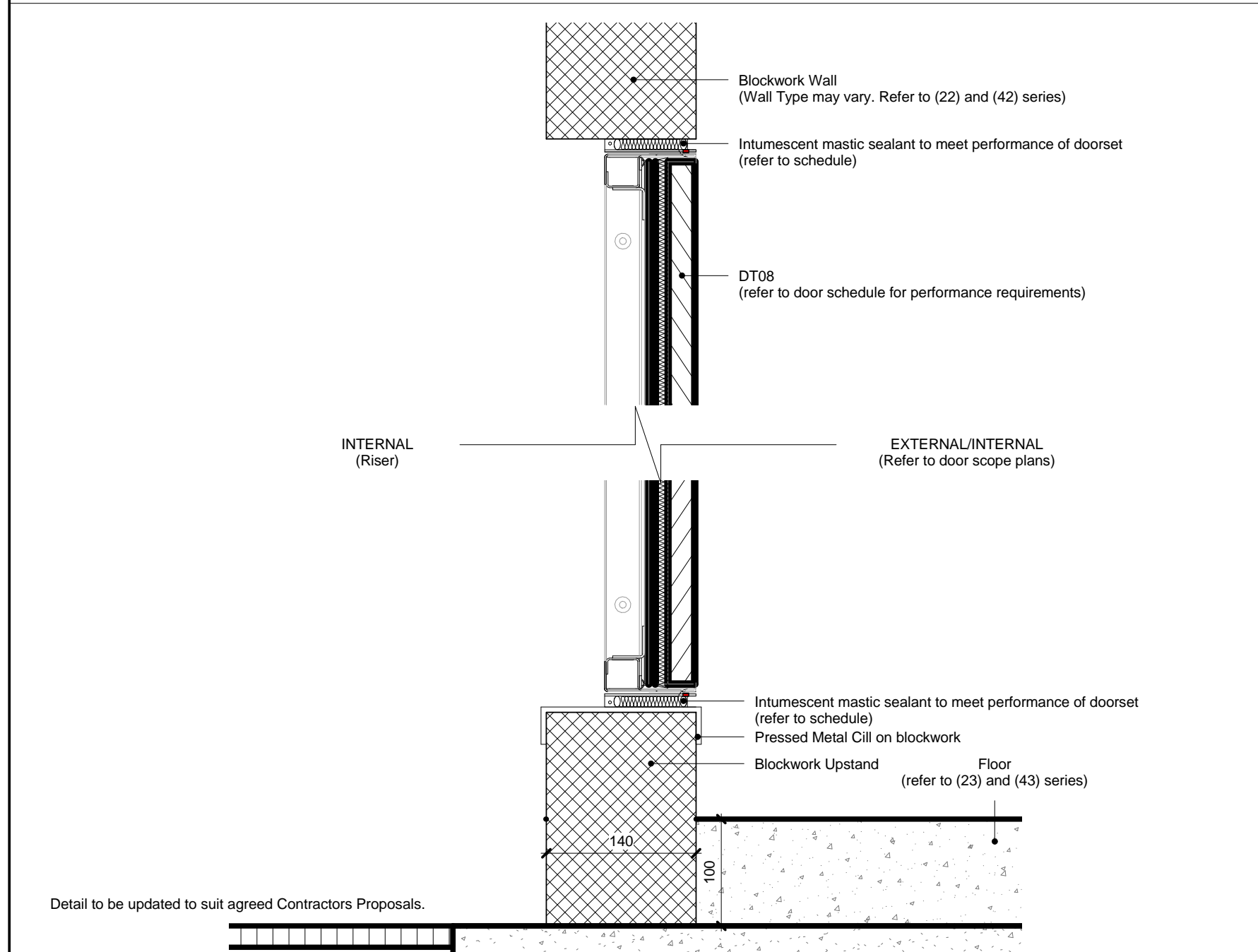

DT08 RISER DOOR (Indicative) NOTE: Previously Durasteel which is omitted through Value Engineering. Alternative to be agreed.

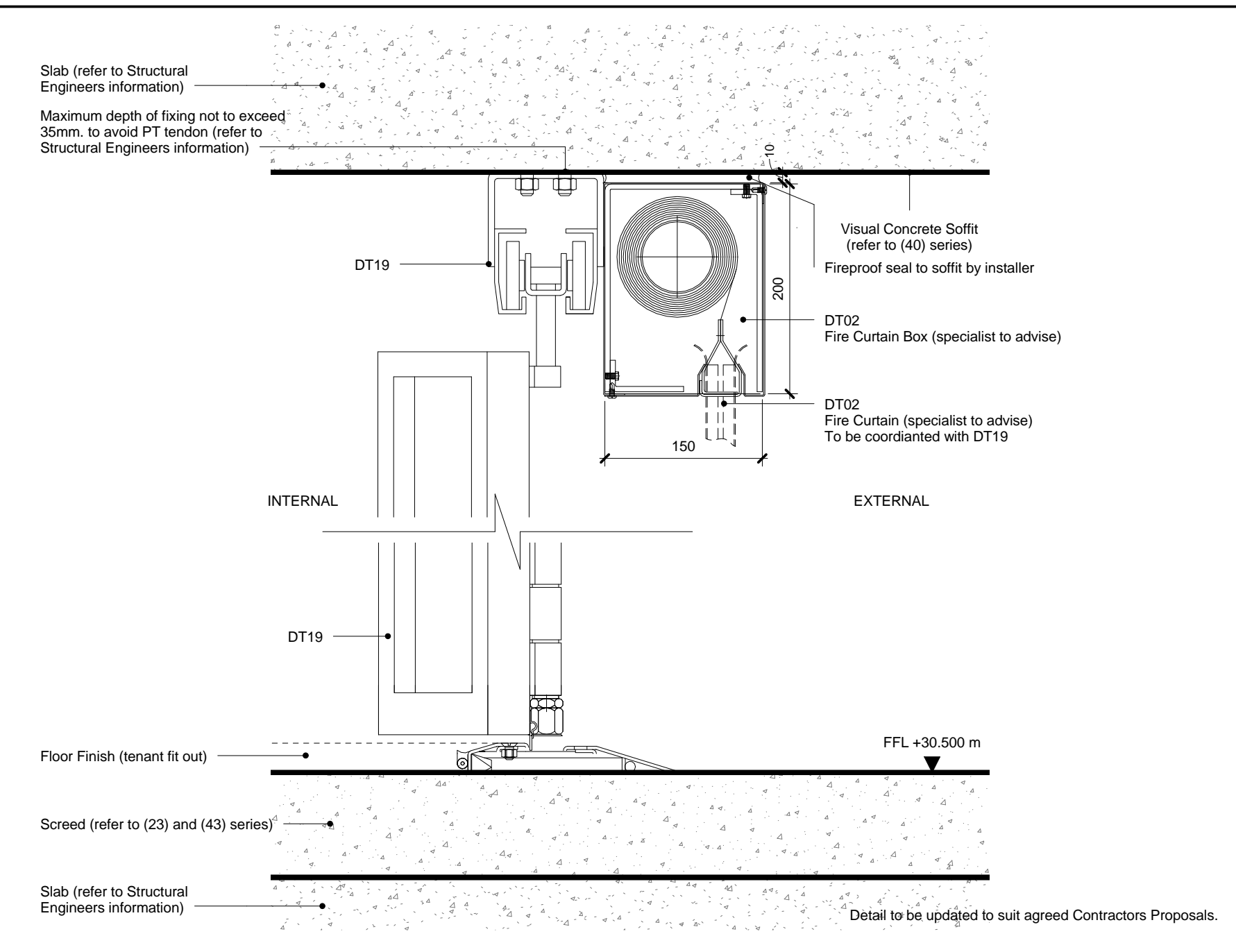

2 DT02 FIRE CURTAIN

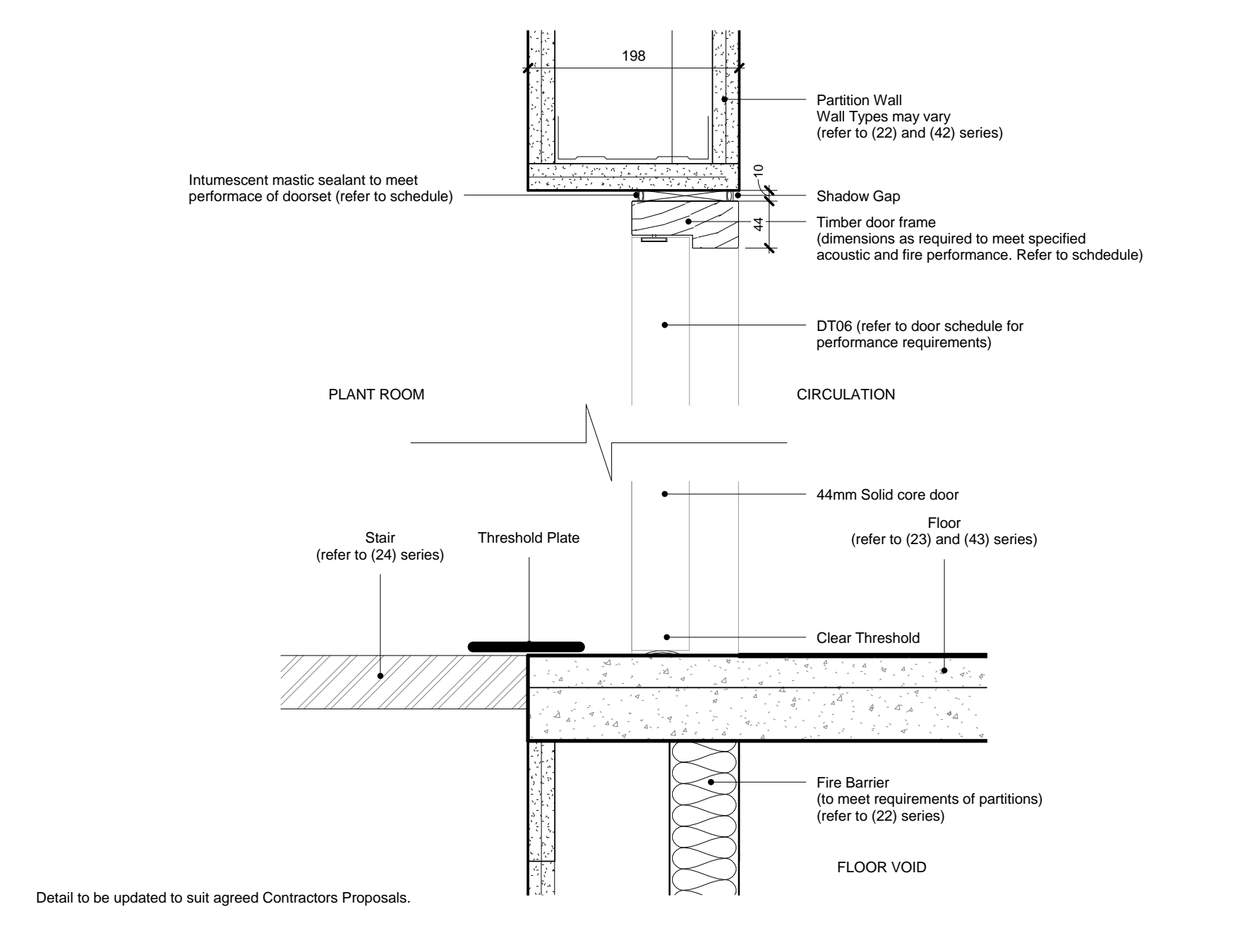

5 DT06 INTERNAL PLANT ROOM DOOR

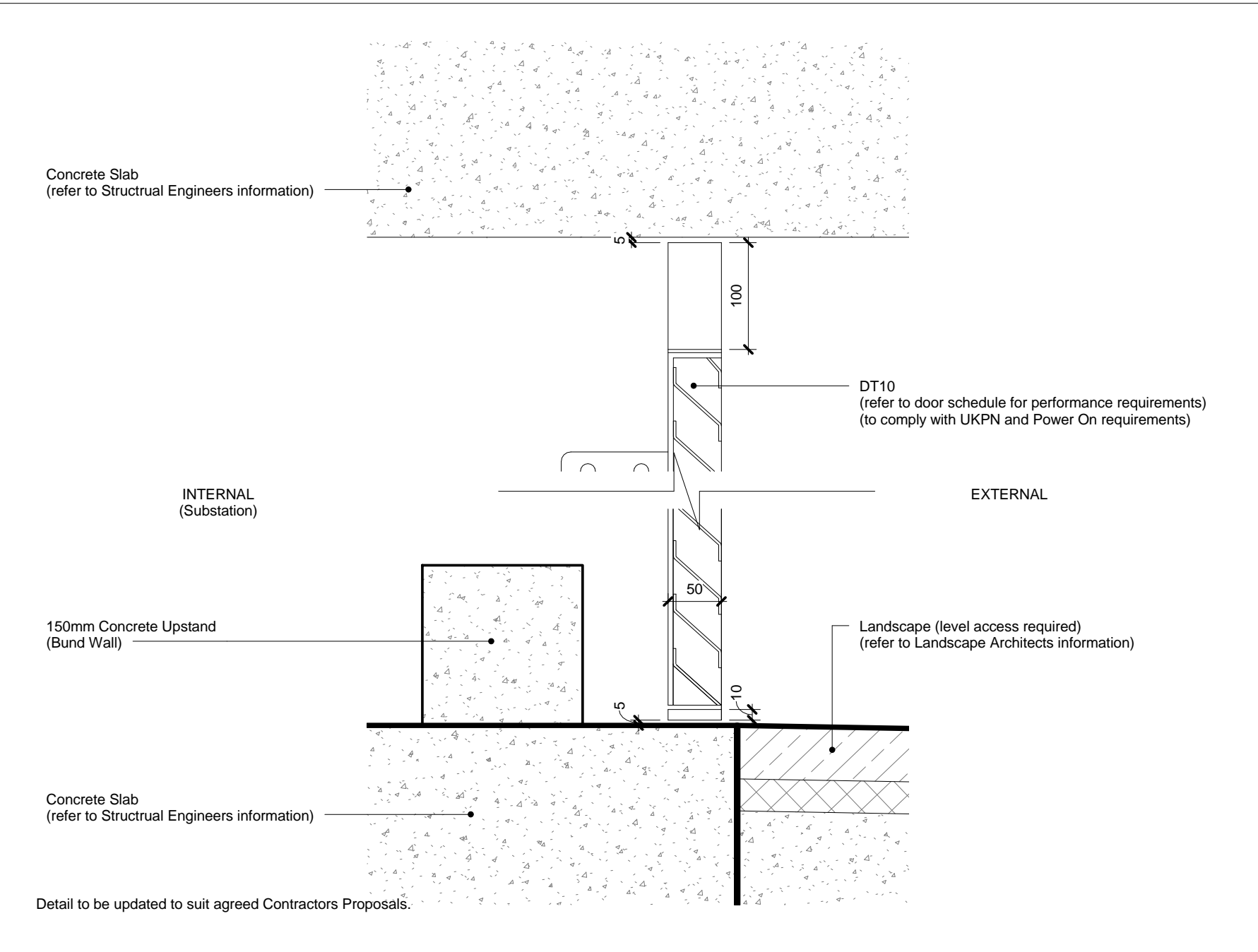

8 DT10 SUBSTATION DOOR

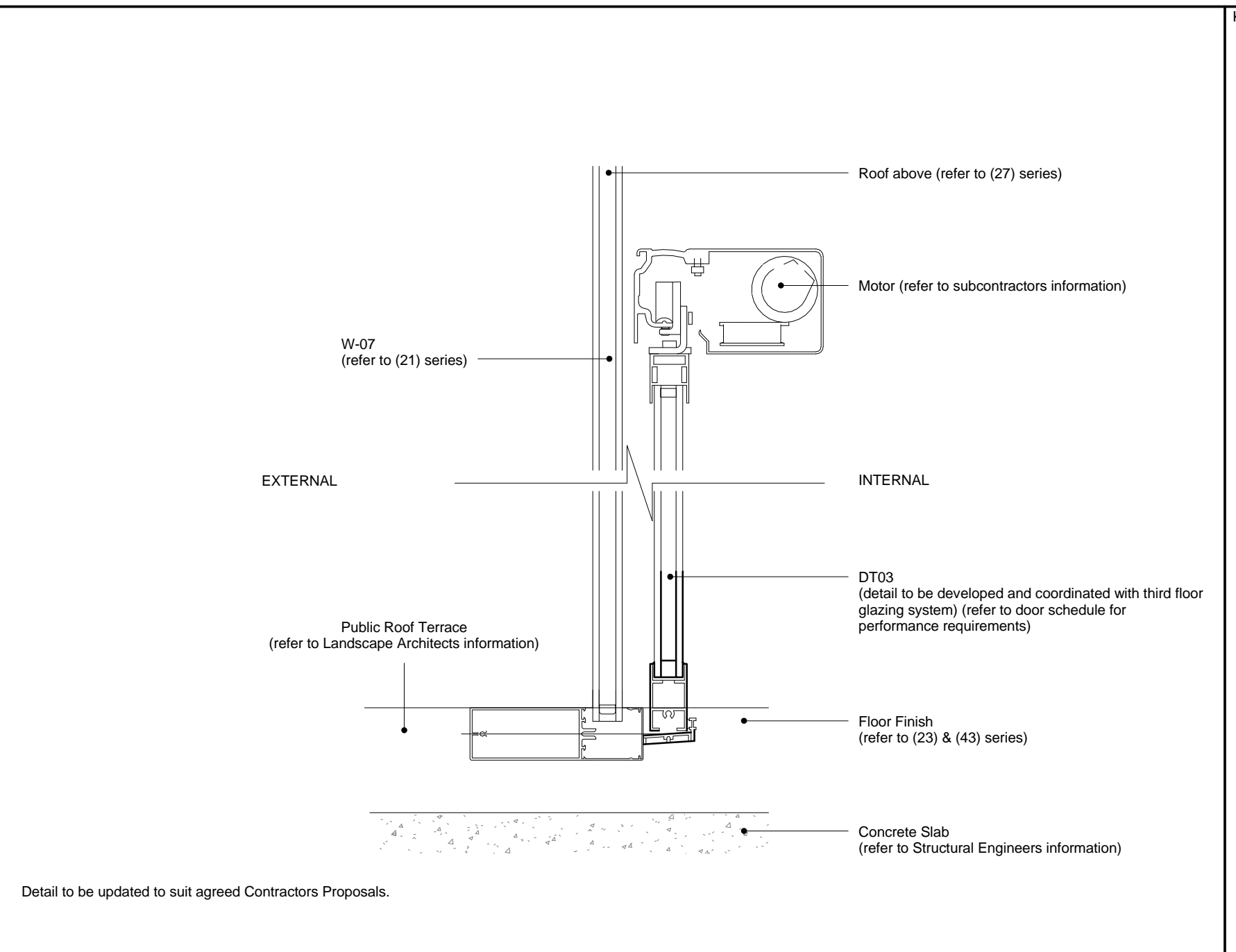

DT03 EXTERNAL GLAZED SLIDING DOOR (TO BE COORDINATED WITH THIRD FLOOR GLAZING SYSTEM)

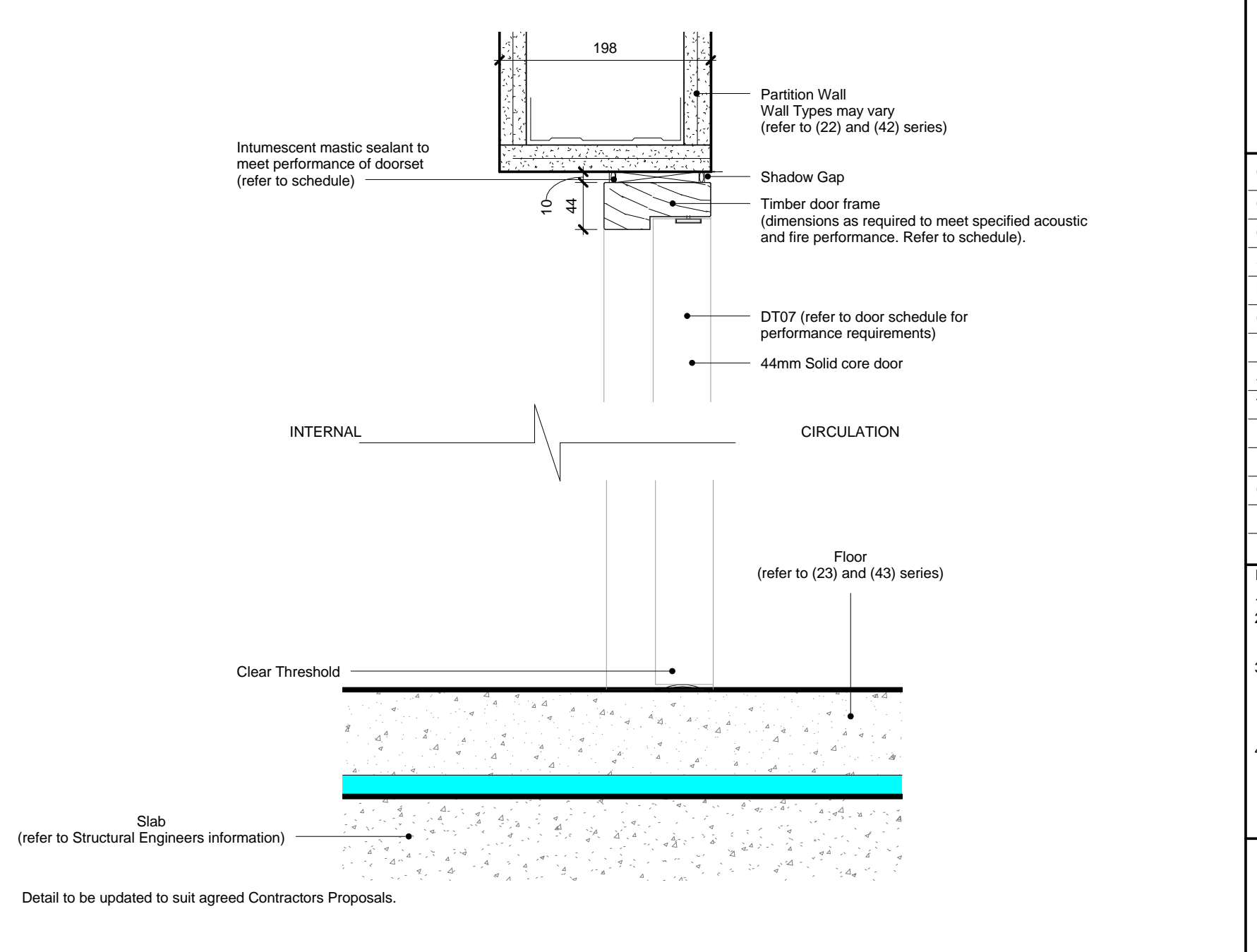

6 DT07 INTERNAL DOOR

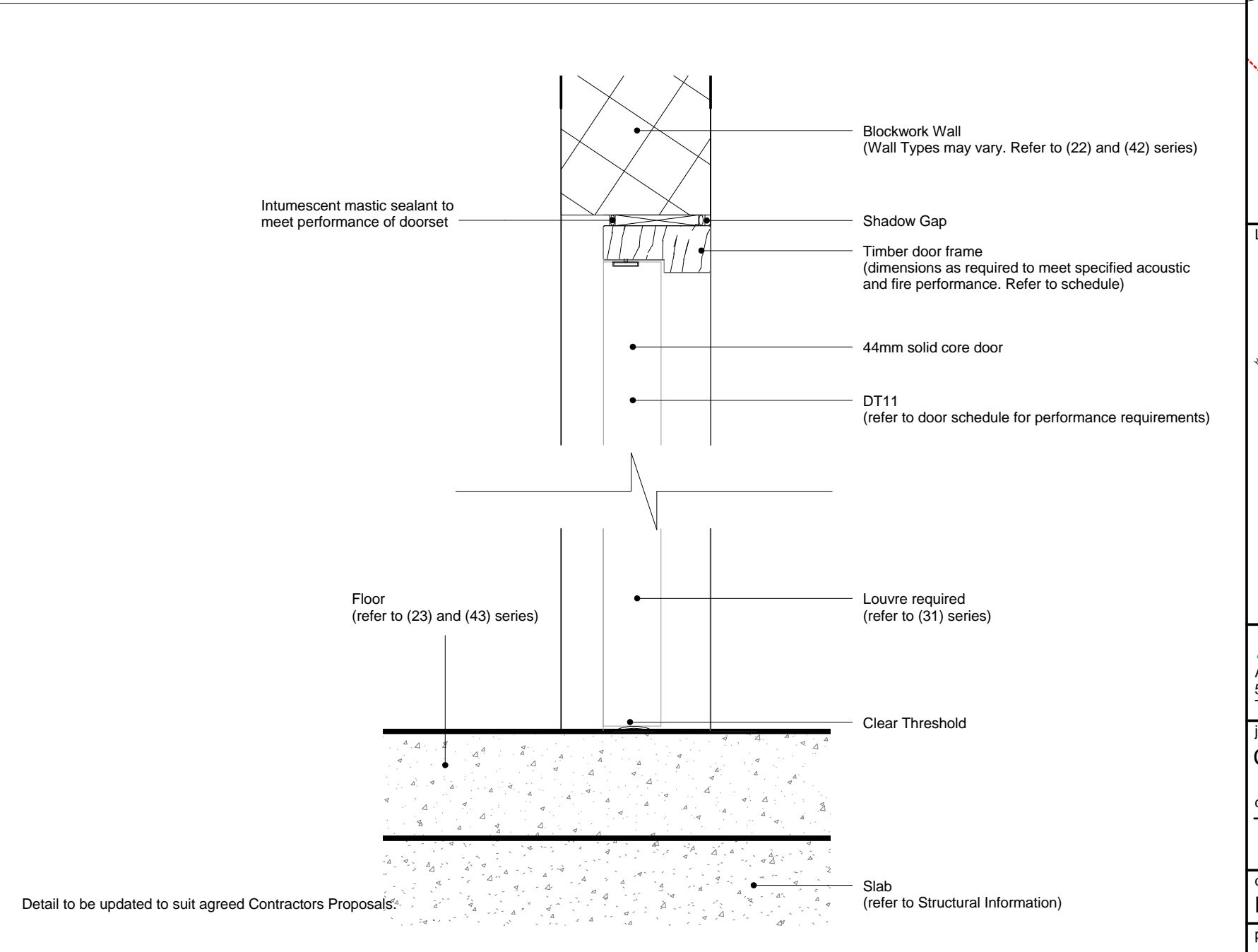

9 DT11 WASTE ROOM DOOR

KEY
For other elements refer to individual drawing series:
(19) Waterproofing
(20) Slab Edge
(21) Facade
(22) Internal walls
(23) Floors
(31) Windows
(32) Doors
(33) Soffits / Ceilings
(40) Visual concrete
(42) Internal Wall finishes
(43) Floor finishes
(45) Soffits / Ceilings Finishes

Landscape Information taken from Drawing D1907 L.210 Lower Ground Floor - Hard & Soft Landscape General Arrangement by Fabrik, Revision O, dated 11.12.15
Door Details show design intent only

REV	DATE	DESCRIPTION	F02	30/09/16	Stage F - For Coordination
C01	18/11/16	For Construction	F01	12/08/16	Stage F - For Coordination

CONSULTANTS	
CLIENT:	Stanley Sidings
CONTRACTOR:	Mace Group
STRUCTURAL ENGINEER:	Walsh Group
MECHANICAL ENGINEER:	AECOM
COST CONSULTANT:	Gardiner & Theobald
PROJECT MANAGER:	Gardiner & Theobald
ACOUSTIC CONSULTANT:	Arup
TRANSPORT CONSULTANT:	Arup
PLANNING CONSULTANT:	Gerald Eve
LANDSCAPE ARCHITECT:	Fabrik
CDM CO-ORDINATOR:	Gardiner & Theobald

NOTE
1. Do not scale from this drawing.
2. All dimensions to be checked on site by the contractor and such dimensions to be his responsibility.
3. Report all drawing errors, omissions and discrepancies to the architect.
4. This document may be issued in an uncontrolled CAD format to enable others to use it as background information to make alterations and/or additions. In that instance the file will be accompanied by a PDF version. It is for those making such alterations and additions to ensure that they make use of current background information.
5. AHMM Ltd accepts no liability for any such alterations or additions to the background information or arising out of changes to background information which occur prior to alterations or additions being made.

REFER TO TECHNICAL REFERENCE SHEET FOR SPECIFICATION CLAUSES
DOCUMENT REFERENCE: 14045 A TRS

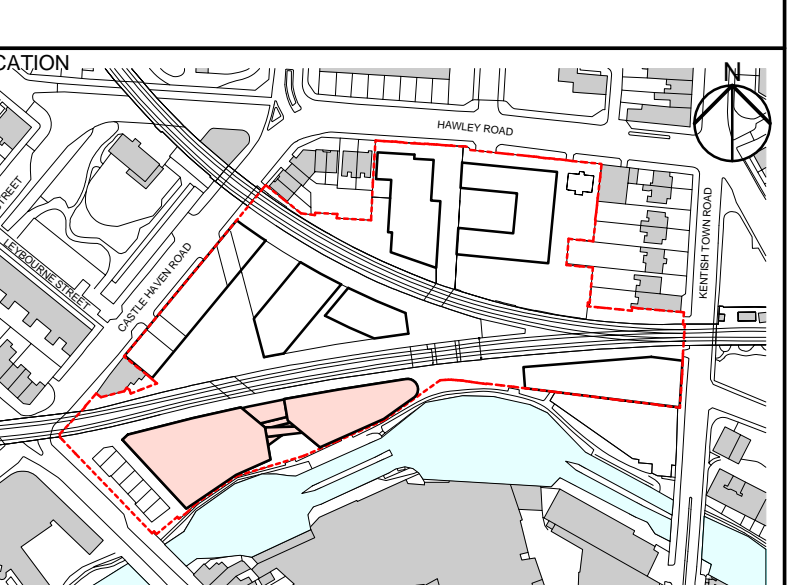
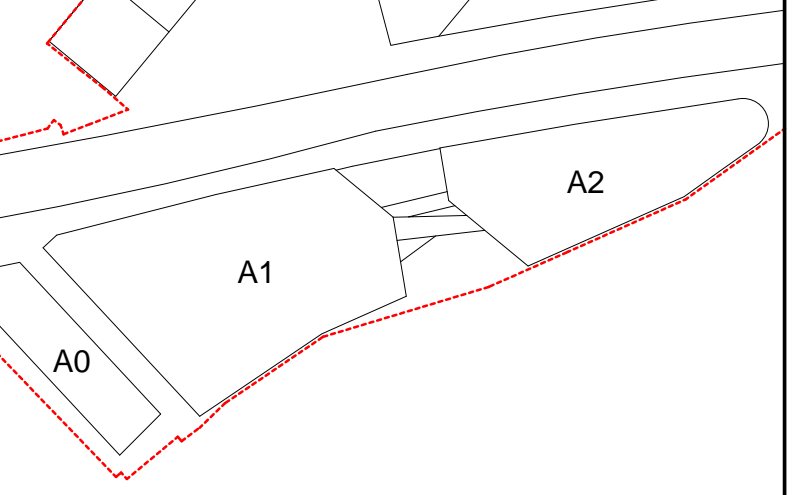

ALFORD HALL MONAGHAN MORRIS
ARCHITECTS Ltd
5-23 OLD STREET, LONDON, EC1V 9HL
TEL 020 7251 5261 FAX 020 7251 5123 WEB WWW.AHMM.CO.UK

job title
CAMDEN LOCK VILLAGE
drawing title / location
Typical Door Details

drawn by	checked	scale	status
MP	FG	1:5 @ A1	For Construction
project	drawing no.	revision	
14045	AX_(32)_ 9012	C01	