

1 Window W-01 Elevation

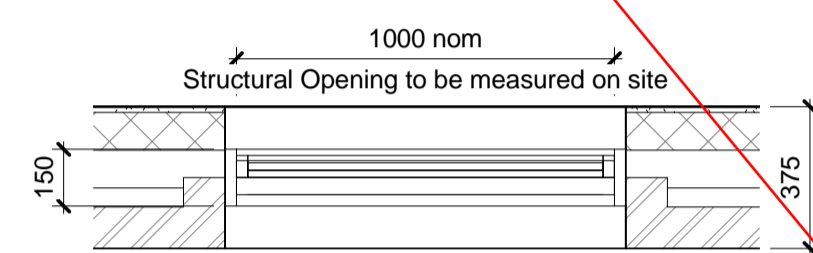

2 Window W-01 Plan

N/A FOR THIS CONDITION

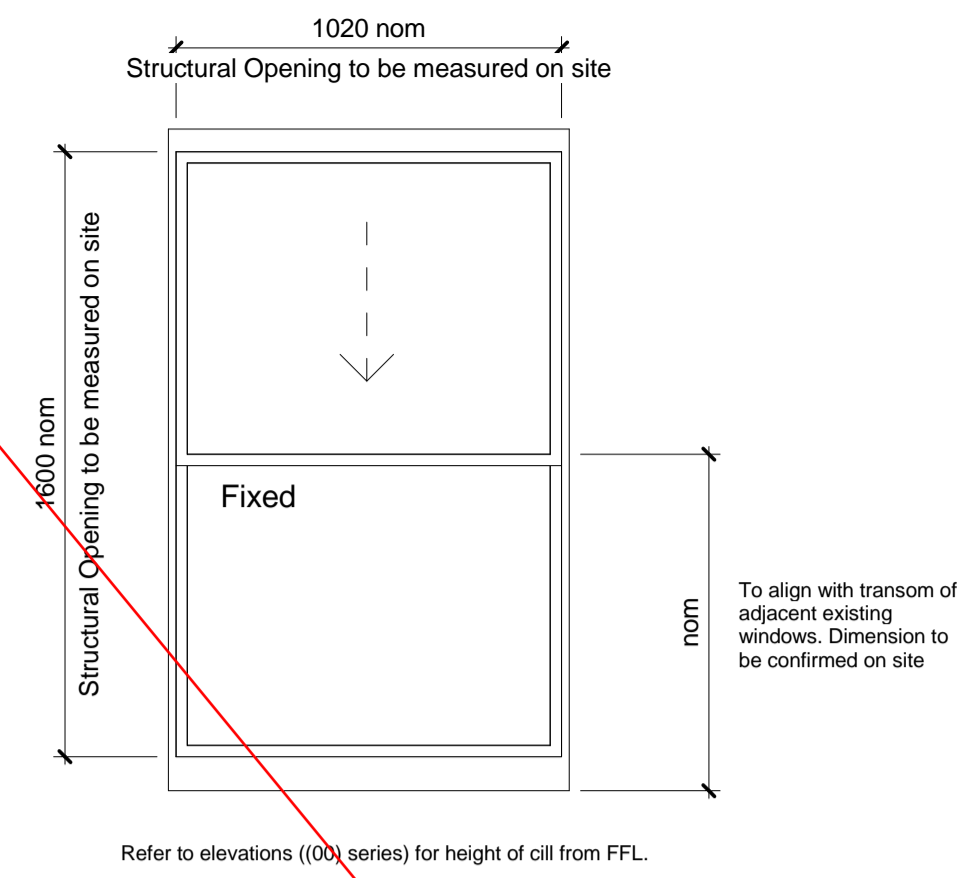

3 Window W-02 Elevation

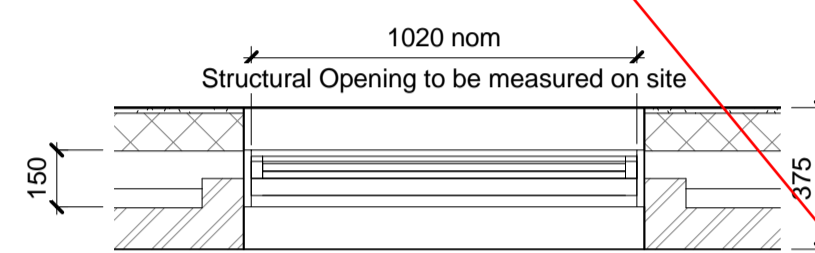

4 Window W-02 Plan

N/A FOR THIS CONDITION

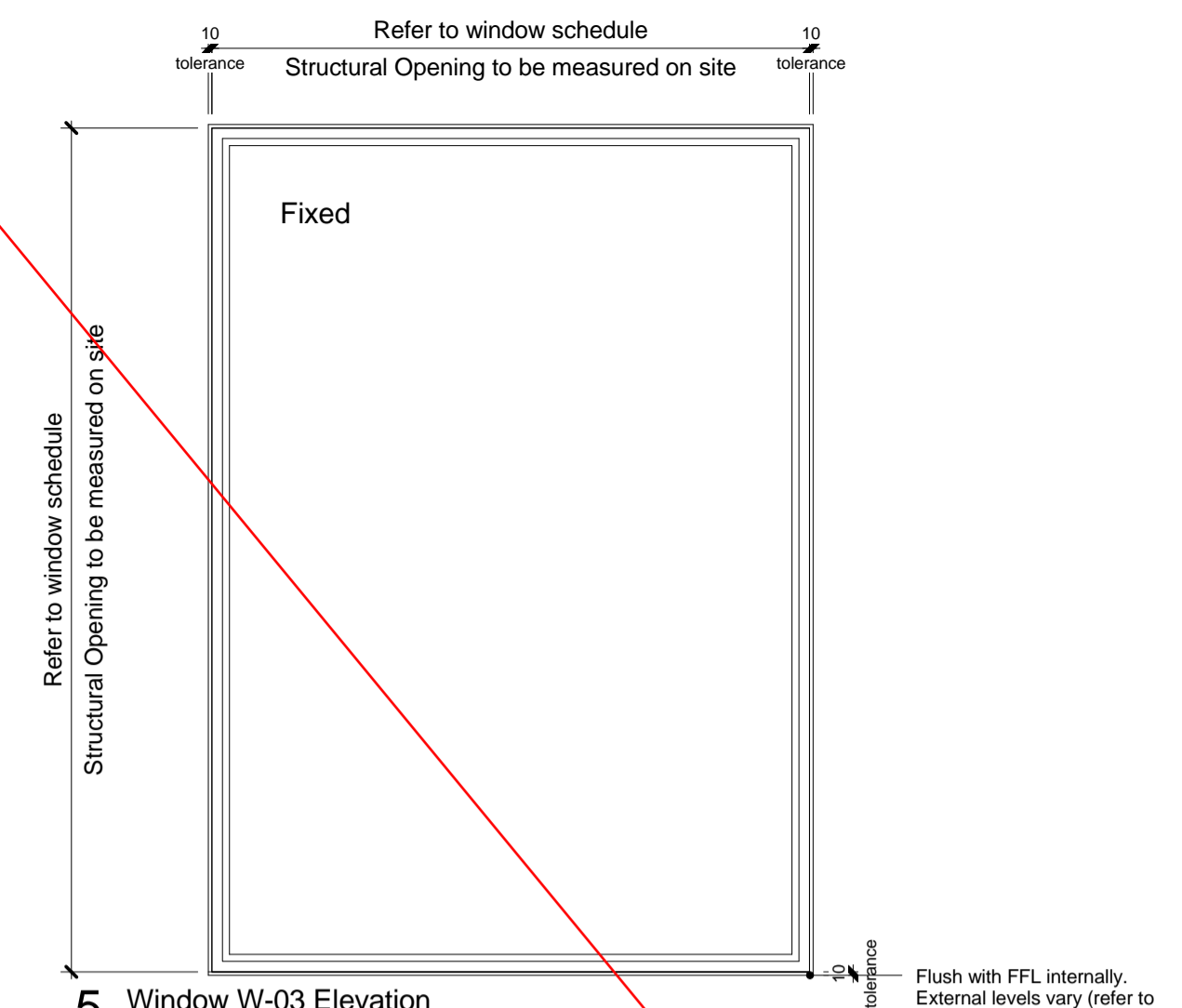

5 Window W-03 Elevation

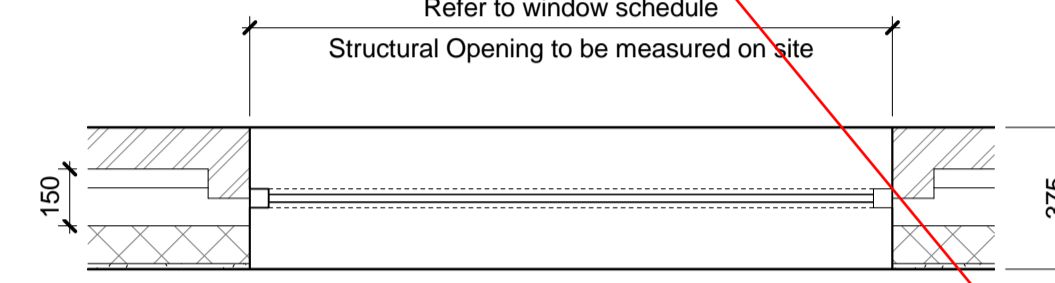

6 Window W-03 Plan

N/A FOR THIS CONDITION

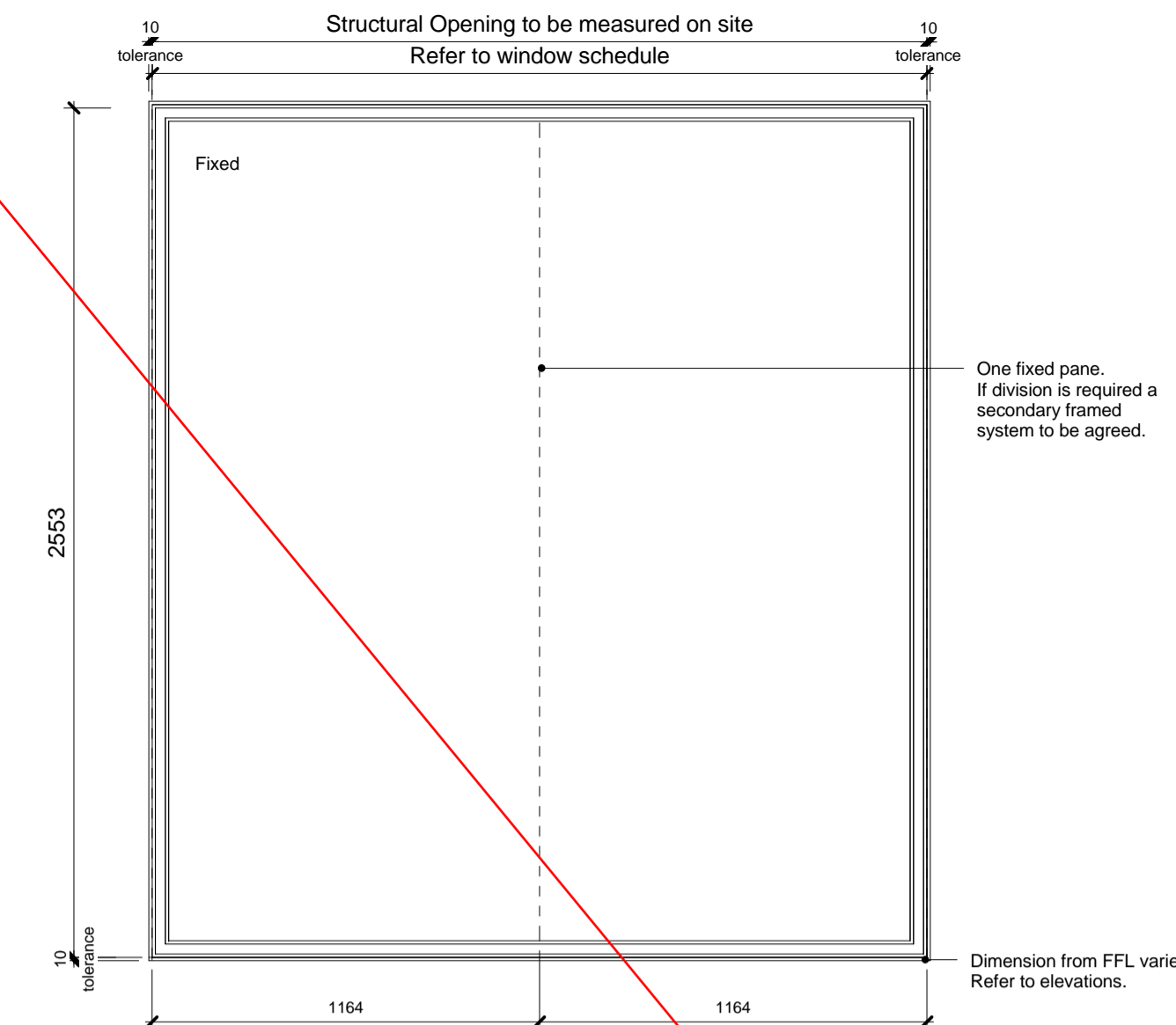

7 Window W-04 Elevation

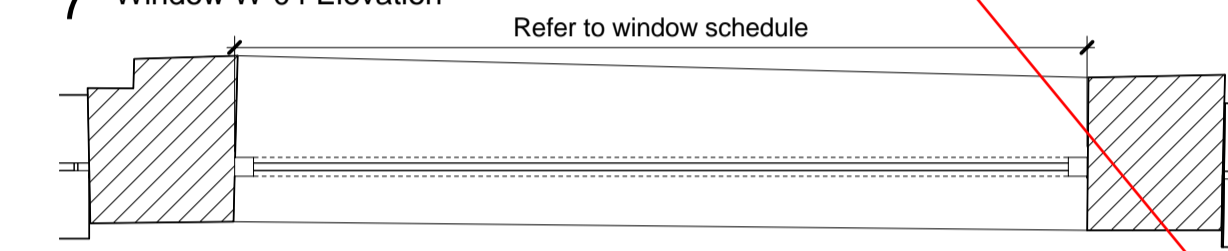

8 Window W-04 Plan

N/A FOR THIS CONDITION

WINDOW TYPE	W-01
WINDOW NUMBER	W3.01, W3.02, W3.03, W3.04
FINISH	Painted timber sash with double glazing

WINDOW TYPE	W-02
WINDOW NUMBER	W2.01, W2.02, W2.03, W2.04
FINISH	Painted timber sash with double glazing

WINDOW TYPE	W-03
WINDOW NUMBER	WUG.04, WUG.05, WUG.06, WUG.07, WUG.08, WUG.09
NOTES	PPC RAL tbc

WINDOW TYPE	W-04
WINDOW NUMBER	WUG.01, WUG.02, WUG.03
FINISH	PPC RAL tbc

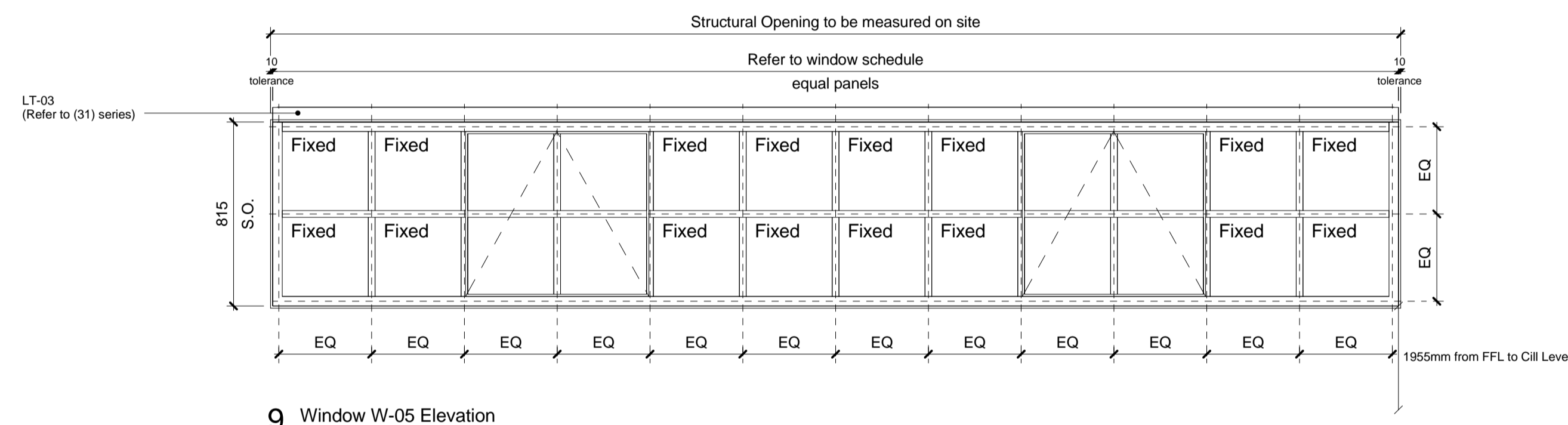

9 Window W-05 Elevation

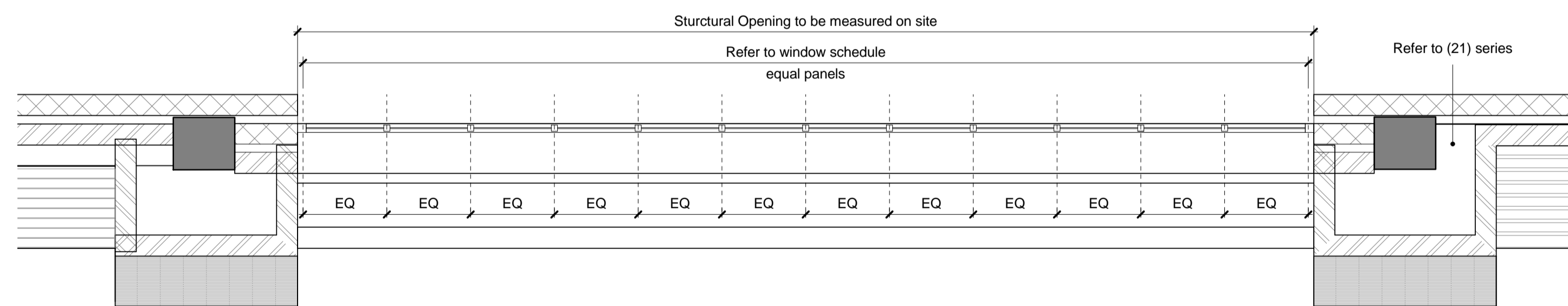

10 Window W-05 Plan

CANAL WALL WINDOWS

WINDOW TYPE	W-05
WINDOW NUMBER	WLG.02, WLG.03, WLG.04, WLG.05, WLG.06, WLG.07, WLG.08
FINISH	Wired glazing, pressed metal sill, galvanised and painted frame
NOTE	Locking mechanism & Integrated ventilation louvres required. Refer to drawing A1_(21)_2030

NOTES	<p>WT1 Window Type</p> <p>W2.01 Window Number</p> <p>1. Refer to AX_(31)_1010 for replacement windows</p> <p>2. All window openings to be site measured individually prior to manufacture & installation</p> <p>3. Variations to drawings to be agreed with Heritage Planner</p> <p>4. All dimensions are nominal. Final dimensions of frames to be agreed and coordinated with the design team prior to fabrication</p>
-------	--

REV	DATE	DESCRIPTION
C01	07/10/16	For Construction
F01	22/07/16	Stage F - For Coordination
F02	23/09/16	Stage F - For Coordination

CONSULTANTS	Stanley Sidings
CLIENT:	Mace Group
CONTRACTOR:	Walsh Group
STRUCTURAL ENGINEER:	AECOM
MECHANICAL ENGINEER:	Gardiner & Theobald
COST CONSULTANT:	Gardiner & Theobald
PROJECT MANAGER:	Arup
ACOUSTIC CONSULTANT:	Arup
TRANSPORT CONSULTANT:	Gerald Eve
PLANNING CONSULTANT:	Fabrik
LANDSCAPE ARCHITECT:	Gardiner & Theobald
CDM CO-ORDINATOR:	

NOTE

- Do not scale from this drawing.
- All dimensions to be checked on site by the contractor and such dimensions to be his responsibility.
- Report all drawing errors, omissions and discrepancies to the architect.
- This document may be issued in an uncontrolled CAD format to enable others to use it as background information to make alterations and/or additions. In that instance the file will be accompanied by a PDF version. It is for those making such alterations and additions to ensure that they make use of current background information.

AHMM Ltd accepts no liability for any such alterations or additions to the background information or arising out of changes to background information which occur prior to alterations of additions being made.

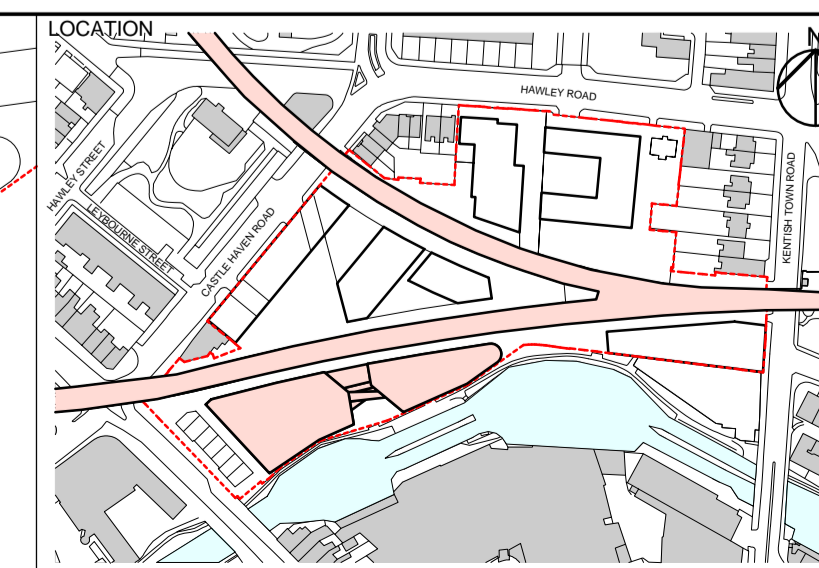
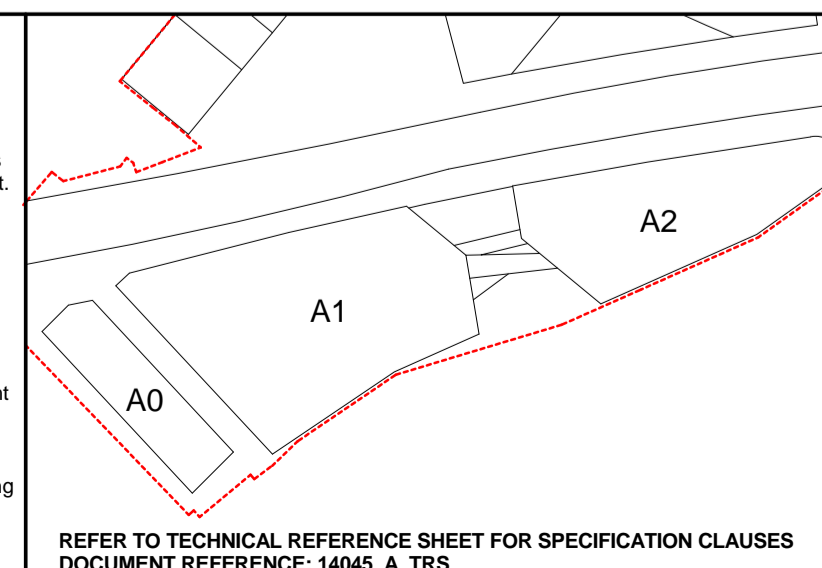

ALLFORD HALL MONAGHAN MORRIS			
ARCHITECTS LTD 5-23 OLD STREET, LONDON, EC1V 9HL TEL 020 7251 5261 FAX 020 7251 5123 WEB WWW.AHMM.CO.UK			
job title CAMDEN LOCK VILLAGE			
drawing title / location New Window Matrix 1			
drawn by MP	checked FG	scale 1 : 20 @ A1	status For Construction
project 14045	zone CI/SIB	drawing no. AX_(31)_1000	revision C01