

1 | BLOCK C - STAIR SECTION - L00-L03
1 : 20

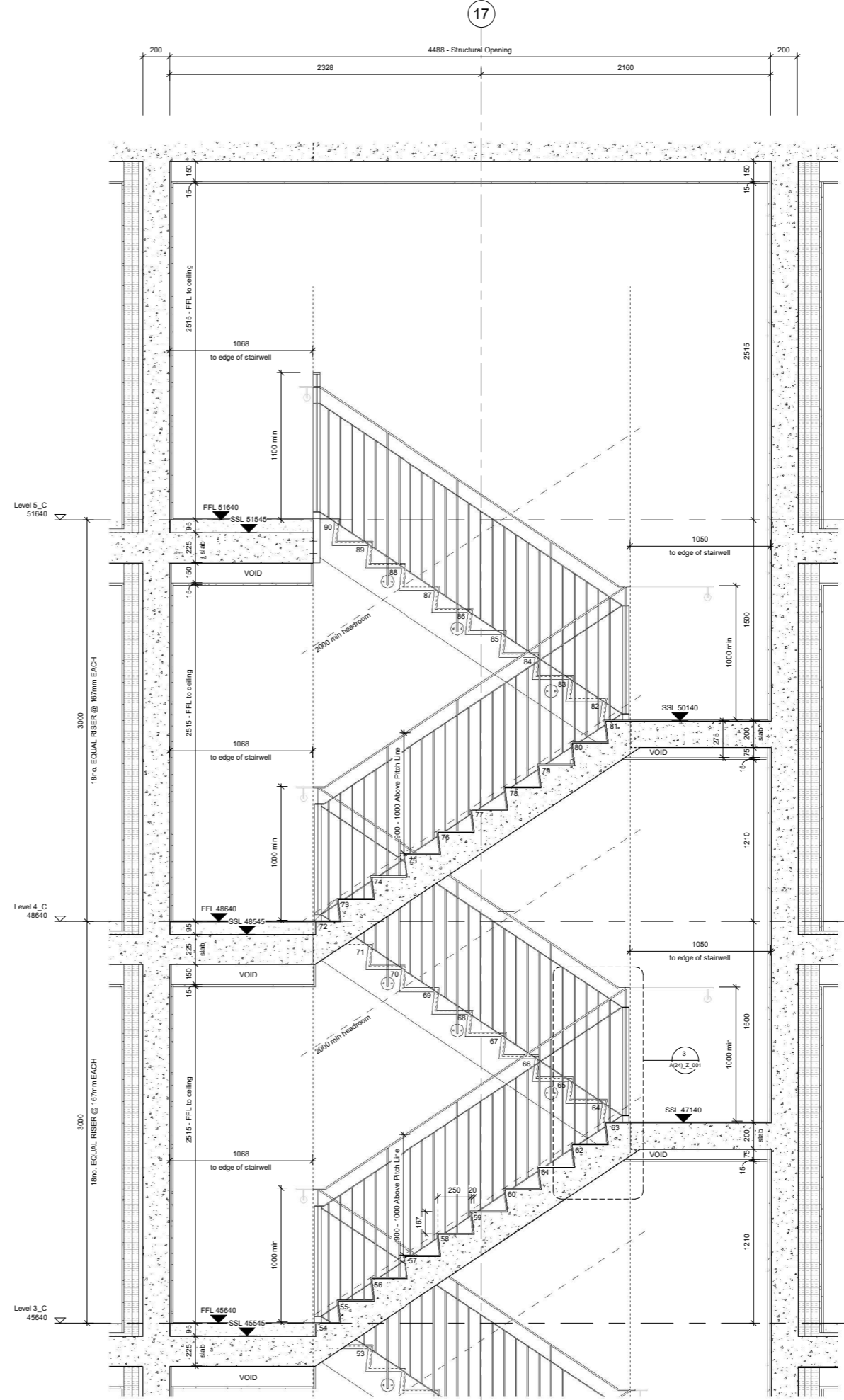

2 | BLOCK C - STAIR SECTION - L03-L05
1 : 20

- GENERAL NOTES**
- This drawing is copyright of PTE architects
 - Use figured dimensions only. DO NOT SCALE.
 - All dimensions are in millimetres unless noted otherwise
 - All levels are in metres above Ordnance datum unless noted otherwise
 - This drawing must be read in conjunction with all other relevant drawings and specifications from the Architect and other consultants
- SETTING OUT NOTES**
- All setting out to be confirmed on site prior to construction - any discrepancy must be immediately reported to the Architect.
 - All setting out to face of structure or to grid.
 - All partitions set out to studwork or structure.
 - For setting out and specification of MSE services refer to MSE Consultants documents.
 - For setting out and specification of structure refer to Structural Engineers documents.
- STAIR NOTES**
- Stair construction: precast concrete, to comply with Part B, K & M of the Building Regs. For rise and tread dimensions refer to plans on drawings A(24) series.
 - All dimensions to be checked on site prior to manufacture / assembly. All discrepancies are to be referred to Architect for clarification prior to construction.
 - Thickness of concrete shown to stair is indicative and subject to Structural Engineer and sub-contractor details.
 - Minimum dimensions (eg. 900mm min clear) to be checked on site and confirmed prior to construction.
 - Side trim: to be confirmed
 - Edge trim type/spec: to be confirmed
 - Stair nosing trim - Gradius or similar approved type/ spec/ colour: to be confirmed
 - Details are indicative only. Detailed design, structural sizes etc to be confirmed by specialist and Structural Engineer prior to construction.
 - Stair sub contractor to provide full shop drawings for Architects inspection prior to commencing manufacture / assembly.
 - Refer to FDS fire strategy report for fire resisting construction requirements.
 - External stair setting out subject to confirmation of stair finish paving.
 - Skirting along outer edge to be 150mm high 19mm thick MDF board paint finish
 - 9mm nominal floor finishes shown on sections only

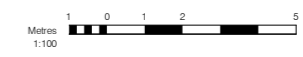
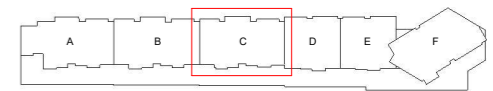

A	18/11/16	LEVEL 3 CONSTRUCTION ISSUE. DIMENSIONS AMENDED	AL	DPD
/	16/08/16	ISSUED FOR CONSTRUCTION	AL	DPD
REV	date	description	dm	aud

LEVEL 3 FOR CONSTRUCTION

Dispeker Wharf
38 Graham Street
London N1 8LX
020 7336 7777
forename.surname@pte.a.co.uk
@ptearchitects
www.pollardthomasedwards.co.uk

**Pollard
Thomas
Edwards**

project	job number	drawn	audited	scale	date
ABBEY AREA PHASE 1	15-029	AL	DPD	As indicated@A1	AUG 16
drawing title	drawing number	revision			
STAIR SECTION BLOCK C	029_A(24)_C_002	A			

C:\Users\aron.lung\Documents\Revit User Models\2015-029_PTE_A_A_Building_aron.lung.rvt