

Information contained within this drawing is the sole copyright of 21st Architecture Ltd and is not to be reproduced without express permission. No implied licence exists. This drawing not to be used for land transfer or valuation purposes. Do not scale from this drawing. All dimensions & levels are to be checked on site by the contractor. Issued for purposes indicated only. Drawing errors and omissions to be reported to the architect.

Setting out and all G.A. drawings prepared from survey information provided by others.  
 All setting out must be checked on site.  
 All levels must be checked on site and refer to Ordnance Datum Newlyn unless alternative Datum given.  
 All fixings and weathenings must be checked on site.  
 All dimensions must be checked on site.  
 This drawing must not be scaled.  
 This drawing must be read in conjunction with the relevant specification clauses.  
 This drawing must not be used for land transfer purposes.  
 This drawing must not be used on site unless issued for construction.

**THIS IS A DESIGN INTENT DRAWING. SUB-CONTRACTOR / SUPPLIERS DETAILED DRAWINGS AND SPECIFICATIONS TO BE SUBMITTED FOR DESIGN TEAM INFORMATION AND/OR COMMENT**

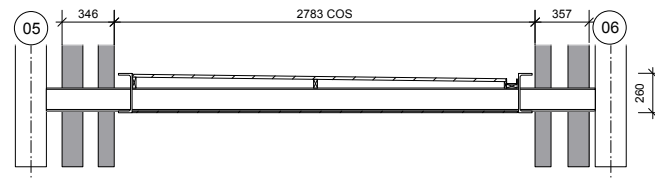
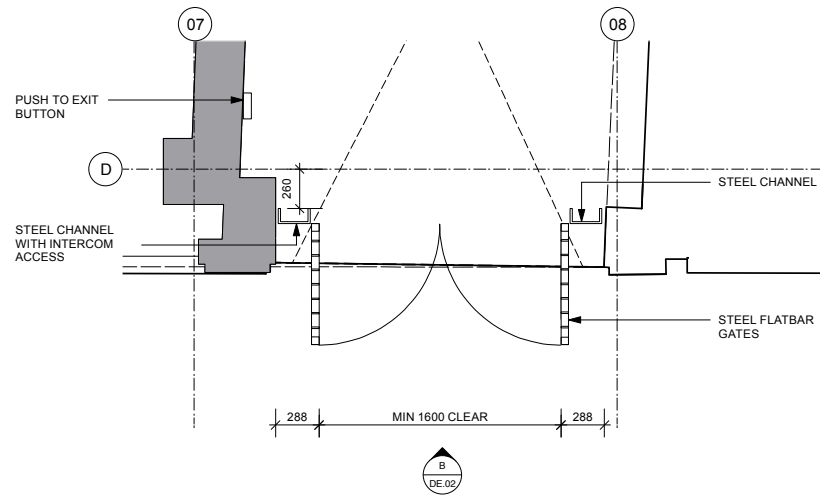

**A ENTRY GATES PLAN**  
 DE.01 1:25@A1, 1:50@A3

**C CANOPY SECTION**  
 DE.02 1:25@A1, 1:50@A3

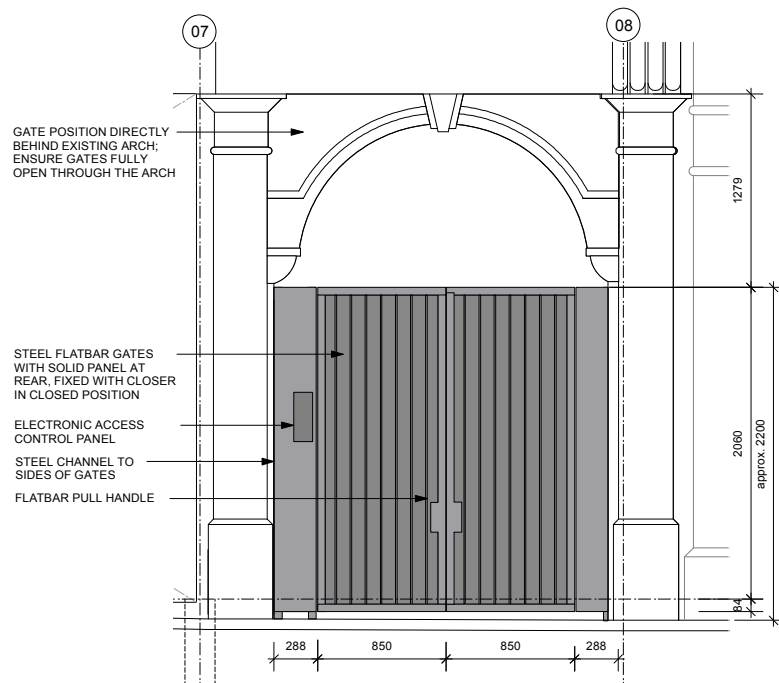

**B ESCAPE ALLEY GATES ELEVATION**  
 DE.02 1:25@A1, 1:50@A3

P1 16/01/17 Issued to LBC Planning  
 T 07/12/16 Issue for Tender  
 A 08/11/16 Issue for Information



**Twenty First Architecture Ltd,**  
 314 Goswell Road,  
 London,  
 EC1V 7AF  
 Tel: +44(0)20 7962 0282  
 www.21starchitecture.com

Client  
 London + Regional Properties Ltd

Project  
 10 Parkway,  
 Camden, NW1 7AA

Drawing Title  
 Escape Corridor Gates and Details

Status  
 Planning Drawn AW Checked PK

Scale  
 1:25@A1 / 1:50@A3 Date  
 Sept 2016

Drwa. No.  
**247\_DE\_02** Revision  
**P1**

