

CONSTRUCTION KEY

- existing retained
- line over/under/behind
- demolished
- new construction
- 28mm thick drylining (incorporating Newton 503 mesh & 12.5mm plasterboard)

GROSS INTERNAL FLOOR AREAS:

- Overall: 409.1 m²
- Communal Circulation: 20 m²
- FS36 House: 123.5 m²
- FS38 LM: 67.3 m²
- FS38 1FF: 32.8 m²
- FS38 2FF: 75.9 m²
- FS38 3FF: 71.7 m²

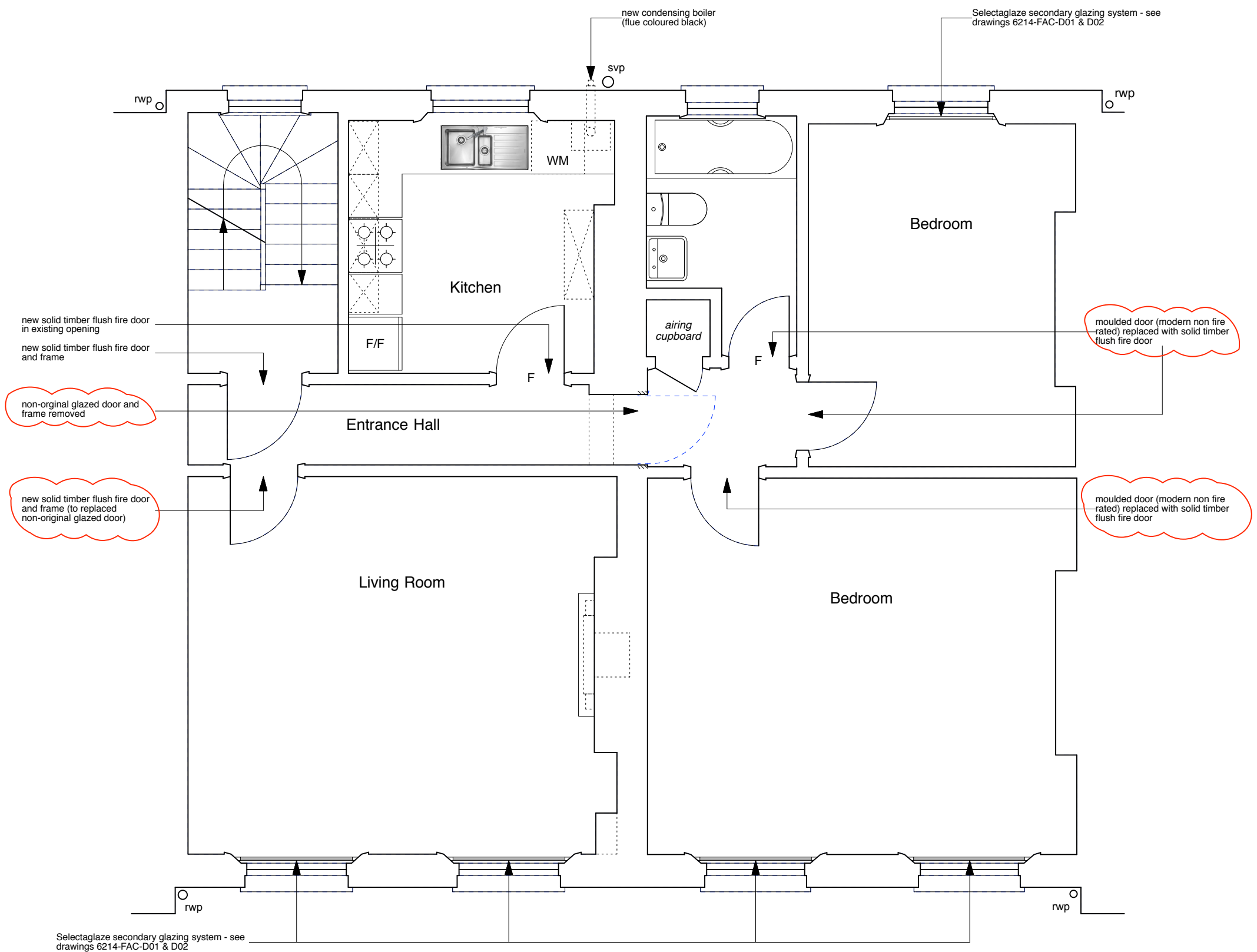

NOTE:

Existing, non fire-rated flush internal doors to be replaced with solid timber flush fire doors.

Defective, non-original sash windows to be replaced like-for-like but without horns and using stretched ovolo mouldings/glazing bars & hardwood cills.



Rev A - 25/01/17 - revised as indicated

	PROJECT 5 ARCHITECTURE LLP 8 Waterson Street London E2 8HL	job title 36-38 FREDERICK STREET, LONDON WC1X 0ND	scale 1:50 @ A3	drawn SA	drawing no. 6214-FS36+38-P04A
	T: +44 (0)20 7739 9131 F: +44 (0)20 7739 3687 E: info@p5a.co.uk	drawing SECOND FLOOR PLAN - PROPOSED	date OCT 2016	checked XX	