

DOMED SKY
LIGHTS ABOVE

SCALE 1:100

PREVIOUSLY APPROVED
LIGHTWELL CONFIGURATION

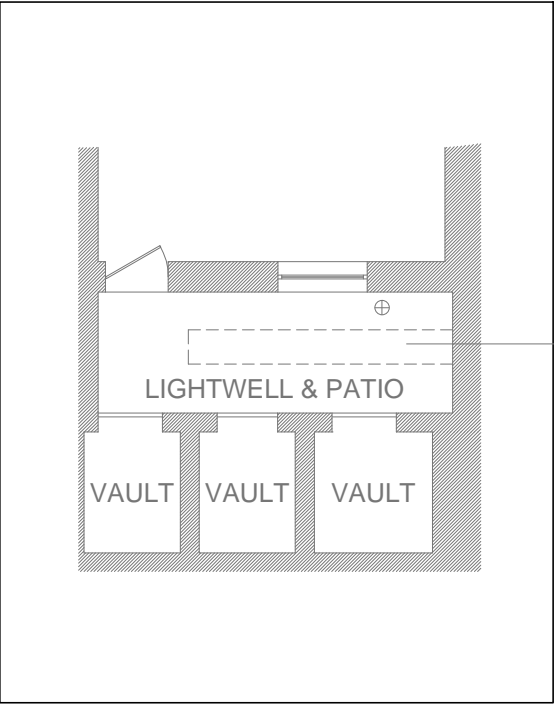

UNCOVERED
OPENING ABOVE

SCALE 1:100

EXISTING (AS BUILT)
LIGHTWELL CONFIGURATION

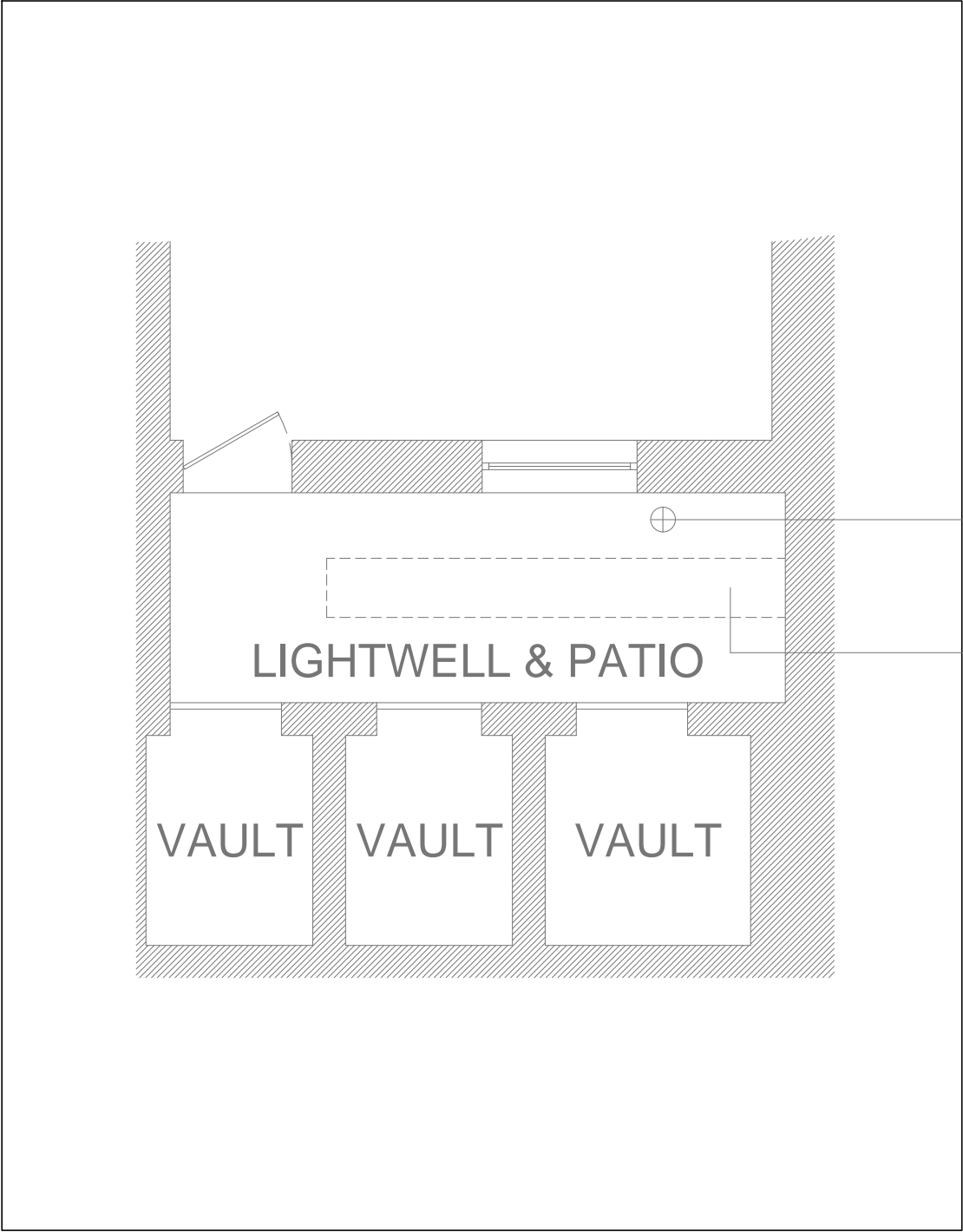

WATER RUNOFF VIA
EXISTING DRAIN COVER

METAL GRILLE COVER ABOVE
(FOR IMPROVED LIGHT, EMERGENCY
EGRESS AND VENTILATION)

SCALE 1:50

PROPOSED
LIGHTWELL CONFIGURATION

BASEMENT PLAN

Revision notes:		
Rev:	Date:	Notes:
A	20.01.2017	ANNOTATION CHANGES (SHOPFRONT / FRONT ELEVATION NOT PART OF APPLICATION)

Drawn by:
GC

Client:
Ganeshwaran Velautham
40 Copse Wood Way, London HA6 2UA

Project:
Flat 1, 245 Royal College Street, London NW1 9LT
Full Planning Application Ref: PP-05241164

Drawing Title:
Existing and Proposed Basement Plan
DWG-04

Date:
21 June 2016

Scale @ A3:
as indicated

Revision:
A

BONNYSTREET PLANNING LIMITED

WWW.TOWNPLANNING.LONDON

0m (1:100) 1m 2m 3m 4m 5m

0m (1:50) 1m

2m 3m 4m 5m